

Mustil no.	Killa no.	AREA UNDER 24.0 M WIDE ROAD
45	15/1	$a = 48.615 + 31.12 / 2 \times 18.97 = 757.04$ Sqm
	16/1/2	$b = 5.985 \times 7.38 / 2 = 22.084$ Sqm.
	17/1	$c = 18.44 + 23.475 / 2 \times 7.38 = 154.666$ $d = 20.625 \times 29.5 / 2 = 304.218$ $e = 2.85 \times 29.5 = 84.075$ $f = 20.115 \times 29.5 / 2 = 296.696$ Total = 839.655 sqm
	17/2	$g = 15.495 \times 23.47 / 2 = 181.833$ $h = 7.465 \times 23.47 = 175.20$ $i = 15.09 \times 23.47 / 2 = 177.081$ Total = 534.114 sqm
47	24	$j = 7.465 \times 11.5 / 2 = 42.923$ $k = 30.9 + 11.5 / 2 \times 15.09 = 319.908$ $l = 24.035 \times 30.90 / 2 = 371.340$ $m = 24.035 \times 29.45 / 2 = 353.915$ $n = 22.791 \times 29.45 / 2 = 335.594$ Total = 1423.67 sqm
	3/1	$o = 8.38 \times 20.115 = 168.563$ $p = 7.48 + 20.115 / 2 \times 11.735 = 161.91$ $q = 10.055 \times 10.83 / 2 = 54.44$ Total = 384.913 sqm
	3/2 min	$r = 15.65 \times 18.855 / 2 = 147.54$ Sqm.
	3/4 min	$s = 10.055 + 13.41 / 2 \times 8.38 = 98.318$ Sqm.
	3/8 min	$t = 13.41 + 20.265 / 2 \times 3.35 = 56.405$ $u = 20.265 \times 5.78 = 117.131$ $v = 20.115 + 11.29 / 2 \times 10.165 = 159.615$ Total = 333.151 Sqm
3/9 min	$w = 13.775 \times 15.92 / 2 = 109.649$ Sqm.	
		TOTAL AREA UNDER 24.0 WIDE ROAD = 4650.142 SQM. OR 1.1491 ACRES

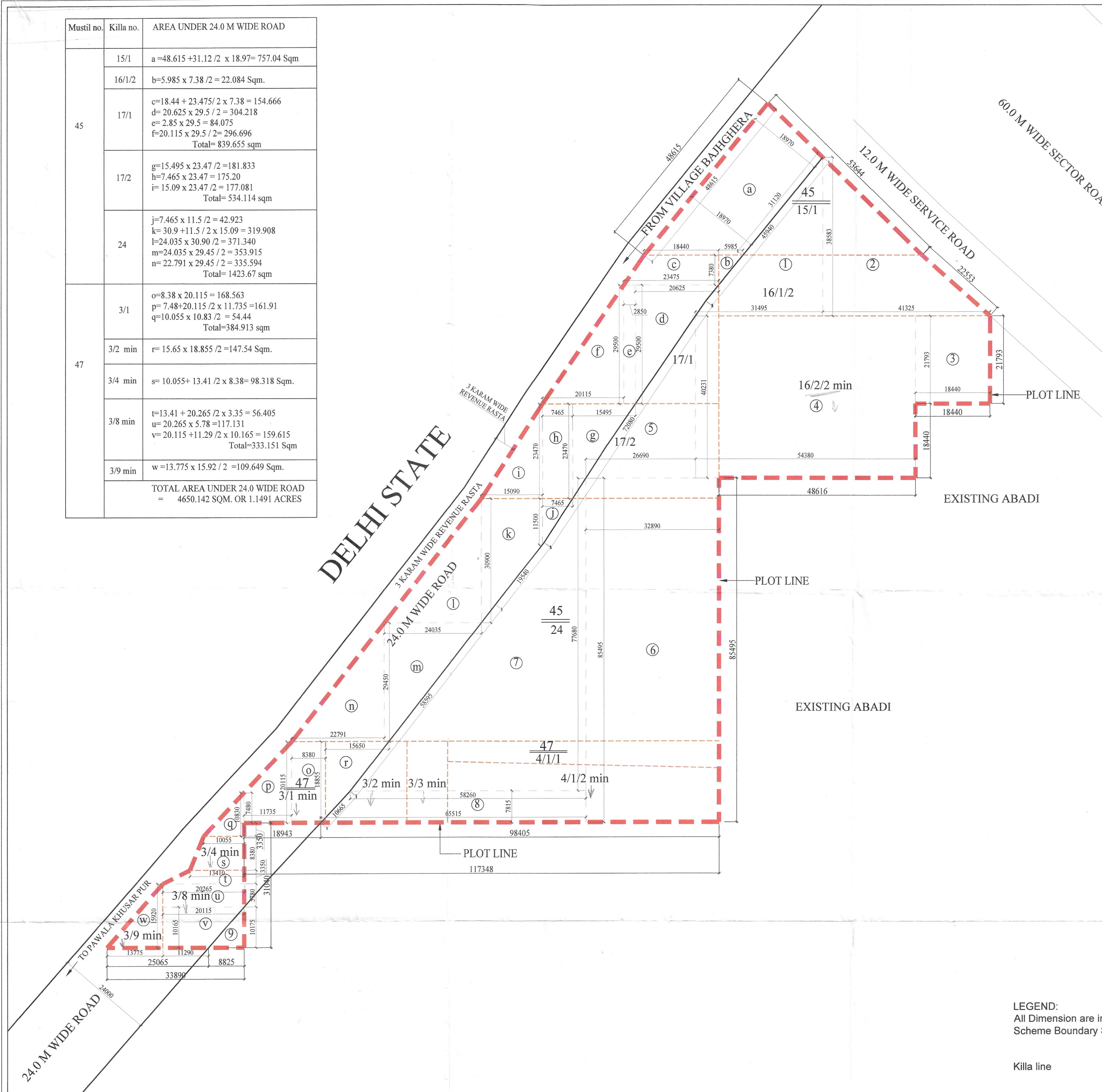

LEGEND:
 All Dimension are in Millimeter.
 Scheme Boundary Shown as

Killa line

SITE AREA CALCULATION				
S.NO.	LENGTH (M)	BREADTH (M)	AREA (SQ.M.)	CAL. FORMULA
1	31.495	38.583	607.586	(LxB)/2
2	38.583	41.325	797.221	(LxB)/2
3	18.440	21.793	401.863	LxB
4	54.380	40.231	2187.762	LxB
5	26.690	40.231	536.883	(LxB)/2
6	32.890	85.495	2811.931	LxB
7	58.260	77.680	2262.818	(LxB)/2
8	58.26+65.515	/2 x 7.815	483.650	(LxL)/2X H
9	8.825	10.175	44.897	(LxB)/2
TOTAL			10089.7	
AREA IN ACRES			2.4932	
SITE AREA = 2.4932 ACRES OR 10089.7 SQM.				
AREA UNDER 24.0 WIDE ROAD = 1.1491 ACRES OR 4650.142 SQM.				
TOTAL AREA = 3.6423 ACRES OR 14739.842 SQM.				

Sr No.	MUSTIL NO.	KILLA NO.	AREA GRANTED LOI MEMO. NO. 17296 DATED 20.07.2021			AREA UNDER 24.0 WIDE ROAD	
			KANAL	MARLA	SARSAI	AREA IN SQM.	ACRES
1	45	15/1	2	10	0	757.04	0.1871
2		16/1/2	1	15	0	22.084	0.0055
3		16/2/2 Min	4	13	1	NA	NA
4		17/1	2	5	0	839.655	0.2075
5		17/2	2	7	0	534.114	0.1320
6	47	24	9	16	0	1423.678	0.3518
7		3/1 Min	0	15	3	384.913	0.0951
8		3/2 Min	0	16	3	147.54	0.0365
9		3/3 Min	0	7	6	NA	NA
10		3/4 Min	0	4	3	98.318	0.0243
11		3/8 Min	0	17	6	333.151	0.0823
12		3/9 Min	0	4	5	109.649	0.0271
13		4/1/1	0	13	0	NA	NA
14		4/1/2 Min	1	17	7	NA	NA
TOTAL AREA IN KANAL - MARLA			29	2	7	4650.142	1.1491
AREA IN ACRES						3.6423	

PRINCIPAL ARCHITECT:

DESIGN FORUM INTERNATIONAL
 K-47, KAILASH COLONY, NEW DELHI-110048
 PHONE NO.: 011-46556600

OWNER'S SIGNATURE:

ARCHITECT'S SIGNATURE:

CLIENT:
 M/s GILLSON CHITS PVT. LTD. IN COLLABORATION WITH M/s BRISK INFRASTRUCTURE & DEVELOPERS PVT. LTD.

PROJECT:
 DEMARCATION PLAN OF COMMERCIAL PLOTTED COLONY OVER AN AREA MEASURING 3.6423 ACRES VIDE L.O.1 MEMO NO. 17296 DATED 20.07.2021 IN THE REVENUE ESTATE OF VILLAGE-CHAUMA IN SECTOR -109, GURUGRAM-MANESAR URBAN COMPLEX

DRAWING TITLE:
DEMARCATION PLAN

North

SCALE : 1:500

DATE : AUG 2021