

MORTGAGE AREA (15% OF TOTAL SALEABLE PLOTTED AREA)				
15% OF 26685.205 SQ.M. = 3997.795 SQ.M. = 0.985 Acres				
S.No of Plots	Size of Plots (In MTS.)	Total No of Plots	Total Plots Area(In SQ.M.)	Share Detail
C-144	6.55 X 16.80	110.04	110.04	53/16
C-145 to C-154	6.55 X 16.80	110.04	1100.40	53/15/2
C-155 to C-161	6.55 X 16.80	110.04	990.36	53/16
C-164 to C-173	6.96 X 14.77	102.80	1028	52/11
C-174 to C-175	6.96 X 14.77	102.80	205.6	52/11
C-176 to C-181	6.96 X 14.77	102.80	614.8	52/11
TOTAL AREA OF MORTGAGE PLOTS		39	4951.20	1001 Acres

FREEZE AREA (9% OF TOTAL SALEABLE PLOTTED AREA)				
9% OF 26685.205 SQ.M. = 2399.663 SQ.M. = 0.589 Acres				
S.No of Plots	Size of Plots (In MTS.)	Total No of Plots	Total Plots Area(In SQ.M.)	Share Detail
C-12 to C-36	7.25 X 17.44	136.61	633.05	53/13
C-40 to C-44	6.55 X 16.80	110.04	500.20	53/13
C-45 to C-47	6.55 X 16.80	110.04	300.12	53/13
C-51 to C-60	6.55 X 16.80	110.04	880.32	53/13
C-69 to C-76	6.55 X 16.80	110.04	1540.56	53/13
C-77 to C-80	6.55 X 16.80	110.04	500.20	53/14
C-88 to C-102	6.55 X 16.80	110.04	500.20	53/14
C-103 to C-107	6.55 X 16.80	110.04	1100.40	53/14
C-110 to C-112	6.55 X 16.80	110.04	550.20	53/14
C-124 to C-127	6.55 X 16.80	110.04	550.20	53/14
C-128 to C-131	6.55 X 16.80	110.04	1100.28	53/14
C-148 to C-151	6.55 X 16.80	110.04	990.36	53/14
C-155 to C-161	6.55 X 16.80	110.04	1028	52/11
C-164 to C-173	6.96 X 14.77	102.80	205.6	52/11
C-174 to C-181	6.96 X 14.77	102.80	614.8	52/11
TOTAL AREA OF FREEZE PLOTS		122	13877.41	3.308 Acres

PROFITABLE OF AREA SCHEME AREA				
50% OF 124 M WIDE SERVICE ROAD AND GREEN BELT				
AREA OF SCHEME (A, B, C)				
Area Under Commercial Provision @ 21% of Licensed Area	Area Under Residential Provision @ 79% of Licensed Area	Total Area	Area Under Commercial Provision @ 21% of Licensed Area	Area Under Residential Provision @ 79% of Licensed Area
1.044	1.044	2.088	0.231	1.857
Green Area Provided @ 7.16 % of Licensed Area			1.044	1.044
width	depth	Area	Number	Total Area
7.52	1.44	10.8288	12	129.9456
7.52	1.44	10.8288	12	129.9456
Type-C	6.55	16.80	110.04	1344.8607
Type-D	6.55	14.77	102.80	2467.181
Type-E	6.70	18.10	121.27	2691.450
Type-F	6.55	16.50	108.08	2009.592
Type-G	7.73	18.50	143.00	2624.500
Total area in Acres			234	6.889

DENSITY CALCULATIONS FOR PLOTTED DEVELOPMENT 13.38623 ACRES				
Plots @ 11.5 Person per plots - 258 X 115	3189.000			
Plots @ 11.5 Person per plots - 258 X 115	246.533	P.S.A		
Admitted Density	1318.013 (14.423)	P.S.H		
OR	561.623	P.F.H		
PROPOSED GREEN AREA = 7.16 % OF LICENSED AREA = 0.75 X 13.38623 = 1.004 ACRES				
PROPOSED GREEN AREA = 1.044 ACRES @ 1.044 / 13.38623 X 100 = 7.819%				

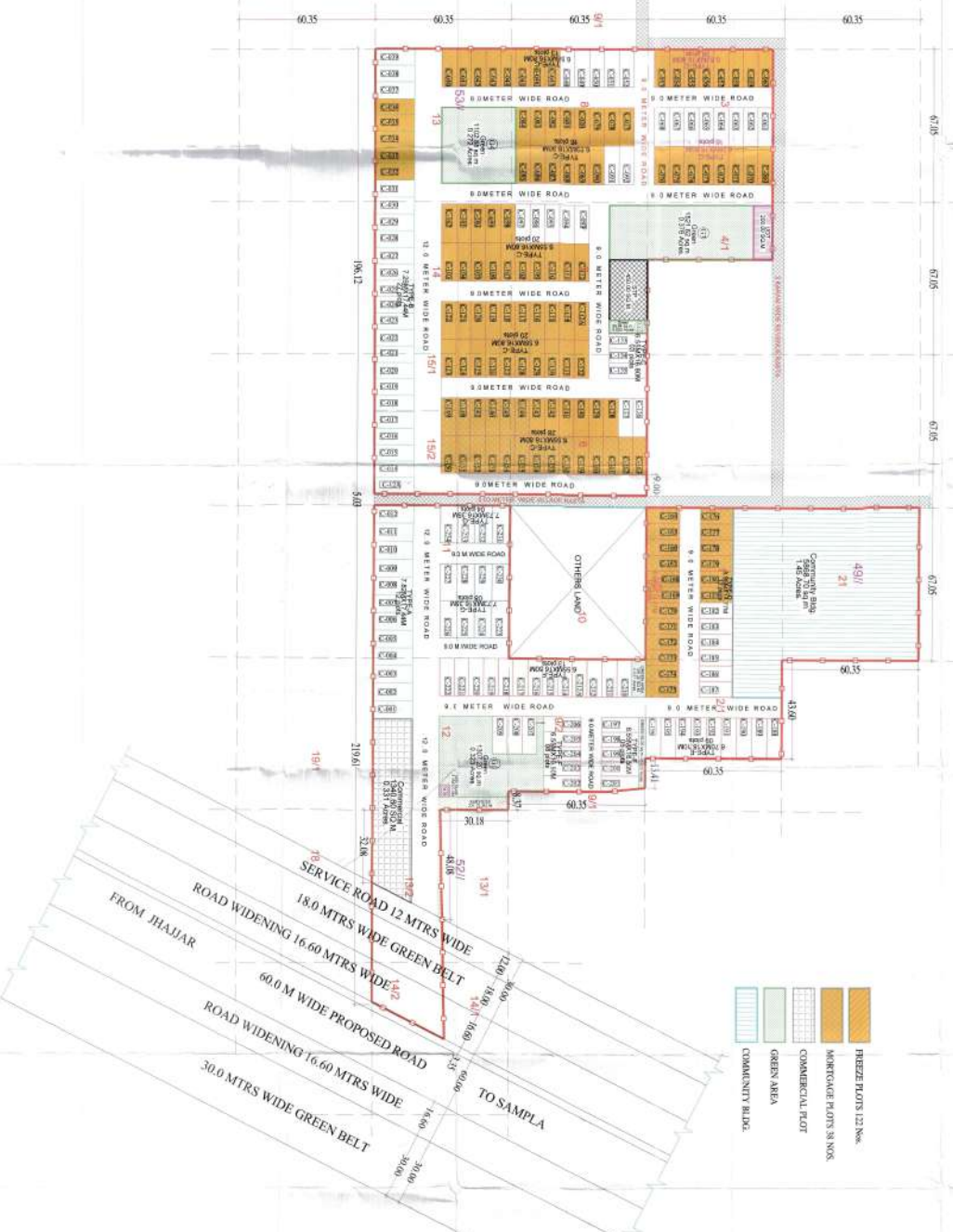

13.38623 ACRES No. 310, 2nd St. Plot No. 115, L-2-231

The 100% layout plan for the above mentioned project is prepared in accordance with the provisions of the Maharashtra Building Regulation Act, 1960 and the Maharashtra Building (Amendment) Act, 1972 and the Maharashtra Building (Amendment) Act, 1980 and the Maharashtra Building (Amendment) Act, 1985 and the Maharashtra Building (Amendment) Act, 1990 and the Maharashtra Building (Amendment) Act, 1995 and the Maharashtra Building (Amendment) Act, 2000 and the Maharashtra Building (Amendment) Act, 2005 and the Maharashtra Building (Amendment) Act, 2010 and the Maharashtra Building (Amendment) Act, 2015 and the Maharashtra Building (Amendment) Act, 2020 and the Maharashtra Building (Amendment) Act, 2025.

PROJECT:
PROPOSED LAYOUT PLAN FOR AFFORDABLE RESIDENTIAL PLOTTED COLONY UNDER DEEN DAVAJAN AWAS YOJANA (DDJAY) ON LAND AD MEANS RING 13.38623 ACRES AT SECTOR-29 VILLAGE JANDHOL, TEHSIL & DISTRICT HAJIAR, RAJASTHAN FOR M/S. VIJAY LAXMI INFRABUILD (P) LTD.

DRAWING TITLE: LAYOUT PLAN

NAME OF OWNER: VIJAY LAXMI INFRABUILD (P) LTD.

SIGNATURE: [Signature]

NAME OF ARCHITECT: [Signature]

SCALE: 1:1000

DRAWING NO.: [Number]

DATE: [Date]