

LAYOUT PLAN AS PER AKS- SHJRA PLAN WITHIN KHEWAT NO. 2918, KHATA NO. 3241,
 MUSTIL KILLA NO. 33/3(8-0), 8/1 (7-2), 13/1/2(1-16) MEASURING 16 KANAL 18 MARLA AND
 KHEWAT NO. 2905 MIN MUSTIL KILLA NO. 26/23/3(0-18), 23/5(0-3), 24/1/5(0-12), 24/1/7(1-0)
 MEASURING 2 KANAL 13 MARLA
 SITUATED AT VILLAGE BOHAR, SECTOR 35 SUNCITY ROHTAK
 TOTAL LAND AREA MEASURING 19 KANAL 11 MARLA OR - 2.44375 ACERS
 BELONGING TO M/S PATANJALI BUILDCON PVT.LTD

AREA DETAIL :-

- TOTAL AREA OF SITE = 9889.50 SQ.M.
- AREA UNDER 70.0 M GREEN BELT = 994.46 SQ.M.
- AREA UNDER 30.0 M SERVICE BELT = 378.63 SQ.M.
- NET PLANNED AREA = 8516.41 SQ.M.

(SANJAY KUMAR) STP (HQ)
 (P. B. SINGH) CTP (HR.)
 (T.L. SATYAPRAKASH) IAS DGTCP (HR.)

FOR MORTGAGE DEBO ONLY

(NARINDER KUMAR) JD (HQ)
 (YAJAN CHAUDHARY) ATP (HQ)
 (DIVYA DOGRA) DTP (HQ)

75.0 M WIDE BYE PASS ROAD

100.0 M WIDE GREEN BELT INCLUDING 30.0 M WIDE SERVICE ROAD

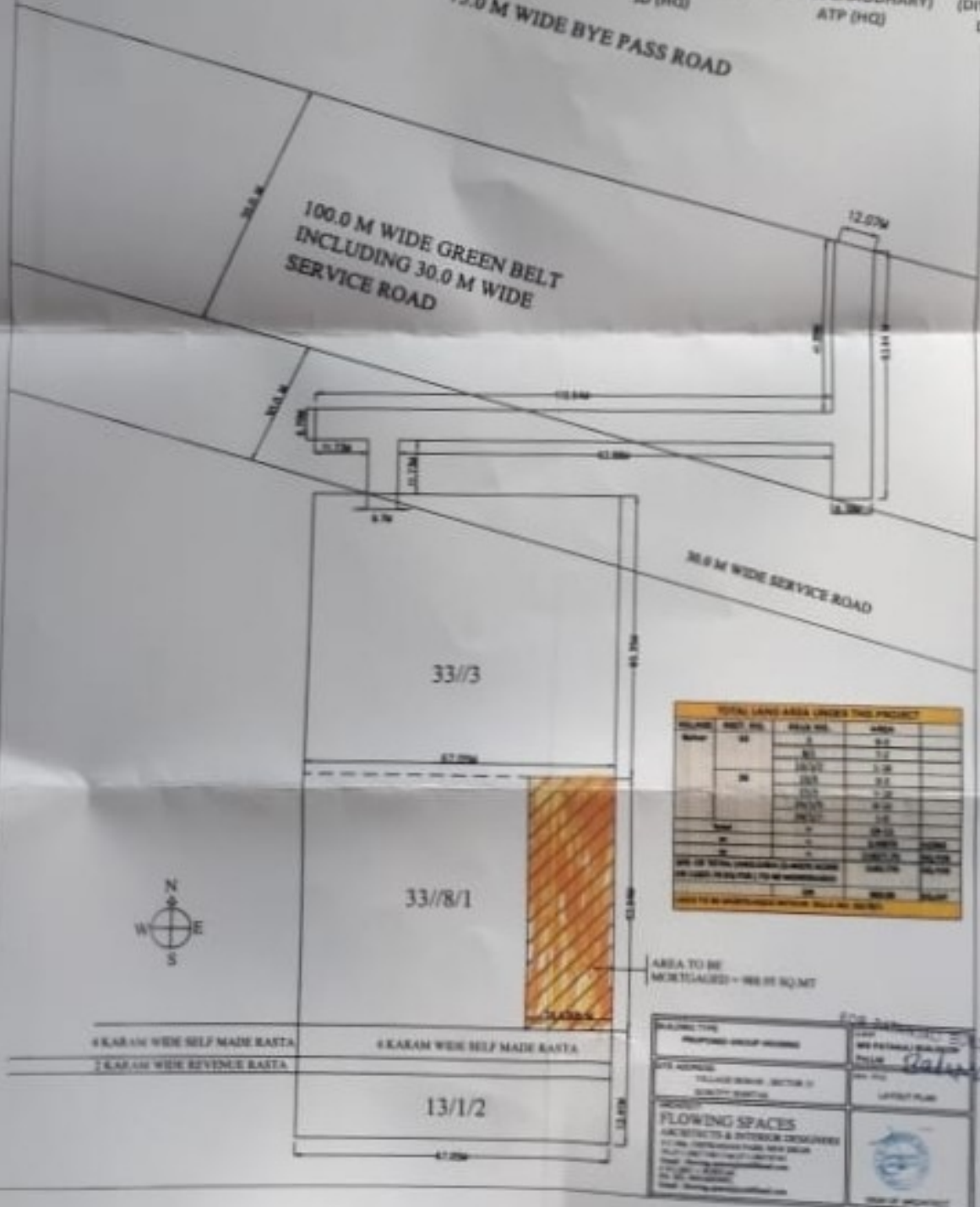

NO.	AREA (SQ. M)	AREA (KANAL)	AREA (MARLA)
1	9889.50	19	11
2	994.46	2	12
3	378.63	0	22
4	8516.41	17	11
5	16875.00	33	19
6	16875.00	33	19
7	16875.00	33	19
8	16875.00	33	19
9	16875.00	33	19
10	16875.00	33	19
11	16875.00	33	19
12	16875.00	33	19
13	16875.00	33	19
14	16875.00	33	19
15	16875.00	33	19
16	16875.00	33	19
17	16875.00	33	19
18	16875.00	33	19
19	16875.00	33	19
20	16875.00	33	19
21	16875.00	33	19
22	16875.00	33	19
23	16875.00	33	19
24	16875.00	33	19
25	16875.00	33	19
26	16875.00	33	19
27	16875.00	33	19
28	16875.00	33	19
29	16875.00	33	19
30	16875.00	33	19
31	16875.00	33	19
32	16875.00	33	19
33	16875.00	33	19
34	16875.00	33	19
35	16875.00	33	19
36	16875.00	33	19
37	16875.00	33	19
38	16875.00	33	19
39	16875.00	33	19
40	16875.00	33	19
41	16875.00	33	19
42	16875.00	33	19
43	16875.00	33	19
44	16875.00	33	19
45	16875.00	33	19
46	16875.00	33	19
47	16875.00	33	19
48	16875.00	33	19
49	16875.00	33	19
50	16875.00	33	19
51	16875.00	33	19
52	16875.00	33	19
53	16875.00	33	19
54	16875.00	33	19
55	16875.00	33	19
56	16875.00	33	19
57	16875.00	33	19
58	16875.00	33	19
59	16875.00	33	19
60	16875.00	33	19
61	16875.00	33	19
62	16875.00	33	19
63	16875.00	33	19
64	16875.00	33	19
65	16875.00	33	19
66	16875.00	33	19
67	16875.00	33	19
68	16875.00	33	19
69	16875.00	33	19
70	16875.00	33	19
71	16875.00	33	19
72	16875.00	33	19
73	16875.00	33	19
74	16875.00	33	19
75	16875.00	33	19
76	16875.00	33	19
77	16875.00	33	19
78	16875.00	33	19
79	16875.00	33	19
80	16875.00	33	19
81	16875.00	33	19
82	16875.00	33	19
83	16875.00	33	19
84	16875.00	33	19
85	16875.00	33	19
86	16875.00	33	19
87	16875.00	33	19
88	16875.00	33	19
89	16875.00	33	19
90	16875.00	33	19
91	16875.00	33	19
92	16875.00	33	19
93	16875.00	33	19
94	16875.00	33	19
95	16875.00	33	19
96	16875.00	33	19
97	16875.00	33	19
98	16875.00	33	19
99	16875.00	33	19
100	16875.00	33	19

AREA TO BE MORTGAGED - 16875 SQ.MT

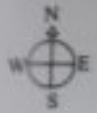

4 KAKAM WIDE SELF MADE BASTA
 1 KAKAM WIDE REVENUE BASTA
 4 KAKAM WIDE SELF MADE BASTA

FOR SALE/LEASE/RENT/DEVELOPMENT

PROPOSED GROUP NAME: M/S PATANJALI BUILDCON PVT. LTD.

DATE: 20/01/2024

PROJECT NAME: PATANJALI BUILDCON PVT. LTD.

AREA: 16875 SQ.MT

TYPE OF PROJECT: FLOWING SPACES

DESIGNER: M/S PATANJALI BUILDCON PVT. LTD.

SCALE: 1:1000

DATE OF PREPARATION: 20/01/2024

PROJECT LOCATION: SECTOR 35, SUNCITY, ROHTAK

PROJECT NO: PATANJALI/2024/01

PROJECT ADDRESS: SECTOR 35, SUNCITY, ROHTAK

PROJECT CONTACT: 9876543210

PROJECT WEBSITE: www.patanjalibuildcon.com

PROJECT OFFICE: PATANJALI BUILDCON PVT. LTD., SECTOR 35, SUNCITY, ROHTAK

PROJECT PHONE: 9876543210

PROJECT FAX: 9876543210

PROJECT EMAIL: info@patanjalibuildcon.com

PROJECT URL: www.patanjalibuildcon.com

PROJECT SOCIAL MEDIA: www.patanjalibuildcon.com

PROJECT CONTACT PERSON: PATANJALI BUILDCON PVT. LTD. DIRECTOR