

DTP  
 ATP  
 AD  
 JE  
 PAT

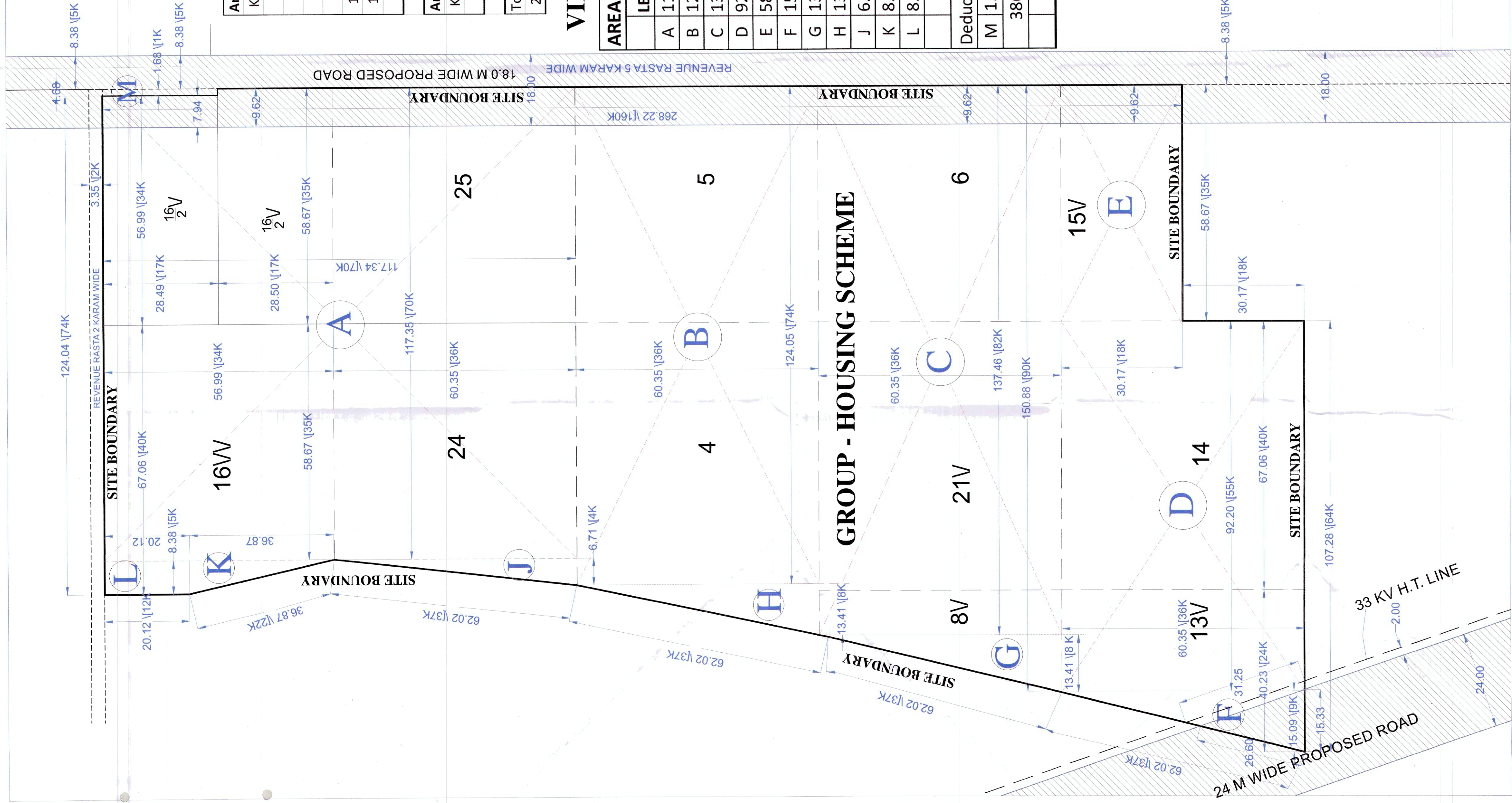

**Area falling under 18.00 M wide Road.**

Killa No.	Length	Width	Area (Sq.m.)
15/1.	9.62	30.17	= 290.24
6	9.62	60.35	= 580.57
5	9.62	60.35	= 580.57
25	9.62	60.35	= 580.57
16/2/2.	9.62	28.50	= 274.17
16/2/1.	7.94	28.49	= 226.21
Total area (Sq.m.)			<b>2532.32</b>

**Area falling under 24.00 M wide Road.**

13/2.	15.33	26.60	0.5	<b>203.89</b>
Total area under Roads =			2532.32	+ 203.89
Total area under Roads =			<b>2736.21</b>	

**VILLAGE ABADI**

**AREA DETAIL**

LENGTH	WIDTH	AREA (Sq.m.)
A 117.35	X 117.35	= 13771.023
B 124.05	X 60.35	= 7486.418
C 137.46	X 60.35	= 8295.711
D 92.20	X 60.35	= 5564.270
E 58.67	X 30.17	= 1770.074
F 15.09	X 60.35	0.5 455.341
G 13.41	X 60.35	0.5 404.647
H 13.41	X 60.35	0.5 404.647
J 6.71	X 60.35	0.5 202.474
K 8.38	X 36.87	0.5 154.485
L 8.38	X 20.12	= 168.606
Deduction		
M 1.68	X 28.49	= 47.86
38677.69 - 47.86		=
		<b>38677.69</b>
		<b>Acres</b>

GODREJ PROPERTIES LTD.  
*Vishesh Singh*  
 Authorized Signatory

PROJECT NAME & ADDRESS :  
 Demarcation plan of Group Housing Colony under  
 TOD over an area measuring 9.56875 acres (99.5%)  
 Residential and 0.5% Commercial in revenue  
 estate of village Ghasola, Tahsil Badshahpur,  
 sector-49, Gurugram - Godrej Properties Ltd.  
 Loi No. LC-50711/JE(SJ)/2023/17  
 Dated: 07.06.2023

OWNER NAME :  
**M/Godrej Properties Ltd.**

ARCHITECT'S SIGNATURE :  
  
 Architect  
 1000, Sector 49, Gurugram  
 Haryana, India  
 PIN No. 122 002

DRAWING TITLE :  
**DEMARICATION PLAN**

NORTH :  
