

GROUND FLOOR AREA CALCULATION ( COMMERCIAL -3 )						
TOTAL COVD. AREA AT GROUND FLOOR						
Sr No	Dim (m)	X	Dim (m)	Fec.	Nos	Area (SQM)
F01	( 5.030 + 8.105 ) / 2 X 13.000				1	85.377
TOTAL GROUND COVERAGE / FAR AREA AT GROUND FLOOR (C)						85.377

Exit Calculation For Ground Floor						
Total floor area			85.377		sqm	
Floors	Average occupant load as per NBCC	No. of occupant	As per NBCC (@ 10mm/ Person)	Exit Required	Stair case Provided	
Mercantile Area	85.377	3	28.46	10	1 X 1250 = 1250 MM	

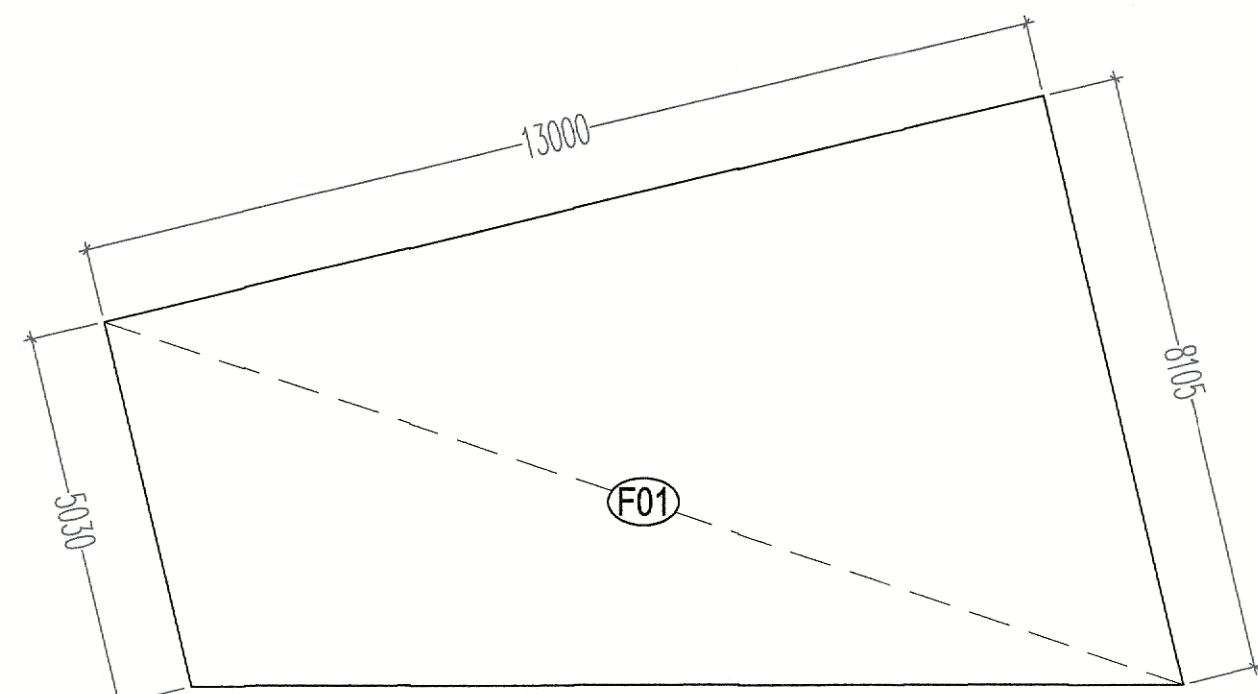

AREA DIAGRAM GROUND FLOOR

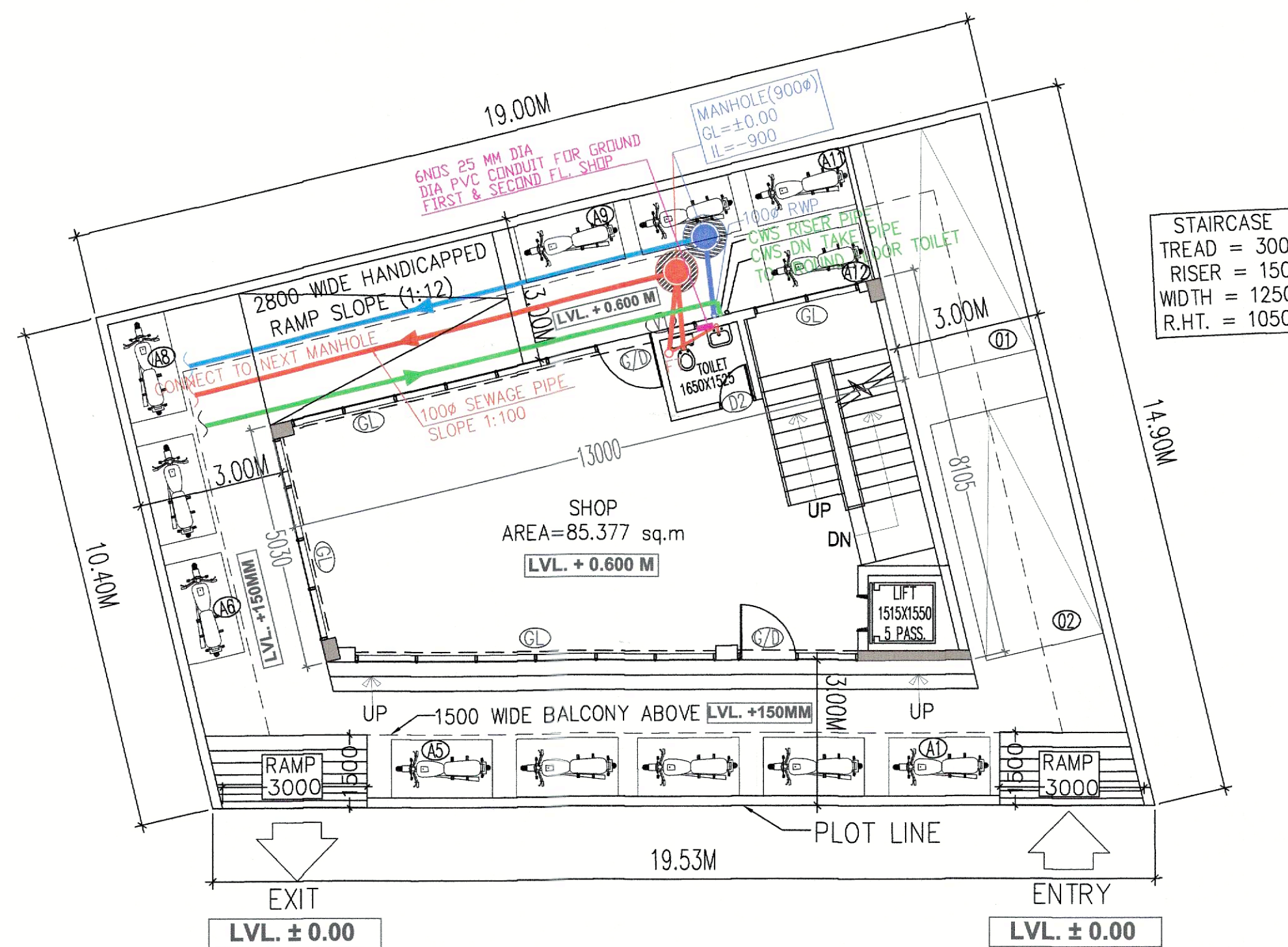

GROUND FLOOR PLAN

TOILET CALCULATION						FAR AREA	OCCUPAN T LOAD	NO OF OCCUPANT
TOTAL FAR AREA AT GROUND FLOOR						85.377	3	28.5
TOTAL FAR AREA AT FRST FLOOR						67.255	6	11.2
TOTAL FAR AREA AT SECOND FLOOR						67.255	6	11.2
TOTAL NO OF OCCUPANT								50.9
NO.	PERMANENT POPULATION		FLOATING POPULATION		TOTAL REQUIRED		TOTAL PROVIDED	
	10%	5.09	90%	45.79				
	MALE (2/3)	FEMALE (1/3)	MALE (2/3)	FEMALE (1/3)	MALE	FEMALE	MALE + FEMALE	
POPULATION	3	2	31	15	-	-	-	
W.C.	0.14	0.11	0.12	0.10	0.26	0.21	1	
URINAL	0.11	-	0.61	-	0.72	-	1	
WASH BASIN	0.14	0.07	0.12	0.11	0.26	0.18	1	

BASEMENT FLOOR AREA CALCULATION ( COMMERCIAL -3 )						
TOTAL COVERD AREA AT BASEMENT FLOOR						
Sr No	Dim (m)	X	Dim (m)	Fec.	Nos	Area (SQM)
N01	( 5.030 + 8.105 ) / 2 X 13.000				1	85.377
TOTAL COVERD AREA AT BASEMENT FLOOR (C)						85.377

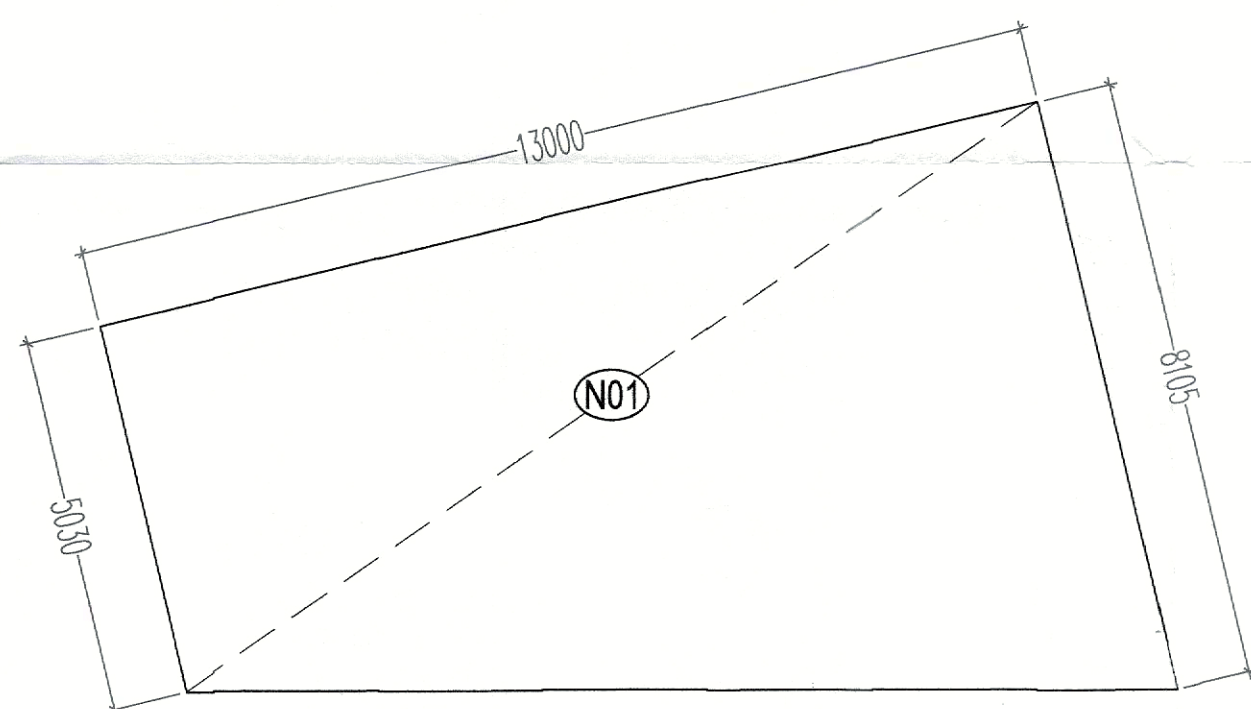

AREA DIAGRAM BASEMENT FLOOR

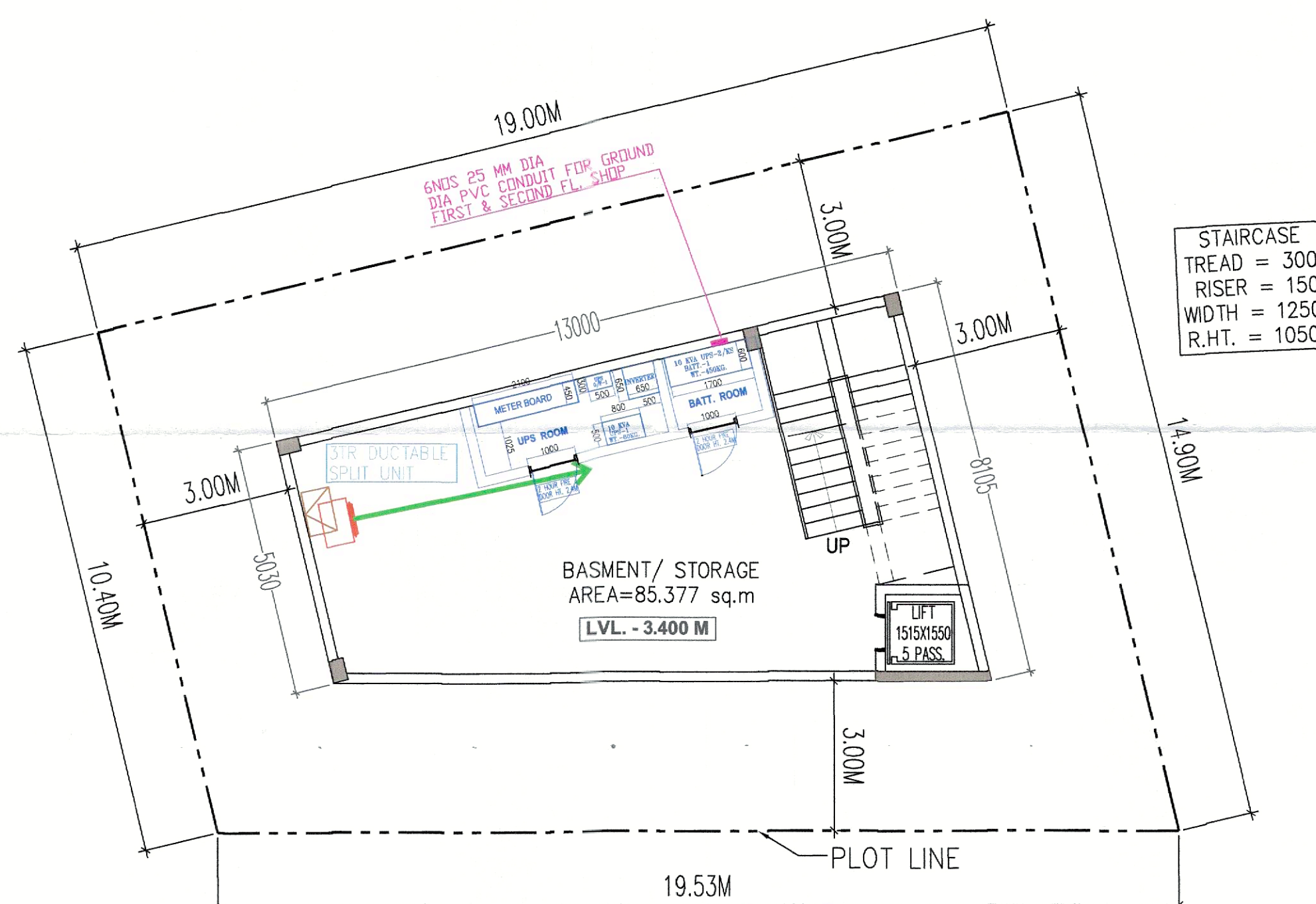

BASEMENT PLAN

Sanctioned and Valid For 2 Years  
Subject to Validity of Licence / L.U. Extension Permission  
Building Plan Committee Controlled Area  
Gurgaon Circle, Gurgaon

#### PLUMBING LEGEND

- 100Ø SOIL PIPE
- 100Ø WASTE PIPE
- 75Ø ANTISYPHONAGE VENT PIPE
- DOMESTIC WATER SUPPLY DN TAKE PIPE
- FLUSHING WATER SUPPLY DN TAKE PIPE
- DOMESTIC WATER RISER PIPE
- FLUSHING WATER RISER PIPE
- SOFT WATER RISER PIPE
- 100Ø RAIN WATER PIPE
- 150Ø RAIN WATER PIPE

#### SCHEDULE OF OPENINGS

TYPE	WIDTH	HEIGHT	SILL HT.	LINTEL
D1	1000	2100	-	2100
D2	750	2100	-	2100
FCD	1300	2100	-	2100
G/D	AS/PLAN	2100	-	2100
GL	AS/PLAN	2100	-	2100
V1	600	900	B.O.B	-

#### NOTES

- WHOLE BUILDING SHALL BE MECHANICALLY VENTILATED WITH 100% POWER BACKUP AND SPRINKLERS WITH ARTIFICIAL LIGHTING.
- HANDICAP RAMP WITH RAILING
- ALL PARTITION ARE IN 150/200MM THICK IN BLOCK WORK.

OWNER'S SIGN

GIAN P. MATHUR  
ARCHITECT  
B. Arch., C.A. I.I.A.  
CA No. 80/5769

ARCHITECT'S SIGN

PROJECT:-  
APPROVAL OF BUILDING PLAN OF COMMERCIAL -3 OF AREA MEASURING 240.352 SQM PART OF AFFORDABLE RESIDENTIAL PLOTTED COLONY UNDER DEEN DAYAL JAN AWAS YOJANA, OVER AN AREA MEASURING 23,2999 ACERS INCLUDING ADDITIONAL AREA 2,69097 ACERS LICENCE NO. 62 OF 2022 DATED 25.05.2022 ADJOINING TO EARLIER GRANTED LICENSE NO. 68 OF 2021 DATED 16.09.2021 FOR AN AREA MEASURING 20,60902 ACERS IN THE REVENUE ESTATE OF VILLAGE BEHRAMPUR AND ULLAWAS, SECTOR-61, DISTRICT GURUGRAM-SUPOSHAA REALCON PVT. LTD.