

ZONING PLAN OF AFFORDABLE RESIDENTIAL PLOTTED COLONY OVER AN AREA MEASURING 16.31875 ACRE (LICENSE NO. 181 OF DATED 11-09-2023) UNDER DJJAY - 2016, FALLING IN THE REVENUE ESTATE OF VILLAGE RATHDHANA, SECTOR-33, SONEPAT, DEVELOPED BY - SH. OM PRAKASH SAROHA AND OTHERS IN COLLABORATION WITH ELDECO INFRACON REALTORS LIMITED.

FOR PURPOSE OF CODE 1.2 (xcvi) & 6.1 (1) OF THE HARYANA BUILDING CODE, 2017, AS AMENDED FROM TIME TO TIME.

1. USE ZONE
The land shown in this zoning plan shall be used in accordance with the marking explained in the table below and no other manner whatsoever:

Notation	Permissible use of land on the plot marked in column 1	Type of building permissible on land marked in column 2
1	Road	Road furniture at approved places.
2	Public open space	To be used only for landscape features.
3	Residential Buildable Zone	Residential building.
4	Commercial	As per supplementary zoning plan to be approved separately for each site.

2. MAXIMUM PERMISSIBLE GROUND COVERAGE BASEMENT, FAR AND MAXIMUM PERMISSIBLE HEIGHT / INCLUDING STILLT PARKING

- (a) The building or buildings shall be constructed only within the portion of the site marked as buildable zone as explained above, and nowhere else.
- (b) The Planning parameter to be adopted is as below:-

Plot Area (sq. metres)	Maximum Permissible Ground Coverage	Permissible Basement	Maximum Permissible Floor Area Ratio (FAR)	Maximum permissible Height (in metres)
Upto 150 square metres	75%	Single Level	200%	16.5

- (c) The sites are permitted parking purpose in residential plots of all sizes, subject to the condition that maximum permissible height of building shall not exceed 16.5 metres as per the terms and conditions of policy circulated vide memo no. Misc-2339-VOL-III-ULB/7/5/2006-2TCP dated 25-04-2022.

3. PERMISSIBLE NUMBER OF DWELLING UNIT ON EACH PLOT

- a). No. of Dwelling unit permitted on each plot : 3 (Three)
- b). Provided that in case the decision dated 23.02.2023 to keep in abeyance the approvals of 1+4 dwelling units is revoked by the competent authority and building plans approval for such 1+4 units is allowed, the number of dwelling unit permitted on each plot shall be restored to 4 (four) dwelling units.

4. BAR ON SUB-DIVISION OF PLOT

Sub-division & clubbing of the plots shall not be permitted in any circumstances.

5. BUILDING SETBACK

Building other than boundary wall and gates shall be constructed only within the portion of the site marked as residential buildable zone in clause number 1 above. Balcony of a width of maximum 1.80 m in front and rear sides of a plot can be permitted within the plot. No balcony beyond the rear zoning shall be permitted.

6. HEIGHT OF THE BUILDING AND PERMISSIBLE NUMBER OF STOREY

The maximum height and number of storey shall be allowed on the plot as per provisions of Haryana Building Code, 2017.

7. STILLT PARKING

Stillt parking is allowed in all sizes plots. The clear height of the stillt shall be 2.40 metres from the plinth level and below the bottom of the beam. The stillt will not be permissible for any purpose other than parking.

8. PARKING

- (a) Parking shall be provided as per the provisions of Haryana Building Code - 2017, as amended from time to time.
- (b) In no circumstance, the vehicle(s) belonging to the plot shall be parked outside the plot area.

9. PLINTH LEVEL
The plinth height of building shall be as per Code No. 7.3 of the Haryana Building Code, 2017.

10. BASEMENT

Single level basements within the building zone of the site shall be provided as per Code 6.3(3)(i)(a) and shall be constructed, used and maintained as per Code 7.16 of the Haryana Building Code, 2017.

11. RESTRICTION OF ACCESS FROM 45 MTS. WIDE OR MORE SECTOR ROADS AND PUBLIC OPEN SPACES

In the case of plots which abut on the 45 meters or more wide sector roads and plots which abut on public open spaces, no direct access whatsoever secondary or main shall be allowed into the plots from such roads and open spaces.

12. BOUNDARY WALL

- (a) The boundary wall shall be constructed as per Code 7.5.
- (b) The boundary walls in front courtyard which abut on a road or an open space shall be constructed according to standard design as approved by the DGCP. The boundary wall in the rear courtyard shall not be more than 1.80 meters in height.
- (c) In case of corner plots, boundary walls shall be rounded off at such corner by a radius as given below:-
 - i). 0.5 meters Radius for plots opening on to open space.
 - ii). 1.0 meters Radius for plots upto 125 sq. meters.
 - iii). 1.50 meters Radius for plots above 125 sq. meters to 150 sq. meters.
- (d) The owner/applicant if desires, is permitted to not construct boundary wall in front of plot, so that the said area can be utilized for parking.

13. GATE AND GATE POST

- a) Gate and gate post shall be constructed as per approved standard design, at the position indicated on the zoning plan.
- b) An additional wicket gate of standard design not exceeding 1.15 meter width may be allowed in the front and side boundary wall provided further that no gate shall be allowed in the rear boundary wall or towards the sector road and public open space.

14. DISPLAY OF POSTAL NUMBER OF THE PLOT

The premises number and postal address shall be written in the space shown for this purpose on the standard design of the gate as per approved design.

15. GARBAGE COLLECTION POINT

Every plot holder shall make adequate provision for garbage collection in his own plot and make suitable arrangement for disposal at the towable collection point to be provided by the colonizer.

16. ACCESS

No plot or public building will derive an access from less than 9.00 meters wide road.

17. GENERAL

- (i) That the coloniser/owner shall use only Light-Emitting Diode lamps (LED) lighting for internal lighting as well as Campus lighting.
- (ii) That the coloniser/owner shall strictly comply with the directions issued vide Notification No. 19/6/2016-5P dated 31.03.2016 issued by Haryana Government Renewable Energy Department, if applicable.
- (iii) That the coloniser/owner shall ensure the installation of Solar Photovoltaic Power Plant as per the provisions of order No. 22/52/2005-5Power dated 21.03.2016 issued by Haryana Government Renewable Energy Department, if applicable.
- (iv) Fire safety protection measures shall be regulated by Haryana fire service Act, 2009 as amended from time to time.
- (v) Rain water harvesting shall be provided as per HBC-2017 (if applicable).

Note:
Read this drawing in conjunction with the demarcation plan verified by D.T.P. Sonapat vide Endst no. 13656 Dated 22/09/2023

DRG. NO. DGCP/974 DATED 20-10-23

(NARINDER KUMAR) JD(HQ) (SUREKHA YADAV) ATP(HQ) (SUNENA) DTP(HQ) (SANJAY KUMAR) STP(E&V) (B.P. SINGH) LTP(HR) (T.L. SATYAPRAKASH, IAS) (DGCP(HR))

PLOT ZONING DETAIL:-

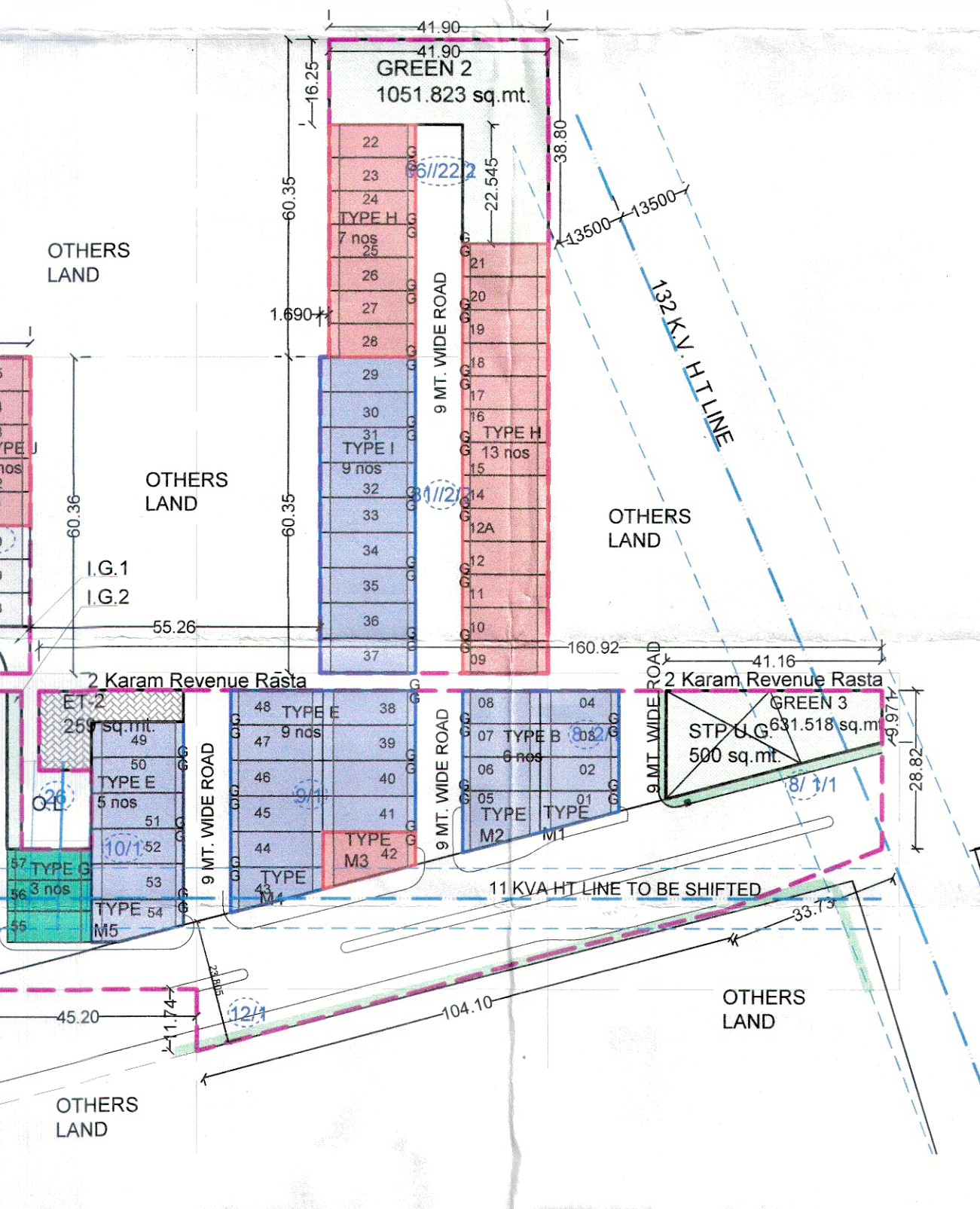
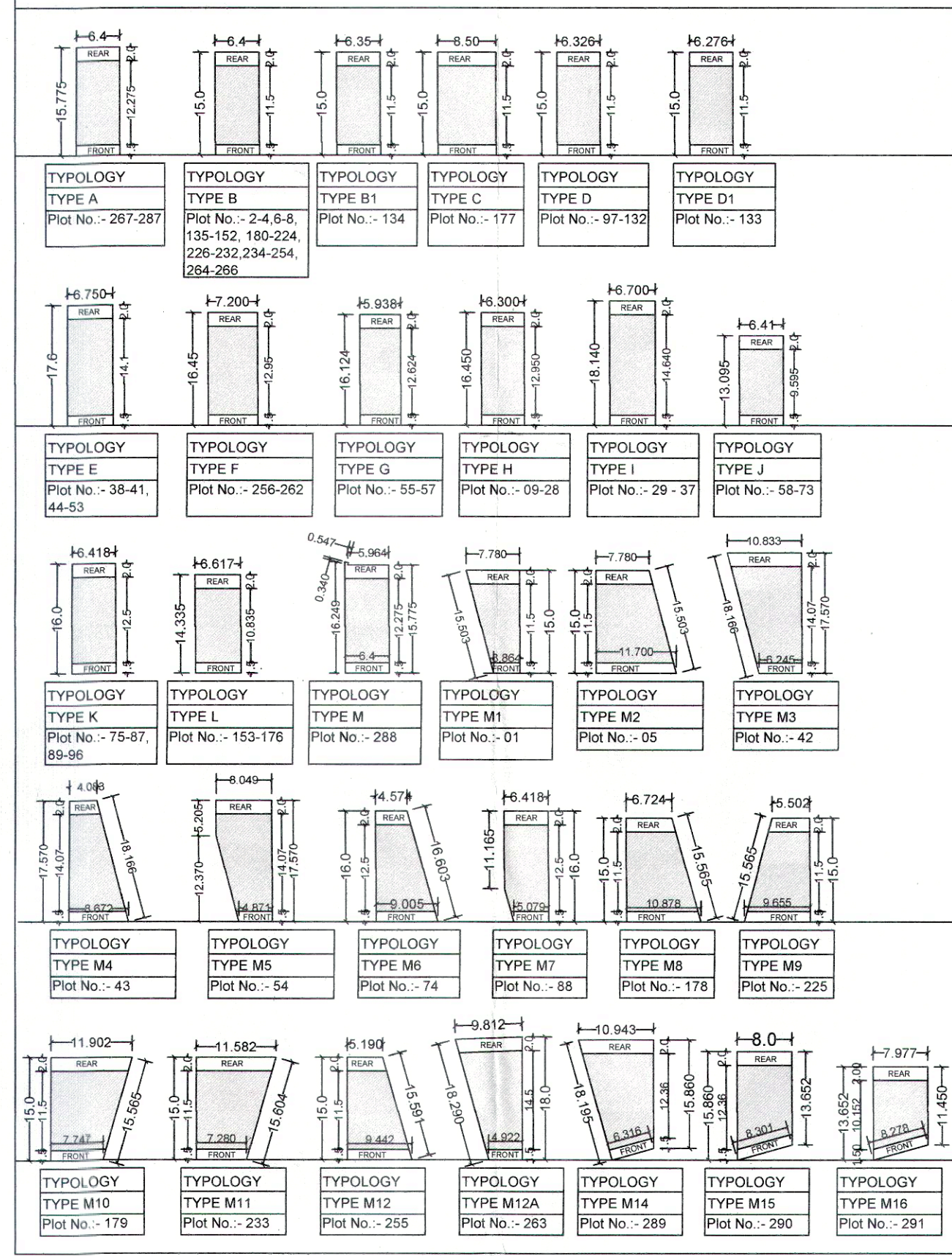

- NOTE:-**
- ALL DIMENSIONS ARE IN METERS
 - NO PROJECTION /CANTILEVER ALLOWED IN THE REAR SETBACK

SHEET 1 OF 3

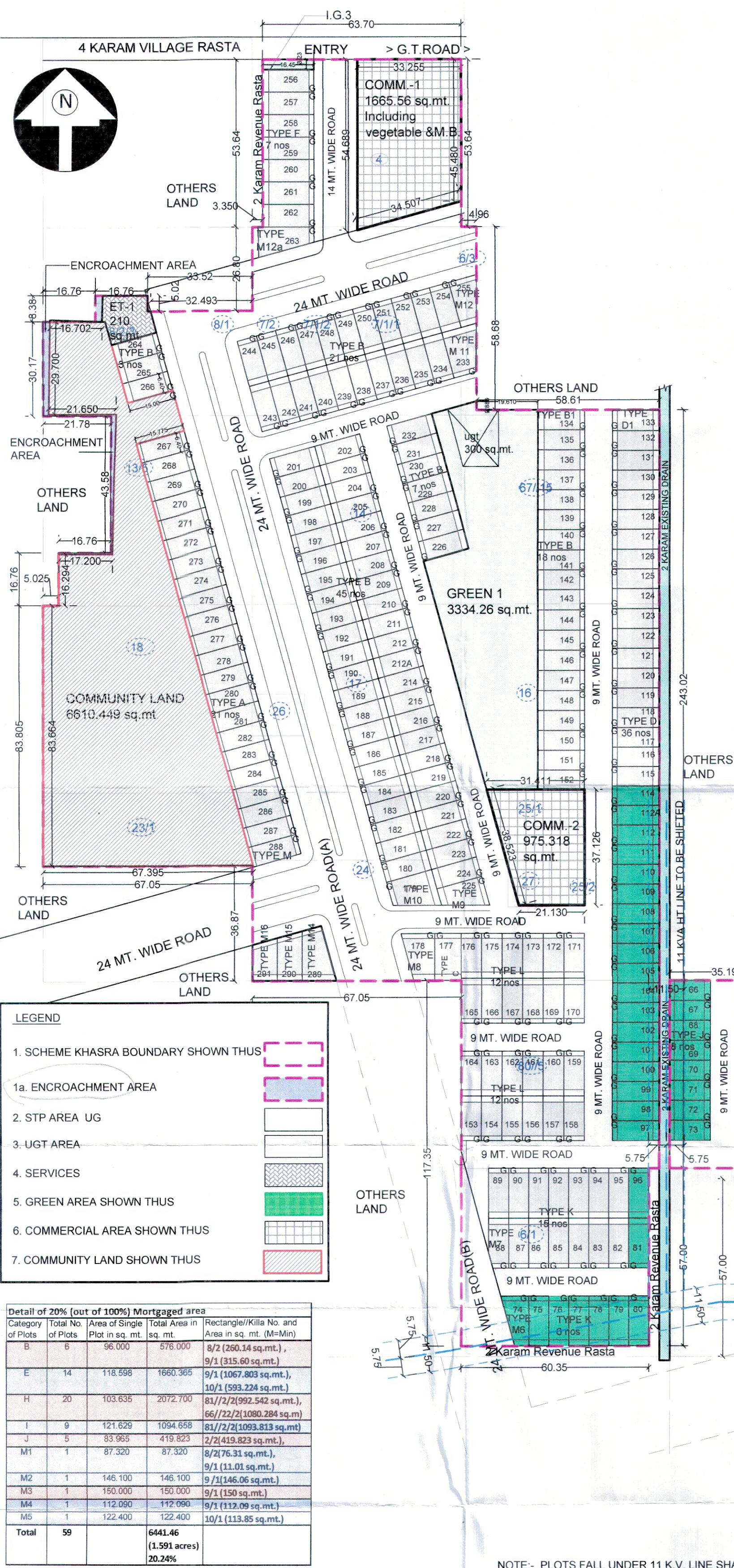

LEGEND

- SCHEME KHASRA BOUNDARY SHOWN THUS
- ENCROACHMENT AREA
- STP AREA UG
- UGT AREA
- SERVICES
- GREEN AREA SHOWN THUS
- COMMERCIAL AREA SHOWN THUS
- COMMUNITY LAND SHOWN THUS

Detail of 20% (out of 100%) Mortgage area

Category	Total No. of Plots	Area of Single Plot in sq. mt.	Total Area in sq. mt.	Rectangle/Killa No. and Area in sq. mt. (B-H in ft)
B	6	96.000	576.000	8/2 (296.14 sq.mt.), 9/1 (315.60 sq.mt.)
E	14	118.558	1660.365	9/1 (1067.803 sq.mt.), 10/1 (593.224 sq.mt.)
H	20	103.635	2072.700	81/72/1992.542 sq.mt.), 86/72/211090.284 sq.mt.)
I	9	121.829	1096.465	81/72/1099.813 sq.mt.)
J	5	83.965	419.823	2/2(419.823 sq.mt.)
M1	1	87.320	87.320	8/2(76.31 sq.mt.), 9/1 (11.01 sq.mt.)
M2	1	146.100	146.100	9/1(146.06 sq.mt.)
M3	1	150.000	150.000	9/1 (150 sq.mt.)
M4	1	112.060	112.060	9/1 (112.09 sq.mt.)
M5	1	122.400	122.400	10/1 (113.85 sq.mt.)
Total	59	6441.46	6441.46	(1.591 acres) 20.24%

3218.523 Sqm. 3222.933 Sqm.

NOTE:- PLOTS FALL UNDER 11 K.V. LINE SHALL BE KEPT FREEZE TILL THE LINE OF SHIFTING.