

**DEMARCATON AREA STATEMENT FOR BLOCK -A-**  
**PLOTTED COLONY REWARI, SECTOR - 25 & 26, REWARI**

Sl. No.	Type	Size of Plot (sq. mtrs)	Plot Nos.	No. of Plots	Plot Area (sq. mtrs)
1.	B1	29.0 X 30.0	970.00	1	870.00
2.	DC	10.0 X 20.0	200.00	9	1800.00
3.	C	10.0 X 25.0	250.00	54	13500.00
4.	D	10.0 X 20.0	200.00	6	1200.00
5.	BC2	12.0 X 25.0	300.00	4	1200.00
6.	BC1	12.0 X 25.0	300.00	4	1200.00
<b>Total</b>					<b>20120.00</b>

**DEMARCATON AREA STATEMENT FOR BLOCK -B-**  
**PLOTTED COLONY REWARI, SECTOR - 25 & 26, REWARI**

Sl. No.	Type	Size of Plot (sq. mtrs)	Plot Nos.	No. of Plots	Plot Area (sq. mtrs)
1.	B1	29.0 X 30.0	870.00	1	870.00
2.	B	12.0 X 25.0	450.00	7	630.00
3.	BC	12.0 X 25.0	300.00	25	7500.00
4.	BC2	24.0 X 25.0	600.00	7	6300.00
5.	D	10.0 X 20.0	200.00	60	12000.00
6.	E	8.0 X 20.0	160.00	36	5760.00
7.	E1	24.0 X 40.0	960.00	3	2880.00
<b>Total</b>					<b>43470.00</b>

**DEMARCATON AREA STATEMENT FOR BLOCK -C-**  
**PLOTTED COLONY REWARI, SECTOR - 25 & 26, REWARI**

Sl. No.	Type	Size of Plot (sq. mtrs)	Plot Nos.	No. of Plots	Plot Area (sq. mtrs)
1.	F	4.0 X 12.5	50.00	61	3050.00
<b>Total</b>					<b>3050.00</b>

**DEMARCATON AREA STATEMENT FOR BLOCK -D-**  
**PLOTTED COLONY REWARI, SECTOR - 25 & 26, REWARI**

Sl. No.	Type	Size of Plot (sq. mtrs)	Plot Nos.	No. of Plots	Plot Area (sq. mtrs)
1.	B1	29.0 X 32.0	928.00	2	1856.00
2.	D	10.0 X 20.0	200.00	6	1200.00
3.	C	10.0 X 25.0	250.00	12	3000.00
<b>Total</b>					<b>7880.00</b>

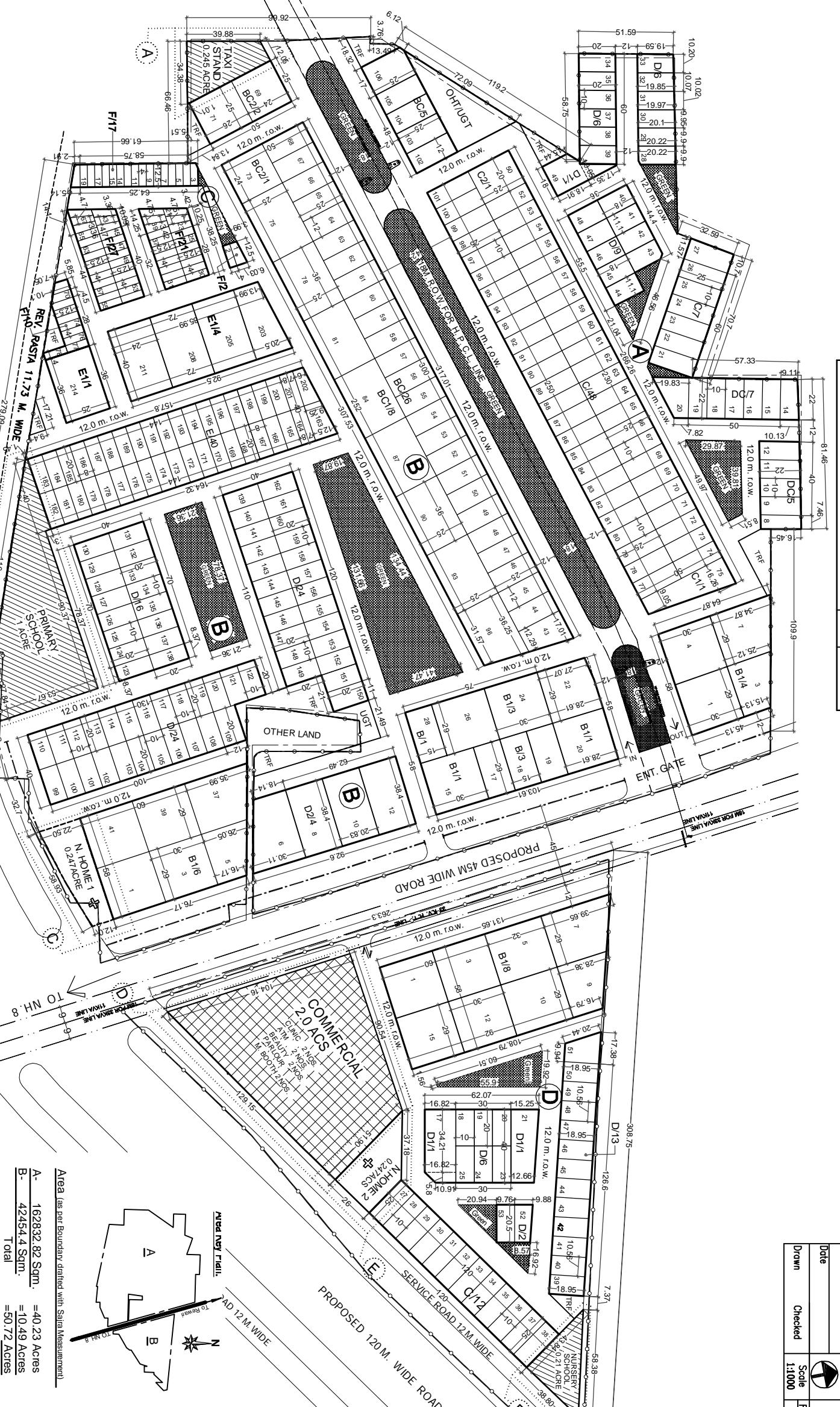

Sl. No.	Facility	Area (in acre)
1.	Commercial	2.0 Acre
2.	Nursery School	0.21 Acre
3.	Primary School	1.0 Acre
4.	Tank Stand	0.245 Acre
<b>Total</b>		<b>3.455 Acre</b>

1.	TIF	TRANSPORTER
2.	OHT	OVERHEAD TANK
3.	URT	UNDER GROUND TANK

1.	Scheme Boundary	Demarcation shown thru
2.	Undivided/Partial/Other's Land	
3.	Revenue Grid	
4.	Revenue Katcha	
<b>Developer :</b>		
<b>GURJITEK ESTATE PVT LTD.</b>		
SCO - 25, Sector - 31, Gurgaon		
Phone : 01244272596		
Email : gurjitek@rediffmail.com		
Title		
<b>Demarcation Plan of Tishan Vardika</b>		
Residential Development of TISHAN VARDIKA at Village		
Barama & Dhamela, Subsector at Sector 25-26		
<b>ARCHITECTS</b>		
Interior consultants pvt. Ltd.		
11415,1116,Shekhar Plaza A-3/BLCK,		
Shekhar Lod, Gurgaon, (Gurgaon/01055105991)		
Plot No: 10788 Email: info@interiorconsultants.com		
Tel: 011-22597188 Fax: 011-22597189 Web: www.interiorconsultants.com		

1.	Area (as per Boundary clarified with Salaria Measurement)	
2.	A- 162832.82 Sqm. = 40.23 Acres	
3.	B- 42454.4 Sqm. = 10.48 Acres	
4.	Total = 50.72 Acres	

Job No.:	North:	Drawing No.
Date:	Scale:	A 1/1a
Drawn:	Checked:	Scale
		Revisions
		R