

Fi Rm JE JB ATP DTP

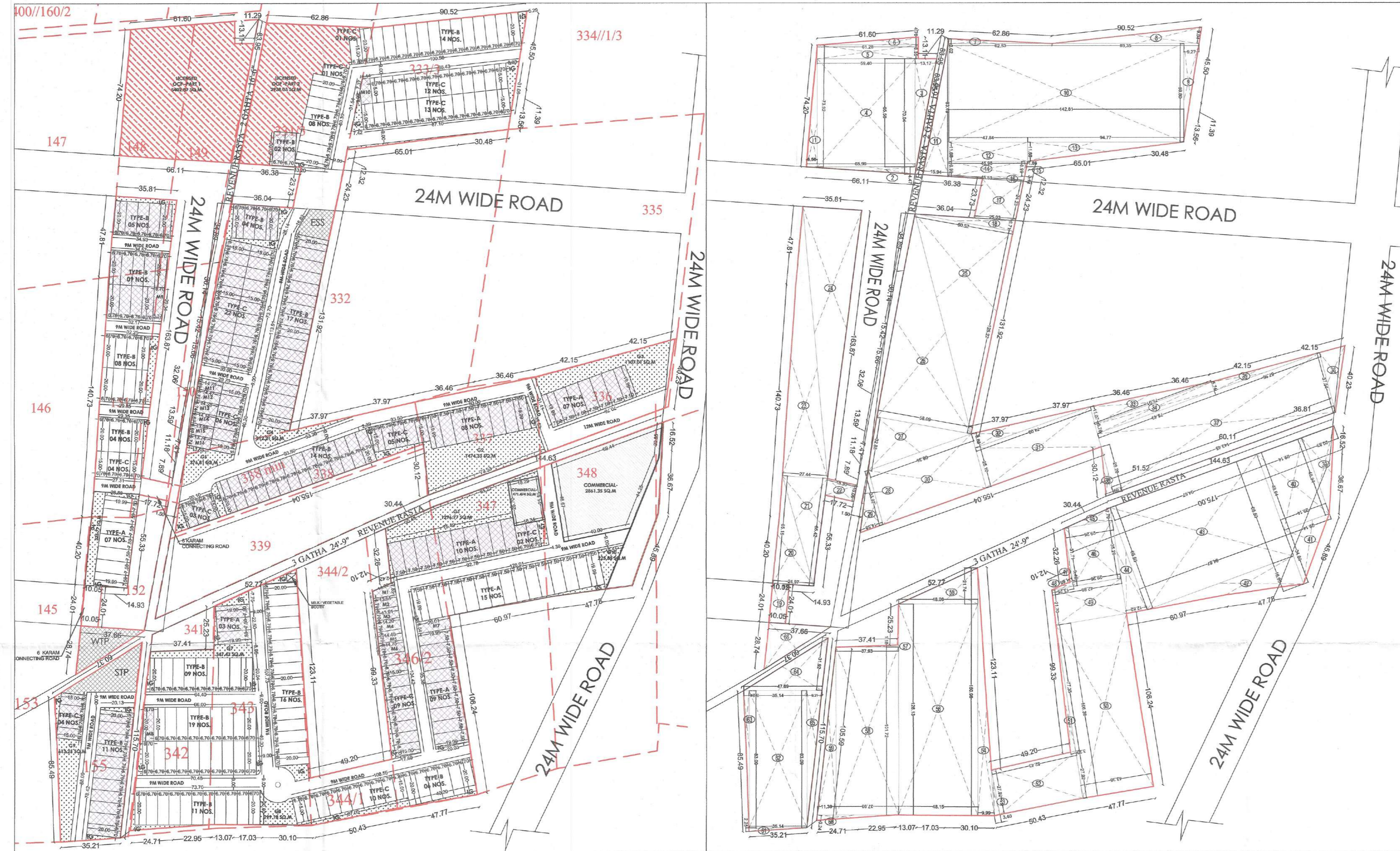

| SECTOR-37D | | | | | | |
|--|-------------|-----------|------------------------|----------|-----------|------------|
| 20.5890 | PERMISSIBLE | | | PROPOSED | | |
| | AREA | AREA | PERCENTAGE | AREA | AREA | PERCENTAGE |
| | ACRES | SQ.MTS. | % | ACRES | SQ.MTS. | % |
| TOTAL Licence Area | 20.5890 | 83320.595 | | 1.576 | 6378.650 | 7.66 |
| Open Area under GREEN/PARK | 1.544 | 6249.045 | 7.50 | 2.061 | 8340.900 | 10.01 |
| Community Facilities | 2.059 | 8332.059 | 10.00 | 0.824 | 3332.824 | 4.00 |
| Commercial Area (calculated on total licenced area) | 0.824 | 3332.824 | 4.00 | 0.824 | 3332.824 | 4.00 |
| Area Under Plots (calculated on total licenced area) | 12.559 | 50825.563 | 61.00 | 10.066 | 40736.045 | 48.89 |
| Total permissible Residential + Commercial area | 13.383 | 54158.387 | 65.00 | 10.890 | 44068.869 | 52.89 |
| Permissible Density | 240-400 ppa | | Minimum Required Plots | 274.52 | | |
| Achieved Density @ 18 persons per plot | 283.25 ppa | | Achieved Plots | 324.000 | | |

| LAND AREA CALCULATION | | | | | | GREEN AREA CALCULATION | | | | | |
|-----------------------|-----------|------------|-----------|-------------|--------------|------------------------|-----------------|------------|-----------|-------------|--------------|
| S.NO. | SHAPE | LENGTH (M) | WIDTH (M) | AREA (SQ.M) | CAL. FORMULA | S.NO. | SHAPE | LENGTH (M) | WIDTH (M) | AREA (SQ.M) | CAL. FORMULA |
| 1 | TRIANGLE | 6.56 | 73.92 | 242.438 | (LB)/2 | G1 | TRIANGLE | 30.67 | 6.29 | 96.827 | (LB)/2 |
| 2 | TRIANGLE | 65.86 | 4.47 | 147.421 | (LB)/2 | G2 | RECTANGLE | 75.74 | 9 | 681.660 | LXB |
| 3 | TRIANGLE | 13.17 | 70.04 | 461.233 | (LB)/2 | G3 | RECTANGLE | 44.65 | 6.29 | 280.849 | LXB |
| 4 | RECTANGLE | 59.40 | 65.55 | 3894.304 | LXB | G4 | TRIANGLE | 45.03 | 5.92 | 133.289 | (LB)/2 |
| 5 | RECTANGLE | 61.28 | 8.35 | 511.688 | LXB | G5 | RECTANGLE | 18.29 | 2.22 | 40.804 | LXB |
| 6 | TRIANGLE | 61.28 | 4.76 | 145.846 | (LB)/2 | G6 | RECTANGLE | 18.29 | 2.22 | 40.804 | LXB |
| 7 | TRIANGLE | 62.53 | 3.62 | 94.400 | (LB)/2 | G7 | RECTANGLE | 4.41 | 4.99 | 22.006 | (LB) |
| 8 | TRIANGLE | 89.35 | 9.94 | 444.070 | (LB)/2 | G8 | TRIANGLE | 67.79 | 10.1 | 342.340 | (LB)/2 |
| 9 | TRIANGLE | 9.27 | 59.8 | 277.373 | (LB)/2 | G9 | RECTANGLE | 69.57 | 15.6 | 1085.292 | (LB) |
| 10 | RECTANGLE | 142.63 | 59.8 | 8508.636 | LXB | G10 | TRIANGLE | 3.96 | 15.6 | 30.886 | (LB)/2 |
| 11 | TRIANGLE | 15.94 | 83.49 | 665.415 | (LB)/2 | G11 | TRIANGLE | 52.5 | 3.92 | 102.900 | (LB)/2 |
| 12 | RECTANGLE | 47.84 | 11.68 | 558.771 | LXB | G12 | RECTANGLE | 52.5 | 6.91 | 362.775 | LXB |
| 13 | RECTANGLE | 94.7 | 11.68 | 1100.872 | LXB | G13 | TRIANGLE | 29.95 | 2.58 | 38.687 | (LB)/2 |
| 14 | RECTANGLE | 45.98 | 8.99 | 413.860 | LXB | G14 | TRIANGLE | 11.73 | 24.33 | 142.695 | (LB)/2 |
| 15 | TRIANGLE | 1.85 | 8.99 | 8.361 | (LB)/2 | G15 | RECTANGLE | 18.26 | 28.53 | 442.266 | (LB) |
| 16 | TRIANGLE | 65.33 | 3.34 | 71.451 | (LB)/2 | G16 | TRIANGLE | 39.9 | 4.83 | 96.959 | (LB)/2 |
| 17 | RECTANGLE | 25.03 | 24.23 | 606.477 | (LB) | G17 | TRIANGLE | 2.09 | 1.27 | 1.327 | (LB)/2 |
| 18 | TRIANGLE | 60.52 | 6.71 | 203.045 | (LB)/2 | G18 | RECTANGLE | 2.09 | 4.83 | 10.095 | (LB) |
| 19 | RECTANGLE | 10.12 | 24.01 | 162.803 | LXB | G19 | TRIANGLE | 3.7 | 7.14 | 13.209 | (LB)/2 |
| 20 | TRIANGLE | 24.97 | 65.15 | 813.398 | (LB)/2 | G20 | TRIANGLE | 9.88 | 6 | 29.640 | (LB)/2 |
| 21 | TRIANGLE | 27.44 | 65.42 | 897.562 | (LB)/2 | G21 | RECTANGLE | 17.56 | 7.14 | 125.378 | (LB) |
| 22 | RECTANGLE | 18.30 | 10.06 | 184.098 | (LB) | G22 | IRREGULAR SHAPE | --- | --- | --- | (LB)/2 |
| 23 | TRIANGLE | 27.44 | 163.58 | 2244.318 | (LB)/2 | G23 | TRIANGLE | 28.66 | 24.74 | 329.794 | (LB)/2 |
| 24 | TRIANGLE | 35.81 | 163.87 | 2934.092 | (LB)/2 | G24 | IRREGULAR SHAPE | --- | --- | --- | (LB)/2 |
| 25 | TRIANGLE | 65.52 | 125.22 | 3789.157 | (LB)/2 | G25 | IRREGULAR SHAPE | --- | --- | --- | (LB)/2 |
| 26 | TRIANGLE | 58.09 | 125.17 | 3635.569 | (LB)/2 | G26 | RECTANGLE | 22.65 | 2.66 | 60.249 | LXB |
| 27 | TRIANGLE | 58.09 | 32.88 | 955.000 | (LB)/2 | G27 | TRIANGLE | 60.82 | 1.91 | 58.083 | (LB)/2 |
| 28 | RECTANGLE | 1.50 | 10.09 | 15.335 | LXB | G28 | RECTANGLE | 60.82 | 3.71 | 225.642 | (LB) |
| 29 | TRIANGLE | 14.58 | 33.07 | 247.641 | (LB)/2 | G29 | IRREGULAR SHAPE | --- | --- | --- | (LB)/2 |
| 30 | RECTANGLE | 66.36 | 33.97 | 2254.249 | LXB | G30 | IRREGULAR SHAPE | --- | --- | --- | (LB)/2 |
| 31 | RECTANGLE | 74.09 | 25.10 | 1859.659 | LXB | G31 | TRIANGLE | 3.26 | 15.74 | 25.656 | (LB)/2 |
| 32 | TRIANGLE | 74.09 | 8.88 | 328.900 | (LB)/2 | G32 | RECTANGLE | 18.69 | 12.89 | 240.914 | LXB |
| 33 | TRIANGLE | 75.01 | 11.07 | 415.189 | (LB)/2 | G33 | RECTANGLE | 6.79 | 60.36 | 410.050 | LXB |
| 34 | RECTANGLE | 75.49 | 5.76 | 434.822 | LXB | G34 | TRIANGLE | 7.37 | 60.36 | 222.427 | (LB)/2 |
| 35 | TRIANGLE | 67.86 | 5.74 | 195.045 | (LB)/2 | G35 | TRIANGLE | 15.51 | 27.75 | 215.201 | (LB)/2 |
| 36 | TRIANGLE | 16.01 | 37.55 | 300.588 | (LB)/2 | G36 | RECTANGLE | 6.75 | 55.12 | 372.050 | (LB) |
| 37 | RECTANGLE | 143.45 | 37.55 | 5385.548 | LXB | TOTAL | | | | 6378.65 | |
| 38 | TRIANGLE | 4.99 | 28.38 | 138.900 | (LB)/2 | | | | | | |
| 39 | TRIANGLE | 20.83 | 48.94 | 509.7101 | (LB)/2 | | | | | | |
| 40 | RECTANGLE | 29.34 | 48.94 | 1426.3116 | LXB | | | | | | |
| 41 | TRIANGLE | 25.34 | 34.69 | 305.4939 | (LB)/2 | | | | | | |
| 42 | TRIANGLE | 94.67 | 16.95 | 802.32925 | (LB)/2 | | | | | | |
| 43 | RECTANGLE | 94.67 | 65.59 | 6209.4033 | (LB) | | | | | | |
| 44 | TRIANGLE | 12.82 | 66.59 | 420.039 | (LB)/2 | | | | | | |
| 45 | TRIANGLE | 29.26 | 7.79 | 113.89771 | (LB)/2 | | | | | | |
| 46 | RECTANGLE | 29.26 | 35.29 | 1032.884 | (LB) | | | | | | |
| 47 | TRIANGLE | 1.60 | 31.71 | 26.19079 | (LB)/2 | | | | | | |
| 48 | TRIANGLE | 13.25 | 3.49 | 23.12251 | (LB)/2 | | | | | | |
| 49 | RECTANGLE | 42.88 | 21.70 | 930.485 | (LB) | | | | | | |
| 50 | RECTANGLE | 43.26 | 109.38 | 4632.698 | (LB) | | | | | | |
| 51 | TRIANGLE | 3.29 | 72.15 | 124.02025 | (LB)/2 | | | | | | |
| 52 | RECTANGLE | 52.43 | 27.92 | 1463.95045 | (LB) | | | | | | |
| 53 | TRIANGLE | 3.4 | 27.92 | 47.464 | (LB)/2 | | | | | | |
| 54 | TRIANGLE | 9.89 | 159.95 | 784.045 | (LB)/2 | | | | | | |
| 55 | TRIANGLE | 48.08 | 21.74 | 522.6295 | (LB)/2 | | | | | | |
| 56 | RECTANGLE | 48.15 | 128.13 | 6169.4935 | (LB) | | | | | | |
| 57 | TRIANGLE | 37.93 | 1.18 | 22.7107 | (LB)/2 | | | | | | |
| 58 | RECTANGLE | 37.93 | 101.72 | 3858.2395 | (LB) | | | | | | |
| 59 | TRIANGLE | 11.39 | 101.72 | 579.2954 | (LB)/2 | | | | | | |
| 60 | TRIANGLE | 46.31 | 3.4 | 75.9647 | (LB)/2 | | | | | | |
| 61 | TRIANGLE | 35.14 | 2.25 | 38.9325 | (LB)/2 | | | | | | |
| 62 | RECTANGLE | 35.14 | 83.09 | 2919.7826 | (LB) | | | | | | |
| 63 | TRIANGLE | 3.24 | 83.09 | 134.6628 | (LB)/2 | | | | | | |
| 64 | TRIANGLE | 47.69 | 31.92 | 761.1344 | (LB)/2 | | | | | | |
| 65 | TRIANGLE | 9.31 | 83.09 | 386.7835 | (LB)/2 | | | | | | |
| 66 | TRIANGLE | 37.66 | 28.74 | 541.1742 | (LB)/2 | | | | | | |
| TOTAL | | | | 80047.819 | | | | | | | |

| VEGETABLE/ MILK BOOTH | MTS. | MTS. | SQ.MTS. |
|-----------------------|------|------|---------|
| | 6.02 | 4.36 | 26.25 |
| TOTAL | | | 26.25 |

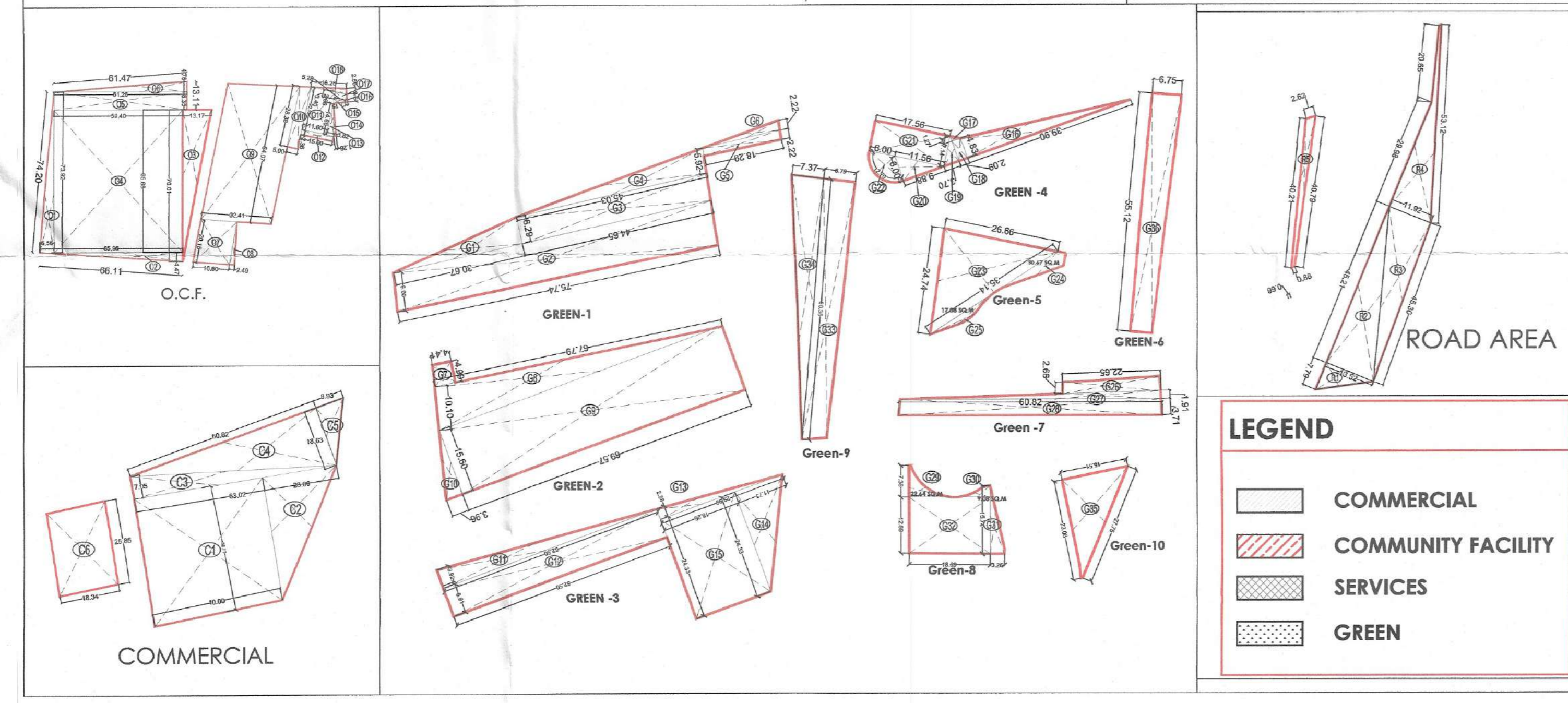

| COMMERCIAL AREA CALCULATION | | | | | |
|-----------------------------|-----------|------------|-----------|-------------|--------------|
| S.NO. | SHAPE | LENGTH (M) | WIDTH (M) | AREA (SQ.M) | CAL. FORMULA |
| C1 | RECTANGLE | 40.00 | 38.77 | 1550.60 | LXB |
| C2 | TRIANGLE | 23.06 | 38.00 | 438.13688 | (LB)/2 |
| C3 | TRIANGLE | 63.03 | 7.05 | 222.1465 | (LB)/2 |
| C4 | TRIANGLE | 60.62 | 18.63 | 564.6753 | (LB)/2 |
| C5 | TRIANGLE | 8.93 | 18.63 | 83.18295 | (LB)/2 |
| C6 | RECTANGLE | 18.34 | 25.85 | 474.089 | LXB |
| TOTAL | | | | 3332.824 | |

| ROAD AREA CALCULATION | | | | | |
|-----------------------|-----------------|------------|-----------|-------------|--------------|
| S.NO. | SHAPE | LENGTH (M) | WIDTH (M) | AREA (SQ.M) | CAL. FORMULA |
| R1 | TRIANGLE | 13.52 | 7.79 | 52.660 | (LB)/2 |
| R2 | TRIANGLE | 13.52 | 45.21 | 305.620 | (LB)/2 |
| R3 | TRIANGLE | 11.92 | 45.30 | 269.386 | (LB)/2 |
| R4 | IRREGULAR SHAPE | --- | --- | 225.390 | --- |
| R5 | IRREGULAR SHAPE | --- | --- | 65.140 | --- |
| TOTAL | | | | 919.338 | |

| GREEN AREA CALCULATION | | |
|------------------------|----------|-------|
| | SQ.M. | ACRES |
| G1 | 1296.770 | 0.320 |
| G2 | 1474.330 | 0.364 |
| G3 | 1107.010 | 0.274 |
| G4 | 312.210 | 0.077 |
| G5 | 376.810 | 0.093 |
| G6 | 325.770 | 0.080 |
| G7 | 347.470 | 0.086 |
| G8 | 299.180 | 0.074 |
| G9 | 613.250 | 0.152 |
| G10 | 225.850 | 0.056 |
| TOTAL | 6378.650 | 1.576 |

| CLASSIFICATION OF PLOTS | | | | | |
|-------------------------|--------------|----------------|--------------|---------------------|----------|
| TYPE | SIZE OF PLOT | AREA OF PLOT | NO. OF PLOTS | TOTAL AREA OF PLOTS | |
| | MTS. | MTS. | SQ.MTS. | SQ.MTS. | |
| A | 7.50 | 19.99 | 149.93 | 59 | 8845.58 |
| B | 6.70 | 20.00 | 134.00 | 157 | 21038.00 |
| C | 6.70 | 15.00 | 100.50 | 92 | 9246.00 |
| M | | IRREGULAR SIZE | 16 | 1606.47 | |
| TOTAL | | | 324 | 40736.05 | |

| CLASSIFICATION OF FROZEN PLOTS | | | | | |
|--------------------------------|--------------|----------------|--------------|---------------------|----------|
| TYPE | SIZE OF PLOT | AREA OF PLOTS | NO. OF PLOTS | TOTAL AREA OF PLOTS | |
| | MTS. | MTS. | SQ.MTS. | SQ.MTS. | |
| A | 7.50 | 19.99 | 149.925 | 37 | 5547.225 |
| B | 6.70 | 20.00 | 134.000 | 62 | 8308.000 |
| C | 6.70 | 15.00 | 100.500 | 51 | 5125.500 |
| MISC. | | IRREGULAR SIZE | 16 | 1606.47 | |
| TOTAL | | | 166 | 20587.195 | |

| O.C.F. AREA CALCULATION | | | | | |
|-------------------------|-----------|------------|-----------|-------------|--------------|
| S.NO. | SHAPE | LENGTH (M) | WIDTH (M) | AREA (SQ.M) | CAL. FORMULA |
| O1 | TRIANGLE | 6.56 | 73.92 | 242.438 | (LB)/2 |
| O2 | TRIANGLE | 65.86 | 4.47 | 147.322 | (LB)/2 |
| O3 | TRIANGLE | 13.17 | 70.01 | 461.016 | (LB)/2 |
| O4 | RECTANGLE | 59.40 | 65.88 | 3901.392 | LXB |
| O5 | RECTANGLE | 61.28 | 8.35 | 511.688 | LXB |
| O6 | TRIANGLE | 61.28 | 4.76 | 145.846 | (LB)/2 |
| O7 | RECTANGLE | 16.5 | 20.15 | 334.890 | (LB) |
| O8 | TRIANGLE | 2.49 | 20.15 | 25.087 | (LB)/2 |
| O9 | RECTANGLE | 32.41 | 64.073 | 2076.606 | (LB) |
| O10 | RECTANGLE | 5.00 | 28.38 | 141.900 | (LB) |
| O11 | RECTANGLE | 11.6 | 20.12 | 233.392 | (LB) |
| O12 | RECTANGLE | 15.00 | 2.36 | 35.400 | (LB) |
| O13 | TRIANGLE | 3.82 | 14.66 | 28.001 | (LB)/2 |
| O14 | TRIANGLE | 1.26 | 14.66 | 9.236 | (LB)/2 |
| O15 | TRIANGLE | 5.28 | 2.06 | 5.438 | (LB)/2 |
| O16 | TRIANGLE | 1.15 | 3.57 | 2.053 | (LB)/2 |
| O17 | RECTANGLE | 5.28 | 3.4 | 17.952 | (LB) |
| O18 | TRIANGLE | 16.26 | 2.66 | 21.626 | (LB)/2 |
| TOTAL | | | | 8340.90 | |

PROJECT NAME AND ADDRESS:
LAYOUT PLAN OF PROPOSED RESIDENTIAL PLOTTED COLONY UNDER DDJAY, IN SECTOR-37D, GURGAON, OVER AN AREA OF 20.586 ACRES BEING DEVELOPED BY SIGNATURE GLOBAL DEVELOPERS PVT. LTD

OWNER'S NAME:
M/S SIGNATURE GLOBAL DEVELOPERS PVT. LTD

OWNER'S NAME:
SITE DEMARCATION PLAN

OWNER'S SIGNATURE:

