

DTP
ATP
JD
JE
PAT

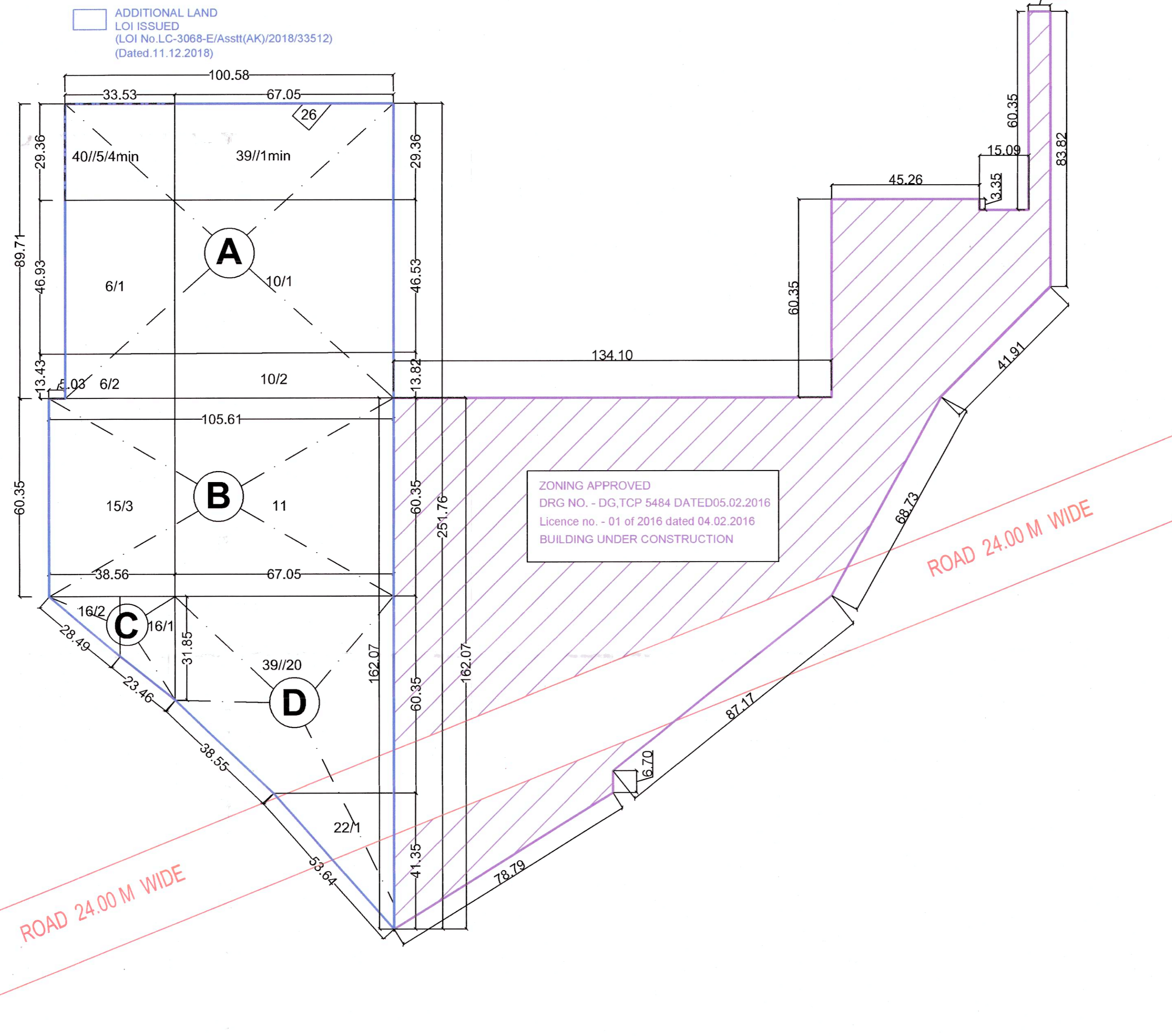

PLOT AREA	=	5.00	ACRES				=	20235.000	SQM
AREA UNDER ZONNING								AREA	
A	100.58	X	89.71				=	9023.032	SQM
B	60.35	X	105.61				=	6373.564	SQM
C	38.56	X	31.85	+ 2			=	614.068	SQM
D	31.85	+	94.16	+ 2	X	67.050	=	4224.485	SQM
TOTAL								20235.149	SQM
								5.000	ACRES

AREA UNDER 24.0M WIDE ROAD

E	16.68	+	26.51	+ 2	X	24.000	=	518.280	SQM
F	11.32	X	24.00	+ 2			=	135.840	SQM
TOTAL								654.120	SQM
								0.162	ACRES
NET PLANNED AREA		=	5.000	-	0.162	=	4.838	ACRES	

PRODUCED BY AN AUTODESK EDUCATIONAL PRODUCT

PRODUCED BY AN AUTODESK EDUCATIONAL PRODUCT

ROAD AREA

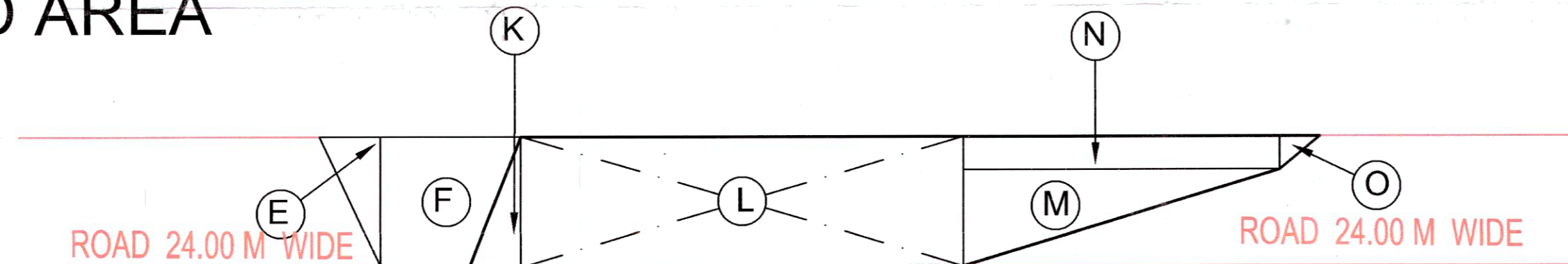

NOTE- ALL Dimensions are in mt.

PROJECT NAME & ADDRESS :
Demarcation plan of Affordable Group Housing colony for an additional granted (LOI No.LC-3068-E/Asstt(AK)/2018/33512 Dated.11.12.2018) over an area measuring 5.00 acres,abutting already licence granted land bearing licence No. 1-04-16.

Falling in the Revenue Estate of Village Hayatpur, Sector-93, Gurugram being developed by M/s Signature Builders Private Limited.

OWNER NAME :
M/s Signature Builders Private Limited.

ARCHITECT'S SIGNATURE :
Manoj Malhotra

REVISION :

DRAWING TITLE :
DEMARCATON PLAN

A1 SIZE

NORTH :

SCALE : **1:1000**