

- NOTE:-
1. ALL DIMENSIONS ARE IN METERS
 2. NO PROJECTION /CANTILEVER ALLOWED IN THE REAR SETBACK

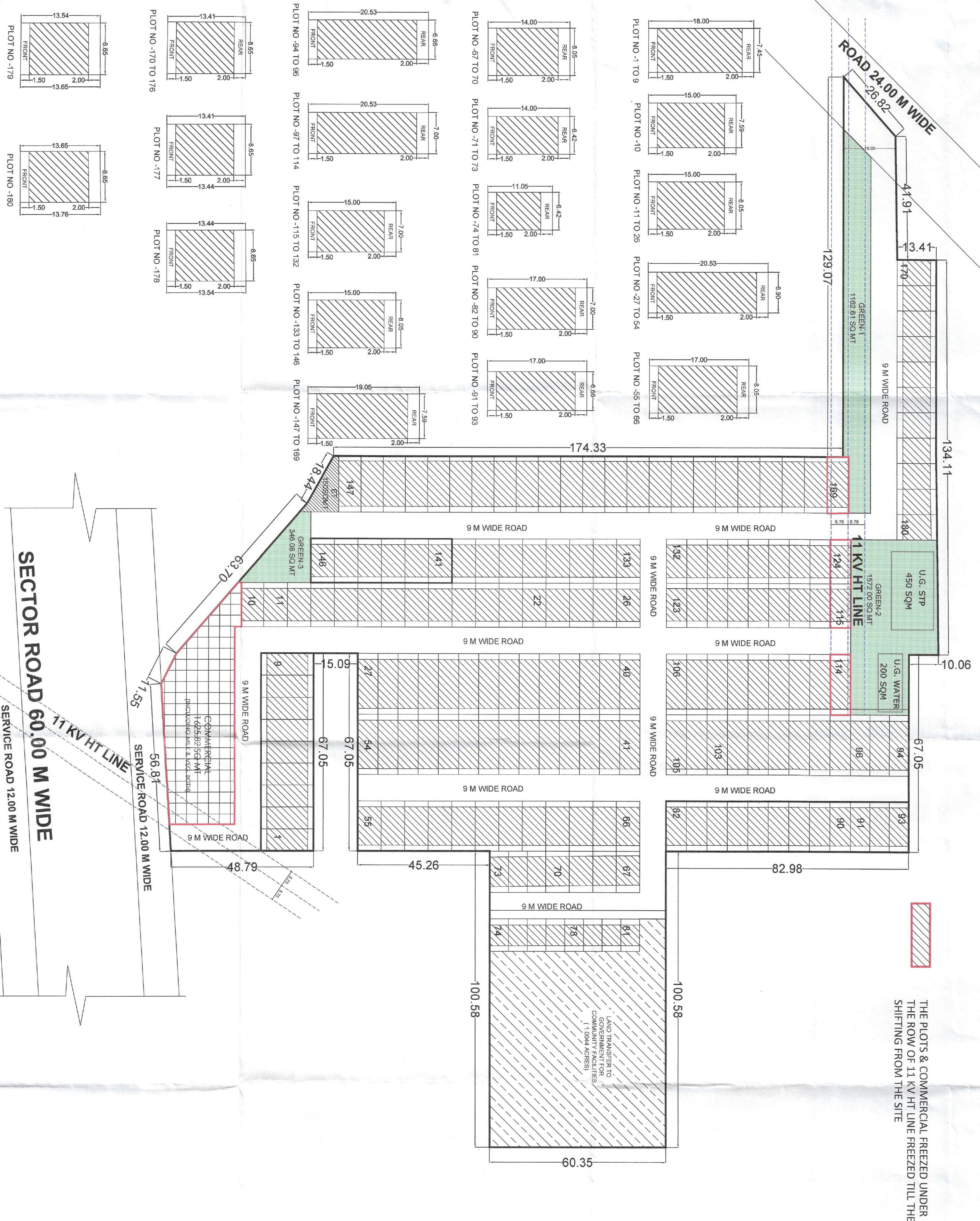

ZONING PLAN OF AFFORDABLE RESIDENTIAL PLOTTED COLONY (UNDER DEEN DAYAL JAN AWAS YOJNA-2016) MEASURING 10.04375 ACRES (LICENCE NO. 109 OF 2022 DATED 05.08.2022) IN SECTOR-4, SOHNA, BEING DEVELOPED BY V. K. DEVELOPERS.

FOR PURPOSE OF CODE 1.2 (kvv) & 6.1 (1) OF THE HARYANA BUILDING CODE, 2017, AS AMENDED FROM TIME TO TIME.

1. USE ZONE

The land shown in this zoning plan shall be utilized in accordance with the marking explained in the table below and no other manner whatsoever:

Notation	Permissible use of land on the portion of the plot marked in column 1	Type of building permissible on land marked in column 1.	
1.	Road	Road furniture at approved places.	
	Public open space	To be used only for landscape features.	
	Residential Buildable Zone	Residential building.	
	Commercial	As per supplementary zoning plan to be approved separately for each site.	

2. MAXIMUM PERMISSIBLE GROUND COVERAGE BASEMENT, FAR AND MAXIMUM PERMISSIBLE HEIGHT / INCLUDING STILL PARKING

Plot Area upto 150 square metres	Maximum Permissible Ground Coverage 75%	Permissible Basement Single level	Maximum Permissible Floor Area Ratio (FAR) 200%	Maximum permissible Height (G+3 Floor) (including still (S+4 floor)) 18.5 metres
----------------------------------	---	-----------------------------------	---	--

3. PERMISSIBLE NUMBER OF DWELLING UNIT ON EACH PLOT

Not more than four dwelling units shall be allowed on each plot as per the terms and conditions of policy circulated vide memo no. Misc-149/2019/7/03/2019/2/TCP dated 07.03.2019.

4. BAR ON SUB-DIVISION OF PLOT

Sub-division & clubbing of the plots shall not be permitted any circumstances.

5. BUILDING SETBACK

Building other than boundary wall and gates shall be constructed only within the portion of the site marked as residential buildable zone in clause number 1 above. The cantilever projections as allowed in Haryana Building Code, 2017 shall not project beyond the portion marked as residential buildable zone in rear side.

6. HEIGHT OF THE BUILDING AND PERMISSIBLE NUMBER OF STOREY

The maximum height and number of storey shall be allowed on the plot as per provisions of Haryana Building Code, 2017.

7. STILL PARKING

Stilt parking is allowed in all sizes plots. The clear height of the stilt shall be 2.40 metres from the plinth level and below the bottom of the beam. The Stilt will not be permissible for any purpose other than parking.

8. PARKING

Parking shall be provided as per the provisions of Haryana Building Code - 2017, as amended from time to time.

9. PLINTH LEVEL

The plinth height of building shall be as per Code No. 7.3 of the Haryana Building Code, 2017.

10. BASEMENT

Single level basements within the building zone of the site shall be provided as per Code 6.3(3)(i)(a) and shall be constructed, used and maintained as per Code 7.16 of the Haryana Building Code, 2017.

11. RESTRICTION OF ACCESS FROM 45 MTS. WIDE OR MORE SECTOR ROADS AND PUBLIC OPEN SPACES

In the case of plots which about on the 45 meters or more wide sector roads and plots which about on public open spaces, no direct access whatsoever secondary or main shall be allowed into the plots from such roads and open spaces.

12. BOUNDARY WALL

(a) The boundary wall shall be constructed as per Code 7.5.
 (b) The boundary walls in front courtyard which about on a road or an open space shall be constructed according to standard design as approved by the DG/CP. The boundary wall in the rear courtyard shall not be more than 1.80 meters in height.
 (c) In case of corner plots, boundary walls shall be rounded off at such corner by a radius as given below:-
 i). 0.5 meters Radius for plots opening on to open space.
 ii). 1.0 meters Radius for plots upto 125 sq. meters.
 iii). 1.50 meters Radius for plots above 125 sq. meters.
 (d) The owner/applicant if desires, is permitted to not construct boundary wall in front of plot, so that the said area can be utilized for parking.

13. GATE AND GATE POST

a) Gate and gate post shall be constructed as per approved standard design, at the position indicated on the zoning plan.
 b) An additional wicket gate or standard design not exceeding 1.15 meter width may be allowed in the front and side boundary wall provided further that no gate shall be allowed in the rear boundary wall or towards the sector road and public open space.

14. DISPLAY OF POSTAL NUMBER OF THE PLOT

The premises number and postal address shall be written at the space shown for this purpose on the standard design of the gates as per approved design.

15. GARBAGE COLLECTION POINT

Every plot holder shall make adequate provision for garbage collection in his own plot and make suitable arrangement for disposal at the towable collection point to be provided by the colonizer.

16. ACCESS

No plot or public building will derive an access from less than 9.00 meters wide road.

1. GENERAL

(i) That the coloniser/owner shall use only Light-Emitting Diode lamps (LED) fitting for internal lighting as well as Campus lighting.
 (ii) That the coloniser/owner shall strictly comply with the directions issued vide Notification No. 19/6/2016-SP dated 31.03.2016 issued by Haryana Government Renewable Energy Department, if applicable.
 (iii) That the coloniser/owner shall ensure the installation of Solar Photovoltaic Power Plant as per the provisions of order No. 22/52/2005-SPower dated 21.03.2016 issued by Haryana Government Renewable Energy Department, if applicable.
 (iv) Fire safety protection measures shall be regulated by Haryana fire service Act, 2006 as amended from time to time.
 (v) Rain water harvesting shall be provided as per HBC-2017 (if applicable)

Note: Read this drawing in conjunction with the demarcation plan verified by D.T.P. Gurgaon vide Enrol no. 11426 dated 21.09.2022

DRG. NO. DG:TCP 8-770 DATED 28-11-2022

(RAM AYFAR BASSI) JD(HQ) (SAMJAY NARANG) ATP (HQ) (R.S.BATHI) DTP(HQ) (HITESH SHARMA) STP(HQ) (P.P.SINGH) CTR(HQ) (T.L.SATYAPRAKASH, IAS) DG, ICP(HR)