

Revenue Rasta
2 Karam wide

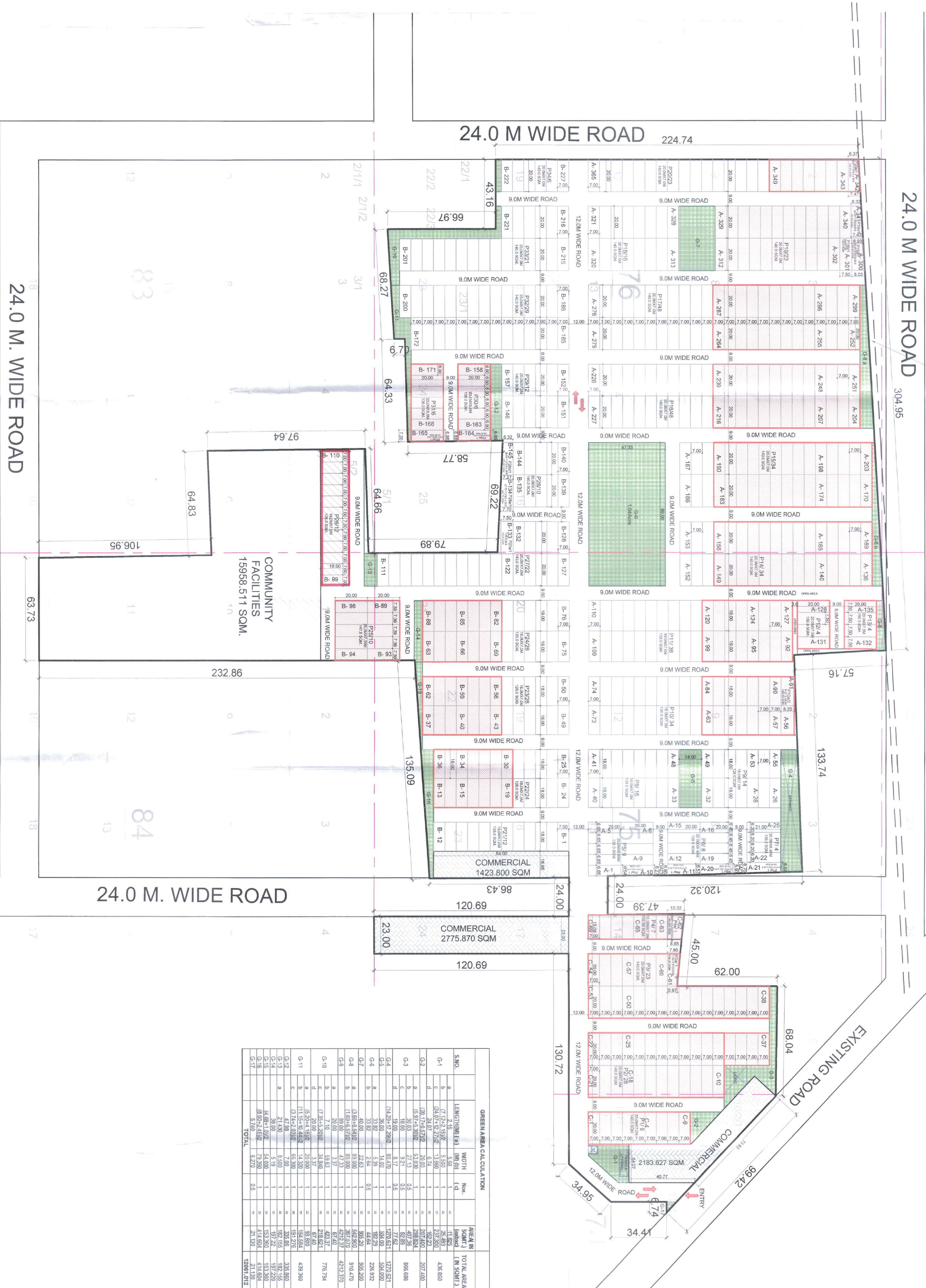

LAYOUT PLAN

- LEGEND**
- COMMUNITY FACILITIES
 - ORGANIZED OPEN SPACE
 - COMMERCIAL AREA

NOTE : AREA UNDER 24.0M WIDE SECTOR ROAD FALSE IN
KHASRA NO. 75// 14 = 24.0 X 24.0 = 576 SQM.

GREEN AREA CALCULATION

S.NO.	LAND USE	WIDTH	NO.	AREA IN SQM	TOTAL AREA
0-1	2.10	1	1	2.10	2.10
0-2	1.50	1	1	1.50	1.50
0-3	1.50	1	1	1.50	1.50
0-4	1.50	1	1	1.50	1.50
0-5	1.50	1	1	1.50	1.50
0-6	1.50	1	1	1.50	1.50
0-7	1.50	1	1	1.50	1.50
0-8	1.50	1	1	1.50	1.50
0-9	1.50	1	1	1.50	1.50
0-10	1.50	1	1	1.50	1.50
0-11	1.50	1	1	1.50	1.50
0-12	1.50	1	1	1.50	1.50
0-13	1.50	1	1	1.50	1.50
0-14	1.50	1	1	1.50	1.50
0-15	1.50	1	1	1.50	1.50
0-16	1.50	1	1	1.50	1.50
0-17	1.50	1	1	1.50	1.50
0-18	1.50	1	1	1.50	1.50
0-19	1.50	1	1	1.50	1.50
0-20	1.50	1	1	1.50	1.50
0-21	1.50	1	1	1.50	1.50
0-22	1.50	1	1	1.50	1.50
0-23	1.50	1	1	1.50	1.50
0-24	1.50	1	1	1.50	1.50
0-25	1.50	1	1	1.50	1.50
0-26	1.50	1	1	1.50	1.50
0-27	1.50	1	1	1.50	1.50
0-28	1.50	1	1	1.50	1.50
0-29	1.50	1	1	1.50	1.50
0-30	1.50	1	1	1.50	1.50
0-31	1.50	1	1	1.50	1.50
0-32	1.50	1	1	1.50	1.50
0-33	1.50	1	1	1.50	1.50
0-34	1.50	1	1	1.50	1.50
0-35	1.50	1	1	1.50	1.50
0-36	1.50	1	1	1.50	1.50
0-37	1.50	1	1	1.50	1.50
0-38	1.50	1	1	1.50	1.50
0-39	1.50	1	1	1.50	1.50
0-40	1.50	1	1	1.50	1.50
0-41	1.50	1	1	1.50	1.50
0-42	1.50	1	1	1.50	1.50
0-43	1.50	1	1	1.50	1.50
0-44	1.50	1	1	1.50	1.50
0-45	1.50	1	1	1.50	1.50
0-46	1.50	1	1	1.50	1.50
0-47	1.50	1	1	1.50	1.50
0-48	1.50	1	1	1.50	1.50
0-49	1.50	1	1	1.50	1.50
0-50	1.50	1	1	1.50	1.50
0-51	1.50	1	1	1.50	1.50
0-52	1.50	1	1	1.50	1.50
0-53	1.50	1	1	1.50	1.50
0-54	1.50	1	1	1.50	1.50
0-55	1.50	1	1	1.50	1.50
0-56	1.50	1	1	1.50	1.50
0-57	1.50	1	1	1.50	1.50
0-58	1.50	1	1	1.50	1.50
0-59	1.50	1	1	1.50	1.50
0-60	1.50	1	1	1.50	1.50
0-61	1.50	1	1	1.50	1.50
0-62	1.50	1	1	1.50	1.50
0-63	1.50	1	1	1.50	1.50
0-64	1.50	1	1	1.50	1.50
0-65	1.50	1	1	1.50	1.50
0-66	1.50	1	1	1.50	1.50
0-67	1.50	1	1	1.50	1.50
0-68	1.50	1	1	1.50	1.50
0-69	1.50	1	1	1.50	1.50
0-70	1.50	1	1	1.50	1.50
0-71	1.50	1	1	1.50	1.50
0-72	1.50	1	1	1.50	1.50
0-73	1.50	1	1	1.50	1.50
0-74	1.50	1	1	1.50	1.50
0-75	1.50	1	1	1.50	1.50
0-76	1.50	1	1	1.50	1.50
0-77	1.50	1	1	1.50	1.50
0-78	1.50	1	1	1.50	1.50
0-79	1.50	1	1	1.50	1.50
0-80	1.50	1	1	1.50	1.50
0-81	1.50	1	1	1.50	1.50
0-82	1.50	1	1	1.50	1.50
0-83	1.50	1	1	1.50	1.50
0-84	1.50	1	1	1.50	1.50
0-85	1.50	1	1	1.50	1.50
0-86	1.50	1	1	1.50	1.50
0-87	1.50	1	1	1.50	1.50
0-88	1.50	1	1	1.50	1.50
0-89	1.50	1	1	1.50	1.50
0-90	1.50	1	1	1.50	1.50
0-91	1.50	1	1	1.50	1.50
0-92	1.50	1	1	1.50	1.50
0-93	1.50	1	1	1.50	1.50
0-94	1.50	1	1	1.50	1.50
0-95	1.50	1	1	1.50	1.50
0-96	1.50	1	1	1.50	1.50
0-97	1.50	1	1	1.50	1.50
0-98	1.50	1	1	1.50	1.50
0-99	1.50	1	1	1.50	1.50
0-100	1.50	1	1	1.50	1.50
TOTAL				1500.00	1500.00

AREA CHART

S.NO	DISCRIPTION	AREA IN ACRES	AREA IN SQM	PERCENTAGE
1	TOTAL LICENCE AREA	38.4325	159572.354	100%
2	NET PLANNED AREA	34.9324	142437.437	90.93%
3	MAX PERMISSIBLE AREA OF UNDER RES. PLOTTING (61% OF 38.4325 ACRES)	23.4518	95000.000	61.03%
4	PROPOSED AREA UNDER RES. PLOTTING	24.0531	97339.156	62.61%
5	RECORDED AREA FOR COMMON FACILITIES (10% OF 38.4325 ACRES)	3.8432	15542.235	10.00%
6	PROVIDED AREA FOR COMMON FACILITIES TO BE	3.5431	14243.743	9.22%
7	PROVIDED GREEN AREA (7.5% OF 38.4325 ACRES)	2.8824	11672.187	7.50%
8	PROVIDED GREEN AREA	2.5914	10365.512	6.74%
9	PERMISSIBLE AREA UNDER COMMERCIAL	4.0003	16187.467	10.41%
10	PROPOSED AREA UNDER COMMERCIAL	1.9714	7884.297	5.13%

FLORID AREA CHART

PILOT TYPE	PILOT NO.	WIDTH	LENGTH	AREA	NO OF PLOTS	AREA IN SQM	PERCENTAGE
P1	C17-C27	7.000	20.000	140.000	28	140.000	0.87%
P2	C28-C37	7.000	20.000	140.000	28	140.000	0.87%
P3	C38-C47	7.000	20.000	140.000	28	140.000	0.87%
P4	C48-C57	7.000	20.000	140.000	28	140.000	0.87%
P5	C58-C67	7.000	20.000	140.000	28	140.000	0.87%
P6	C68-C77	7.000	20.000	140.000	28	140.000	0.87%
P7	C78-C87	7.000	20.000	140.000	28	140.000	0.87%
P8	C88-C97	7.000	20.000	140.000	28	140.000	0.87%
P9	C98-C107	7.000	20.000	140.000	28	140.000	0.87%
P10	C108-C117	7.000	20.000	140.000	28	140.000	0.87%
P11	C118-C127	7.000	20.000	140.000	28	140.000	0.87%
P12	C128-C137	7.000	20.000	140.000	28	140.000	0.87%
P13	C138-C147	7.000	20.000	140.000	28	140.000	0.87%
P14	C148-C157	7.000	20.000	140.000	28	140.000	0.87%
P15	C158-C167	7.000	20.000	140.000	28	140.000	0.87%
P16	C168-C177	7.000	20.000	140.000	28	140.000	0.87%
P17	C178-C187	7.000	20.000	140.000	28	140.000	0.87%
P18	C188-C197	7.000	20.000	140.000	28	140.000	0.87%
P19	C198-C207	7.000	20.000	140.000	28	140.000	0.87%
P20	C208-C217	7.000	20.000	140.000	28	140.000	0.87%
P21	C218-C227	7.000	20.000	140.000	28	140.000	0.87%
P22	C228-C237	7.000	20.000	140.000	28	140.000	0.87%
P23	C238-C247	7.000	20.000	140.000	28	140.000	0.87%
P24	C248-C257	7.000	20.000	140.000	28	140.000	0.87%
P25	C258-C267	7.000	20.000	140.000	28	140.000	0.87%
P26	C268-C277	7.000	20.000	140.000	28	140.000	0.87%
P27	C278-C287	7.000	20.000	140.000	28	140.000	0.87%
P28	C288-C297	7.000	20.000	140.000	28	140.000	0.87%
P29	C298-C307	7.000	20.000	140.000	28	140.000	0.87%
P30	C308-C317	7.000	20.000	140.000	28	140.000	0.87%
P31	C318-C327	7.000	20.000	140.000	28	140.000	0.87%
P32	C328-C337	7.000	20.000	140.000	28	140.000	0.87%
P33	C338-C347	7.000	20.000	140.000	28	140.000	0.87%
P34	C348-C357	7.000	20.000	140.000	28	140.000	0.87%
P35	C358-C367	7.000	20.000	140.000	28	140.000	0.87%
P36	C368-C377	7.000	20.000	140.000	28	140.000	0.87%
P37	C378-C387	7.000	20.000	140.000	28	140.000	0.87%
P38	C388-C397	7.000	20.000	140.000	28	140.000	0.87%
P39	C398-C407	7.000	20.000	140.000	28	140.000	0.87%
P40	C408-C417	7.000	20.000	140.000	28	140.000	0.87%
P41	C418-C427	7.000	20.000	140.000	28	140.000	0.87%
P42	C428-C437	7.000	20.000	140.000	28	140.000	0.87%
P43	C438-C447	7.000	20.000	140.000	28	140.000	0.87%
P44	C448-C457	7.000	20.000	140.000	28	140.000	0.87%
P45	C458-C467	7.000	20.000	140.000	28	140.000	0.87%
P46	C468-C477	7.000	20.000	140.000	28	140.000	0.87%
P47	C478-C487	7.000	20.000	140.000	28	140.000	0.87%
P48	C488-C497	7.000	20.000	140.000	28	140.000	0.87%
P49	C498-C507	7.000	20.000	140.000	28	140.000	0.87%
P50	C508-C517	7.000	20.000	140.000	28	140.000	0.87%
P51	C518-C527	7.000	20.000	140.000	28	140.000	