







**PROPOSED LAYOUT PLAN OF INDUSTRIAL PLOTTED COLONY OVER AN AREA MEASURING 15.4375 ACRES IN THE REVENUE ESTATE OF VILL. BEER, TEH. & DISTT. HISAR (HARYANA), BEING DEVELOPED BY M.K.S. ENTERPRISES**

AREA CALCULATIONS					
S.NO.	PARTICULARS	PROPOSAL (ACRE)	PROPOSAL (%)	PERMISSIBLE (ACRE)	PERMISSIBLE (%)
1	TOTAL AREA OF THE SCHEME	15.4375	-	15(MINIMUM)	-
2	AREA UNDER 100M WIDE GREEN BELT	1.0551	-	-	-
3	BALANCE AREA	14.3824	-	-	-
4	50% BENEFIT OF AREA UNDER 100M WIDE GREEN BELT	0.5276	-	-	-
5	NET PLANNED AREA	14.9100	-	-	-
6	AREA UNDER INDUSTRIAL PLOTS	9.6915	65.00%	9.6915	65.00%
7	AREA UNDER ROADS / GREEN / IG / OPEN SPACES / SERVICES	5.2185	35.00%	5.2185	35.00%

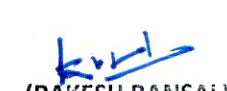
DETAIL OF INDUSTRIAL PLOTS OFFERED BY THE LICENCEE TO BE MORTGAGE AGAINST IDW					
INDUSTRIAL PLOTS(TO BE MORTGAGE) IDW					
S.NO.	CATEGORY	SIZE(IN METERS)	AREA(IN SQMT)	NO. OF PLOTS	TOTAL(IN SQMT)
1	E	15.32 X 40.94	627.20	4	2508.80
2	E1	15.34 X 40.94	628.02	1	628.02
3	F	15.33 X 27.28	418.20	2	836.40
4	TOTAL			7	3973.22 SQMT
					0.9818 ACRES 10.13%

To be read with License No. 71 of 2023 Dated 6/4/2023.  
 That this Layout plan for site area measuring 15.4375 acres (Drawing No. DGTCP- 919 dated 06-04-23) comprised of licence which is issued in respect of Industrial Plotted Colony being developed by Sumati Chaudhary & others in collaboration with MKS Enterprises falling in the revenue estate of village Beer, District Hisar, is hereby approved subject to the following conditions:-

1. That this Layout Plan shall be read in conjunction with the clauses appearing on the agreement executed under Rule 11 and the bilateral agreement.
2. That the demarcation plans as per site of all the Industrial, Residential and Commercial and Community sites shall be got approved from this Department and construction on these sites shall be governed by the Haryana Building Code, 2017 and the Zoning Plan approved by the Director General, Town & Country Planning, Haryana.
3. That the high-tension lines passing in the colony area shall have to be suitably aligned or right of way along the same shall be maintained as per ISI norms.
4. That for proper planning and integration of services in the area adjacent to the colony, the colonizer shall abide by the directions of the DGTCP for the modification of layout plans of the colony.
5. That the revenue rasta falling in the colony shall be kept free for circulation/movement as shown in the layout plan.
6. That the colonizer shall abide by the directions of the DGTCP, Haryana and accordingly shall make necessary changes in the layout plan for making any adjustment in the alignment of the peripheral roads, internal road circulation or for proper integration of the planning proposals of the adjoining areas.
7. That no property/plot shall derive access directly from the carriage way of 30 metres or wider sector road if applicable.
8. All green belts provided in the layout plan within the licensed areas of the colony shall be developed by the colonizer.
9. Any excess area over and above the permissible under Industrial, Residential and Commercial use shall be deemed to be open space.
10. No plot will derive an access from less than 15 metres wide road would mean a minimum clear width of 15 metres between the plots.
11. The portion of the sector/development plan roads/green belts as provided in the Development Plan if applicable, which form part of the licensed area shall be transferred free of cost to the government on the lines of section 3(3)(a)(iii) of the Act No.8 of 1975.
12. That you will have no objection to the regularization of the boundaries of the licence through give and take with the land that HUDA is finally able to acquire in the interest of planned development and integration of services. The decision of the competent authority shall be binding in this regard.
13. That the colonizer shall obtain the Clearance/NOC as per the provisions of the Notification No. S.O. 1533 (E) Dated 14.9.2006 issued by Ministry of Environment and Forest, Government of India before starting the construction/execution of development works at site.
14. That the colonizer shall obtain the permission from the competent authority before laying of services and construction of roads along/across the revenue rasta and making culvert over the water courses/Dhanas, wherever applicable as per the layout plan.
15. That the rain water harvesting system shall be provided as per Central Ground Water Authority Norms/Haryana Govt. Notification as applicable.
16. That the colonizer shall also indicate solid waste measures as directed by the Haryana State Pollution Control Board at the time of submission of the demarcation plan.
17. For allotment of residential plots/flats, preference shall be given to the industry owners/ executives/ workers. The colonizer may also plan dormitories/ hostels for the industrial workers/labour.
18. That the owner shall ensure the installation of Solar Photovoltaic Power Plant as per the provisions of order No. 22/52/2005-5Power dated 21.03.2016 issued by Haryana Government Renewable Energy Department.
19. That the owner shall strictly comply with the directions issued vide Notification No. 19/6/2016-5P dated 31.03.2016 issued by Haryana Government Renewable Energy Department.
20. That owner shall ensure the installation of Solar Power Plant as per provisions of Haryana Solar Power Policy, 2016 issued by Haryana Government Renewable Energy Department vide Notification No. 19/4/2016-5 Power dated 14.03.2016.
21. That the colonizer/owner shall ensure the installation of the Light-Emitting Diode (LED) lamps for its campus as well as building.

 (RAKESH BANSAI) DTP (HQ)  
 (SANJAY KUMAR) STP (E&V)  
 (J.P. SINGH) CTP (HR)  
 (T.L. SATYAPRAKASH, IAS) DGTCP (HR)  
 (SURESH YADAV) ATP (HQ)  
 (PARVEEN KUMAR) JD (HQ)

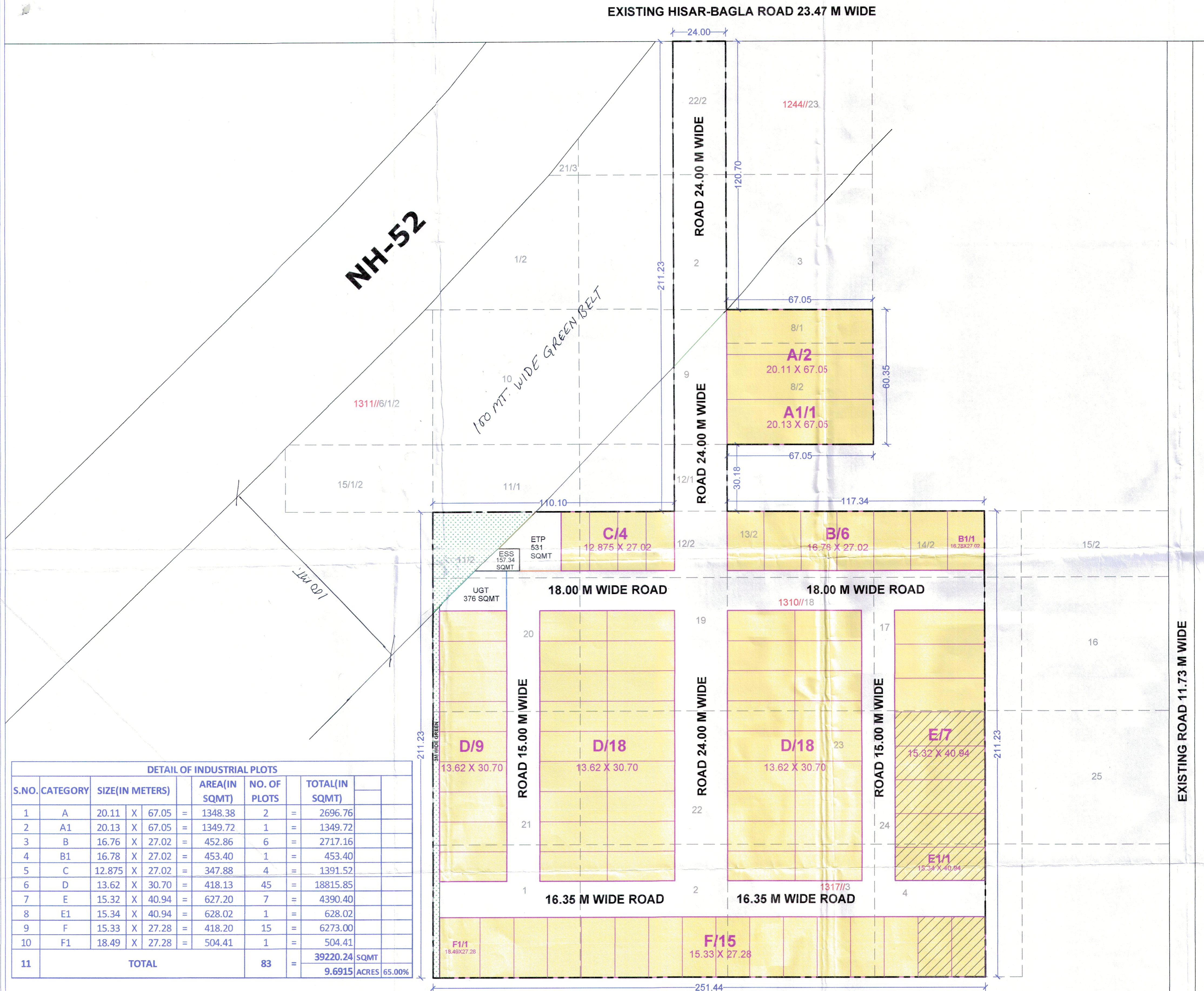

DETAIL OF INDUSTRIAL PLOTS					
S.NO.	CATEGORY	SIZE(IN METERS)	AREA(IN SQMT)	NO. OF PLOTS	TOTAL(IN SQMT)
1	A	20.11 X 67.05	1348.38	2	2696.76
2	A1	20.13 X 67.05	1349.72	1	1349.72
3	B	16.76 X 27.02	452.86	6	2717.16
4	B1	16.78 X 27.02	453.40	1	453.40
5	C	12.875 X 27.02	347.88	4	1391.52
6	D	13.62 X 30.70	418.13	45	18815.85
7	E	15.32 X 40.94	627.20	7	4390.40
8	E1	15.34 X 40.94	628.02	1	628.02
9	F	15.33 X 27.28	418.20	15	6273.00
10	F1	18.49 X 27.28	504.41	1	504.41
11	TOTAL			83	39220.24 SQMT
					9.6915 ACRES 65.00%

**DIVINE ARCHITECTS & PLANNERS**

ADDRESS: SCO 76-77, 1st FLOOR, SECTOR-8C, MADHYA MARG, CHANDIGARH-160009  
 CONTACT: +91-98139-00375, +91-172-4785520  
 EMAIL: divinearchitects18@gmail.com

LEGEND:  
 UGT = UNDERGROUND WATER TANK  
 ETP = EFFLUENT TREATMENT PLANT  
 IG = INCIDENTAL GREEN  
 PARKS/OPEN SPACES/IG  
 KILLA LINE  
 SCHEME BOUNDARY

ABBREVIATIONS-  
 ESS = ELECTRIC SUB STATION  
 UGT = UNDERGROUND WATER TANK  
 ETP = EFFLUENT TREATMENT PLANT  
 IG = INCIDENTAL GREEN

(SCALE-N.T.S.)

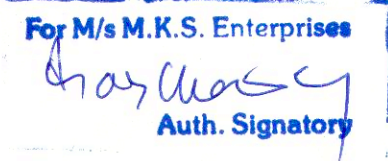
For M/s M.K.S. Enterprises  
  
 Auth. Signatory

For M/s M.K.S. Enterprises  
  
 AR. MOHIT SHARMA  
 CA/26/16/8557  
 (M/46139-00375)  
 1st Floor, Sector-8C, Chandigarh

WEST NORTH EAST SOUTH

SIGNATURE OF OWNER / APPLICANT

SIGNATURE OF ARCHITECT / TOWN PLANNER