

JE FI Suresh Kumar AD SD ATP  
 AC DTP

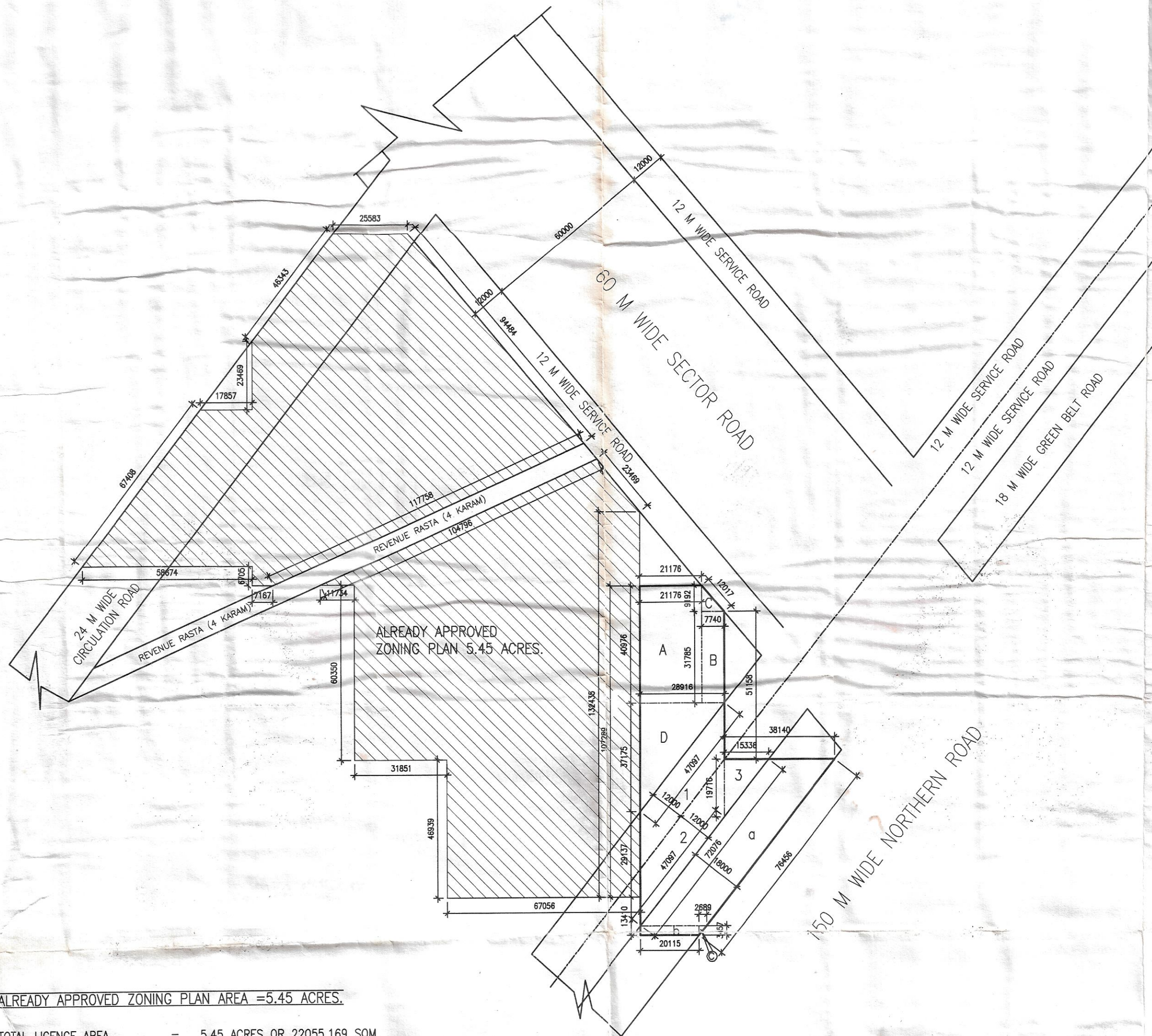

ADDITION (1) NET PLANNED AREA

A=	40.976X21.176	=867.707
B=	7.740X31.785	=246.015
C=0.50X	7.740X9.192	=35.573
D=0.50X	28.916X37.175	=537.476
TOTAL		=1686.771

ADDITION (2) 12M. WIDE SERVICE ROAD

1=	47.097X12.000	=565.164
TOTAL		=565.164

ADDITION (3) 12M. WIDE SERVICE ROAD (PART OF GREEN BELT)

2=	47.097X12.000	=565.164
3=0.50X	15.336X19.716	=151.182
TOTAL		=716.346 SQM

ADDITION (4) 18M. WIDE GREEN BELT

a=	72.076X18.000	=1297.368
b=	20.115X3.457	=69.537
c=0.50X	2.689X3.457	=4.647
TOTAL		=1371.552 SQM

TOTAL LOI AREA = 1.075 ACRES OR 4350.36375 SQM.  
 TOTAL SITE AREA = ADDITION (1)+ADDITION(2)+ADDITION(3)+ADDITION(4)  
 = 1686.771+565.164+716.346+1371.552  
 = 4339.833 SQM. (1.07240 ACRES)

TOTAL AREA UNDER 12M. - (Part of 24 M. Road) WIDE SERVICE ROAD = ADDITION (2) = 565.164 SQM. (0.1396 ACRE)

TOTAL AREA UNDER 12M. - (Part of 24 M. Road) WIDE SERVICE ROAD (PART OF GREEN BELT) = ADDITION (3) = 716.346 SQM. (0.1770 ACRE)

TOTAL AREA UNDER 18M. WIDE GREEN BELT = ADDITION (4) = 1371.552 SQM. (0.3389 ACRE)

NET PLANNED AREA = TOTAL SITE AREA - (TOTAL AREA UNDER ROAD & GREEN BELT)  
 = 4339.833 - 565.164 + 716.346 + 1371.552  
 = 4339.833 - 2653.062  
 = 1686.771 SQM. OR 0.4168 ACRE.

ALREADY APPROVED ZONING PLAN AREA = 5.45 ACRES.

TOTAL LICENCE AREA	=	5.45 ACRES OR 22055.169 SQM.
TOTAL SITE AREA	=	ADDITION (1) = 22248.635 SQM. (5.497 ACRES)
TOTAL AREA UNDER 24 M WIDE CIRCULATION ROAD	=	ADDITION (SCR1) + ADDITION (SCR2) = 1900.374 + 1321.416 = 3221.79 SQM. (0.796 ACRE)
TOTAL AREA UNDER 24 M WIDE SERVICE ROAD	=	ADDITION (SR1) = 330.180 SQM. (0.081 ACRE)
NET PLANNED AREA	=	TOTAL SITE AREA - (TOTAL AREA UNDER 24 M WIDE CIRCULATION ROAD + TOTAL AREA UNDER 24 M WIDE SERVICE ROAD + TOTAL AREA UNDER 12 M WIDE SERVICE ROAD) = 22248.635 - (3221.79 + 330.180) = 22248.635 - 3551.970 = 18696.665 SQM. OR 4.620 ACRES

PROJECT

PROPOSED DEMARCATION PLAN OF COMMERCIAL COLONY ON RECT.NO 24 KILLA NO.2/1/1,9/2 LOI AREA MEASURING 1.075 ACRES. IN SEC.-106, VILLAGE - PAWALA KHUSRUPUR, TEHSIL & DISTRICT GURGAON, HARYANA FOR M/S AIRMID DEVELOPERS LTD. LOI MEMO NO.13724, DATED-03/08/2012

DATE	SEPTEMBER 2012	DRAWN BY	AMAR SINGH
SCALE	1:800	PROJECT	DEMARCATION PLAN

OWNER SIGN.

ARCHITECTS SIGN.

*Amar Singh*  
 AJAY RUSTAGI  
 ARCHITECT  
 HUDA Regn. No. 35/2012  
 Office: 1st Floor, Gurgaon City  
 Office: Sec-14, Gurgaon-122001  
 M: 9811477121



S.No. 8

AREA UNDER 24M WIDE SERVICE ROAD

Ret NO. Killa No. 24 10/01 330.180 SQM or 0.081 ACRES

AREA UNDER 24M WIDE CIRCULATION ROAD

Ret NO. Killa No. 18 24 1518.362 SQM or 0.376 ACRES  
 18 25/01 99.421 SQM or 0.025 ACRES  
 18 16/01 77.068 SQM or 0.019 ACRES  
 18 16/02 1526.820 SQM or 0.377 ACRES

ADDITION - SP1 (24 M WIDE SERVICE ROAD)						
RI	=	AB	X	22.084	X	24.137
						= 330.180
						sqm.
						TOTAL = 330.180
						sqm.

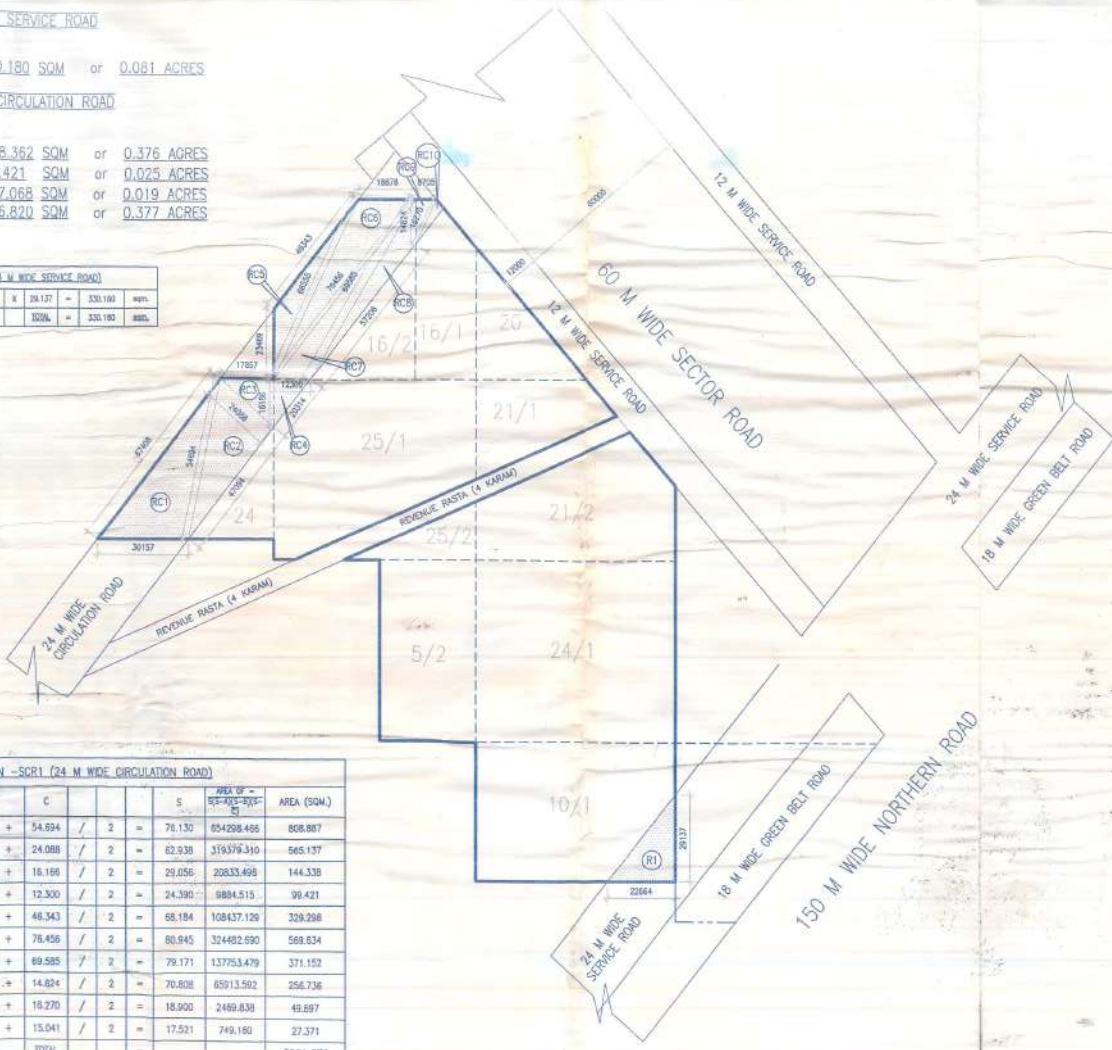

AD surely  
 SD  
 ATP  
 DTP

PROJECT :-  
 DEMARCATION PLAN OF COMMERCIAL ON THE NOTIFIED AREA MEASURING 5.46 ACRE IN 863-108, VILLAGE PANAWA KAGESUPUR, DISTRICT GURGAON, HARYANA FOR M/S ARMAD DEVELOPERS LTD. (LOI MEAS NO.20342, DATED-30/12/2011)

Associated Architects  
**RISMS**  
 ARCHITECTS  
 RISMS ARCHITECTS PVT. LTD.  
 65, Nara House, Showal Kunj  
 (Behind G.D., Vasant Kunj),  
 New Delhi-110070.  
 Tel:- 011-26989615, 26989617  
 www.risms-arch.com

ADDITION - SCR1 (24 M WIDE CIRCULATION ROAD)									
NO.	A	B	C		S	AREA OF - 5/2-203-873-30	AREA (SQM.)		
RC1	= 30.157	+ 67.408	+ 54.694	/	2	= 78.130	654298.496	808.867	
RC2	= 54.694	+ 47.094	+ 24.088	/	2	= 62.938	319379.310	565.137	
RC3	= 24.088	+ 17.857	+ 16.166	/	2	= 29.056	20833.468	144.338	
RC4	= 20.314	+ 16.166	+ 12.300	/	2	= 24.390	9894.515	96.421	
RC5	= 66.555	+ 23.489	+ 46.343	/	2	= 66.184	108437.129	329.298	
RC6	= 66.555	+ 16.878	+ 76.456	/	2	= 80.945	324482.990	569.634	
RC7	= 12.300	+ 76.456	+ 89.585	/	2	= 79.171	137753.479	371.152	
RC8	= 89.585	+ 57.206	+ 14.824	/	2	= 70.808	65913.582	256.736	
RC9	= 6.705	+ 14.824	+ 16.270	/	2	= 16.900	2489.838	49.697	
RC10	= 3.730	+ 16.270	+ 15.041	/	2	= 17.521	749.160	27.371	
						TOTAL		3221.671	

ARCHITECT'S SEAL & SIGNATURE	OWNER'S SEAL & SIGNATURE
APRIL 2012 Scale 1:1250	Drawing No:-
Road Area	RA-01