

# SECTOR-29A

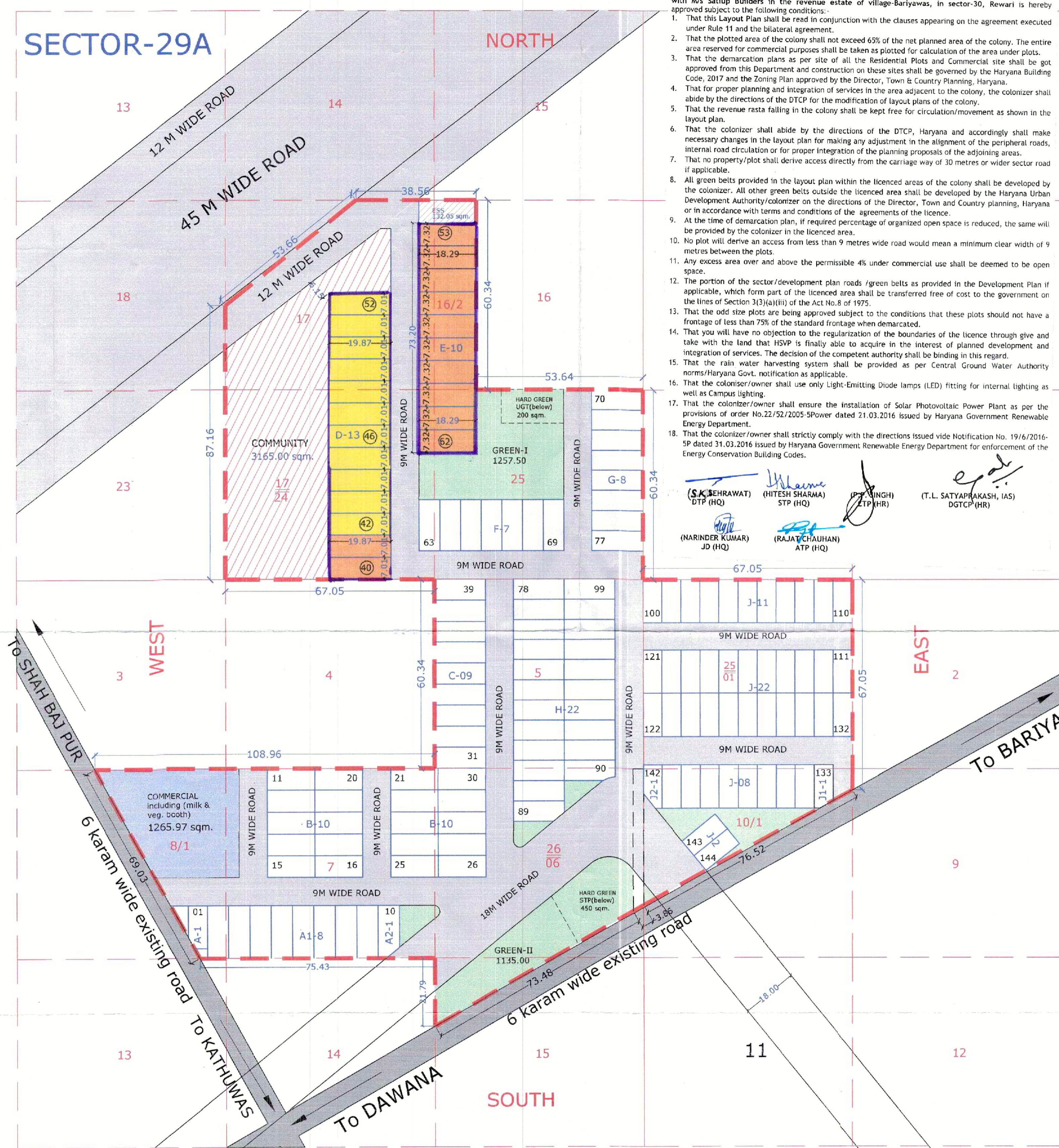

To be read with Licence No. 09 of 2023 Dated 13/01/2023

This Layout plan for an area measuring 7.81875 acres (Drawing no. DTCP/8923 dated 17-01-2023) comprised of licence which is issued in respect of Affordable Plotted Colony (Under Deen Dayal Jan Awas Yojna) being developed by Shri Rajbir Singh, Satbir Singh S/o Sh. Rajinder Singh & Others in collaboration with M/s Sattup Builders in the revenue estate of village-Bariyawas, in sector-30, Rewari is hereby approved subject to the following conditions:

1. That this Layout Plan shall be read in conjunction with the clauses appearing on the agreement executed under Rule 11 and the bilateral agreement.
2. That the plotted area of the colony shall not exceed 65% of the net planned area of the colony. The entire area reserved for commercial purposes shall be taken as plotted for calculation of the area under plots.
3. That the demarcation plans as per site of all the Residential Plots and Commercial site shall be got approved from this Department and construction on these sites shall be governed by the Haryana Building Code, 2017 and the Zoning Plan approved by the Director, Town & Country Planning, Haryana.
4. That for proper planning and integration of services in the area adjacent to the colony, the colonizer shall abide by the directions of the DTCP for the modification of layout plans of the colony.
5. That the revenue rasta falling in the colony shall be kept free for circulation/movement as shown in the layout plan.
6. That the colonizer shall abide by the directions of the DTCP, Haryana and accordingly shall make necessary changes in the layout plan for making any adjustment in the alignment of the peripheral roads, internal road circulation or for proper integration of the planning proposals of the adjoining areas.
7. That no property/plot shall derive access directly from the carriage way of 30 metres or wider sector road if applicable.
8. All green belts provided in the layout plan within the licensed areas of the colony shall be developed by the colonizer. All other green belts outside the licensed area shall be developed by the Haryana Urban Development Authority/colonizer on the directions of the Director, Town and Country planning, Haryana or in accordance with terms and conditions of the agreements of the licence.
9. At the time of demarcation plan, if required percentage of organized open space is reduced, the same will be provided by the colonizer in the licensed area.
10. No plot will derive an access from less than 9 metres wide road would mean a minimum clear width of 9 metres between the plots.
11. Any excess area over and above the permissible 4% under commercial use shall be deemed to be open space.
12. The portion of the sector/development plan roads /green belts as provided in the Development Plan if applicable, which form part of the licensed area shall be transferred free of cost to the government on the lines of Section 3(3)(a)(ii) of the Act No.8 of 1975.
13. That the odd size plots are being approved subject to the conditions that these plots should not have a frontage of less than 75% of the standard frontage when demarcated.
14. That you will have no objection to the regularization of the boundaries of the licence through give and take with the land that HSPV is finally able to acquire in the interest of planned development and integration of services. The decision of the competent authority shall be binding in this regard.
15. That the rain water harvesting system shall be provided as per Central Ground Water Authority norms/Haryana Govt. notification as applicable.
16. That the colonizer/owner shall use only Light-Emitting Diode lamps (LED) fitting for internal lighting as well as Campus lighting.
17. That the colonizer/owner shall ensure the installation of Solar Photovoltaic Power Plant as per the provisions of order No.22/52/2005-5P dated 21.03.2016 issued by Haryana Government Renewable Energy Department.
18. That the colonizer/owner shall strictly comply with the directions issued vide Notification No. 19/6/2016-5P dated 31.03.2016 issued by Haryana Government Renewable Energy Department for enforcement of the Energy Conservation Building Codes.

(S.K. SEHRAWAT) DTP (HQ) (NARINDER KUMAR) JD (HQ)  
 (HITESH SHARMA) STP (HQ) (RAJAT CHAUHAN) ATP (HQ)  
 (T.L. SATYAPRAKASH, IAS) DTGCP (HR)

10.204 % Area (1532.18 sqm. of Total Saleable area) to be Mortgaged against (EDC B.G.) in Favour of DTCP Haryana.

TYPE OF PLOTS	LOTS NO.	DIMENSION OF PLOTS IN SQM.	AREA OF PLOTS IN SQM.	NO OF PLOTS	AREA UNDER PLOTS
		W D			
D	42 to 52	7.01 19.87	139.29	11	1532.18
<b>TOTAL</b>				<b>11</b>	<b>1532.18</b>

TOTAL AREA = 1532.18 X 100 / 15014.65 = 10.204 % (0.3786 Acs.)

DETAIL OF MORTGAGED AREA WITH KILLA NO. FALLING UNDER 10.204 % against (EDC B.G.)

REC / KILLA NO.	AREA IN SQM.	AREA IN K - M - S
17//17	611.80	01 - 04 - 02
17//24	920.38	01 - 16 - 03
<b>TOTAL</b>	<b>1532.18 sqm.</b>	<b>03 - 00 - 05</b>

10.772 % Area (1617.41 sqm. of Total Saleable area) to be Mortgaged against (IDW B.G.) in Favour of DTCP Haryana.

TYPE OF PLOTS	LOTS NO.	DIMENSION OF PLOTS IN SQM.	AREA OF PLOTS IN SQM.	NO OF PLOTS	AREA UNDER PLOTS
		W D			
D	40 to 41	7.01 19.87	139.29	2	278.58
D	53 to 62	7.32 18.29	133.88	10	1338.83
<b>TOTAL</b>				<b>12</b>	<b>1617.41</b>

TOTAL AREA = 1617.41 X 100 / 15014.65 = 10.772 % (0.3996 Acs.)

DETAIL OF MORTGAGED AREA WITH KILLA NO. FALLING UNDER 10.772 % against (IDW B.G.)

REC / KILLA NO.	AREA IN SQM.	AREA IN K - M - S
17//16	712.34	01 - 08 - 01
17//17	259.23	00 - 10 - 02
17//24	376.57	00 - 15 - 00
17//25	269.27	00 - 10 - 06
<b>TOTAL</b>	<b>1617.41 sqm.</b>	<b>03 - 04 - 00</b>

Plot No.	Area in Sqm.	No. of Plots	Total area in Sqm.	Head of BG
Type-D (Plot No. 42 to 52)	139.29	11	1532.18	EDC
Type-F (Plot No. 40 to 41)	139.29	2	278.58	IDW
Type-D (Plot No. 53 to 62)	1338.83	10	1338.83	
<b>Total</b>		<b>23</b>	<b>3149.59 Sqm. Or 0.778 acres (20.97%)</b>	

## AREA STATEMENT :

DESCRIPTION	AREA IN SQ.METER	AREA IN ACRES	AREA ACHIEVED	AREA PERMISSIBLE
TOTAL AREA OF THE SCHEME	31641.30	7.81875	—	65%
A - AREA UNDER PLOTS	15014.65	3.71	47.45 %	ACHIEVED (A+B) 51.45%
B - AREA UNDER COMMERCIAL	1265.97	0.3128	4.00 %	
TOTAL PLOTS	144			

## DETAIL OF PLOTS

TYPE OF PLOTS	DIMENSION OF PLOTS IN SQM.	AREA OF PLOTS IN SQM.	NO OF PLOTS	AREA UNDER PLOTS
	W D			
A	irregular	80.20	1	80.20
A1	6.85 16.86	115.49	8	923.93
A2	irregular	108.33	1	108.33
B	6.90 15.25	105.23	20	2104.50
C	6.71 16.35	109.71	9	987.38
D	7.01 19.87	139.29	13	1810.75
E	7.32 18.29	133.88	10	1338.83
F	6.64 16.30	108.23	7	757.62
G	6.41 16.42	105.25	8	842.02
H	6.43 16.35	105.13	22	2312.87
J	6.10 13.72	83.69	43	3598.76
J1	irregular	78.12	1	78.12
J2	irregular	71.35	1	71.35
<b>TOTAL</b>				<b>144</b>

TOTAL AREA UNDER PLOTS = 3.71 ACS.

## DETAIL OF GREEN

	AREA IN SQMTR.	AREA IN ACS.	AREA PROVIDE	AREA REQUIRED
GREEN-I	1257.50	0.3106	3.9725 %	(2373.10 sqm.)
GREEN-II	1135.00	0.2804	3.5862 %	7.50 %
<b>TOTAL</b>	<b>2392.50</b>	<b>0.591</b>	<b>7.5587%</b>	
STP & UGT MUMTY AREA	19.40			

0.782 acres Land Reserved For Community Facilities for Transfer to Government.

TOTAL PLOTS	PERSON PER PLOTS	TOTAL DENSITY	PERCENTAGE PER ACRES
144	13.5	1944.00	1944.00 / 7.81875 = 248.63 PPA SAY = 249.00 PPA

Seema Rani  
 Signature of Architect  
**SEEMA RANI**  
 CA/2015/72259

Hitesh Mishra

ARCHITECT SIGNATURE AUTHORIZED SIGNATORY

CLIENT:-  
**M/S SATTUP BUILDER**  
 ADDRESS:- 93-R, MODEL TOWN REWARI-123401.

LAYOUT PLAN OF AFFORDABLE RESIDENTIAL PLOTTED COLONY UNDER (DDJAY) AT SECTOR-30, AREA MEASURING 7.81875 ACS. IN VILLAGE BARIYAWAS, DISTRICT-REWARI, HARYANA.

SCALE :- 1:800 DATE:-DEC-2022 DESIGN BY:-PANKAJ KAPOOR M-8800093157