

ZONING PLAN OF AFFORDABLE HOUSING COLONY OVER AN AREA MEASURING 5.5875 ACRES UNDER THE RAYAN PONDY JAIN AWAS YOJANA AT RAJASTI BRINDA, TERISI SHING BALLY 1 REAL ESTATE AND DEVELOPERS

FOR THE PURPOSE OF CODE 1.2 (DCC) & THE MARRIAGE BUILDING CODE, 2017 AS NOTIFIED FROM TIME TO TIME.

FOR THE PURPOSE OF CODE 1.2 (DCC) & THE MARRIAGE BUILDING CODE, 2017 AS NOTIFIED FROM TIME TO TIME.

THE DEVELOPER'S RESPONSIBILITY TO OBTAIN ALL NECESSARY PERMITS AND APPROVALS FROM THE RELEVANT AUTHORITIES FOR THE PROPOSED DEVELOPMENT SHALL BE THE SOLE RESPONSIBILITY OF THE DEVELOPER.

1.1. MARRIAGE BUILDING CODE, 2017

Sl. No.	Particulars	Area (sq. m)	Area (sq. ft)
1.	Overall Area	328	3544
2.	Area for Marriage Hall	140	1510

1.2. MARRIAGE BUILDING CODE, 2017

Sl. No.	Particulars	Area (sq. m)	Area (sq. ft)
1.	Area for Marriage Hall	140	1510
2.	Area for Kitchen	24	258
3.	Area for Living Room	24	258
4.	Area for Bed Room	24	258

1.3. MARRIAGE BUILDING CODE, 2017

Sl. No.	Particulars	Area (sq. m)	Area (sq. ft)
1.	Area for Marriage Hall	140	1510
2.	Area for Kitchen	24	258
3.	Area for Living Room	24	258
4.	Area for Bed Room	24	258

1.4. MARRIAGE BUILDING CODE, 2017

Sl. No.	Particulars	Area (sq. m)	Area (sq. ft)
1.	Area for Marriage Hall	140	1510
2.	Area for Kitchen	24	258
3.	Area for Living Room	24	258
4.	Area for Bed Room	24	258

1.5. MARRIAGE BUILDING CODE, 2017

Sl. No.	Particulars	Area (sq. m)	Area (sq. ft)
1.	Area for Marriage Hall	140	1510
2.	Area for Kitchen	24	258
3.	Area for Living Room	24	258
4.	Area for Bed Room	24	258

1.6. MARRIAGE BUILDING CODE, 2017

Sl. No.	Particulars	Area (sq. m)	Area (sq. ft)
1.	Area for Marriage Hall	140	1510
2.	Area for Kitchen	24	258
3.	Area for Living Room	24	258
4.	Area for Bed Room	24	258

1.7. MARRIAGE BUILDING CODE, 2017

Sl. No.	Particulars	Area (sq. m)	Area (sq. ft)
1.	Area for Marriage Hall	140	1510
2.	Area for Kitchen	24	258
3.	Area for Living Room	24	258
4.	Area for Bed Room	24	258

1.8. MARRIAGE BUILDING CODE, 2017

Sl. No.	Particulars	Area (sq. m)	Area (sq. ft)
1.	Area for Marriage Hall	140	1510
2.	Area for Kitchen	24	258
3.	Area for Living Room	24	258
4.	Area for Bed Room	24	258

1.9. MARRIAGE BUILDING CODE, 2017

Sl. No.	Particulars	Area (sq. m)	Area (sq. ft)
1.	Area for Marriage Hall	140	1510
2.	Area for Kitchen	24	258
3.	Area for Living Room	24	258
4.	Area for Bed Room	24	258

1.10. MARRIAGE BUILDING CODE, 2017

Sl. No.	Particulars	Area (sq. m)	Area (sq. ft)
1.	Area for Marriage Hall	140	1510
2.	Area for Kitchen	24	258
3.	Area for Living Room	24	258
4.	Area for Bed Room	24	258

1.11. MARRIAGE BUILDING CODE, 2017

Sl. No.	Particulars	Area (sq. m)	Area (sq. ft)
1.	Area for Marriage Hall	140	1510
2.	Area for Kitchen	24	258
3.	Area for Living Room	24	258
4.	Area for Bed Room	24	258

1.12. MARRIAGE BUILDING CODE, 2017

Sl. No.	Particulars	Area (sq. m)	Area (sq. ft)
1.	Area for Marriage Hall	140	1510
2.	Area for Kitchen	24	258
3.	Area for Living Room	24	258
4.	Area for Bed Room	24	258

1.13. MARRIAGE BUILDING CODE, 2017

Sl. No.	Particulars	Area (sq. m)	Area (sq. ft)
1.	Area for Marriage Hall	140	1510
2.	Area for Kitchen	24	258
3.	Area for Living Room	24	258
4.	Area for Bed Room	24	258

1.14. MARRIAGE BUILDING CODE, 2017

Sl. No.	Particulars	Area (sq. m)	Area (sq. ft)
1.	Area for Marriage Hall	140	1510
2.	Area for Kitchen	24	258
3.	Area for Living Room	24	258
4.	Area for Bed Room	24	258

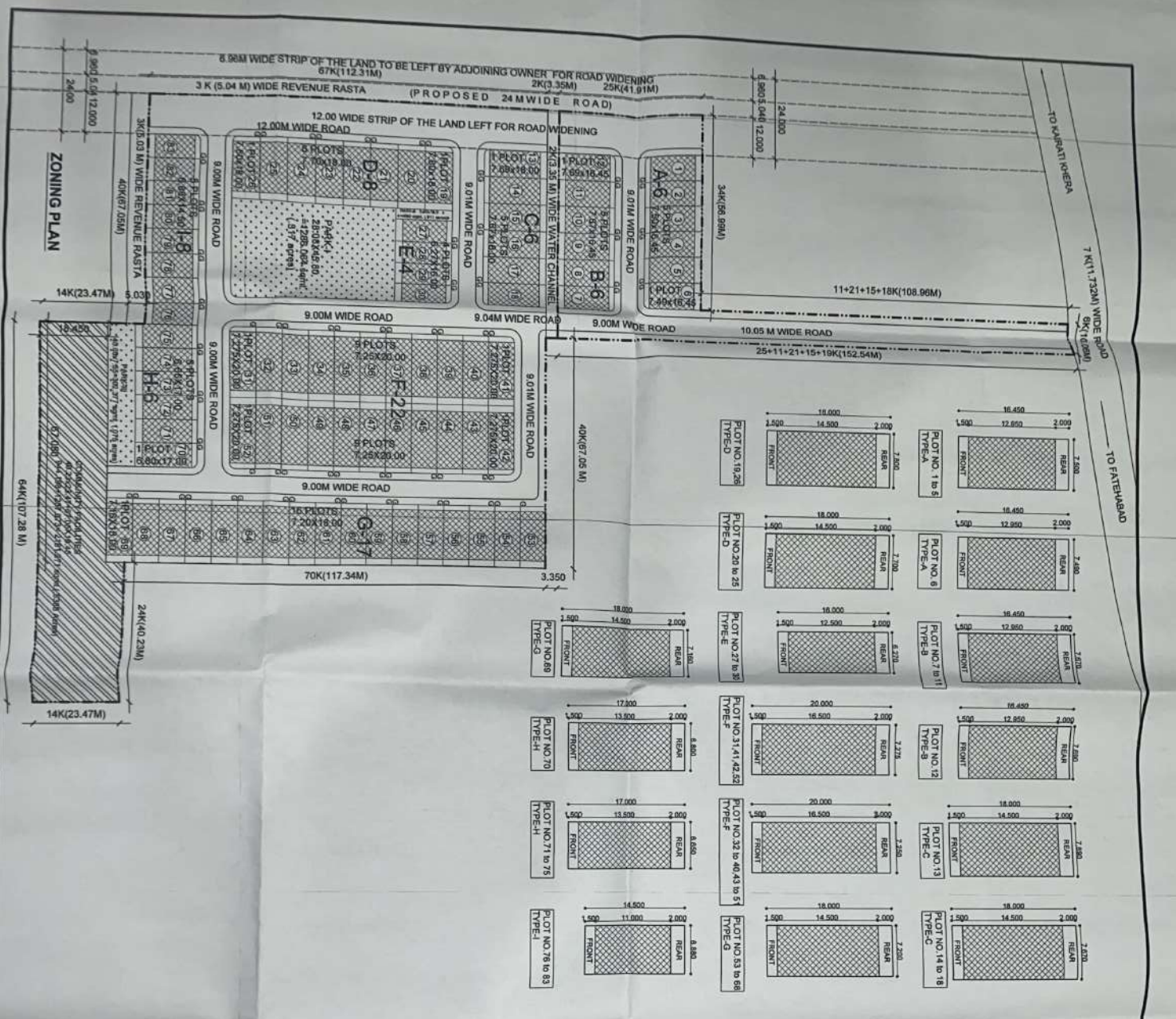

DIRECTOR
MHPVU

DATE: 18.01.2023

DRIVING NO. 2001 CT/123/2023/01

HDI S DT(DND) DT (E) Rakhanda STP CP