

**LEGEND:**

SYMBOL	DESCRIPTION
	EXTINGUISHER - CLEAN AGENT 2.5kg
	SAND BUCKET
	GAS FLOODING SYSTEM
	9 Lt MECHANICAL TYPE FIRE EXTINGUISHER

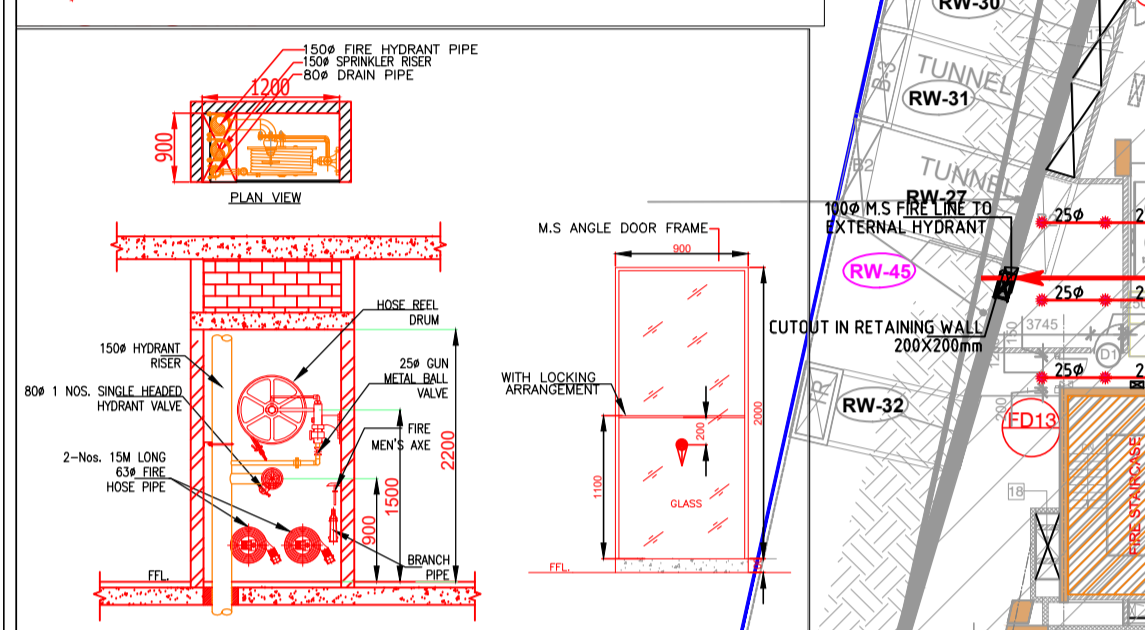
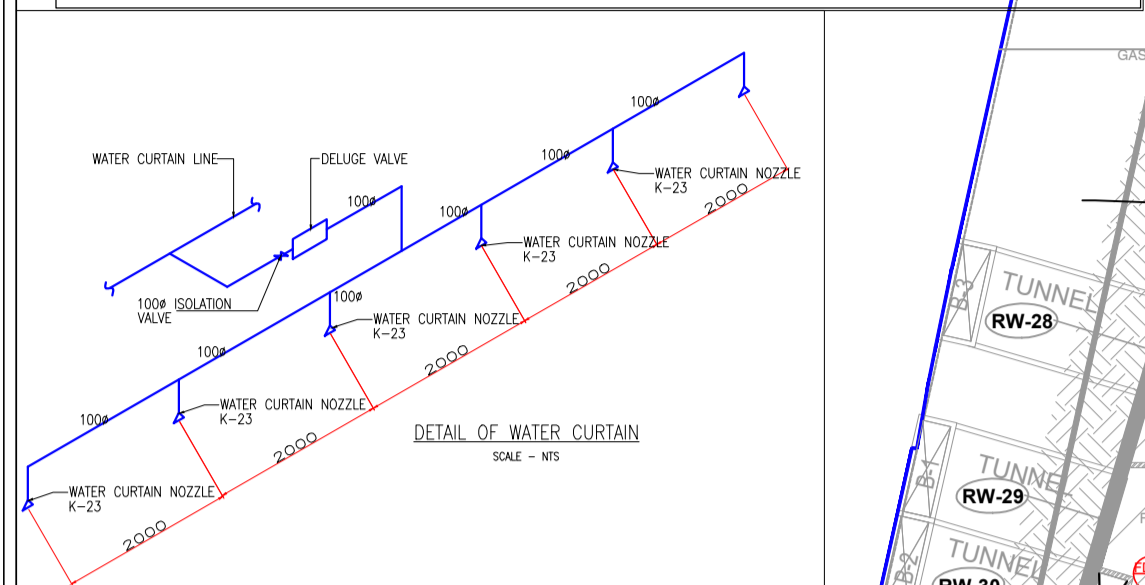
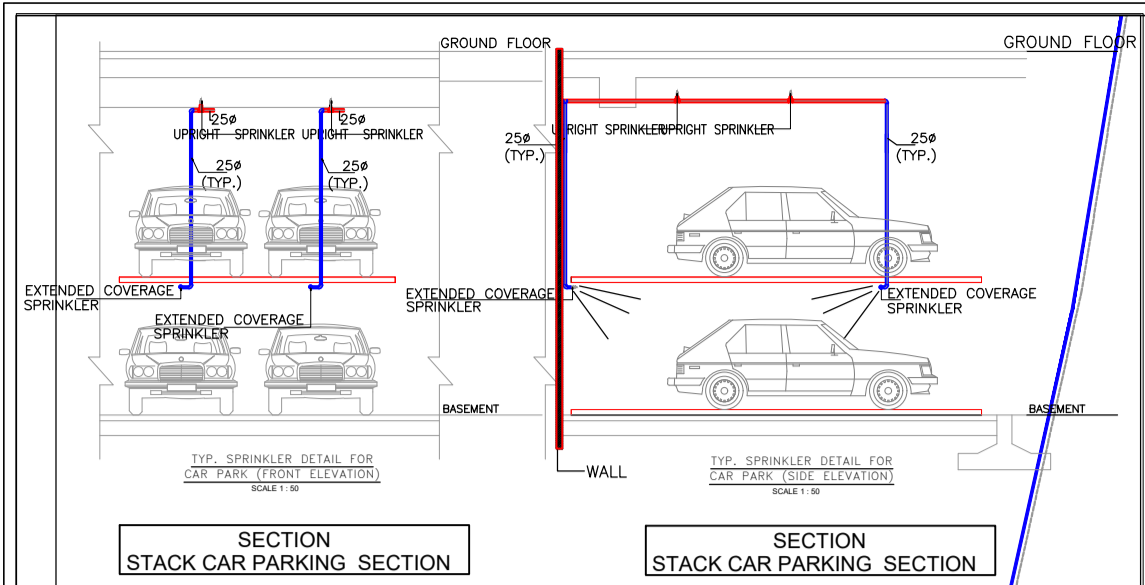

**LEGEND**

NO.	DESCRIPTION	SYMBOL
1	MULTI-TURN DETECTOR (ADDRESSABLE)	
2	SMOKE DETECTOR (ADDRESSABLE)	
3	SMOKE DETECTOR (NON-ADDRESSABLE)	
4	SMOKE DETECTOR (NON-ADDRESSABLE)	
5	ADDRESSABLE MANUAL CALL POINT (AT 1400 MM F.L.)	
6	HOOTER (AT 2400 MM MINIMUM F.L.) (S.O. BOSS)	
7	HOOTER (ADDRESSABLE)	
8	CONTROL MODULE (ADDRESSABLE)	
9	FIRE FIGHTING JACK	
10	RELAY MODULE (ADDRESSABLE)	

**NOTE :**  
 1. FD = FIRE RATED DOORS (Min. 2 hrs. Fire rating As/N.B.C.)  
 NO. OF F.H.C = 21 NOS.

For KUMAR ENDOOR PVT. LTD.  
 RAJINDER KUMAR  
 CA/2490/75

CERTIFIED THAT THESE PLANS ARE AS PER ORIGINAL PLANS APPROVED BY DG, TCP, CHANDIGARH VIDE MEMO NO. ZP-1267/JD(RA)/2023/1591 DATED 17-01-2023  
 RAJINDER KUMAR CA/2490/75  
 ARCHITECT SIG.

- NOTES & REFERENCES**
- ALL DRAWINGS ARE TO BE READ, NOT TO BE MEASURED.
  - ALL DIMENSIONS ARE IN MM UNLESS MENTIONED.
  - 230MM / 115MM BRICK AND 200MM BLOCK WORK ARE USED FOR WALLS.
  - 100% STANDBY GENERATOR ARE PROVIDED FOR COMMON SERVICES (FIRE FIGHTING, LIFTS, LIGHTING AND VENTILATION) AND ALL ELECTRICAL INSTALLATIONS SHALL BE AS PER PROVISION OF NBC.
  - FIRE FIGHTING / SAFETY PROVISIONS WILL BE AS PER RELEVANT NBC PROVISIONS.
  - BASEMENT AREA SHALL BE MECHANICALLY VENTILATED AS PER RELEVANT CODE.
  - ALL TOILETS ARE VENTILATED AS PER HARYANA BUILDING CODE 2017.
  - ENTIRE BUILDING HAS AUTOMATIC SPRINKLER SYSTEM AS PER NBC.
  - BUILDING WILL BE DESIGNED/STRUCTURED AS PER RELEVANT IS CODES FOR EARTHQUAKE RESISTANCE.
  - SOLAR PANELS OF REQUIRED CAPACITY SHALL BE PROVIDED ON ROOF TOP AS PER HARYANA / ZONING NORMS.
  - ALL HANDICAP RAMPS SHALL BE PROVIDED WITH RAILINGS.
  - TRAVEL DISTANCE COMPLIANCE TO NBC 2016 FOR FULLY SPRINKLED COMMERCIAL BUILDING.
  - WATER HARVESTING SYSTEM SOLAR WATER SYSTEM AND LED LIGHTING WILL BE PROVIDED AS REQUIRED.
  - BASEMENT FLOOR AREA SHALL BE MECHANICALLY VENTILATED AND 100% LIGHTING BACKUP.
- NOTE: 40.00 (FINISHED GROUND FLOOR LEVEL) IN CORRESPONDENCE TO +101.20M

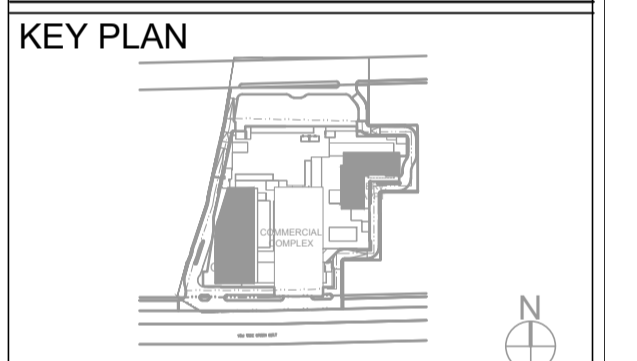

**ARCHITECT:**

**RKA**  
 RAJINDER KUMAR ASSOCIATES  
 ARCHITECTS B-6/17 Shopping Centre  
 Sandjarjung Enclave  
 New Delhi 110029 India  
 DESIGNERS T 91 11 2612930  
 ENGINEERS T 91 11 2612931  
 F 91 11 26186874

**PROJECT NAME :**  
 REVISED BUILDING PLAN  
 UNDER TRANSIT ORIENTED DEVELOPMENT  
 (TOD) POLICY DATED 09.02.2016 FOR  
 COMMERCIAL COLONY AREA MEASURING  
 7.84875 ACRES (LICENCE NO 71 OF 2018  
 DATED 25/10/2018) IN SECTOR-71,  
 GURUGRAM MANESAR URBAN COMPLEX  
 BEING DEVELOPED BY ROSHNI BUILDERS  
 PVT.LTD. AND OTHERS IN COLLABORATION  
 WITH ROSHNI BUILDERS PVT.LTD.

**ARCHITECTURE DRAWING:**  
 REVISED SUBMISSION

**DRAWING TITLE :**  
**BASEMENT-01  
 FIRE FIGHTING LAYOUT**

SCALE :- 1:200 DATED :- 30-11-2021

DEALT BY :

DWG NO. **A1-03** Rev No. **R0**

SIGNATURE AND SEAL OF ARCHITECT SIGNATURE OF OWNER

RAJINDER KUMAR CA/2490/75

**NON FIRE DOOR SCHEDULE**

S.NO	LEGEND	SIZE (MM)	SELL (MM)	LEVEL (MM)	REMARKS	FIRE RATING
1	FD1	1200 X 2100	0	+2100	STAIRCASE	2 HRS
2	FD2	1200 X 2100	0	+2100	ELECTRICAL ROOM	2 HRS
3	FD3	1200 X 2100	0	+2100	AC PLANT ROOM	2 HRS
4	FD4	1500 X 2100	0	+2100	ASH PLANT ROOM	2 HRS
5	FD5	2400 X 2100	0	+2100	ASH WAREHOUSE	2 HRS
6	FD6	3000 X 2100	0	+2100	AC PLANT ROOM	2 HRS
7	FD7	1800 X 2100	0	+2100	OFFICE LIFT LOBBY	2 HRS
8	FD8	1800 X 2100	0	+2100	OFFICE LIFT LOBBY	2 HRS
9	FD9	1800 X 2100	0	+2100	SERVICE APARTMENT SERVICE LIFT LOBBY	2 HRS
10	FD10	1800 X 2100	0	+2100	SERVICE APARTMENT SERVICE LIFT LOBBY	2 HRS
11	FD11	1200 X 2100	0	+2100	RETAIL	2 HRS
12	FD12	1200 X 2100	0	+2100	RETAIL	2 HRS
13	FD13	3000 X 3000	0	+3000	SIG ROOM	2 HRS
14	FD14	1200 X 2100	0	+2100	SIG OPERATOR ROOM	2 HRS
15	FD15	1800 X 2100	0	+2100	DIG ROOM/HALL	2 HRS
16	FD16	3000 X 3000	0	+3000	PRINT ROOM	2 HRS
17	FD17	2500 X 2100	0	+2100	L.T.D.G PANEL ROOM	2 HRS
18	FD18	1200 X 2100	0	+2100	TRANSFORMER ROOM	2 HRS
19	FD19	1800 X 2100	0	+2100	ELECTRICAL SHAFT	2 HRS
20	FD19	900 X 2100	0	+2100	L.V SHAFT	2 HRS
21	FD19	1800 X 2100	0	+2100	STP	2 HRS

**FIRE DOOR SCHEDULE**

S.NO	LEGEND	SIZE (MM)	SELL (MM)	LEVEL (MM)	REMARKS	FIRE RATING
1	FD1	1200 X 2100	0	+2100	STAIRCASE	2 HRS
2	FD2	1200 X 2100	0	+2100	ELECTRICAL ROOM	2 HRS
3	FD3	1200 X 2100	0	+2100	AC PLANT ROOM	2 HRS
4	FD4	1500 X 2100	0	+2100	ASH PLANT ROOM	2 HRS
5	FD5	2400 X 2100	0	+2100	ASH WAREHOUSE	2 HRS
6	FD6	3000 X 2100	0	+2100	AC PLANT ROOM	2 HRS
7	FD7	1800 X 2100	0	+2100	OFFICE LIFT LOBBY	2 HRS
8	FD8	1800 X 2100	0	+2100	OFFICE LIFT LOBBY	2 HRS
9	FD9	1800 X 2100	0	+2100	SERVICE APARTMENT SERVICE LIFT LOBBY	2 HRS
10	FD10	1800 X 2100	0	+2100	SERVICE APARTMENT SERVICE LIFT LOBBY	2 HRS
11	FD11	1200 X 2100	0	+2100	RETAIL	2 HRS
12	FD12	1200 X 2100	0	+2100	RETAIL	2 HRS
13	FD13	3000 X 3000	0	+3000	SIG ROOM	2 HRS
14	FD14	1200 X 2100	0	+2100	SIG OPERATOR ROOM	2 HRS
15	FD15	1800 X 2100	0	+2100	DIG ROOM/HALL	2 HRS
16	FD16	3000 X 3000	0	+3000	PRINT ROOM	2 HRS
17	FD17	2500 X 2100	0	+2100	L.T.D.G PANEL ROOM	2 HRS
18	FD18	1200 X 2100	0	+2100	TRANSFORMER ROOM	2 HRS
19	FD19	1800 X 2100	0	+2100	ELECTRICAL SHAFT	2 HRS
20	FD19	900 X 2100	0	+2100	L.V SHAFT	2 HRS
21	FD19	1800 X 2100	0	+2100	STP	2 HRS

- FIRE FIGHTING LEGEND**
- (A) 1000 M.S FIRE PIPE (FOR RETAIL /CINEMA AREA)
  - (B) 1500 M.S FIRE PIPE (LOWER ZONE) OFFICE BLOCK / SERVICES APARTMENT
  - (C) 1500 M.S SPRINKLER PIPE (LOWER ZONE) OFFICE BLOCK
  - (D) 800 DRAIN PIPE
  - (E) 1500 M.S FIRE PIPE (HIGH ZONE) OFFICE BLOCK
  - (F) 1500 M.S SPRINKLER PIPE (HIGH ZONE)
  - FIRE HOSE CABINET
  - UP-RIGHT TYPE SPRINKLER
  - PENDENT TYPE SPRINKLER
  - SIDE WALL TYPE SPRINKLER
  - ▲ AIR CUSHION TANK
  - ▲V AIR RELEASE VALVE
  - 4.5 KG CO2 FIRE EXTINGUISHER
  - 6KG ABC TYPE EXTINGUISHER
  - FUTURE CONNECTION (TYP)

**LEGEND**

	O.C RECEIVED MEMO-1267(AO/RA) (2021/31358/13-12-2021)
	REVISED SUBMISSION

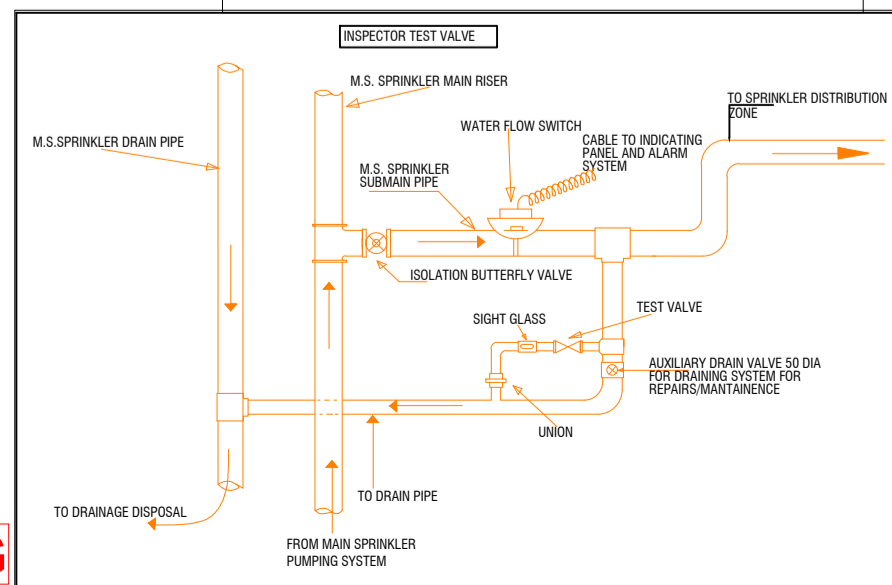

**FIRE SUBMISSION DRAWING**