

DEMARICATION PLAN

- A) Total Land Applied for Licence(As per L.O.I) = 14.4125 Acres
- B) Total Area of Site as per Demarcation Plan = 14.4125 Acres(58325.407 Sqmts)
- C) Area under 24 Metre wide Road = 76.466 Sqmts

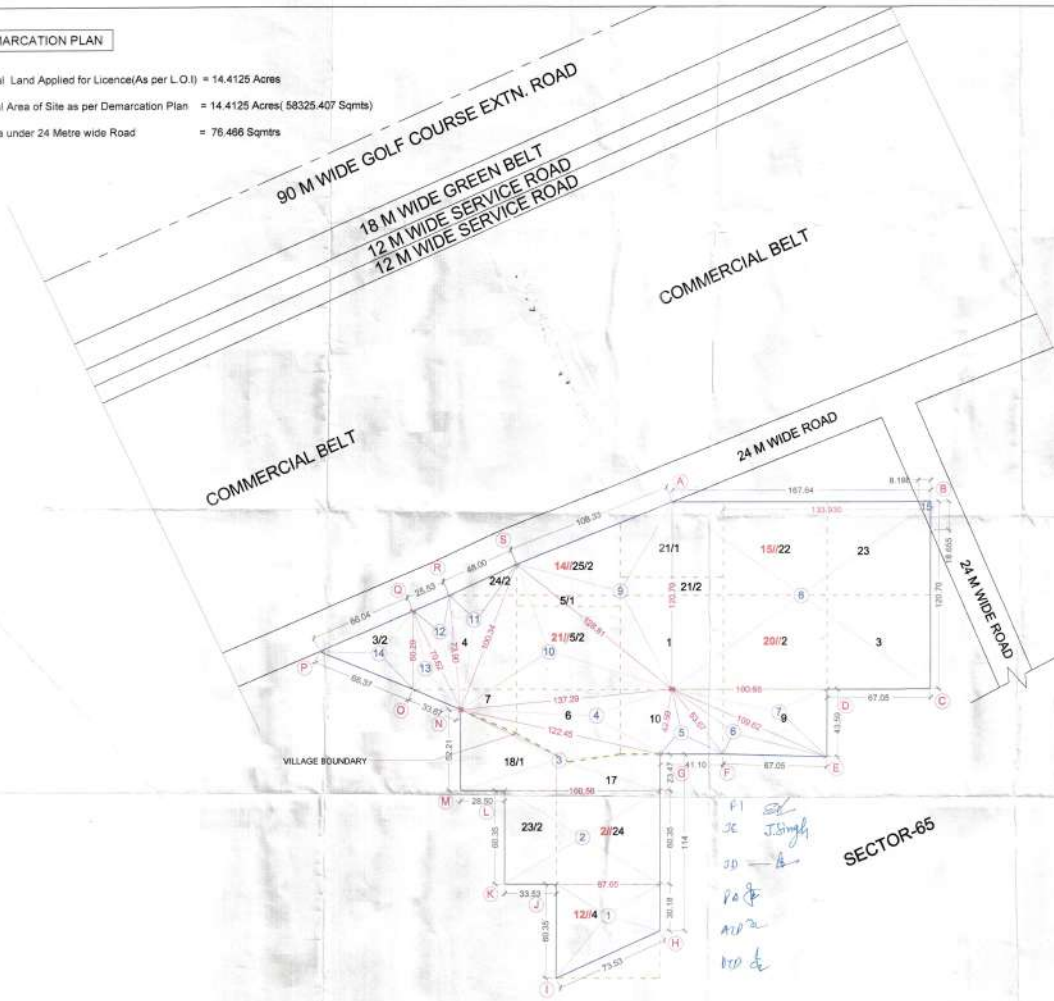

AREA STATEMENTS:-	
Detail-1 (Quadrilateral) Area = $(30.18 + 40.35)/2 \times 47.05$	= 3036.018 Sqmt
Detail-2 (Rectangle) Area = 100.58×60.35	= 6070.003 Sqmt
Detail-3 (Quadrilateral) Area = $(22.47 + 42.21)/2 \times 129.08$	= 4884.387 Sqmt
Detail-4 (Triangle) $S = (172.45 + 137.29 + 42.89)/2 = 181.145$ Area = $181.145 \times 28.716 \times 13.875 \times 106.575$	= 2557.181 Sqmt
Detail-5 (Triangle) $S = (42.59 + 41.75 + 33.47)/2 = 48.88$ Area = $48.88 \times 24.09 \times 27.58 \times 15.01$	= 861.271 Sqmt
Detail-6 (Triangle) $S = (25.47 + 47.06 + 109.62)/2 = 115.185$ Area = $115.185 \times 41.315 \times 48.105 \times 6.565$	= 1377.261 Sqmt
Detail-7 (Triangle) Area = $(100.89 \times 45.59)/2$	= 2192.359 Sqmt
Detail-8 (Rectangle) Area = 182.64×105.70	= 30334.148 Sqmt
Detail-9 (Triangle) $S = (120.70 + 125.81 + 108.35)/2 = 178.92$ Area = $178.92 \times 88.22 \times 82.11 \times 70.59$	= 6070.149 Sqmt
Detail-10 (Triangle) $S = (158.81 + 100.34 + 137.29)/2 = 183.22$ Area = $183.22 \times 84.41 \times 82.88 \times 43.92$	= 6160.258 Sqmt
Detail-11 (Triangle) $S = (105.34 + 48.10 + 73.90)/2 = 111.12$ Area = $111.12 \times 10.78 \times 43.12 \times 37.22$	= 1677.557 Sqmt
Detail-12 (Triangle) $S = (70.42 + 25.53 + 75.90)/2 = 88.025$ Area = $88.025 \times 14.453 \times 49.48 \times 11.135$	= 900.368 Sqmt
Detail-13 (Triangle) $S = (50.29 + 70.43 + 23.47)/2 = 77.29$ Area = $77.29 \times 27.00 \times 46.47 \times 43.62$	= 779.201 Sqmt
Detail-14 (Triangle) $S = (64.54 + 43.27 + 55.29)/2 = 90.85$ Area = $90.85 \times 24.81 \times 25.48 \times 40.56$	= 1526.246 Sqmt
Detail-15 (Triangle) Area = $(8.178 \times 18.455)/2$	= 76.466 Sqmt

Total Area $(1+2+3+4+5+6+7+8+9+10+11+12+13+14) = 68325.407$ IN SQM.
(14.4125 Acres)
Area Under 24 Meter Wide Road (in Sq. Mts. - 15) = 76.466 Sqmt.

PROJECT NAME AND ADDRESS
DEMARICATION PLAN OF BETTING UP 66X LAND USE (70% RESIDENTIAL, 30% COMMERCIAL) COLONY ANNA MEARINGS 14.4125 ACRES IN THE REVENUE ESTATE OF VILLAGE MADHAWA & BACHHAMPUR, SECTOR - 65, GURUKRISHNA APPROVED VIDE CII NO. LC-3281-G-6888-2017/7320 DATED 12.04.2017 FALLING IN MADHAWA NO. 14262, 2602, 180 2111, 22, 23, 2001, 2, 3, 4, 5, 21/151 D2, 4, 5, 6, 7, IN VILLAGE BACHHAMPUR AND KHARSA NO. 2017, 181, 202, 204, 204+ IN VILLAGE MADHAWA

OWNER NAME
MANGLAM MULTIPLEX PVT. LTD

AUTHORIZED SIGNATORY
[Signature]

ARCHITECT'S SIGNATURE & SEAL
[Signature]
Rajiv K. Bajaj Archt.
Reg. No. CA/149/18/26

DRAWING TITLE DEMARICATION PLAN	REVISION R 0
SCALE 1 : 1000 on A1	NORTH