

Area Detail			
Description	Factor	Acres	Sq.Mts.
Site Area		2.1	8498.385
Permissible Ground Coverage	35.0%		2974.435
Permissible FAR	150		12747.578
Proposed Ground Coverage	35.0%		2974.380
Proposed FAR	150		12747.578

Area Chart									
	X(MM)	Y(MM)	FORMULAE APPLIED	PROPOSED GROUND COVERAGE PER SCO (SQMT)	PROPOSED FAR PER SCO (SQMT)	NO OF SCOS	PROPOSED GROUND COVERAGE PER SCO x NO OF SCOS (SQMT)	PROPOSED FAR PER SCO x NO OF SCOS (SQMT)	
A	6.000	18.000	X * Y	108.000	462.871	17	1836.000	7868.807	
B	5.500	15.000	X * Y	82.500	353.571	7	577.500	2475.000	
C	6.000	15.580	X * Y	93.480	400.629	6	560.880	2403.771	
TOTAL FAR 2.100 ACRES							1217.071	5037.578	
UTILITY BLOCK (PUBLIC TOILET & AMENITIES) FREE OF FAR & GROUND COVERAGE							50.386	50.386	
OPEN AREA INCLUDING VEHICULAR CIRCULATION, PARKING, PUBLIC AMENITIES & SERVICES	SITE AREA-PROPOSED GROUND COVERAGE= OPEN AREA						8498.385-2974.380	5524.005	65%

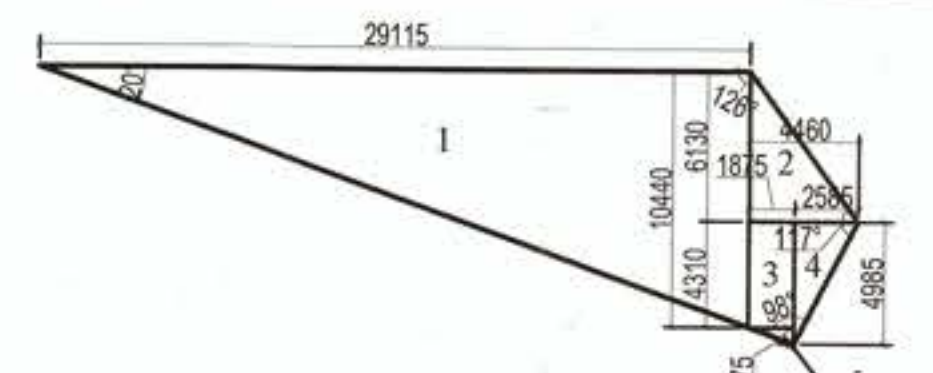
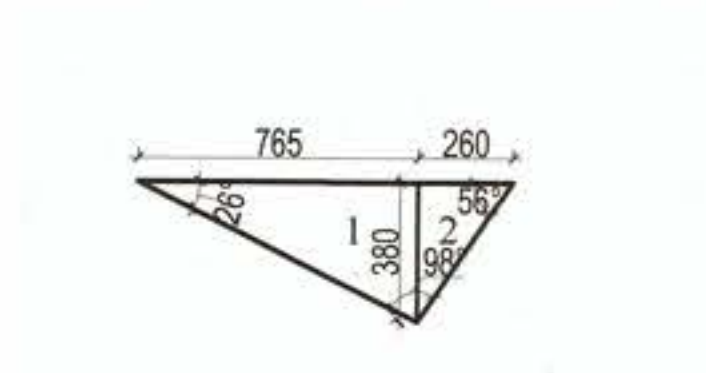
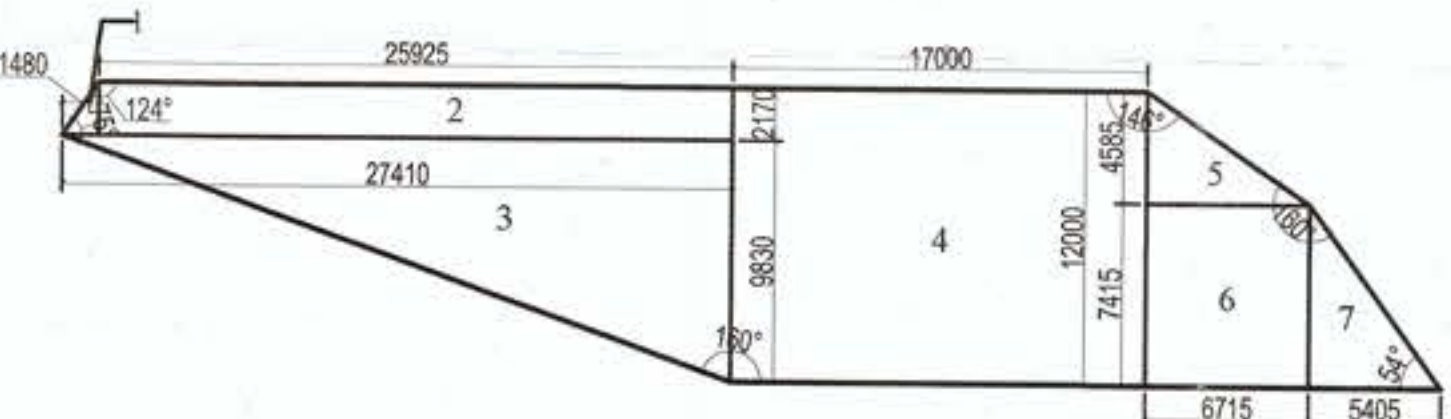
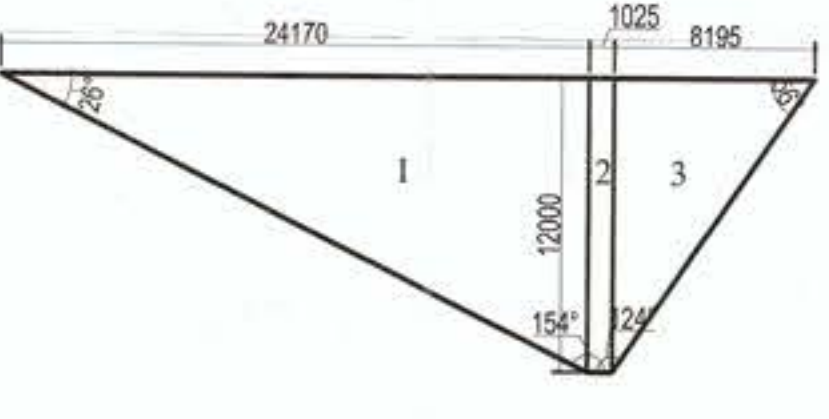
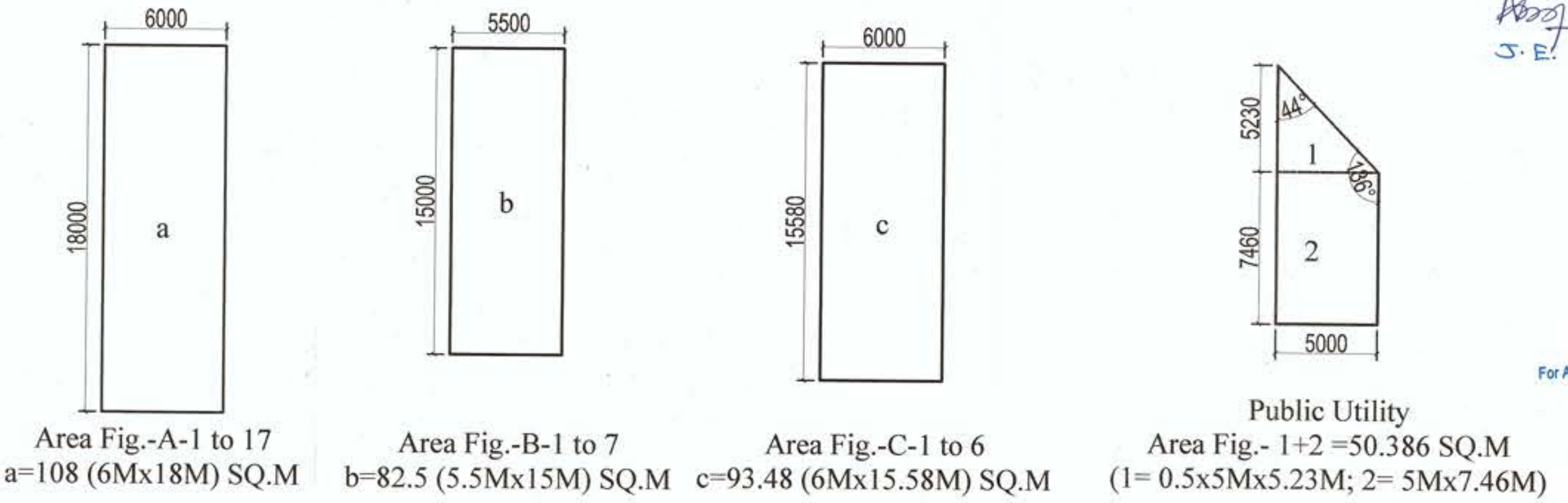

Detail of applied land:
 Total area of applied site=2.1 acres
 Area under 12m wide service road (D1+D2)=0.17 acres (688.298 sq.m)
 Area under 60m wide road (E1+E2)=0.044 acres (181.002 sq.m)

LEGEND:
 All Dimension are in Millimeter .
 Scheme Boundary Shown as
 Area Under Ground Coverage Shown as

Principal Architect:
 DESIGN FORUM INTERNATIONAL
 K-47, KAILASH COLONY, NEW DELHI-110048
 PHONE NO.: 011-46556600
 OWNER'S SIGNATURE:
 ARCHITECT'S SIGNATURE:
 For Action Constructwell Private Limited
 Director/Authorised Signatory

CLIENT:
M/S ACTION CONSTRUCTWELL PVT. LTD.
 PROJECT:
 UTILIZATION PLAN OF COMMERCIAL COLONY M/S ACTION CONSTRUCTWELL PVT. LTD.ON VILLAGE NAHARPUR KASAN ,SEC- 81, TEHSIL GURGAON, DISST. - GURGAON. RECT. NO. 2 KILA NO. 21/2 (1-9), 22(0-18) RECT. NO. 8 KILA NO. 1/2/2(2-10) , 2(5-9), 8/3(1-5) , 9/1(3-8), 12/1/2(1-17) TOTAL 16 KANAL 16 MARLA OR 2.1 ACRES.

DRAWING TITLE:
DEMARICATION PLAN
 North
 SCALE : 1:300
 DATE : 18-07-2022