

SUMMARY SHEET			
DESCRIPTION	FACTOR	ACRES	SQ.MT.
SITE AREA (net planned)		2.5381	10271.41
PERMISSIBLE G.C.	35.00%	0.88833	3594.99
PERMISSIBLE F.A.R.	1.50		15407.115
PROPOSED G.C.	34.997%		3594.761
PROPOSED F.A.R.	1.499		15406.067
TOTAL NO. OF PLOTS			33
RATIO OF F.A.R. DISTRIBUTION ON 1.0 SQ.MT. OF GROUND COVERAGE			
			4.2857

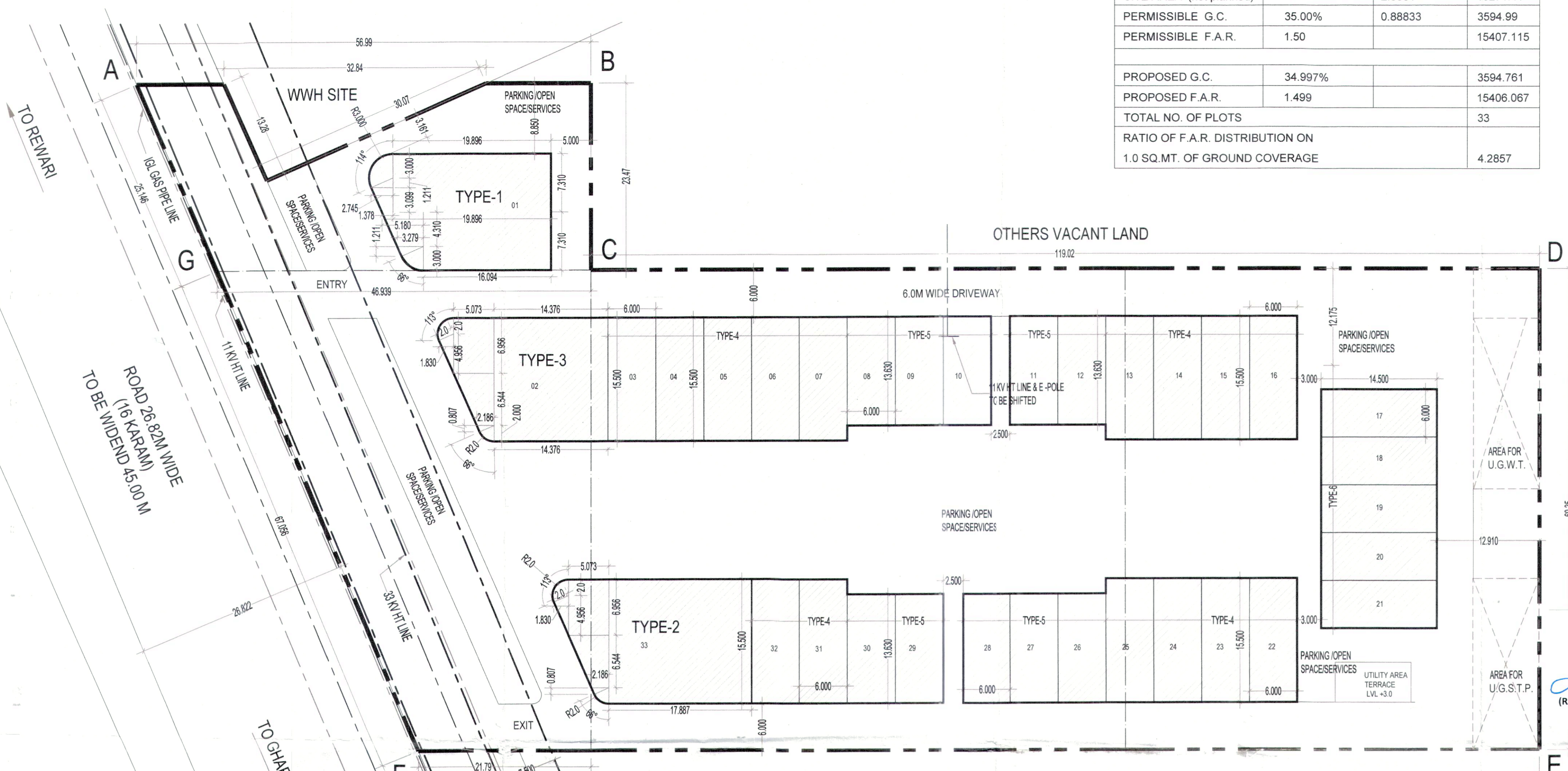

OTHERS VACANT LAND

(RAM AVTAR BASSI) AD (HQ)
 (RAKESH BANSAL) ATP (HQ)
 (PARVEEN KUMAR) DTP (HQ)
 (HITESH SHARMA) STP (HQ)
 (SINGH) DTP (HR)
 (K. MAKRAND PANDURANG, IAS) DTCP (HR)

LC-4545
 L.no. 115/10-08-2022
 DRG. NO:- DTP 8256 DATED:- 16-08-22

SITE LAYOUT
 CLU GRANTED SITE OF GLH PUBLIC SCHOOL

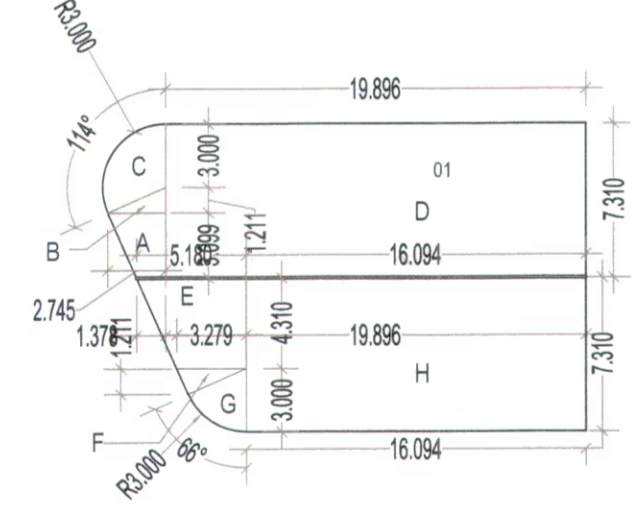

TYPE-1 AREA DIAGRAM

TYPE-1 AREA DETAIL					
S.N.O.	NO.	PREFIX	LENGTH	BREATH	AREA (SQM)
ADDITION					
A	1		(2.745+1.378)/2	3.099	6.389
B	1	0.5	2.745	1.211	1.662
C	1	0.994	3	3	8.949
D	1	1	19.896	7.31	145.440
E	1	(5.180+3.279)/2	4.31	18.229	
F	1	0.5	3.279	1.211	1.985
G	1	0.576	3	3	5.181
H	1	1	16.094	7.31	117.647
TOTAL TYPE-1 AREA					305.482

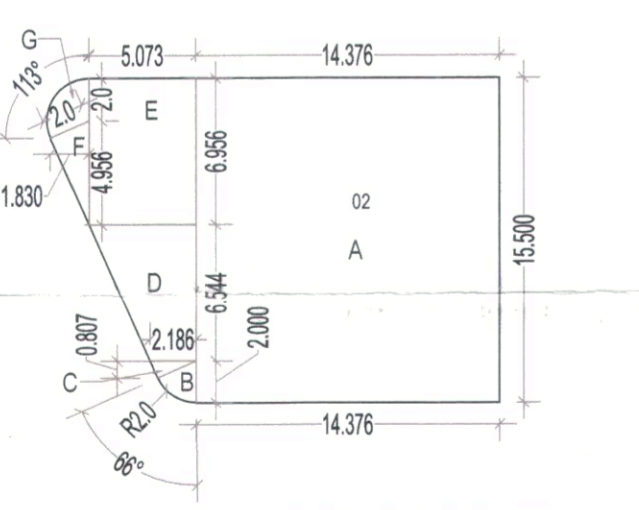

TYPE-3 AREA DIAGRAM

TYPE-3 AREA DETAIL					
S.N.O.	NO.	PREFIX	LENGTH	BREATH	AREA (SQM)
A	1	1	15.5	14.376	222.828
B	1	0.576	2.00	2.00	2.303
C	1	0.5	0.807	2.186	0.882
D	1	(5.073+2.186)/2	6.544	23.751	
E	1	1	6.956	5.073	35.288
F	1	0.5	4.956	1.83	4.535
G	1	0.986	2.00	2.00	3.942
TOTAL TYPE-7 AREA					293.529

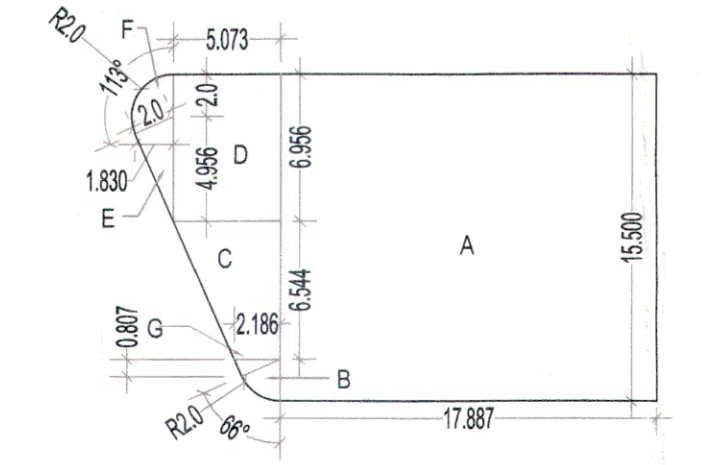

TYPE-2 AREA DIAGRAM

TYPE-2 AREA DETAIL					
S.N.O.	NO.	PREFIX	LENGTH	BREATH	AREA (SQM)
ADDITION					
A	1	1	15.5	17.887	277.249
B	1	0.576	2.00	2.00	2.303
C	1	(5.073+2.186)/2	6.544	23.751	
D	1	1	5.073	6.956	35.288
E	1	0.5	1.830	4.956	4.535
F	1	0.986	2.00	2.00	3.942
G	1	0.5	0.807	2.186	0.882
TOTAL TYPE-7 AREA					347.950

PLOT AREA DETAIL						
PLOT TYPE	PLOT NO.	AREA (SQM)		NO. OF PLOTS	TOTAL AREA (SQ.MT.)	
		LENGTH	BREATH			
TYPE-1	1	AS PER DETAIL		305.482	1	305.482
TYPE-2	2	AS PER DETAIL		347.950	1	347.950
TYPE-3	3	AS PER DETAIL		293.529	1	293.529
TYPE-4	3 TO 7, 13 TO 16, 22 TO 25 & 31 TO 32	6.00	15.500	93.000	15	1395.000
TYPE-5	8 TO 12, 26 TO 30	6.00	13.630	81.780	10	817.800
TYPE-6	17 TO 21	6.00	14.500	87.000	5	435.000
TOTAL				33		3594.761
UTILITY BLOCK (FREE FROM GROUND COVERAGE AND F.A.R.)					ACS	0.888
UTILITY BLOCK		9.5	5	47.5	1	47.5

ROAD WIDENING AREA					
S.N.O.	NO.	PREFIX	LENGTH	BREATH	AREA
ADDITION					
RW1	1	0.5	10.051	25.5340	128.32
RW2	1	0.5	10.274	91.6120	470.61
RW3	1	0.5	10.762	71.2370	383.33
TOTAL ROAD WIDENING AREA					982.26

TOTAL AREA OF LAND		
ACRES	SQ.MT.	
2.5381	10271.41	
0.2427	982.26	
2.2954	9289.15	
0.2427	982.26	
2.5381	10271.41	

SITE AREA					
S.N.O.	NO.	PREFIX	LENGTH	BREATH	AREA
ADDITION					
A	1	1	140.81	60.35	8497.88
B	1	1	46.939	23.47	1101.66
C	1	0.5	25.14	9.17	115.27
D	1	0.5	67.050	22.561	756.36
TOTAL SITE AREA (A)					10471.17
SUBTRACTION (WWH SITE AREA) (B)					
S.N.O.	NO.	PREFIX	LENGTH	BREATH	AREA
1	1	0.5	32.84	12.166	199.76
TOTAL SITE AREA(A-B)					10271.41

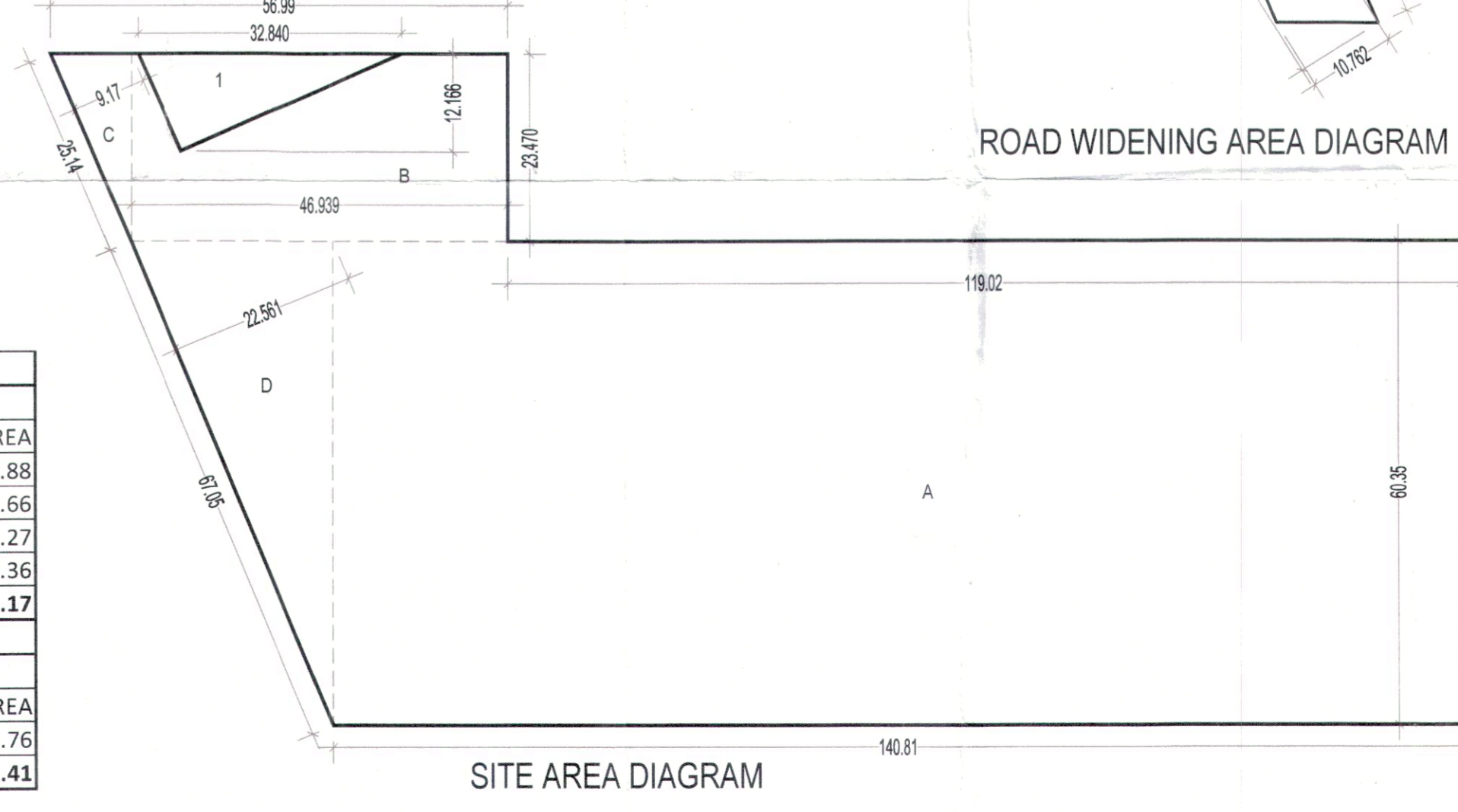

SITE AREA DIAGRAM

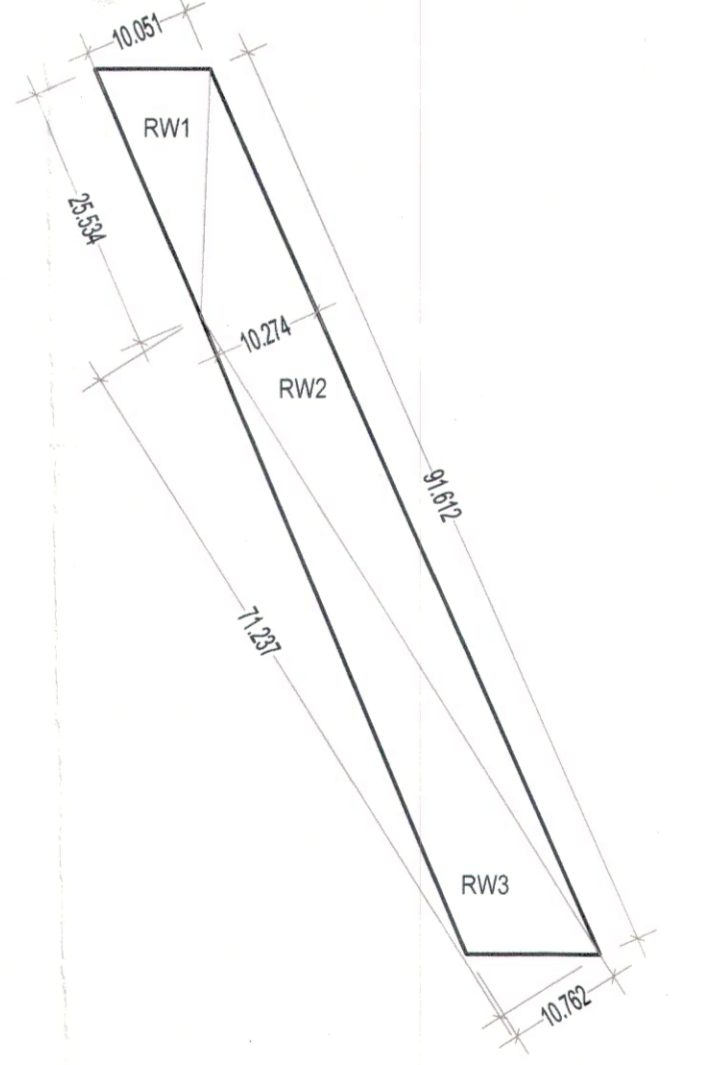

ROAD WIDENING AREA DIAGRAM

NOTES:-

PROJECT:-
 PROPOSED SITE PLOTTED COMMERCIAL COLONY (MEASURING 2.5381 ACRES) BEARING RECTANGLE NO. 23/16/1, 15/2, 22/20 & 19/2 IN REVENUE ESTATE OF VILLAGE PADIYAWAS, SECTOR-25, REWARI, HARYANA. BEING DEVELOPED BY- M/S ONE STOP REALTY SOLUTIONS PVT. LTD. IN COLLABORATION WITH MR. ASHK AND OTHERS

DEVELOPER:-
M/S ONE STOP REALTY SOLUTIONS PVT. LTD.

ARCHITECT:-
VIKAS AHLAWAT ARCHITECTS
 ARCHITECTURE, INTERIORS, PLANNING
 Unit No 303 Ninex Time Center, Suncity Sector-54 Golf Course Road Gurgaon
 O - 01244294293 M. - 9899158486 Mail - ar.vikas.ahlawat@gmail.com

OWNERS SIGNATURE:-
 ARCHITECT SIGNATURE:-
 For ONE STOP REALTY SOLUTIONS PVT. LTD.
 Mr. Signatory Ar. Vikas Ahlawat
 CA/20150925

DRAWING TITLE:
LAYOUT PLAN

DATE:-
APRIL-2022

SCALE:-
1:300 (A1)

SHEET NO.
SP01