

AREA SUMMARY FOR NURSERY SCHOOL

| BUILDING NAME | HEIGHT | NO. OF STORIES | NO. OF STORIES ABOVE GROUND FLOOR | NO. OF STORIES BELOW GROUND FLOOR | TOTAL FLOOR AREA (SQ.M) | TOTAL VOLUME (CU.M) |
|----------------|--------|----------------|-----------------------------------|-----------------------------------|-------------------------|---------------------|
| NURSERY SCHOOL | G+2 | 2 | 1 | 1 | 286.88 | 800.88 |

1. PLOT AREA OF NURSERY SCHOOL = 0.2 ACRE = 800.871 SQ.M
 2. PERM. F.A.R. @ 100% = 800.871 SQ.M
 3. PERM. GROUND COVERAGE @ 33% = 266.286 SQ.M
 4. PERM. F.A.R. @ 100% = 800.871 SQ.M
 5. PROPOSED GROUND COVERAGE = 266.888 SQ.M (33.32%)

AREA CHART

1. PLOT AREA = 81.4 ACRE = 32779.485 SQ.M
 2. PERM. F.A.R. @ 175% = 14252.029 SQ.M
 3. PERM. GROUND COVERAGE @ 35% = 28504.058 SQ.M
 4. PERM. F.A.R. @ 100% = 8140.014 SQ.M
 5. PERM. GROUND COVERAGE @ 33% = 26872.047 SQ.M (77.4537%)
 6. PROP. COMM./SHOPPING BLOCK AREA @ 5% = 4073.977 SQ.M (12.4859%)
 7. PERMISSIBLE DENSITY = 400 PERSON PER ACRE
 8. PROPOSED DENSITY = 380.123 PERSON PER ACRE

PROPOSED DENSITY DETAIL :-

TOTAL NO. OF MAN/DU = 555 DU
 MAIN DU POPULATION = 555 X 5 = 2775 PERSONS.
 PER. SER. PERSONAL REQUIREMENT = 10% OF TOTAL DU, i.e. = 55.5
 PROP. NO. OF SER. PERSONAL = 66
 PROP. SER. PERSONAL POPULATION = 66 X 2 = 132 PERSONS.
 PER. DU IN SLUM @ 15% OF TOTAL DU = 83.25 SN '98 /
 PROP. DU IN SLUM = 86
 PROP. DENS. POPULATION = (86 DU X 2) = 172 PERSONS
TOTAL POPULATION = 2775 + 132 + 172 = 3079 PERSONS
 PROP. DENSITY / ACRE = TOTAL POPULATION / PLOT AREA IN ACRES
 = 3079 / 8.1
 = 380.123 PERSON PER ACRE

PARKING CALCULATIONS :-

PARKING REQUIRED :-
 TOTAL NO. OF RECD. PARKING = 115 ECTS
 MIN. COVD. PARKING REQD. = 75% OF TOTAL ECTS = 86.25 ECTS
PARKING PROPOSED AS FOLLOWS :-
 COVERED PARKING IN STILT = 84.716 ECTS
 COVERED PARKING IN BASEMENT = 18.948 ECTS
TOTAL COVERED PARKING = 103.664 ECTS
 MIN. COVD. PARKING REQD. = 86.25 ECTS
PROPOSED PARKING IN EXCESS OF REQD. = 17.414 ECTS

GREEN AREA CALCULATIONS :-
 RECD. GREEN AREA = 15% OF TOTAL PLOT AREA = 1221.777 SQ.M
 GREEN AREA PROVIDED = 4916.523 SQ.M
GREEN AREA PROVIDED :- 20.08% GREEN AREA PROVIDED :- 4916.523 SQ.M

AREA SUMMARY

| BUILDING NAME | HEIGHT | NO. OF STORIES | NO. OF STORIES ABOVE GROUND FLOOR | NO. OF STORIES BELOW GROUND FLOOR | TOTAL FLOOR AREA (SQ.M) | TOTAL VOLUME (CU.M) |
|--------------------------------|--------|----------------|-----------------------------------|-----------------------------------|-------------------------|---------------------|
| TOWER A | G/S+10 | 5 | 10 | 2 | 510 | 1510 |
| TOWER B | G/S+11 | 1 | 11 | 0 | 55 | 165 |
| TOWER C | G/S+11 | 1 | 11 | 0 | 55 | 165 |
| TOWER D | G/S+11 | 3 | 11 | 0 | 132 | 396 |
| ENS | G+6 | 1 | 6 | 16 | 88 | 264 |
| SUPPORTING COMMUNITY BUILDINGS | G | 1 | 0 | 1 | 66 | 66 |
| TOTAL | | | | | 855 | 2407.578 |

PROPOSED PLAN OF GROUP HOUSING (LICENSE NO. 142 OF 2008 DATED 19.07.2008), AT SECTOR-3, VILLAGE-DHARUHERA, DISTT. - REWAR (HARYANA)

OWNER: M/S BRIHASPATI CONSTRUCTION PVT. LTD.
 SHEET TITLE: SITE PLAN & AREA SHEET
 DRAWING NO: A-01
 SCALE: 1:300
 DATE: []

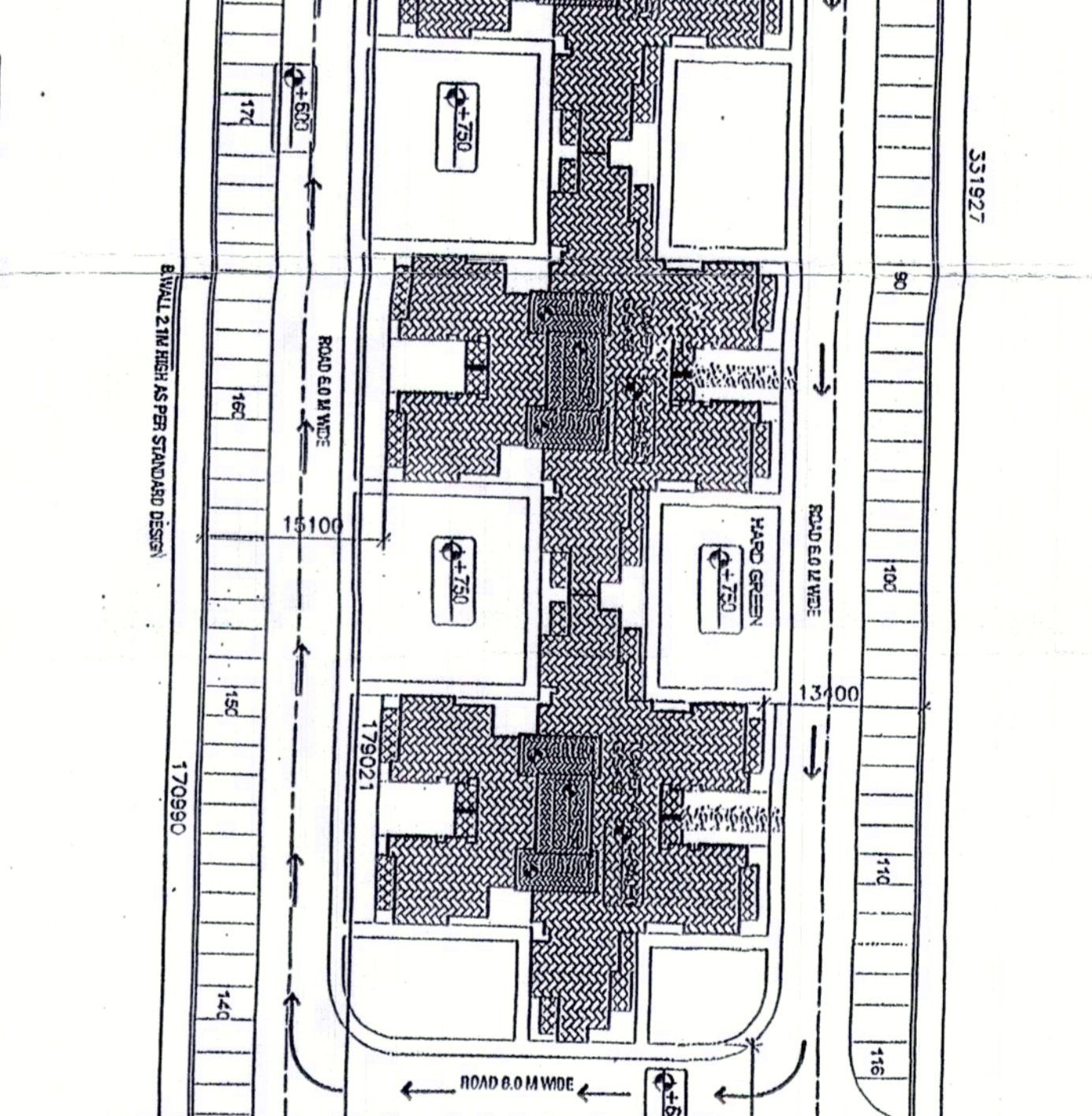

KEY PLAN

Checked and Approved by the Architect/Engineer
 M/S BRIHASPATI CONSTRUCTION PVT. LTD.
 REWAR (HARYANA)

NOTES :- THE PROVISION OF THE SAFETY MEASURES IN THE MAIN STREET BUILDING COMPARE TO THE PROVISIONS OF RULES 1961/78 SHALL BE ENSURED.

OWNER'S SIGN: [Signature]
 ARCHITECT'S SIGN: [Signature]

© & ® THE DRAWINGS IS THE PROPERTY OF THE ARCHITECTS AND ENGINEERS. NO PART OF THIS DRAWING IS TO BE REPRODUCED OR TRANSMITTED IN ANY FORM OR BY ANY MEANS, ELECTRONIC OR MECHANICAL, INCLUDING PHOTOCOPYING, RECORDING, OR BY ANY INFORMATION STORAGE AND RETRIEVAL SYSTEM.