

Village Badshahpur

SECTOR 68

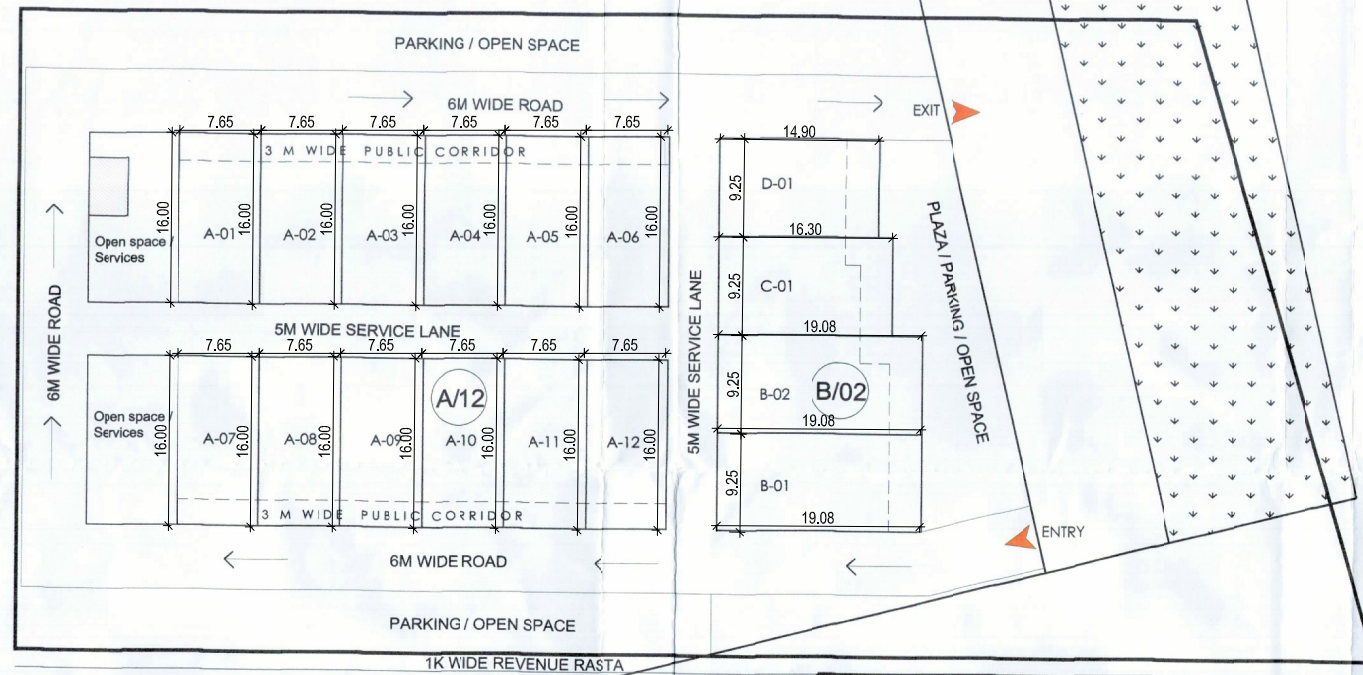

24m Wide Road

60m Wide Sohna Road

To Gurugram

To Sohna

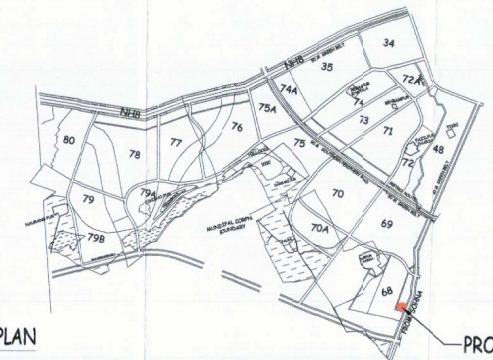

KEY PLAN

PROPOSED SITE

AREA CHART OF TOTAL SCHEME AREA

AREA DESCRIPTION			
DESCRIPTION	FACTOR	ACRES	SQ. MT.
SITE AREA		2.0000	8093.71
AREA GRANTED FOR FAR		1.19	6029.82
PERMISSIBLE G.C.	35% of 149	0.5215	2110.44
PERMISSIBLE F.A.R	1.50		9044.72
PROPOSED G.C.	35%		2110.38
PROPOSED F.A.R	1.50		9044.72
TOTAL NO. OF PLOTS			16
RATIO OF F.A.R DISTRIBUTION ON 1SQ.MT. OF GROUND COVERAGE			4.286

DETAILS OF SCO'S (SECTOR 68)

TYPE	SIZE (M)		AREA		TOTAL NO OF	TOTAL AREA(SQM.)
	LENGTH	WIDTH	SQM.	SQYDS.		
A	16.00	7.65	122.40	146	12	1468.80
B	19.08	9.25	176.49	211	2	352.98
C	16.30	9.25	150.78	180	1	150.78
D	14.90	9.25	137.83	165	1	137.83
GRAND TOTAL					16	2110.38

Sheet Title :-

LAYOUT PLAN

Project

APPLICATION FOR MIGRATION OF 2.00 ACS.
INDEPENDENT COMMERCIAL LICENCE TO PLOTTED
COMMERCIAL COLONY LICENCE (as SCO's)
IN COMMERCIAL BELT OF SECTOR 68,
VILLAGE BADSHAHPUR, GURUGRAM (HARYANA)

SCALE	DATE	DRG NO.	NORTH
NTS	OCT. 2022	SCO/Comm. -01	

(RAM AVTAR BASSI) JD (HQ)
 (SANJAY NARANG) ATP (HQ)
 (R.S. BATT) DTP (HQ)
 (HITESH SHARMA) STP (HQ)
 (P. SINGH) ETP (HR)
 (T.L. SATYAPRAKASH, IAS) DG, TCF (HR)

ARCHITECT
 FAHAD SHAHBAZ
 CA/2008/38330

ARCHITECT

(Authorised Signatory)

AUTHORISED SIGNATORY

Drawn No. 8741 DATED. 15-11-2022

LC-4514

L No. 185/11.11.2022