

SECTOR-88A SCO (3.428 Acres)

AREA PROGRAM				
S.No.	DESCRIPTION		Sq.M.	Acres
1	Total Plot Area	A	13872.60	3.428
2	Area Under Green Belt/Service Road/Sector Road	B	1408.304	0.348
3	Balance Area	(A-B)	12464.298	3.08
4	10% of Licenced Land		1387.26	0.3428
5	Net Planned Area		13851.56	3.4228
6	Permissible Ground Coverage	35.00%	4848.05	
7	Proposed Ground Coverage	35.00%	4848.00	
8	Permissible FAR on land Area	1.50	20777.34	
9	Proposed FAR	1.407	19493.96	
10	Utility/Toilet Block		45.00	
11	Permissible (Parking/Services/Open Space)	65.00%	9003.51	
12	Proposed (Parking/Services/Open Space)	65.00%	9003.56	

DTP *[Signature]*
 ATP *[Signature]*
 AD *[Signature]*
 JE *[Signature]*

VILLAGE	AREA UNDER 12.0M SERVICE ROAD			
HARSARU	87//18MIN	=	236.271	SQM
	87//16MIN	=	6.140	SQM
	Total		242.411	SQM
	AREA UNDER 18.0M GREEN BELT			
HARSARU	87//18MIN	=	160.290	SQM
	87//23MIN	=	284.420	SQM
	Total		444.710	SQM
	AREA UNDER 75.0M WIDE ROAD			
HARSARU	87//23MIN	=	720.520	SQM
	Total		1407.641	SQM
			0.348	ACRES

PLOT AREA	=	3.4280	ACRES		=	13872.60	SQM
AREA UNDER ZONING							
A	67.05	X	120.70		=	8092.935	SQM
B	67.05	X	60.35		=	4046.468	SQM
C	6.70	X	51.97		=	348.199	SQM
D	6.70	X	15.08		=	101.036	SQM
E	15.08	+	16.31	÷ 2	X	6.740	= 105.784 SQM
F	16.31	+	15.05	÷ 2	X	11.340	= 177.811 SQM
G	41.47	+	40.23	÷ 2	X	24.770	= 1011.855 SQM
						13884.088	SQM
						3.431	ACRES
AREA UNDER 12.0M SERVICE ROAD							
a	1.69	X	7.27	÷ 2		6.143	SQM
b	11.89	X	2.751	÷ 2		16.355	SQM
c	11.11	+	9.55	÷ 2	X	6.700	= 69.211 SQM
d	8.57	+	7.35	÷ 2	X	6.740	= 53.650 SQM
e	7.32	+	8.57	÷ 2	X	11.340	= 90.096 SQM
f	1.08	X	12.88	÷ 2		6.955	SQM
						242.411	SQM
AREA UNDER 18.0M GREEN BELT							
g	2.77	X	11.89	÷ 2		16.468	SQM
h	1.69	+	2.77	÷ 2	X	12.880	= 28.722 SQM
i	13.975	+	18.06	÷ 2	X	11.560	= 185.162 SQM
j	13.975	+	18.48	÷ 2	X	13.210	= 214.365 SQM
					Total	444.718	SQM
AREA UNDER 75.0M WIDE ROAD							
k	13.582	+	11.070	÷ 2	X	13.210	= 162.826 SQM
l	13.180	+	13.582	÷ 2	X	11.560	= 154.684 SQM
m	16.890	+	15.650	÷ 2	X	24.770	= 403.008 SQM
					Total	720.519	SQM
						1407.647	SQM
						0.348	ACRES

PLOT DETAIL

TYPE	Size -Mt	Sqmt	NO	TOTAL SQMT
A	6.00	18.00	14	1512.00
B	6.00	14.00	33	2772.00
C	6.00	12.00	7	504.00
M	6.00	10.00	60.00	600.00
Total			55	4848.00

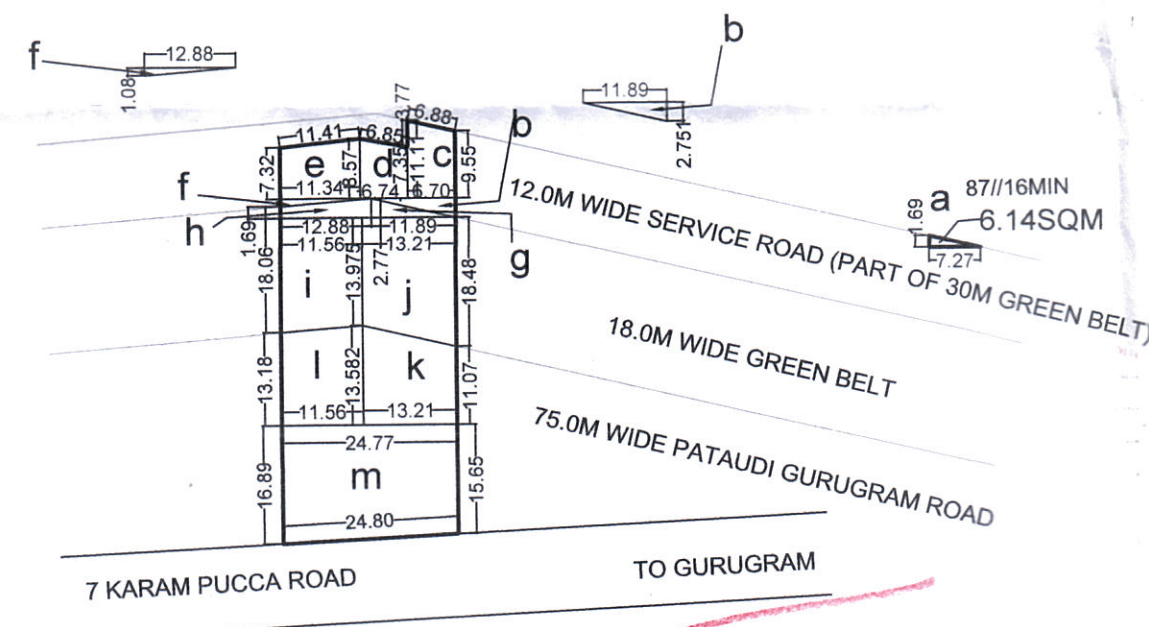

PROJECT NAME & ADDRESS :

Demarcation plan of Commercial SCO Plotted Colony over an area measuring 3.428 acres.
 (License no.69 of 2022 dated 27.05.2022)
 Site measuring = 3.428 acres
 [Rect/Killa No.87//13MIN (0-2), 14 (8-0), 15 (8-0), 18MINM (1-7.5), 23//1MIN (1-19)
 TOTAL AREA 27 KANAL 8.5MARLA OR TOTAL LAND 3.428 ACRES FALLING IN THE REVENUE ESTATE OF VILLAGE HARSARU SECTOR-88A, DISTRICT GURUGRAM- JMK HOLDING PVT. LTD.]

OWNER NAME :
JMK HOLDING PVT. LTD.

ARCHITECT'S SIGNATURE : _____

DRAWING TITLE :
DEMARICATION PLAN

SCALE : _____ **1 : 1000**

REVISION : _____

NORTH :
 N

18MIN	236.27 SQM
18MIN	160.29 SQM
23MIN	284.42 SQM
87//23MIN	720.52 SQM