

**REVISION & MODIFICATION PLAN OF REGULATORY PLAN FOR INDUSTRIAL PLANNING ZONE (IPZ) AREA - II, INDUSTRIAL ESTATE, LUDHIANA DISTRICT, PUNJAB, INDIA. THE PLAN AREA IS DIVIDED INTO 10 SECTORS (A-J) AND 10 ZONES (G1-G10). THE PLAN IS SUBJECT TO THE APPROVAL OF THE GOVERNMENT OF PUNJAB, INDIA.**

**REVISIONS:**

Sl. No.	Description of Revision	Date
1	Initial Issue	15/08/2023
2	Minor Corrections	20/08/2023
3	Final Approval	25/08/2023

Zone	Color	Symbol	Area (Ha)
G1	Green	Green	150.00
G2	Orange	Orange	120.00
G3	Blue	Blue	100.00
G4	Yellow	Yellow	80.00
G5	Purple	Purple	60.00
G6	Red	Red	40.00
G7	Light Green	Light Green	20.00
G8	Light Blue	Light Blue	10.00
G9	Light Orange	Light Orange	5.00
G10	Light Purple	Light Purple	2.00

**GENERAL NOTES:**

- The plan is subject to the approval of the Government of Punjab, India.
- The plan is subject to the approval of the Local Authorities.
- The plan is subject to the approval of the State Government.
- The plan is subject to the approval of the Central Government.
- The plan is subject to the approval of the International Community.

**LEGEND:**

- Industrial Zone (G1-G10)
- Residential Zone (R1-R10)
- Commercial Zone (C1-C10)
- Public Use Zone (P1-P10)
- Green Zone (G1-G10)
- Water Body
- Open Space
- Infrastructure

**TYPICAL ZONING PLANS:**

**INDUSTRIAL ZONE (G1-G10):**

- G1:** Industrial Zone (Green)
- G2:** Industrial Zone (Orange)
- G3:** Industrial Zone (Blue)
- G4:** Industrial Zone (Yellow)
- G5:** Industrial Zone (Purple)
- G6:** Industrial Zone (Red)
- G7:** Industrial Zone (Light Green)
- G8:** Industrial Zone (Light Blue)
- G9:** Industrial Zone (Light Orange)
- G10:** Industrial Zone (Light Purple)

**RESIDENTIAL ZONE (R1-R10):**

- R1:** Residential Zone (Light Green)
- R2:** Residential Zone (Light Blue)
- R3:** Residential Zone (Light Orange)
- R4:** Residential Zone (Light Purple)
- R5:** Residential Zone (Light Green)
- R6:** Residential Zone (Light Blue)
- R7:** Residential Zone (Light Orange)
- R8:** Residential Zone (Light Purple)
- R9:** Residential Zone (Light Green)
- R10:** Residential Zone (Light Blue)

**COMMERCIAL ZONE (C1-C10):**

- C1:** Commercial Zone (Light Green)
- C2:** Commercial Zone (Light Blue)
- C3:** Commercial Zone (Light Orange)
- C4:** Commercial Zone (Light Purple)
- C5:** Commercial Zone (Light Green)
- C6:** Commercial Zone (Light Blue)
- C7:** Commercial Zone (Light Orange)
- C8:** Commercial Zone (Light Purple)
- C9:** Commercial Zone (Light Green)
- C10:** Commercial Zone (Light Blue)

**PUBLIC USE ZONE (P1-P10):**

- P1:** Public Use Zone (Light Green)
- P2:** Public Use Zone (Light Blue)
- P3:** Public Use Zone (Light Orange)
- P4:** Public Use Zone (Light Purple)
- P5:** Public Use Zone (Light Green)
- P6:** Public Use Zone (Light Blue)
- P7:** Public Use Zone (Light Orange)
- P8:** Public Use Zone (Light Purple)
- P9:** Public Use Zone (Light Green)
- P10:** Public Use Zone (Light Blue)

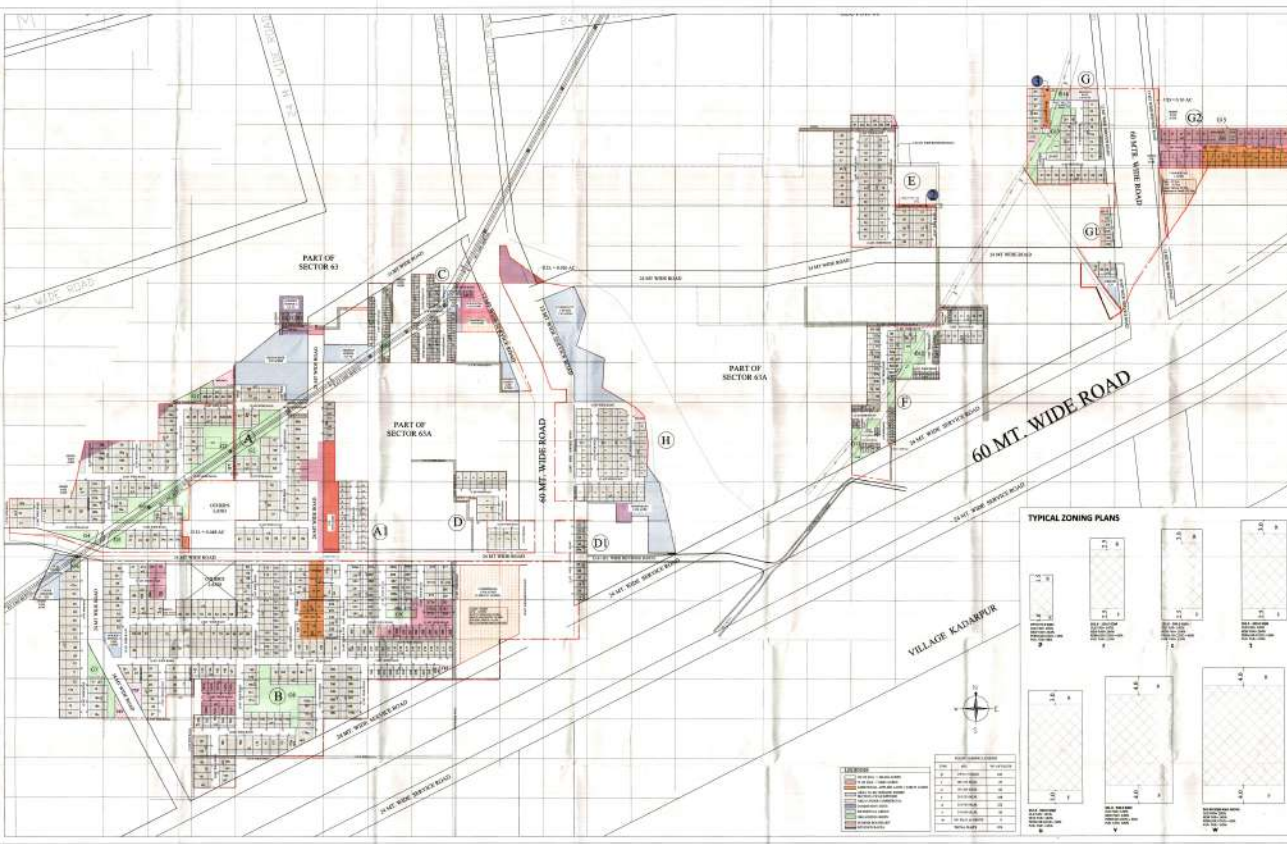

Zone	Color	Symbol	Area (Ha)
G1	Green	Green	150.00
G2	Orange	Orange	120.00
G3	Blue	Blue	100.00
G4	Yellow	Yellow	80.00
G5	Purple	Purple	60.00
G6	Red	Red	40.00
G7	Light Green	Light Green	20.00
G8	Light Blue	Light Blue	10.00
G9	Light Orange	Light Orange	5.00
G10	Light Purple	Light Purple	2.00

Scale: 1:10,000