

TOTAL PLOT AREA		PREVIOUS SANCTION AREA		AREA TO BE PROPOSED	
(IN ACRES)	(IN SQ.MTS)	(IN ACRES)	(IN SQ.MTS)	(IN ACRES)	(IN SQ.MTS)
9.875	3992.6438	8.7875	3405.819	1.0875	4186.8248
0.395	1568.506	0.350	1419.433	0.045	176.0714
4.038	1591.332	4.038	1591.332	0.000	0.000
1.481	594.357	1.481	594.357	0.000	0.000

TOTAL SITE AREA		PREVIOUS SANCTION AREA		AREA TO BE PROPOSED	
Permissible Area (in sq.mts)	Proposed area (in sq.mts)	Permissible Area (in sq.mts)	Proposed area (in sq.mts)	Permissible Area (in sq.mts)	Proposed area (in sq.mts)
3673.315	1021.991	2664.362	1021.991	3673.315	1021.991
1150.924	1150.924	7767.354	7767.354	1150.924	1150.924
87470.23	87470.23	77665.204	77665.204	87470.23	87470.23
8.38	8.38	6.130	6.130	2.250	2.250

TOTAL SITE AREA		PREVIOUS SANCTION AREA		AREA TO BE PROPOSED	
Permissible Area (in sq.mts)	Proposed area (in sq.mts)	Permissible Area (in sq.mts)	Proposed area (in sq.mts)	Permissible Area (in sq.mts)	Proposed area (in sq.mts)
2797.385	2797.385	2484.007	2484.007	2797.385	2797.385
47.950	47.950	42.583	42.583	47.950	47.950
2845.34	2845.34	2526.590	2526.590	2845.34	2845.34
1.70	1.70	1.189	1.189	0.511	0.511

TOTAL SITE AREA		PREVIOUS SANCTION AREA		AREA TO BE PROPOSED	
Permissible Area (in sq.mts)	Proposed area (in sq.mts)	Permissible Area (in sq.mts)	Proposed area (in sq.mts)	Permissible Area (in sq.mts)	Proposed area (in sq.mts)
994.377	938.804	633.554	633.554	994.377	938.804
15	17.38	15	17.00	15	20.18

TOTAL SITE AREA		PREVIOUS SANCTION AREA		AREA TO BE PROPOSED	
Permissible Area (in sq.mts)	Proposed area (in sq.mts)	Permissible Area (in sq.mts)	Proposed area (in sq.mts)	Permissible Area (in sq.mts)	Proposed area (in sq.mts)
1991.322	904.622	1743.608	1743.608	1991.322	904.622
30	24.86	30	23	30	42.30

UNIT SUMMARY	
TOWER NO.	TOTAL AREA (SQ.MTS)
TOWER-1	12000
TOWER-2	12000
TOWER-3	12000
TOWER-4	12000
TOWER-5	12000
TOWER-6	12000
TOWER-7	12000
TOWER-8	12000
TOWER-9	12000
TOWER-10	12000
TOWER-11	12000
TOWER-12	12000
TOWER-13	12000
TOWER-14	12000
TOWER-15	12000
TOWER-16	12000
TOWER-17	12000
TOWER-18	12000
TOWER-19	12000
TOWER-20	12000
TOWER-21	12000
TOWER-22	12000
TOWER-23	12000
TOWER-24	12000
TOWER-25	12000
TOWER-26	12000
TOWER-27	12000
TOWER-28	12000
TOWER-29	12000
TOWER-30	12000
TOWER-31	12000
TOWER-32	12000
TOWER-33	12000
TOWER-34	12000
TOWER-35	12000
TOWER-36	12000
TOWER-37	12000
TOWER-38	12000
TOWER-39	12000
TOWER-40	12000
TOWER-41	12000
TOWER-42	12000
TOWER-43	12000
TOWER-44	12000
TOWER-45	12000
TOWER-46	12000
TOWER-47	12000
TOWER-48	12000
TOWER-49	12000
TOWER-50	12000

BUILTUP AREA SUMMARY	
RESIDENTIAL BUILTUP AREA	PROPOSED BUILTUP AREA
12077.96	12077.96
318.24	318.24
12396.20	12396.20

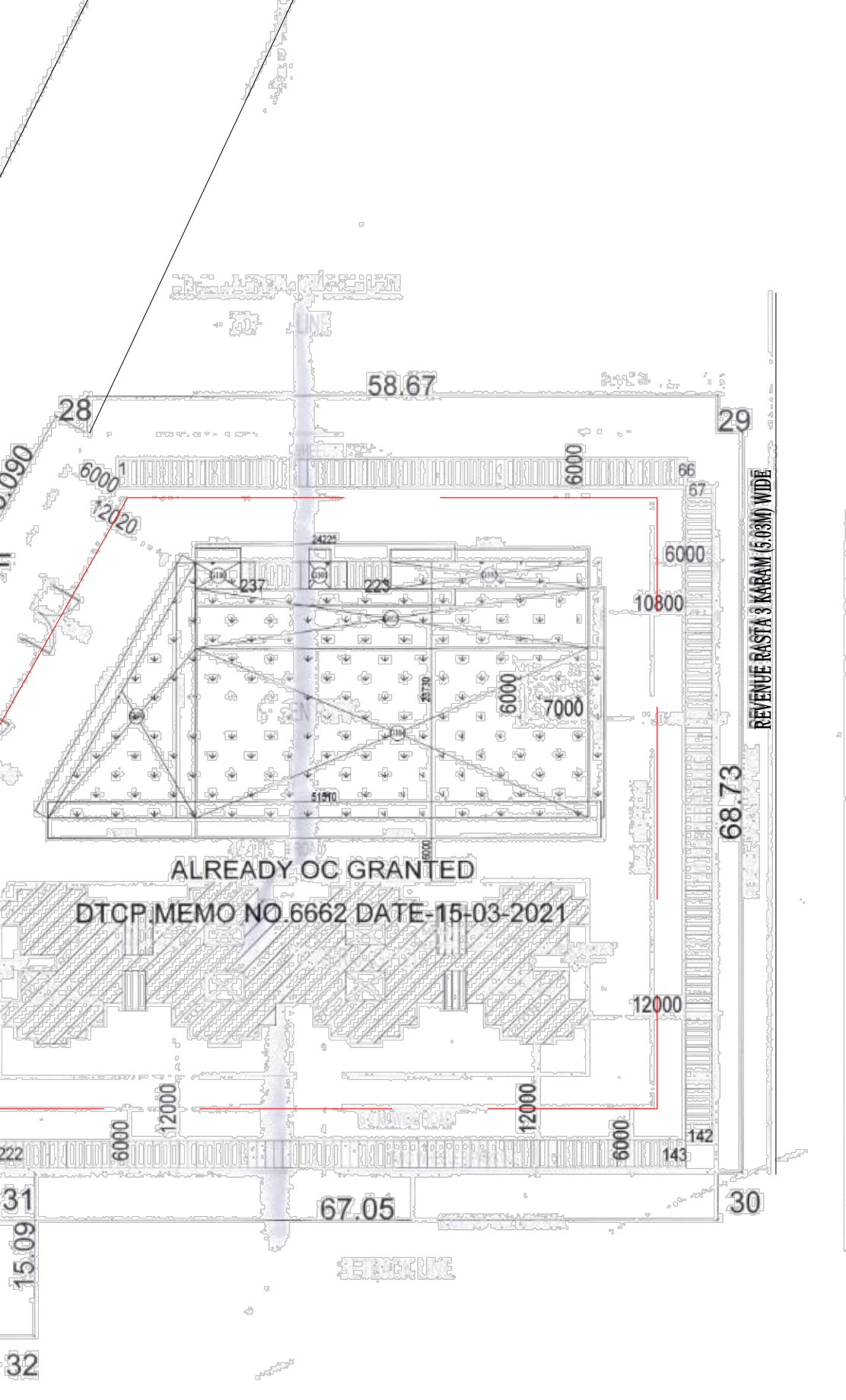
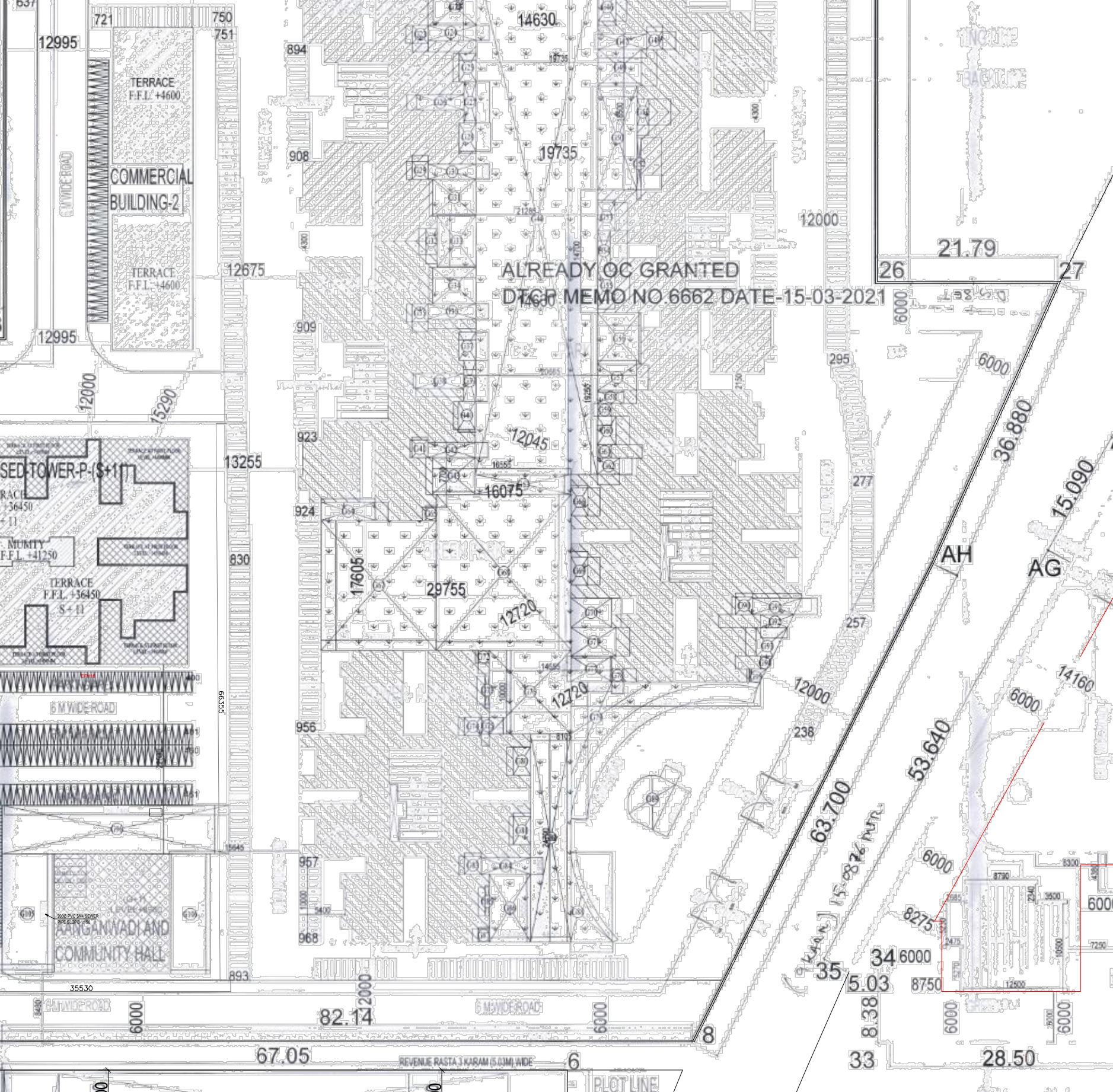
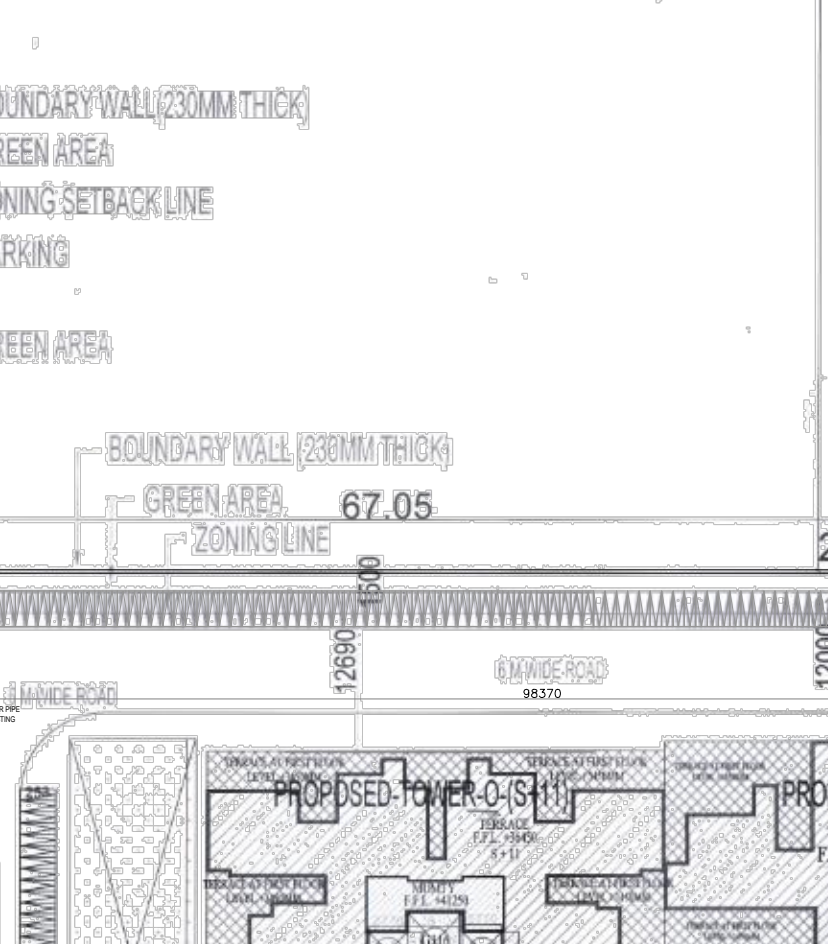
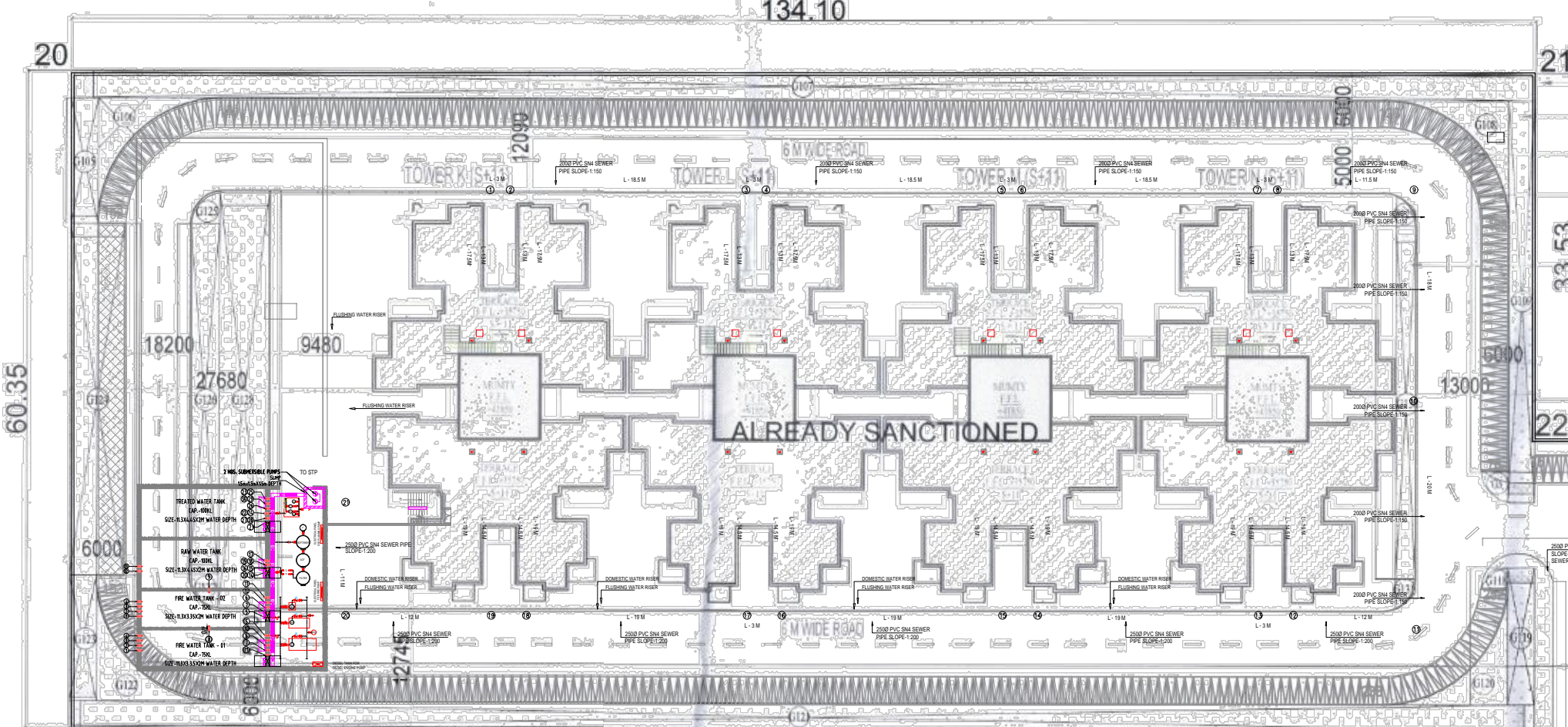

PROPOSED AREA FOR HOUSING												
S.NO.	TOWER NO.	NO OF FLOORS	TYPICAL FLOOR	UNIT PER FLOOR	TOTAL UNITS	GROUND FLOOR FAR	TYPICAL FLOOR FAR	TOTAL FAR	GROUND COVERAGE	HEIGHT IN MTS	MUMTY NON FAR AREA	BUILTUP AREA
1	Q	(S+11)	1st To 11th	11	8	88	31.25	2766.25	32.65	36.45	31.25	4229.12
2	P	(S+11)	1st To 11th	11	8	88	30.51	2765.51	32.65	36.45	30.51	4079.44
3	Q	(S+4)	1st To 4th	4	2	8	18.39	73.56	33.28	15.00	18.39	769.40
TOTAL					162			9795.460	1577.96		80.15	12077.96

PROPOSED AREA FOR COMMERCIAL						
S.NO.	COMMERCIAL NO.	GROUND FLOOR FAR	NO OF FLOORS	TOTAL FAR	GROUND COVERAGE	HEIGHT IN MTS
1	COMMERCIAL-7	318.24	1	318.24	318.24	4.60
TOTAL		318.24		318.24	318.24	

DENSITY CALCULATION FOR 9.48 ACHELAND			
NET PLOT AREA FOR DENSITY OF RESIDENTIAL BUILDING	PROPOSED AREA	ALREADY SANCTIONED AREA	TOTAL
10000	10000	84180	94180
NUMBER OF DW	162	1264	1426
POPULATION @5/UNIT	810	6320	7130
DENSITY PERMISSIBLE	750/900	750/772	750/900
DENSITY ACHIEVED	762/211	750/772	752/109

RESIDENTIAL F.A.R DETAILS						
Residential F.A.R Details	PROPOSED AREA		ALREADY SANCTIONED AREA		TOTAL AREA	
	AREA	UNIT	AREA	UNIT	AREA	UNIT
Tower-A	Sq.mts	7267.82	Sq.mts	7267.82	Sq.mts	Sq.mts
Tower-B	Sq.mts	5163.500	Sq.mts	5163.500	Sq.mts	Sq.mts
Tower-C	Sq.mts	5163.500	Sq.mts	5163.500	Sq.mts	Sq.mts
Tower-D	Sq.mts	6779.640	Sq.mts	6779.640	Sq.mts	Sq.mts
Tower-E	Sq.mts	6710.770	Sq.mts	6710.770	Sq.mts	Sq.mts
Tower-F	Sq.mts	5163.500	Sq.mts	5163.500	Sq.mts	Sq.mts
Tower-G	Sq.mts	5163.500	Sq.mts	5163.500	Sq.mts	Sq.mts
Tower-H	Sq.mts	7267.620	Sq.mts	7267.620	Sq.mts	Sq.mts
Tower-I	Sq.mts	7229.510	Sq.mts	7229.510	Sq.mts	Sq.mts
Tower-J	Sq.mts	5439.011	Sq.mts	5439.011	Sq.mts	Sq.mts
Tower-K	Sq.mts	5439.011	Sq.mts	5439.011	Sq.mts	Sq.mts
Tower-L	Sq.mts	5439.011	Sq.mts	5439.011	Sq.mts	Sq.mts
Tower-M	Sq.mts	5439.011	Sq.mts	5439.011	Sq.mts	Sq.mts
Tower-N	Sq.mts	5439.011	Sq.mts	5439.011	Sq.mts	Sq.mts
Tower-O	3318.93	Sq.mts	Sq.mts	3318.93	Sq.mts	Sq.mts
Tower-P	5926.07	Sq.mts	Sq.mts	5926.07	Sq.mts	Sq.mts
Tower-Q	551.67	Sq.mts	Sq.mts	551.67	Sq.mts	Sq.mts
TOTAL	9796.67		77665.204		87461.874	

PARKING SUMMARY			
TOTAL NO. OF APARTMENTS	NO.	TOWER-O	TOTAL
162	81	81	162
PARKING REQUIRED @0.5 ECS PER DU	40.5	40.5	40.5
PARKING PROVIDED BY AREA	114.51	114.51	114.51
PROPOSED OPEN PARKING AREA	2633.6	2633.6	2633.6
TOTAL NOS. OF PARKING IN OPEN SPACE @2350 M ² /ECS	114	114	114

STILT PARKING AREA			
PROPOSED STILT PARKING	NO.	TOWER-O	TOTAL
168	168	168	168
TOTAL ECS PROVIDED	168	168	168
TOTAL ECS PROVIDED IN STILT AND OPEN	168	168	168
ADDITIONAL ECS PROVIDED (168-81)	87	87	87

AFFORDABLE GROUP HOUSING COLONY SECTOR-92, GURUGRAM									
Area statement for METALLIC ROAD									
S.no.	Description	Type	Number	Length	Height	Breadth	Calculation	Result	UNIT
1	R1	Rectangle	1	33.085	6.000	6.000	Length X breadth	198.390	SQ.MT
2	R2	Rectangle	1	72.880	6.000	6.000	Length X breadth	435.480	SQ.MT
3	R3	Rectangle	1	98.370	6.000	6.000	Length X breadth	590.220	SQ.MT
4	R4	Rectangle	1	66.355	6.000	6.000	Length X breadth	398.130	SQ.MT
5	R5	Rectangle	1	35.530	6.000	6.000	Length X breadth	213.180	SQ.MT
6	R6	Rectangle	1	23.580	6.000	6.000	Length X breadth	141.360	SQ.MT
7	R7	Rectangle	1	21.290	6.000	6.000	Length X breadth	127.740	SQ.MT
Total Addition =								2104.500	SQ.MT
ADD 10 % FOR CURVED ROAD								210.450	SQ.MT
Total Metallic Road Area (A1)=								2314.950	SQ.MT

COMMERCIAL F.A.R AREA DETAILS						
Commercial F.A.R Details	PROPOSED AREA		ALREADY SANCTIONED AREA		TOTAL AREA	
	AREA	UNIT	AREA	UNIT	AREA	UNIT
Commercial-1	Sq.mts	312.435	Sq.mts	312.435	Sq.mts	Sq.mts
Commercial	Sq.mts	2212.966	Sq.mts	2212.966	Sq.mts	Sq.mts
Commercial-2	318.24	Sq.mts	Sq.mts	318.240	Sq.mts	Sq.mts
TOTAL	318.24		2525.401		2843.641	

TO BE READ WITH THIS OFFICE MEMO NO. 6662 DATE-15-03-2021

Checked and found ok for Public Health
 Checked and found ok for Fire Department
 Checked and found ok for Environment & Planning
 Checked and found ok for Traffic Police
 Checked and found ok for Water Supply
 Checked and found ok for Sewerage
 Checked and found ok for Electricity
 Checked and found ok for Gas
 Checked and found ok for Telephone
 Checked and found ok for Cable TV
 Checked and found ok for Fire Alarm
 Checked and found ok for Fire Extinguisher
 Checked and found ok for Fire Escape
 Checked and found ok for Fire Alarm
 Checked and found ok for Fire Extinguisher
 Checked and found ok for Fire Escape

CLIENT:- GLS INFRAPROJECTS PVT. LTD.

PROJECT :-
 REVISED AND PROPOSED PLAN OF AFFORDABLE GROUP HOUSING COLONY FOR AN ADDITIONAL AREA MEASURING 1.10625 ACRES (LICENSE NO. 98 OF 2021 DATED 18/11/2021) IN ALREADY LICENSE GRANTED AFFORDABLE GROUP HOUSING COLONY MEASURING 8.76875 ACRES LICENSE NO. 06 OF 2017 DATED 08.02.2017 AND LICENSE NO. 65 OF 2019 DATED 14.06.2019 TOTAL AREA 9.875 ACRES IN SECTOR-92, GURUGRAM BEING DEVELOPED BY GLS INFRAPROJECTS PVT. LTD.

ARCHITECTS
 Pinnacle Architects Pvt. Ltd.
 Architect: CA/96/19791
 938, Sector-14, Gurugram

SCALE: 1:500
 DRAWING NAME: SITE PLAN
 DRAWING NO. SUB-01

APPLICANT'S SIGN. ARCHITECT'S SIGN.

