

L.No. 107/17.12.2021.

LC- 4446

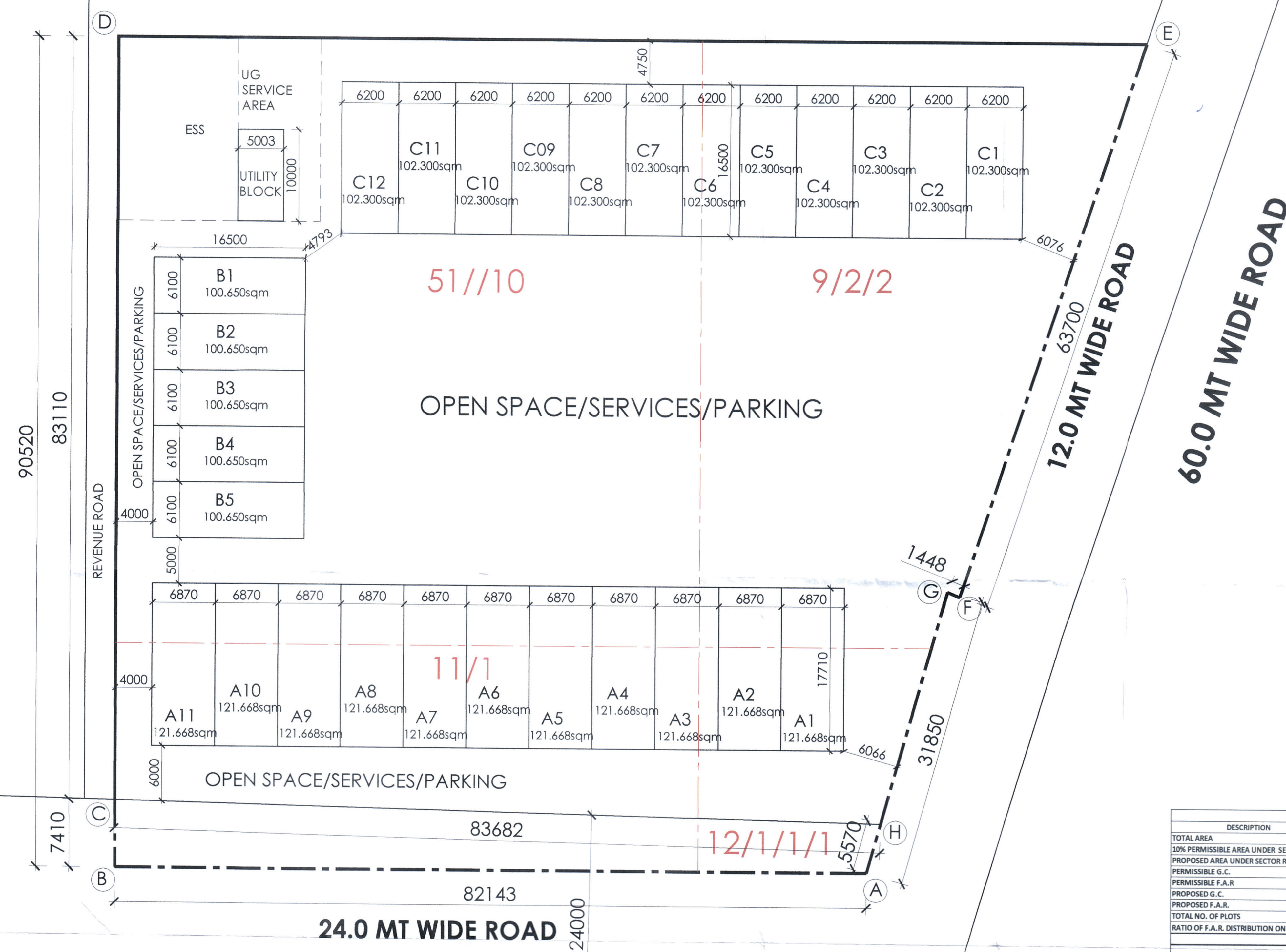

Reg. No - JTCP 8072 Dated 20-12-2021.

(RAM AVTAR BASSI) AD (HQ)  
 (DIVYA DOGRA) ATP (HQ)  
 (NARENDER KUMAR) DTP (HQ)  
 (HITESH SHARMA) STP (HQ) M  
 (P. SINGH) EP (HR)  
 (K. MAKRAND PANDURANG, IAS) DTCP (HR)

| AREA DETAIL   |         |         |           |
|---|---------|---------|-----------|
| DESCRIPTION   | FACTOR  | ACRES   | SQ.MT.    |
| TOTAL AREA  |         | 2.16875 | 8776.619  |
| 10% PERMISSIBLE AREA UNDER SECTOR ROAD                        |         | 0.21688 | 877.662   |
| PROPOSED AREA UNDER SECTOR ROAD                               |         | 0.13112 | 530.630   |
| PERMISSIBLE G.C.  | 35.00%  | 0.759   | 3071.817  |
| PERMISSIBLE F.A.R.  | 1.500   |         | 13164.928 |
| PROPOSED G.C.   | 34.970% |         | 3069.195  |
| PROPOSED F.A.R.   | 1.499   |         | 13153.692 |
| TOTAL NO. OF PLOTS  |         |         | 28        |
| RATIO OF F.A.R. DISTRIBUTION ON 1.0 SQ.MT. OF GROUND COVERAGE |         |         | 4.286     |

| BLOCK SUMMARY |          |              |                 |
|---------------|----------|--------------|-----------------|
| BLOCK NAME    | PLOT NO. | NO. OF PLOTS | PROPOSED F.A.R. |
| BLOCK-A       | A1-A10   | 11           | 1338.345        |
| BLOCK-B       | B1-B5    | 5            | 2156.786        |
| BLOCK-C       | C1-C12   | 12           | 5261.143        |
| TOTAL         |          | 28           | 13153.692       |
| FACTOR        |          |              | 34.97%          |
| BALANCE       |          |              | 2.622           |

| UTILITY BLOCK - FREE FROM GROUND COVERAGE & F.A.R. |               |              |            |
|--|---------------|--------------|------------|
| PLOT SIZE  | AREA (SQ.MT.) | NO. OF PLOTS | TOTAL AREA |
| 5.000 X 10.000                                     | 50.000        | 1            | 50.000     |

| BLOCK-A AREA DETAIL |                |               |            |
|---------------------|----------------|---------------|------------|
| PLOT NO.            | PLOT SIZE      | AREA (SQ.MT.) | TOTAL AREA |
| A1-A10              | 6.870 X 17.710 | 121.668       | 1338.345   |
| TOTAL               |                | 11            | 1338.345   |

| BLOCK-B AREA DETAIL |                |               |            |
|---------------------|----------------|---------------|------------|
| PLOT NO.            | PLOT SIZE      | AREA (SQ.MT.) | TOTAL AREA |
| B1-B5               | 6.100 X 16.500 | 100.650       | 503.250    |
| TOTAL               |                | 5             | 503.250    |

| BLOCK-C AREA DETAIL |                |               |            |
|---------------------|----------------|---------------|------------|
| PLOT NO.            | PLOT SIZE      | AREA (SQ.MT.) | TOTAL AREA |
| C1-C12              | 6.200 X 16.500 | 102.300       | 1227.600   |
| TOTAL               |                | 12            | 1227.600   |

PRINCIPAL ARCHITECT

**ACPL** ISO 9001:2015  
 Architecture Management Planning  
 ACPL Design Ltd  
 www.acplonline.com

PROJECT:-  
 LAYOUT PLAN OF COMMERCIAL PLOTTED COLONY ON THE LAND MEASURING 2.16875 ACRES IN THE REVENUE ESTATE OF VILLAGE BEGUMPUR KHATOLA SECTOR-73, DISTRICT GURUGRAM FOR PYRAMID INFRA TECH PVT. LTD.

For Pyramid Infracore Pvt. Ltd.  
 Authorized Signatory

OWNER/AUTH. SIGNATURE ARCHITECT'S SIGNATURE

DRAWING TITLE: LAYOUT PLAN  
 DRAWING NO.: A-1 SCALE: 1 : 250