

Dated: 09-05-2022

To,
The District Town Planner -Sonipat,
Town & Country Planning Department,
1st Floor, Sector- 15, Sonipat Haryana.

SUB: Approval of Layout -cum- Demarcation Plans for Affordable Plotted Township under DDJAY over 21.28125 acres at Village Revli, Sector-17, Teh. & Distt. Sonipat, Haryana

Ref: License no. 52 of 2022 dated 06-05-2022
LC-4481

Respected Sir,

We, M/s Creative Buildwell Private Ltd (Owner & Developer), Shree Banke Bihari Health Care LLP (Owner - cum - Co-Developer), Mr. Rahul Panwar & Mr. Lalit Panwar both s/o Sh. Surinder Panwar ((Owner - cum Co-Developer) were granted above license no. 52 of 2022 to develop an Affordable Plotted Colony under DDJAY (2016) at Vill. Revli, Sector-17, Teh. & Distt. Sonipat, Haryana over land admeasuring 21.28125 acres.

We are herewith submitting (5 copies) of Layout-cum-Demarcation plan of the above stated township for your kind information and approval.

You are kindly requested to the needful.

Thanking you.

For Creative Buildwell Pvt Ltd
For Shree Banke Bihari Healthcare LLP, For Sh. Rahul Panwar & Sh. Lalit Panwar



Authorized Signatory
+91-9871599771



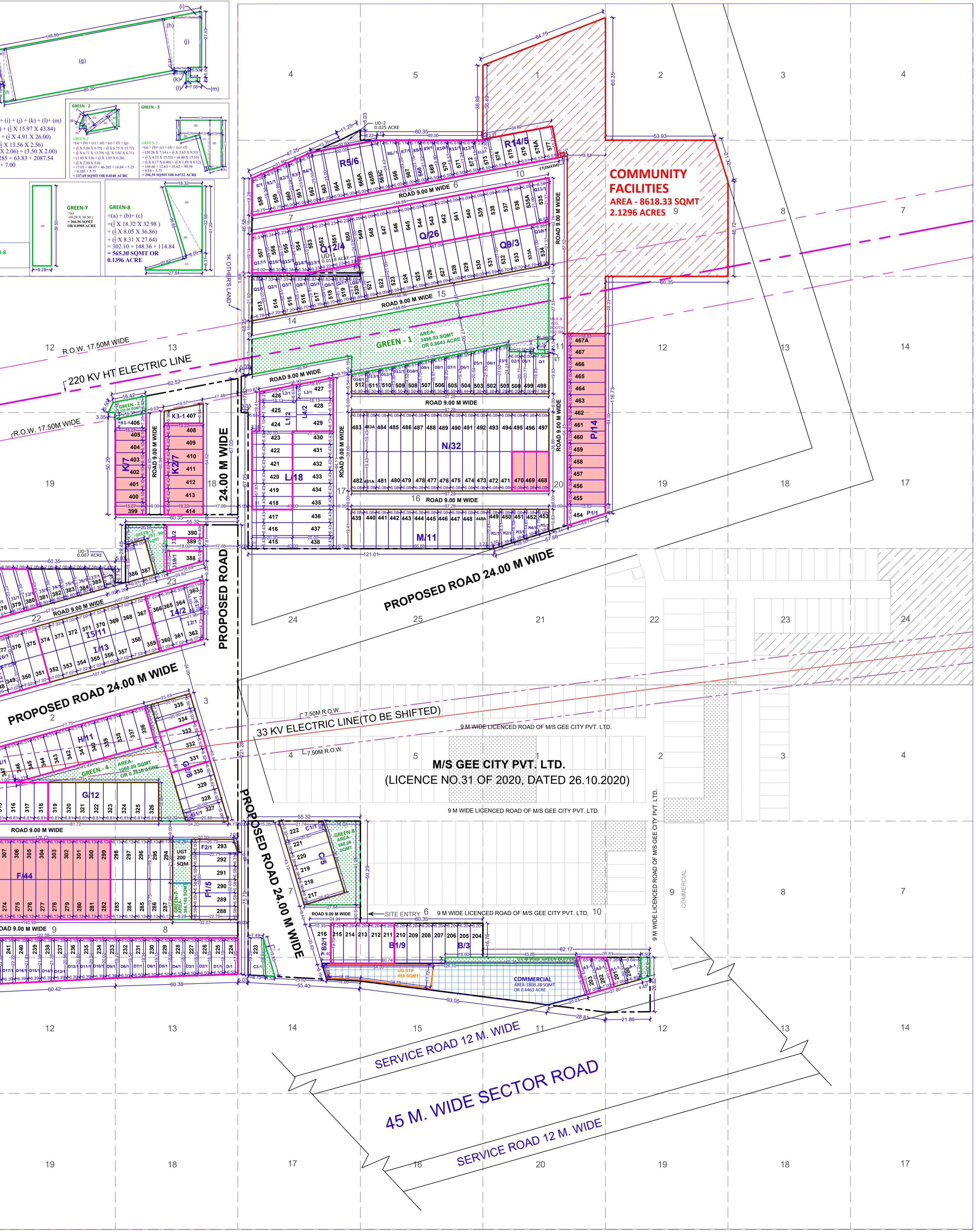
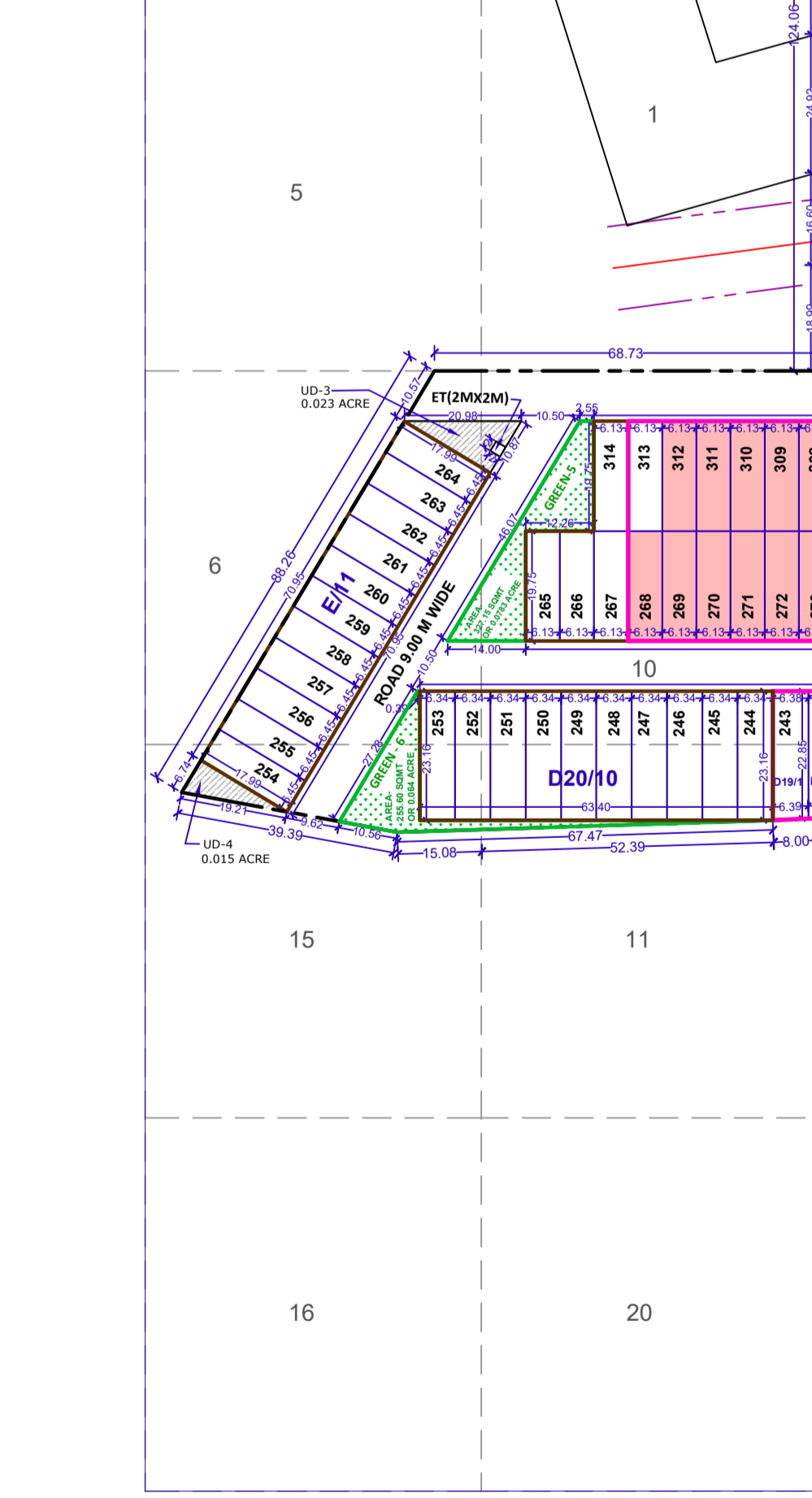
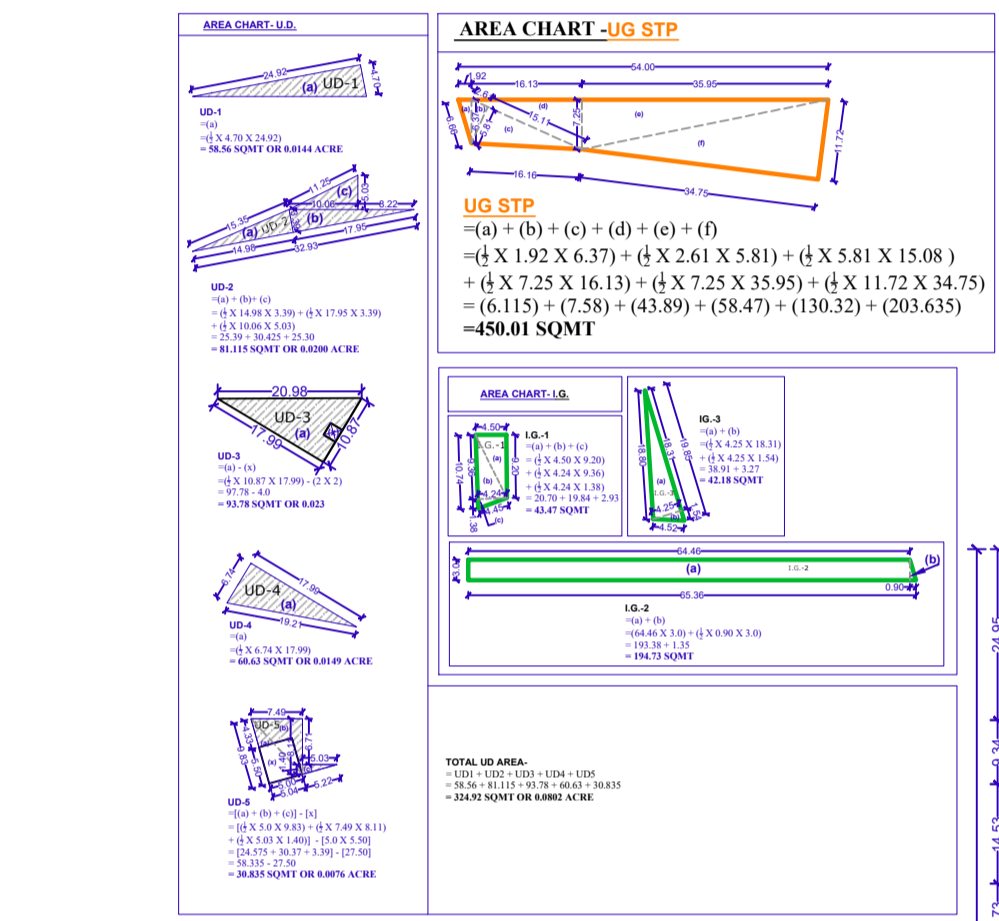
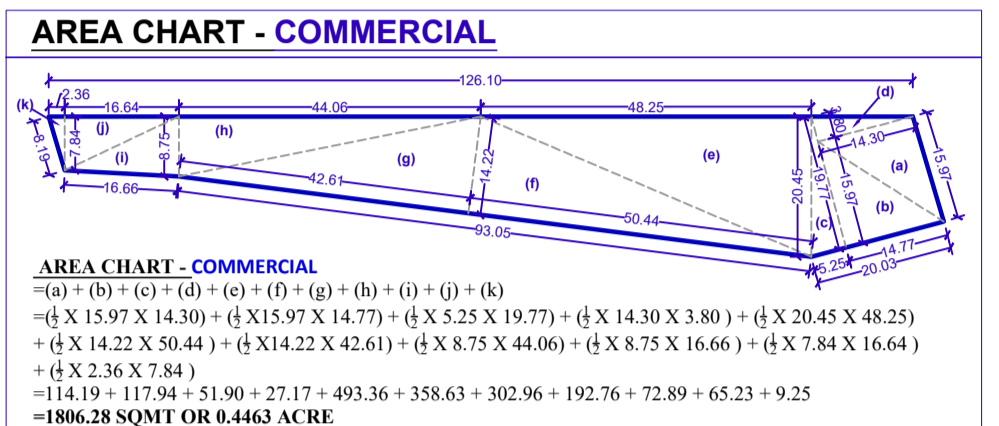
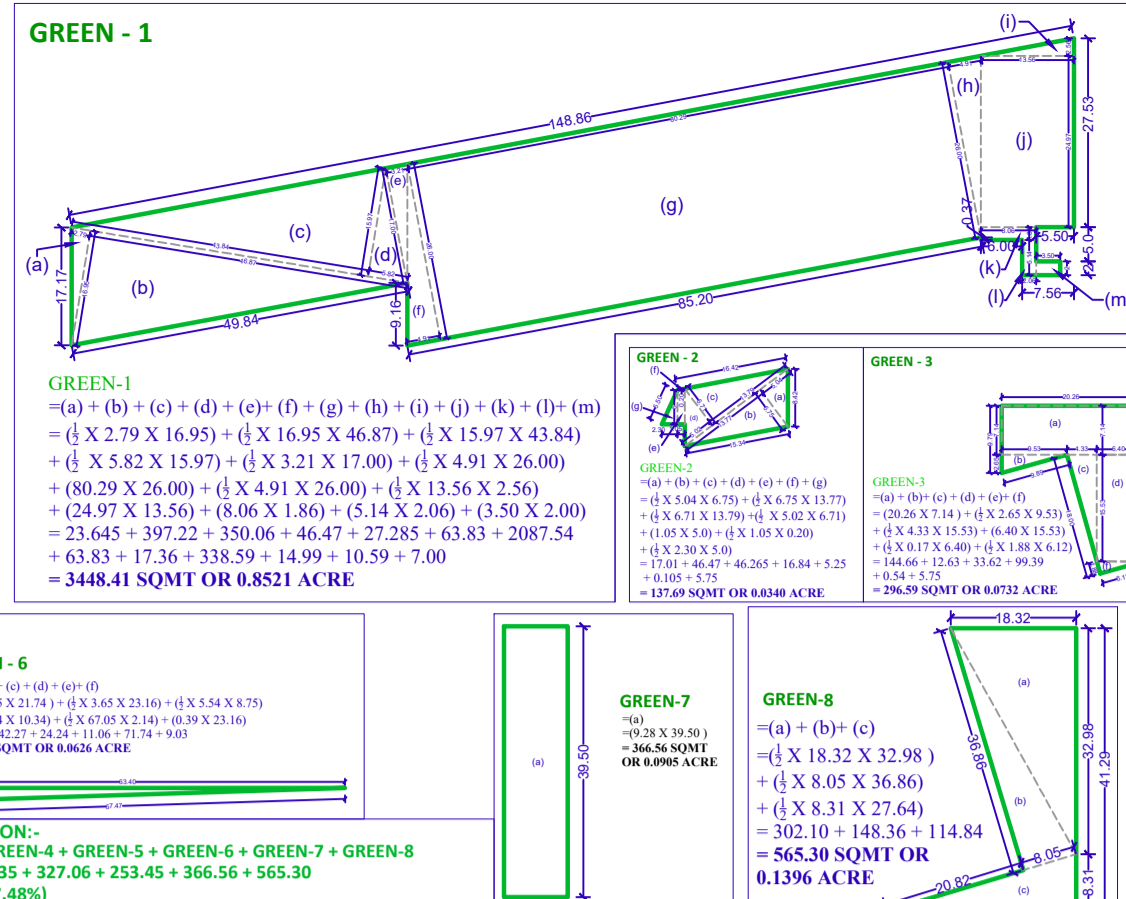
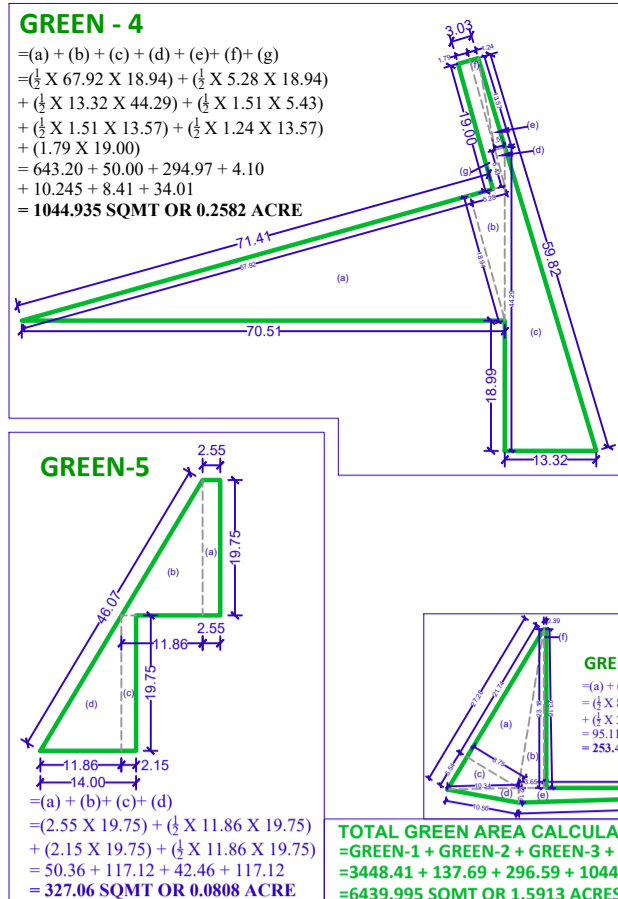
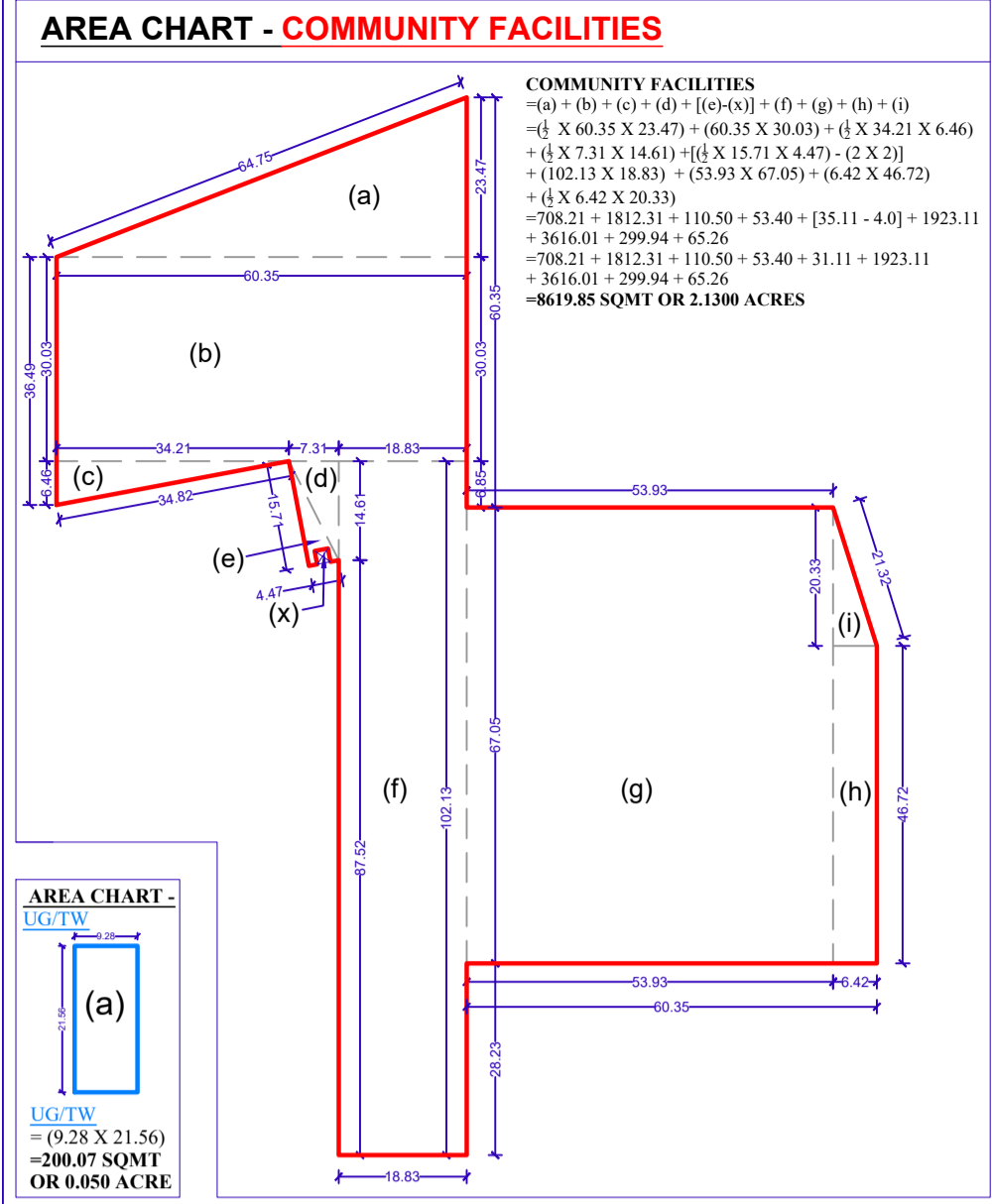

NOTES:
 1. PLOTS FALLING UNDER R.O.W. OF 33KV HT LINE SHALL NOT BE SOLD TILL THE HT LINE SHIFTED AT SITE.
 2. THE APPLICANT HAVE PROPOSED UGSTP BELOW THE COMMERCIAL PARKING AREA WHICH WILL NOT DISTURB THE SURFACE PARKING AREA. ALSO, THE APPLICANT WILL MAINTAIN THE REQUIRED 65% AREA AS THE SURFACE PARKING AREA/OPEN SPACE.