

AREA CHART

- (1) TOTAL SITE AREA = 6294.00 SQ. M
- (2) PERMISSIBLE GROUND COVERAGE - 35% = 2212.9 SQ. M
- (3) PROPOSED GROUND COVERAGE = 3379.00 SQ. M (54.97%)
- (4) PERMISSIBLE F.A.R. - 150% = 12141.00 SQ. M
- (5) PROPOSED F.A.R. = 11835.00 SQ. M (148.23%)

AREA DETAILS

BLOCK	SCO NO	X (MTRS)	Y (MTRS)	PROPOSED GROUND COVERAGE PER SCO (SQ. MT)	SCO	PRC
A-9-C-01-30	6	300	13	554	30	0
CLINIC	31-32	4	8	65	02	
BEAUTY	BP 1	3	0	4	02	
PARLOR	BP 2	3	0	4	02	
BOOTH	ATM 1	3	0	4	02	
MULTI PURPOSE	M B 1	5	0	27	02	
MULTI PURPOSE	M B 2	5	0	27	02	
GRAND TOTAL					38	21

PARKING AREA CAN NOT BE SOLD IN ANY MANNER OR

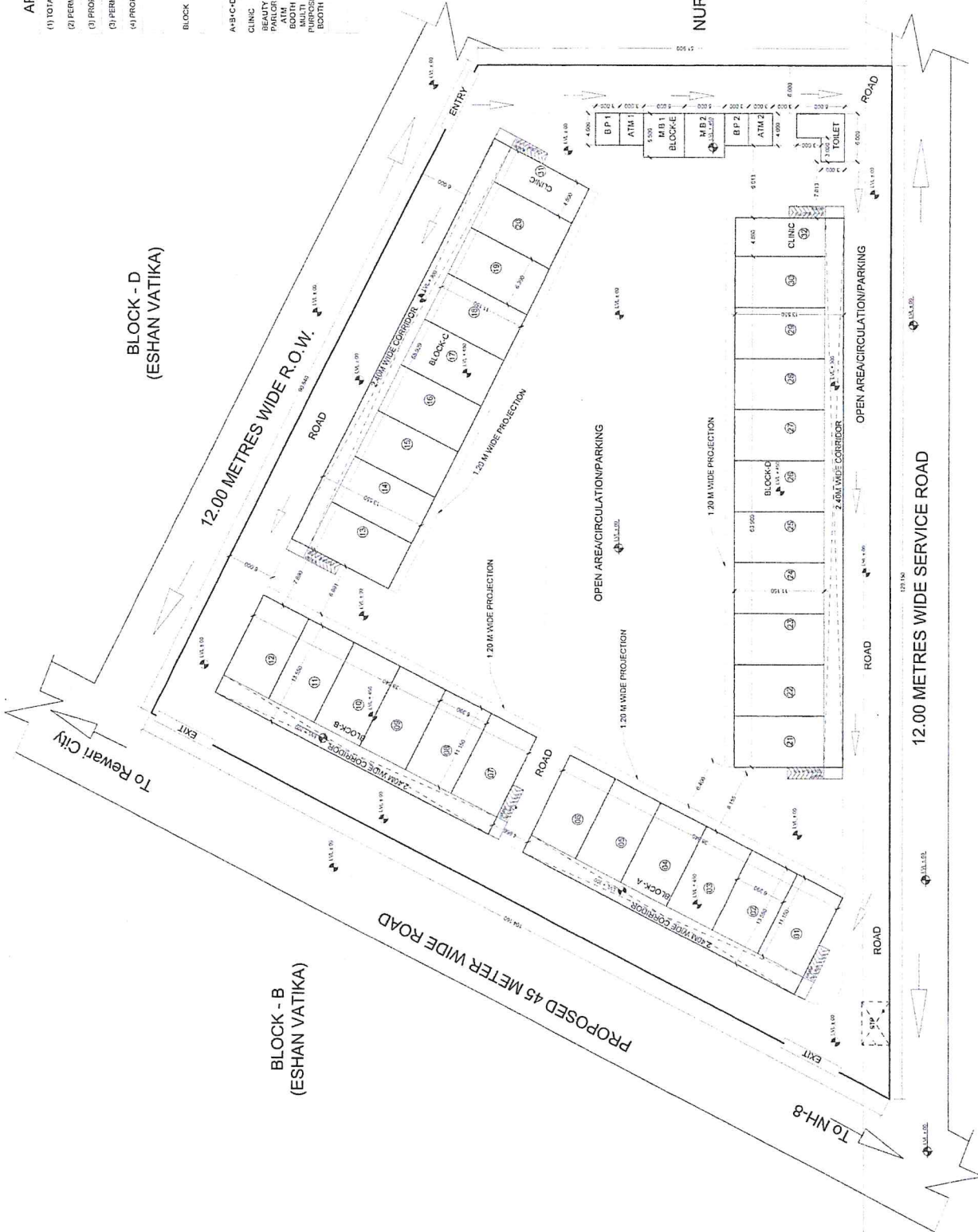

DEVELOPER -
GURUTEK ES
 Reg. Office - 318-31
 Tower, Sector-30,
 Gurgaon
 Ph - 0124
 Email - gurutek@gmail.com

Project -
 PROPOSED STANDARD DI
 COMMERCIAL SITE MEASI
 RESIDENTIAL PLOTTED CI
 MEASURING 50.73125 ACR
 2009 DATED 30.12.2009 / F
 26. REWARI BEING DEVEL
 ESTATE PVT. LTD

ARCHITECT -
ARCHDECK AS
 #581, SECTOR 27, GUR
 Email id - archdeck@rediffmail.com
 Contact - 919156

DRG. TITLE -
LAYOUT PLAN

DATE -
 12/08/2020

DEALT -
 SUNIL

CHKD. BY -
 AR. ABHISHEK GOYAL

SHEET NO
01

DRG. NO - DTTC 8223 (0) DATED 01-04-2020

(KAMARAJI PANDURANG, IAS)
 DTCP (H)

(M. S. SHARMA)
 CIP (H)

(H. S. SINGH)
 IAS (H)

(M. S. SHARMA)
 IAS (H)

(M. S. SHARMA)
 IAS (H)