

AREA CHART (KILA WISE)						
SR.NO.	VILLAGE	RECT.NO.	KILA NO.	TOTAL SITE AREA (SQM.)	AREA IN 24 MTR. (SQM.)	REMARKS
1	BADHA	2	21/1/1	0.05		
2	BADHA	2	20/2/2	0.25		
3	BADHA	3	14/2	0.06	0.01	
4	BADHA	3	16/2/21	0.01		
5	BADHA	3	16/2/1	0.28		
6	BADHA	3	16/2/22	0.05		
7	BADHA	3	17/1	0.11	0.02	
8	BADHA	3	17/2	0.26		
9	BADHA	3	17/3	0.08		
10	BADHA	3	17/4	0.18	0.04	
11	BADHA	3	24/2	0.29	0.15	
12	BADHA	3	25/1/1	0.05	0.01	
13	BADHA	3	25/1/2/1	0.23	0.00	
14	BADHA	3	25/2/1	0.44		
15	BADHA	3	25/2/1/1	0.07		
16	BADHA	8	4/1	0.5	0.06	
17	BADHA	8	4/3	0.19	0.01	
18	BADHA	8	5/1/1	0.01	0.01	
19	BADHA	8	5/1/3	0.35	0.04	
20	BADHA	8	5/2	0.53	0.21	
21	BADHA	8	6/1/2	0.3789	0.217	
22	BADHA	8	6/2/2	0.4	0.17	
23	BADHA	8	7/1	0.96		
24	BADHA	8	8/1	0.08		
25	BADHA	8	14	0.8		
26	BADHA	8	15/1/2	0.19925	0.05	
27	BADHA	8	15/1/2	0.37	0.05	
28	BADHA	8	15/2	0.36		
29	BADHA	8	16	0.23		
30	BADHA	8	17/1	0.59		
31	BADHA	8	18/2	0.25		
32	BADHA	8	19/1/1/1	0.1		
TOTAL				8.69375 ACRES	1.025 ACRES	

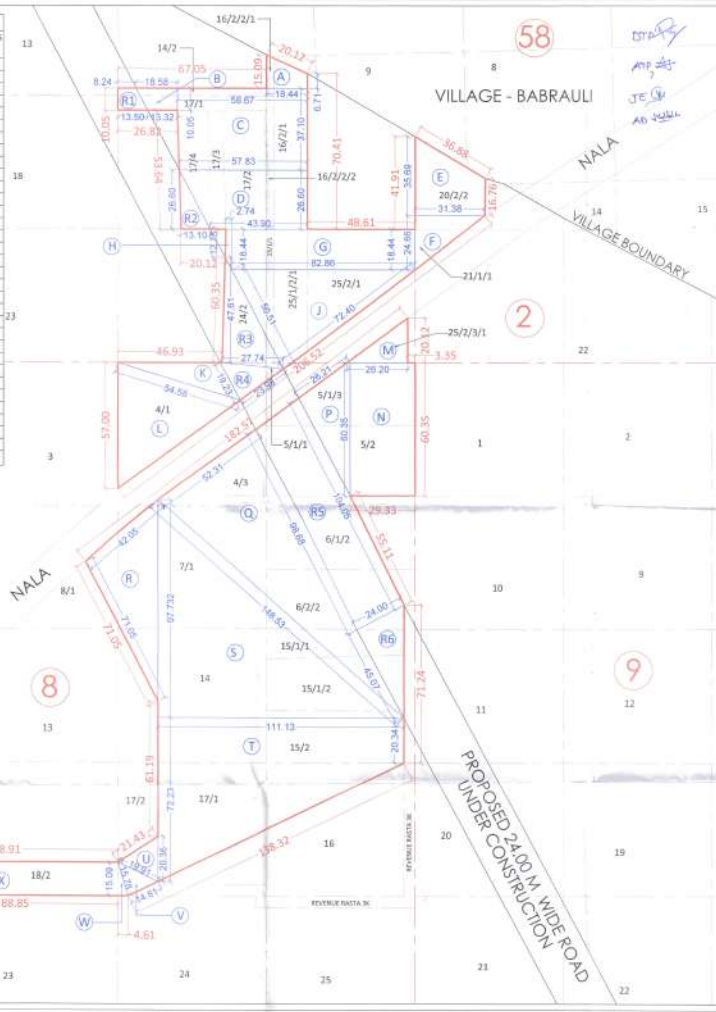

AREA CALCULATION						
SR. NO.	LENGTH	WIDTH	HEIGHT	TOTAL AREA IN SQM.	REMARKS	
A	15.09	X	18.44	/ 2 =	201.80	
B	13.32	X	18.58	X 10.05 / 2 =	360.30	
C	58.67	X	57.83	X 17.1 / 2 =	2161.08	
D	57.83	X	43.9	X 26.6 / 2 =	1355.01	
E	25.69	X	16.76	X 31.58 / 2 =	822.94	
F	31.38	X	24.66	/ 2 =	386.82	
G	82.86	X	18.44	=	1527.94	
H	18.44	X	12.75	X 2.74 / 2 =	42.79	
I	50.51	X	7.22	/ 2 =	1823.41	
J	46.93	X	19.23	/ 2 =	451.23	
K	57	X	54.58	/ 2 =	1555.51	
L	26.2	X	20.12	/ 2 =	263.57	
M	60.35	X	28.31	/ 2 =	1770.87	
N	26.21	X	60.35	/ 2 =	790.89	
O	148.53	X	12.11	/ 2 =	3884.80	
P	71.05	X	42.05	/ 2 =	1499.81	
Q	111.13	X	97.732	/ 2 =	5430.479	
R	72.29	X	20.36	X 111.13 / 2 =	5143.05	
S	20.36	X	19.91	/ 2 =	202.68	
T	14.81	X	15.78	/ 2 =	116.85	
U	4.61	X	15.99	/ 2 =	34.78	
V	98.91	X	88.85	X 15.99 / 2 =	1416.65	
TOTAL AREA (A TO X)				31034.12	SQM.	
				7.66875	ACRES	

AREA UNDER 24.00 MTR. WIDE ROAD						
SR. NO.	LENGTH	WIDTH	HEIGHT	TOTAL AREA IN SQM.	REMARKS	
R1	8.24	X	10.05	/ 2 =	109.24	
R2	13.1	X	26.6	/ 2 =	174.23	
R3	27.74	X	47.65	/ 2 =	660.35	
R4	23.98	X	19.23	/ 2 =	230.57	
R5	24.00	X	45.07	/ 2 =	540.84	
TOTAL AREA (R1 TO R5)				4148.832	SQM.	
				1.0750	ACRES	
TOTAL SITE AREA (A TO X + R1 TO R5)				35182.957	SQM.	
				8.69375	ACRES	

PROJECT
 DEMARCATION PLAN OF PROPOSED AFFORDABLE GROUP HOUSING COLONY SITE MEASURING 8.69375 ACRES AT SECTOR- 89 IN REVENUE ESTATE OF VILLAGE BADHA, GURUGRAM (HR.)
 LOI Granted MEMO NO.LC NO. 4427-JE-(DS)/20121/17356, Dated 20.07-2021
 BEING DEVELOPED BY M/S BREEZ INFRA

 AUTH'S SIGN DATE:	 ARCHITECT'S SIGN 30-08-2021
GH - 01 DEMARCATION PLAN	