

5.0125	PERMISSIBLE			PROPOSED		
	AREA	AREA	PERCENTAGE	AREA	AREA	PERCENTAGE
	ACRES	SQ.MTS.	%	ACRES	SQ.MTS.	%
TOTAL Licence Area	5.0125	20284.860				
Open Area under GREEN/PARK	0.376	1521.305	7.50	0.469	1899.640	9.36
Community facilities	0.501	2028.486	10.00	0.501	2028.486	10.00
Commercial Area (calculated on total licenced area)	0.201	811.394	4.00	0.201	811.400	4.00
Area Under Plots (calculated on total licenced area)	3.058	12373.765	61.00	2.474	10012.16	49.36
Total permissible Residential + Commercial area	3.258	13185.159	65.00	2.675	10823.559	53.35
Permissible Density		240-400 ppa	Minimum Required Plots		66.83	
Achieved Density @ 18 persons per plot	258.55	ppa	Achieved Plots		72.000	

CLASSIFICATION OF PLOTS					
TYPE	SIZE OF PLOT		NO. OF PLOTS	TOTAL AREA OF PLOTS	
	MTS.	SQ.MTS.		MTS.	SQ.MTS.
A	9.100	16.455	37	5540.40	
B	9.070	14.450	29	3800.78	
C	7.900	13.500	4	426.60	
M1	8.345	16.455	1	137.32	
M2	7.409	14.450	1	107.06	
TOTAL			72	10012.16	

CLASSIFICATION OF FROZEN PLOTS					
TYPE	SIZE OF PLOT		NO. OF PLOTS	TOTAL AREA OF PLOTS	
	MTS.	SQ.MTS.		MTS.	SQ.MTS.
A	9.100	16.455	24	3593.77	
B	9.070	14.450	9	1179.55	
M1	8.345	16.455	1	137.32	
M2	7.409	14.450	1	107.06	
TOTAL			35	5017.70	

GREEN AREA CALCULATION		
	SQ.M.	ACRES
G1	1899.640	0.469
TOTAL	1899.640	0.469

	MTS.	MTS.	SQ.MTS.
VEGETABLE/ MILK BOOTH	5.00	5.00	25.00
TOTAL			25.00

50.12% PLOTS FROZEN AREA
5017.70 SQ.MTS/ 1.240 ACRES

- To be read with Licence No. 110 of 2021 dated 19/01/2022**
1. The site is located on the 5th floor of the 6th floor of the building at 20284.860 sq.mts. The site is located in Sector-43A, Gurgaon, Haryana. The site is located in the area bounded by the following boundaries:
- North: 100' 00"
 - South: 100' 00"
 - East: 100' 00"
 - West: 100' 00"
2. The site is located on the 5th floor of the 6th floor of the building at 20284.860 sq.mts. The site is located in Sector-43A, Gurgaon, Haryana. The site is located in the area bounded by the following boundaries:
- North: 100' 00"
 - South: 100' 00"
 - East: 100' 00"
 - West: 100' 00"
3. The site is located on the 5th floor of the 6th floor of the building at 20284.860 sq.mts. The site is located in Sector-43A, Gurgaon, Haryana. The site is located in the area bounded by the following boundaries:
- North: 100' 00"
 - South: 100' 00"
 - East: 100' 00"
 - West: 100' 00"
4. The site is located on the 5th floor of the 6th floor of the building at 20284.860 sq.mts. The site is located in Sector-43A, Gurgaon, Haryana. The site is located in the area bounded by the following boundaries:
- North: 100' 00"
 - South: 100' 00"
 - East: 100' 00"
 - West: 100' 00"
5. The site is located on the 5th floor of the 6th floor of the building at 20284.860 sq.mts. The site is located in Sector-43A, Gurgaon, Haryana. The site is located in the area bounded by the following boundaries:
- North: 100' 00"
 - South: 100' 00"
 - East: 100' 00"
 - West: 100' 00"
6. The site is located on the 5th floor of the 6th floor of the building at 20284.860 sq.mts. The site is located in Sector-43A, Gurgaon, Haryana. The site is located in the area bounded by the following boundaries:
- North: 100' 00"
 - South: 100' 00"
 - East: 100' 00"
 - West: 100' 00"
7. The site is located on the 5th floor of the 6th floor of the building at 20284.860 sq.mts. The site is located in Sector-43A, Gurgaon, Haryana. The site is located in the area bounded by the following boundaries:
- North: 100' 00"
 - South: 100' 00"
 - East: 100' 00"
 - West: 100' 00"
8. The site is located on the 5th floor of the 6th floor of the building at 20284.860 sq.mts. The site is located in Sector-43A, Gurgaon, Haryana. The site is located in the area bounded by the following boundaries:
- North: 100' 00"
 - South: 100' 00"
 - East: 100' 00"
 - West: 100' 00"
9. The site is located on the 5th floor of the 6th floor of the building at 20284.860 sq.mts. The site is located in Sector-43A, Gurgaon, Haryana. The site is located in the area bounded by the following boundaries:
- North: 100' 00"
 - South: 100' 00"
 - East: 100' 00"
 - West: 100' 00"
10. The site is located on the 5th floor of the 6th floor of the building at 20284.860 sq.mts. The site is located in Sector-43A, Gurgaon, Haryana. The site is located in the area bounded by the following boundaries:
- North: 100' 00"
 - South: 100' 00"
 - East: 100' 00"
 - West: 100' 00"
11. The site is located on the 5th floor of the 6th floor of the building at 20284.860 sq.mts. The site is located in Sector-43A, Gurgaon, Haryana. The site is located in the area bounded by the following boundaries:
- North: 100' 00"
 - South: 100' 00"
 - East: 100' 00"
 - West: 100' 00"
12. The site is located on the 5th floor of the 6th floor of the building at 20284.860 sq.mts. The site is located in Sector-43A, Gurgaon, Haryana. The site is located in the area bounded by the following boundaries:
- North: 100' 00"
 - South: 100' 00"
 - East: 100' 00"
 - West: 100' 00"
13. The site is located on the 5th floor of the 6th floor of the building at 20284.860 sq.mts. The site is located in Sector-43A, Gurgaon, Haryana. The site is located in the area bounded by the following boundaries:
- North: 100' 00"
 - South: 100' 00"
 - East: 100' 00"
 - West: 100' 00"
14. The site is located on the 5th floor of the 6th floor of the building at 20284.860 sq.mts. The site is located in Sector-43A, Gurgaon, Haryana. The site is located in the area bounded by the following boundaries:
- North: 100' 00"
 - South: 100' 00"
 - East: 100' 00"
 - West: 100' 00"
15. The site is located on the 5th floor of the 6th floor of the building at 20284.860 sq.mts. The site is located in Sector-43A, Gurgaon, Haryana. The site is located in the area bounded by the following boundaries:
- North: 100' 00"
 - South: 100' 00"
 - East: 100' 00"
 - West: 100' 00"
16. The site is located on the 5th floor of the 6th floor of the building at 20284.860 sq.mts. The site is located in Sector-43A, Gurgaon, Haryana. The site is located in the area bounded by the following boundaries:
- North: 100' 00"
 - South: 100' 00"
 - East: 100' 00"
 - West: 100' 00"
17. The site is located on the 5th floor of the 6th floor of the building at 20284.860 sq.mts. The site is located in Sector-43A, Gurgaon, Haryana. The site is located in the area bounded by the following boundaries:
- North: 100' 00"
 - South: 100' 00"
 - East: 100' 00"
 - West: 100' 00"
18. The site is located on the 5th floor of the 6th floor of the building at 20284.860 sq.mts. The site is located in Sector-43A, Gurgaon, Haryana. The site is located in the area bounded by the following boundaries:
- North: 100' 00"
 - South: 100' 00"
 - East: 100' 00"
 - West: 100' 00"
19. The site is located on the 5th floor of the 6th floor of the building at 20284.860 sq.mts. The site is located in Sector-43A, Gurgaon, Haryana. The site is located in the area bounded by the following boundaries:
- North: 100' 00"
 - South: 100' 00"
 - East: 100' 00"
 - West: 100' 00"
20. The site is located on the 5th floor of the 6th floor of the building at 20284.860 sq.mts. The site is located in Sector-43A, Gurgaon, Haryana. The site is located in the area bounded by the following boundaries:
- North: 100' 00"
 - South: 100' 00"
 - East: 100' 00"
 - West: 100' 00"
21. The site is located on the 5th floor of the 6th floor of the building at 20284.860 sq.mts. The site is located in Sector-43A, Gurgaon, Haryana. The site is located in the area bounded by the following boundaries:
- North: 100' 00"
 - South: 100' 00"
 - East: 100' 00"
 - West: 100' 00"
22. The site is located on the 5th floor of the 6th floor of the building at 20284.860 sq.mts. The site is located in Sector-43A, Gurgaon, Haryana. The site is located in the area bounded by the following boundaries:
- North: 100' 00"
 - South: 100' 00"
 - East: 100' 00"
 - West: 100' 00"
23. The site is located on the 5th floor of the 6th floor of the building at 20284.860 sq.mts. The site is located in Sector-43A, Gurgaon, Haryana. The site is located in the area bounded by the following boundaries:
- North: 100' 00"
 - South: 100' 00"
 - East: 100' 00"
 - West: 100' 00"
24. The site is located on the 5th floor of the 6th floor of the building at 20284.860 sq.mts. The site is located in Sector-43A, Gurgaon, Haryana. The site is located in the area bounded by the following boundaries:
- North: 100' 00"
 - South: 100' 00"
 - East: 100' 00"
 - West: 100' 00"
25. The site is located on the 5th floor of the 6th floor of the building at 20284.860 sq.mts. The site is located in Sector-43A, Gurgaon, Haryana. The site is located in the area bounded by the following boundaries:
- North: 100' 00"
 - South: 100' 00"
 - East: 100' 00"
 - West: 100' 00"
26. The site is located on the 5th floor of the 6th floor of the building at 20284.860 sq.mts. The site is located in Sector-43A, Gurgaon, Haryana. The site is located in the area bounded by the following boundaries:
- North: 100' 00"
 - South: 100' 00"
 - East: 100' 00"
 - West: 100' 00"
27. The site is located on the 5th floor of the 6th floor of the building at 20284.860 sq.mts. The site is located in Sector-43A, Gurgaon, Haryana. The site is located in the area bounded by the following boundaries:
- North: 100' 00"
 - South: 100' 00"
 - East: 100' 00"
 - West: 100' 00"
28. The site is located on the 5th floor of the 6th floor of the building at 20284.860 sq.mts. The site is located in Sector-43A, Gurgaon, Haryana. The site is located in the area bounded by the following boundaries:
- North: 100' 00"
 - South: 100' 00"
 - East: 100' 00"
 - West: 100' 00"
29. The site is located on the 5th floor of the 6th floor of the building at 20284.860 sq.mts. The site is located in Sector-43A, Gurgaon, Haryana. The site is located in the area bounded by the following boundaries:
- North: 100' 00"
 - South: 100' 00"
 - East: 100' 00"
 - West: 100' 00"
30. The site is located on the 5th floor of the 6th floor of the building at 20284.860 sq.mts. The site is located in Sector-43A, Gurgaon, Haryana. The site is located in the area bounded by the following boundaries:
- North: 100' 00"
 - South: 100' 00"
 - East: 100' 00"
 - West: 100' 00"

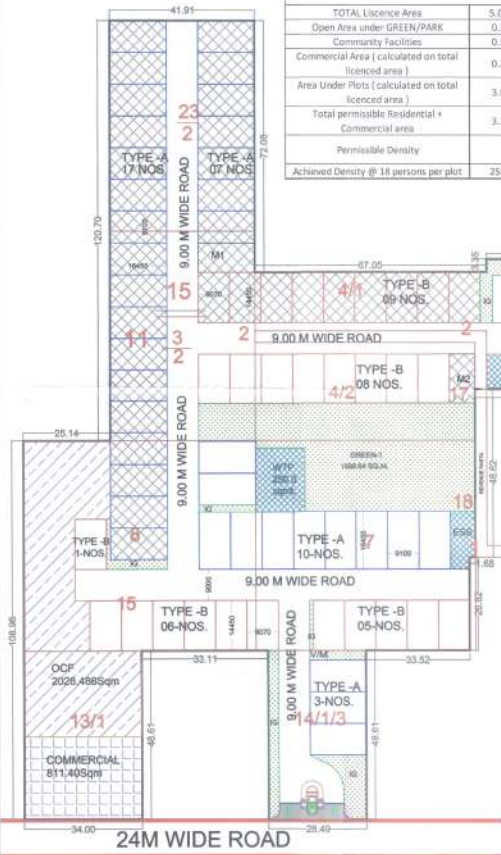

PROJECT NAME AND ADDRESS
LAYOUT PLAN OF PROPOSED RESIDENTIAL PLOTTED COLONY UNDER DDA, IN SECTOR-43A, GURGAON, OVER AN AREA OF 5.0125 ACRES BEING DEVELOPED BY SIGNATURE GLOBAL INDIA PVT. LTD.

OWNER'S NAME:
SIGNATURE GLOBAL INDIA PVT. LTD.

OWNER'S SIGNATURE:

SITE LAYOUT PLAN

OWNER'S SIGNATURE:

SCALE: NORTH

ARCHITECT: