

ARCHITECT (H.Q.) S.T.P. Member Secretary B.P.C.  
 S.T.P. (G) Member B.P.C.  
 Chairman B.P.C.  
 DDT (H.Q) Member B.P.C.  
 DINESH KUMAR SD (H.Q)

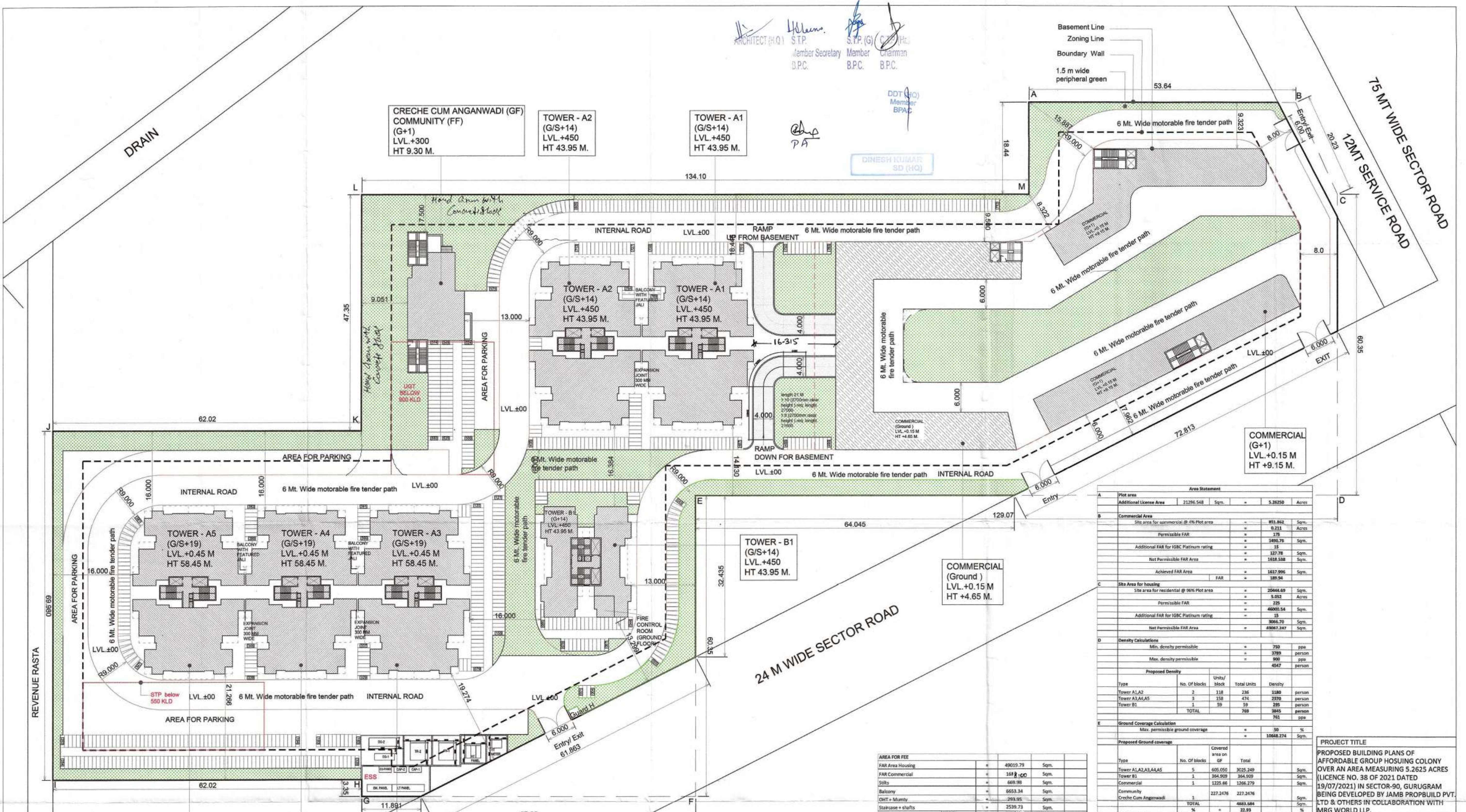

Area Statement			
Plot area		5.26250	Acres
Additional license area		21296.548	Sq.m.
<b>Commercial Area</b>			
Site area for commercial @ 4% Plot area		811.812	Sq.m.
Permissible FAR		0.211	Acres
Additional FAR for IGBC Platinum rating		1495.76	Sq.m.
Not Permissible FAR Area		127.78	Sq.m.
Achieved FAR Area		1618.538	Sq.m.
Site Area for housing			
Site area for residential @ 36% Plot area		2044.69	Sq.m.
Permissible FAR		5.032	Acres
Additional FAR for IGBC Platinum rating		4600.54	Sq.m.
Not Permissible FAR Area		3064.70	Sq.m.
Achieved FAR Area		4907.247	Sq.m.
<b>Density Calculations</b>			
Min. density permissible		790	psa
Max. density permissible		3789	person
Proposed Density		692	psa
Proposed Density		4547	person
<b>Ground Coverage Calculation</b>			
Max. permissible ground coverage		50	%
Proposed ground coverage		10648.274	Sq.m.
<b>FAR Calculation</b>			
Permissible FAR		240	Sq.m.
Achieved FAR		4907.25	Sq.m.

AREA FOR FEE		
FAR Area Housing		49019.79 Sq.m.
FAR Commercial		169.80 Sq.m.
Silt		669.98 Sq.m.
Balcony		6653.34 Sq.m.
CHT + Mummy		293.95 Sq.m.
Staircase + shafts		2539.73 Sq.m.
<b>TOTAL</b>		<b>60774.27</b> Sq.m.

Floors	Tower A1	Tower A2	Tower A3	Tower A4	Tower A5	TOTAL
Ground floor	3	3	3	3	3	33
1st floor	4	4	4	4	4	44
2nd floor	4	4	4	4	4	44
3rd floor	4	4	4	4	4	44
4th floor	4	4	4	4	4	44
5th floor	4	4	4	4	4	44
6th floor	4	4	4	4	4	44
7th floor	4	4	4	4	4	44
8th floor	4	4	4	4	4	44
9th floor	4	4	4	4	4	44
10th floor	4	4	4	4	4	44
11th floor	4	4	4	4	4	44
12th floor	4	4	4	4	4	44
13th floor	4	4	4	4	4	44
14th floor	4	4	4	4	4	44
15th floor	4	4	4	4	4	44
16th floor	4	4	4	4	4	44
17th floor	4	4	4	4	4	44
18th floor	4	4	4	4	4	44
19th floor	4	4	4	4	4	44
<b>Total</b>	<b>59</b>	<b>59</b>	<b>59</b>	<b>59</b>	<b>59</b>	<b>748</b>

**PROJECT TITLE**  
 PROPOSED BUILDING PLANS OF AFFORDABLE GROUP HOUSING COLONY OVER AN AREA MEASURING 5.2625 ACRES (LICENCE NO. 38 OF 2021 DATED 19/07/2021) IN SECTOR-90, GURUGRAM BEING DEVELOPED BY JAMB PROPBUILD PVT. LTD & OTHERS IN COLLABORATION WITH MRG WORLD LLP.

**OWNER'S SIGNATURE**

**ARCHITECT'S SIGNATURE**

**DRAWING TITLE**  
 SITE LAYOUT

**ARCHITECTS**  
 MRG DESIGN TEAM  
 MRG World  
 Vastu Tower, Golf Course Road  
 Gurugram

**DATE** AUG 2021 **DWG. NO.** S - 101

**SCALE** 1:350

**DEALT** MG

**CHECKED** NM

Checked and found ok for Public Health (Internal) Services only subject to comments in Enclosure letter dated 14/08/2021. DT. 14/08/2021  
 Additional Civil Engineer (H.O) HSPV, Panchkula