

AREA STATEMENTS:-			
Detail - A (Rectangle)	Area = 4895.671 Sqmt	Detail - F (Triangle)	Area = 1/2(10.538x10.473) = 55.18224 Sqmt
Detail - B (Triangle)	Area = 1/2(40.37x41.086) = 837.742 Sqmt	Detail - G (Triangle)	Area = 1/2(34.020x23.854) = 286.248 Sqmt
Detail - C (Triangle)	Area = 1/2(40.37x41.086) = 837.742 Sqmt	Detail - H (Rectangle)	Area = (24.00x14.857) = 356.568 Sqmt
Detail - D (Triangle)	Area = 1/2(40.37x41.086) = 837.742 Sqmt	Detail - I (Triangle)	Area = 1/2(34.020x24.147) = 289.764 Sqmt
Detail - E (Triangle)	Area = 1/2(40.37x41.086) = 837.742 Sqmt	Detail - J (Triangle)	Area = 1/2(34.020x24.147) = 289.764 Sqmt
1 Total Site Area =	A+B+C+D+E+F+G+H+I+J = 10117.709 Sqmt		
2 Area Under 24M Wide Road =	G+H+I = 932.980 Sqmt		
3 Area Under Clear Site =	A+B+C+D+E+F+G+H+I+J = 9185.129 Sqmt		

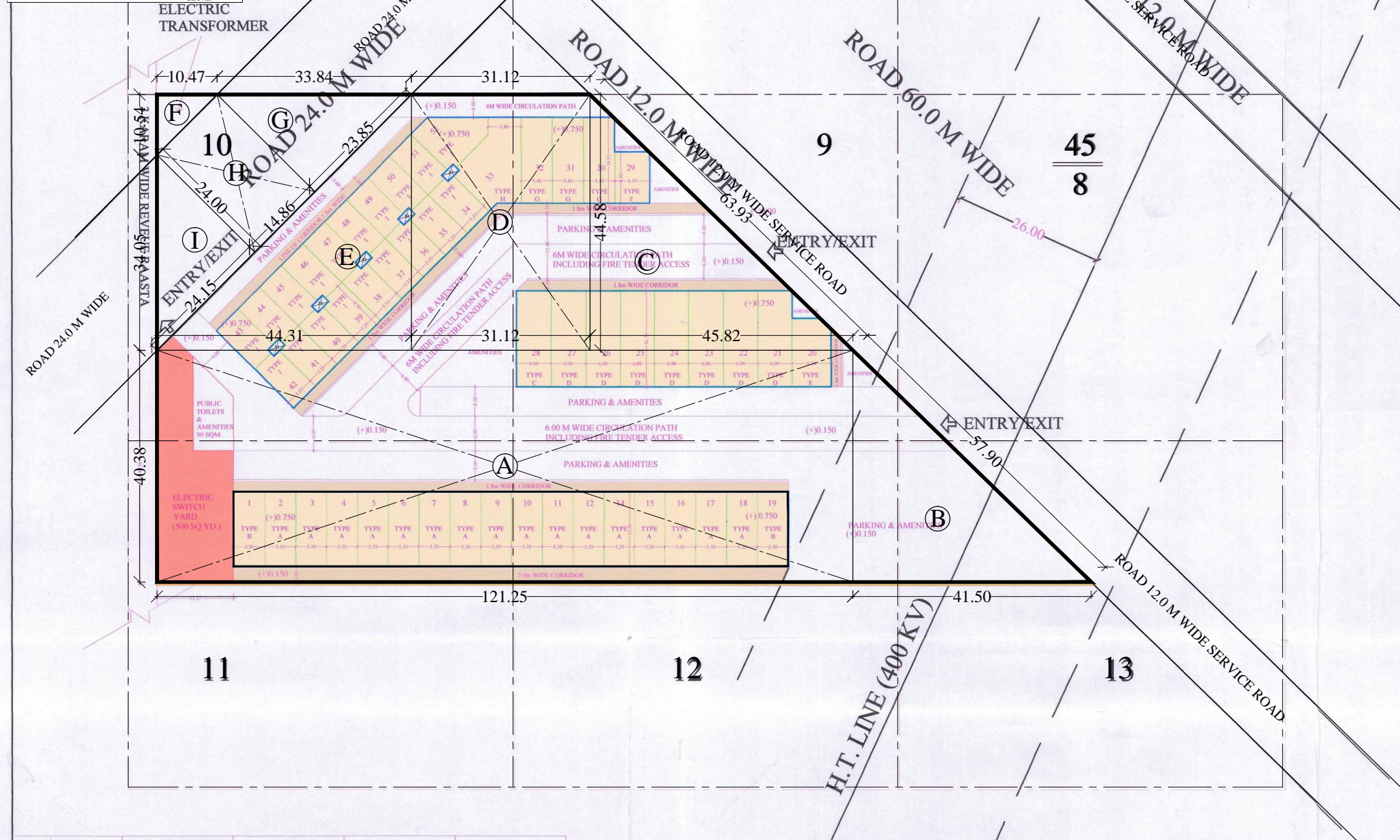

LAYOUT PLAN OF COMMERCIAL PLOTTED COLONY OVER AN AREA MEASURING 2.5 ACRES SITUATED AT SECTOR-102, GURUGRAM, HARYANA

BEING DEVELOPED BY : AKARSHAN ESTATE PVT. LTD. IN COLLABORATION WITH ADANI M2K PROJECTS LLP.

AREA CHART OF TOTAL SCHEME AREA					
TOTAL SCHEME AREA	2.500	ACRE	=	2.5*4046.85	10117.125 SQMT
PERMISSIBLE FAR @1.5			=	1.5*10117.13	15175.695 SQMT
PERMISSIBLE GROUND COVERAGE @35%			=	0.35*10117.13	3540.996 SQMT
PROPOSED FAR			=	1.500	15174.993 SQMT
PROPOSED GROUND COVERAGE			=	30%	3540.774 SQMT

AREA DETAILS							
	X(MTS)	Y(MTS)	FORMULAE APPLIED	PROPOSED GROUND COVERAGE PER SCO (SQMT)	PROPOSED FAR PER SCO (SQMT)	NO OF SCOS	PROPOSED GROUND COVERAGE PER SCO X NO OF SCOS (SQMT)
A	13.000	5.350	X*Y	69.550	298.070	16	1112.800
B	13.000	5.350	X*Y	71.500	298.070	2	143.000
C	16.750	6.040	X*Y	101.170	433.594	1	101.170
D	16.750	6.040	X*Y	100.500	430.713	7	703.500
E			AS PER FIG.	78.765	337.560	1	78.765
F	8.900	6.190	X*Y	55.091	236.103	1	55.091
G	14.010	5.400	X*Y	80.514	345.029	3	241.542
H			AS PER FIG.	129.878	556.616	1	129.878
I			AS PER FIG.	48.813	213.481	18	896.625
J			AS PER FIG.	78.403	336.010	1	78.403
TOTAL FAR 2.500 ACRES				3489.590	51	3540.774	15174.993
UTILITY BLOCK (PUBLIC TOILET & AMENITIES) FREE OF FAR & GROUND COVERAGE						100	100

OPEN AREA INCLUDING VEHICULAR CIRCULATION, PARKING, PUBLIC AMENITIES & SERVICES	=	SITE AREA- PROPOSED GROUND COVERAGE-	10117.125-3540.774	6576.351 SQM	65%
---	---	--------------------------------------	--------------------	--------------	-----

DRG NO:- OTCF 7602 DATE:- 26-11-2020
L. No. 37 dt. 25-11-2020

PROJECT:-
Commercial Plotted Colony On Area Measuring 2.5 Acre Situated At Sector-102, Gurugram Developed BY MS.Akarshan Estate Pvt. Ltd In Collaboration with Adani M2K PROJECTS LLP (Migration from integrated Commercial Colony Licence No. 97 of 2012)

DRAWING TITLE:-
LAYOUT PLAN OF COMMERCIAL PLOTTED COLONY

OWNER:-
AKARSHAN ESTATE PVT. LTD. In Collaboration with Adani M2K PROJECTS LLP
ADANI HOUSE, PLOT NO.83, SECTOR -32, GRUGRAM, HARYANA

SCALE : 1:1000	N ↑	DRAWING NO.
DATE : OCT 2019		01

OWNER 	ARCHITECT
-----------	---------------

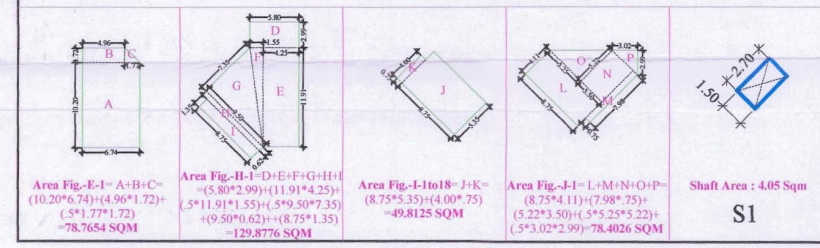

LEGEND:
All Dimension are in Meter.
Scheme Boundary Shown as
Area Under Ground Coverage Shown as

(RAM AVTAR BASSI) AD (HQ) (RAHUL SINGLA) ATP (HQ) (S.K. SEHRAWAT) DTP (HQ) (Hitesh Sharma) STP (HQ) M (JITENDER SHAG) CTP (HR) (K.MAKRAND PANDURANG, IAS) DTCP (HR)