

DTP
ATP
AD
JE

EXISTING 60.0M WIDE SECTOR DIVIDING ROAD

EXISTING 60.0M WIDE SECTOR DIVIDING ROAD

12.0M WIDE SERVICE ROAD

12.0M WIDE SERVICE ROAD

DEMARICATION PLAN

AREA FALLING UNDER 24M WIDE ROAD					
ITEM	Width 1 (m)	Width 2 (m)	Length (m)	Factor	Area (Sq.m)
R1	21.753	22.005	7.555	0.5	165.53
R2	44.850		18.565	0.5	423.14
R3	14.415		24.000	0.50	172.88
R4	55.435		24.000	1.00	1330.44
R5	24.000	21.115	4.460	0.50	100.908
R6	21.155		9.190	0.50	97.21
TOTAL					2289.91

DEVELOPMENT AREA DETAIL					
ITEM	Width 1 (m)	Width 2 (m)	Length (m)	Factor	Area (Sq.m)
1	38.450		23.100	0.50	444.098
2	23.100	23.470	12.665	0.50	294.905
3	25.545		56.435	0.50	708.044
4	63.700		38.270	0.50	1218.900
5	71.293		44.536	0.50	3688.165
6	67.126		31.852	0.50	3318.497
TOTAL					9673.61

Area Chart Killa Wise							
S.No.	Village	Rect. No.	Killa No.	Area	Area in 24 Mtr wide road (Sqmt.)	Remarks	
1	Dhorika	14	11/2/2	4	7	2200.48	1276.58
2	Dhorika	14	19/1/1	5	4	2630.46	
3	Dhorika	14	19/2/2	1	6	657.61	
4	Dhorika	14	20/1/1	5	3	2605.16	424.65
5	Dhorika	14	20/1/2	2	9	1239.35	
6	Dhorika	14	21/2/1	2	10	1264.64	
7	Dhorika	14	22/1	0	2	50.59	
8	Dhorika	15	16/2/2	2	12	1315.23	598.69
Total				23	13	11963.52	2289.91
				2.95625	2.95625	0.566	Sqmt. Acre

GRAND TOTAL					
ITEM	Width 1 (m)	Width 2 (m)	Length (m)	Factor	Area (Sq.m)
TOTAL					11963.52

AREA DETAIL			
DESCRIPTION	FACTOR	ACRES	SQ.MT.
TOTAL AREA	2.95625	1333.333	
PERMISSIBLE G.C.	35.00%	4.695	4387.233
PROPOSED F.A.R.	1.300	35.00%	17965.272
PROPOSED G.C.	35.00%	4.697	4387.233
PROPOSED F.A.R.	1.300		17964.923
TOTAL NO. OF PLOTS			4210
RATIO OF F.A.R. DISTRIBUTION ON 1.0 SQ.MT. OF GROUND COVERAGE			4.210

BLOCK SUMMARY			
BLOCK NAME	PLOT NO.	NO. OF PLOTS	PROPOSED G.C. / PROPOSED F.A.R.
BLOCK-A	A1-A9	9	397.152 / 3031.654
BLOCK-B	B1-B9	9	397.152 / 3031.654
BLOCK-C	C1-C12	12	1776.728 / 3614.514
BLOCK-D	D1	1	255.545 / 1096.888
BLOCK-E	E1-E3	3	255.545 / 1096.888
TOTAL	34	480	17964.923
FACTOR			35.00%
BALANCE			0.715 / 6522

UTILITY BLOCK - FREE FROM GROUND COVERAGE & F.A.R.			
UTILITY BLOCK	PLOT NO.	AREA (SQ.MT.)	TOTAL AREA
UTILITY BLOCK	1	35.000	35.000

BLOCK-A AREA DETAIL			
PLOT NO.	PLOT SIZE	AREA (SQ.MT.)	TOTAL AREA
A1	8.250 X 11.830	122.550	395.850
A2	8.250 X 11.420	94.250	395.850
A3	6.000 X 16.500	99.000	395.850
A4	8.250 X 11.830	97.050	395.850
TOTAL		395.850	395.850

BLOCK-B AREA DETAIL			
PLOT NO.	PLOT SIZE	AREA (SQ.MT.)	TOTAL AREA
B1	8.250 X 11.830	122.550	395.850
B2	8.250 X 11.830	122.550	395.850
B3	6.000 X 16.500	99.000	395.850
B4	8.250 X 11.830	97.050	395.850
TOTAL		395.850	395.850

BLOCK-C AREA DETAIL			
PLOT NO.	PLOT SIZE	AREA (SQ.MT.)	TOTAL AREA
C1-C12	6.750 X 27.000	182.250	1776.728
TOTAL		182.250	1776.728

BLOCK-D AREA DETAIL			
PLOT NO.	PLOT SIZE	AREA (SQ.MT.)	TOTAL AREA
D1	15.300 X 16.667	253.545	253.545
TOTAL		253.545	253.545

BLOCK-E AREA DETAIL			
PLOT NO.	PLOT SIZE	AREA (SQ.MT.)	TOTAL AREA
E1	10.095 X 7.400	74.700	74.700
E2	10.095 X 7.400	74.700	74.700
E3	6.500 X 11.500	74.700	74.700
TOTAL		224.100	224.100

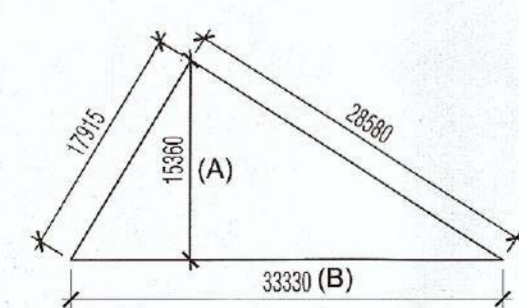

AREA FIGURE OF D1: AXB/2
 $= (33.330 \times 15.380) / 2$
 $= 255.94 \text{ SQM}$

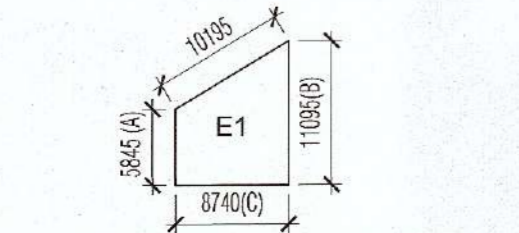

AREA FIGURE OF E1: (A+B)XC
 $= (10.095 + 11.095) \times 7.400 / 2$
 $= 74.02 \text{ SQM}$

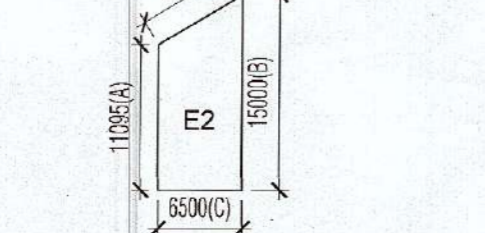

AREA FIGURE OF E2: (A+B)XC
 $= (11.095 + 15.000) \times 7.500 / 2$
 $= 84.80 \text{ SQM}$

PRINCIPAL ARCHITECT:

ACPL ISO 9001:2015
 ACPL Design Ltd
 6/24 South Extension - 1
 New Delhi 110048 India
 T: +91 11 26481235
 F: +91 11 26481236
 E: acpl@acpldesign.com

CLIENT:
GLS INFRAPROJECTS PVT. LTD.

PROJECT:
 DEMARICATION PLAN OF
 PLOTTED
 COMMERCIAL COLONY ON AN AREA MEASURING
 2.95625 ACRES IN THE REVENUE ESTATE OF
 VILLAGE DHORKA, SECTOR-95, DISTT.
 GURUGRAM - GLS INFRAPROJECTS PVT. LTD.
 DEVELOPED UNDER LICENCE NO. 103 of 2021 DATED 08-12-2021

For GLS Infraprojects Pvt. Ltd.
 Authorised Signatory

OWNER/AUTH. SIGNATURE ARCHITECT'S SIGNATURE

DRAWING TITLE
 LAYOUT CUM DEMARICATION PLAN

DRAWING NO. A-1 SCALE: 1 : 300