

AREA STATEMENT :		
DESCRIPTION	AREA IN SQ. METER	AREA IN ACRES
TOTAL AREA OF THE SCHEME	13708.70	3.3875 ACS.
PERMISSIBLE FAR = 150 %	20563.05 sqm.	5.08125 ACS.
PROPOSED FAR = 140.00%	19191.68 sqm.	4.742 ACS.
PERMISSIBLE GROUND COVERAGE	35.00% (4798.04 sqm.)	1.1856 ACS.
PROPOSED GROUND COVERAGE	34.996% (4797.92 sqm.)	1.1855 ACS.

AREA DETAIL

TYPE OF PLOTS	PLOT NO.	DIMENSION OF PLOTS IN SQ.M.	AREA OF PLOTS IN SQ.M.	NO OF FLOORS	GROUND COVERAGE IN SQ.M.	Total Units	Total FAR
A	1-10	6.10 x 19.00	115.90	8	927.20	32	378.8
B	9	5.03 x 17.00	85.51	4	85.51	4	141.04
B1	10,10,28	4.90 x 17.00	83.30	19	1582.70	76	638.04
C	29	4.79 x 17.64	84.50	1	84.50	4	337.824
C1	30,10,39	5.00 x 17.64	88.20	10	882.00	40	3528
D	40,10,58	5.10 x 12.10	61.71	19	1172.49	76	4689.96
D1	59	5.25 x 12.10	63.53	1	63.53	4	254.1
TOTAL					4797.92	236	19191.68



Car Parking Size = 2.5 X 5.0 meter = 12.50 @ ECS.
PARKING AREA CAN NOT BE SOLD AT ANY MANNER.

FOR AMOLIK BUILDCON LLP
Auth. Signatory

AUTHORIZED SIGNATORY



GARG & ASSOCIATES
42, Regd. Building, Chhatrapati Shivaji Maharaj
Museum, Mumbai - 400 004, Maharashtra

ARCHITECT SIGNATURE

SCALE 1 : 850

CLIENT:-
M/S AMOLIK BUILDCON LLP,
ADD. 14/3 MAIN MATHERA ROAD, NEWLA MATHARAPUR, FARIDABAD HARYANA - 121003

LAYOUT PLAN OF COMMERCIAL PLOTTED COLONY/ SCO
IN SECTOR-88, AREA MEASURING - 3.3875 ACS.
IN VILLAGE KHERTI-KALAN DISTRICT-FARIDABAD, HARYANA.

DATE:- DEC-2020 DESIGN BY:-PANKAJ KAPOOR (8800093157)

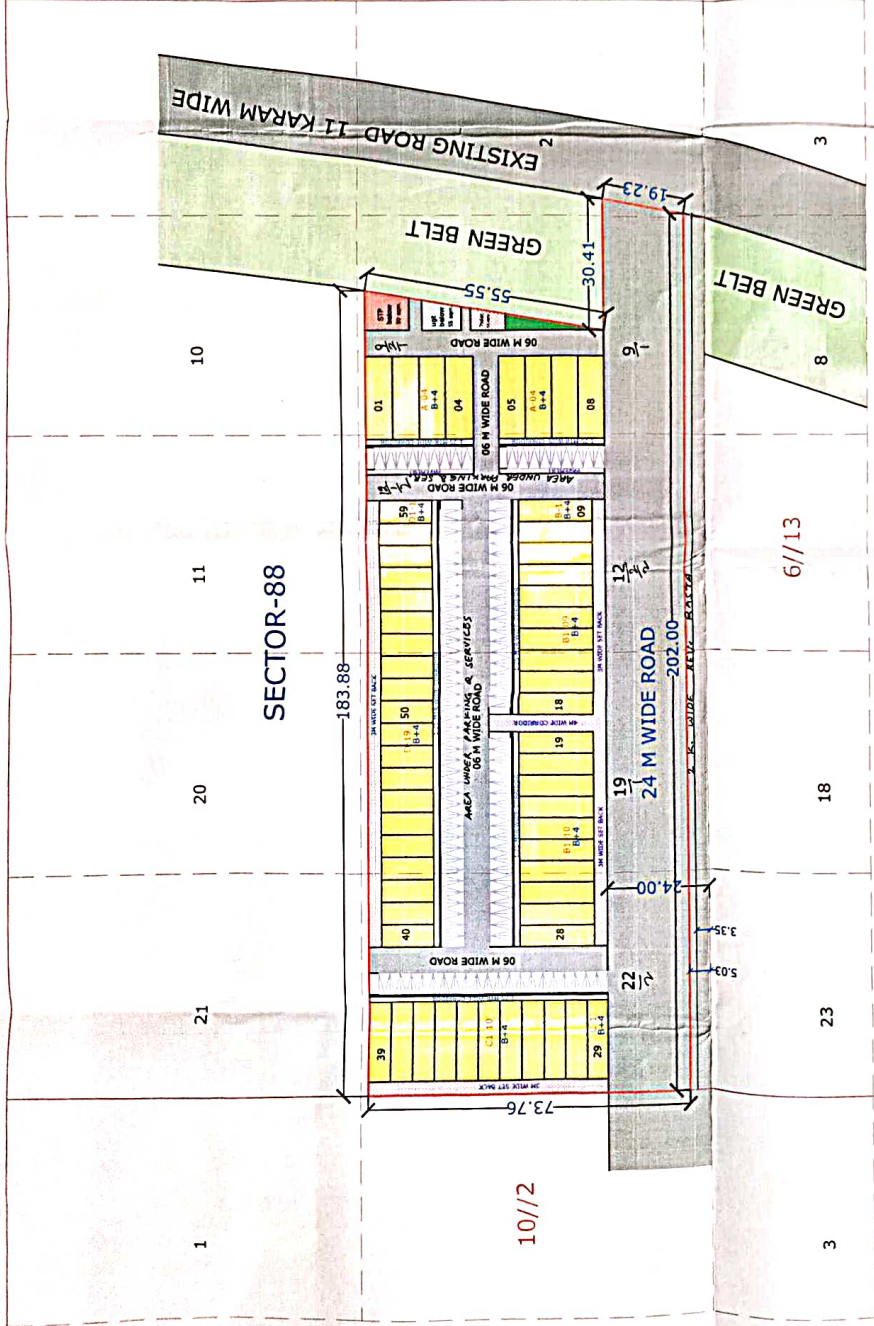

DKG No. - DTC P 8001 DATE: 09-11-2021
L.No. 90/03.11.2021.
 (MANGINDER KUMAR) ADP(HQ)
 (SUNAMA) DTP(HQ)
 (HITESH SHARMA) STP(HQ)
 (K. MANIRAM PANDURANG) DTP(HQ)