

2 KARAM ( 3.352M) WIDE UNCULTIVABLE LAND (GAIR MUMKIN)

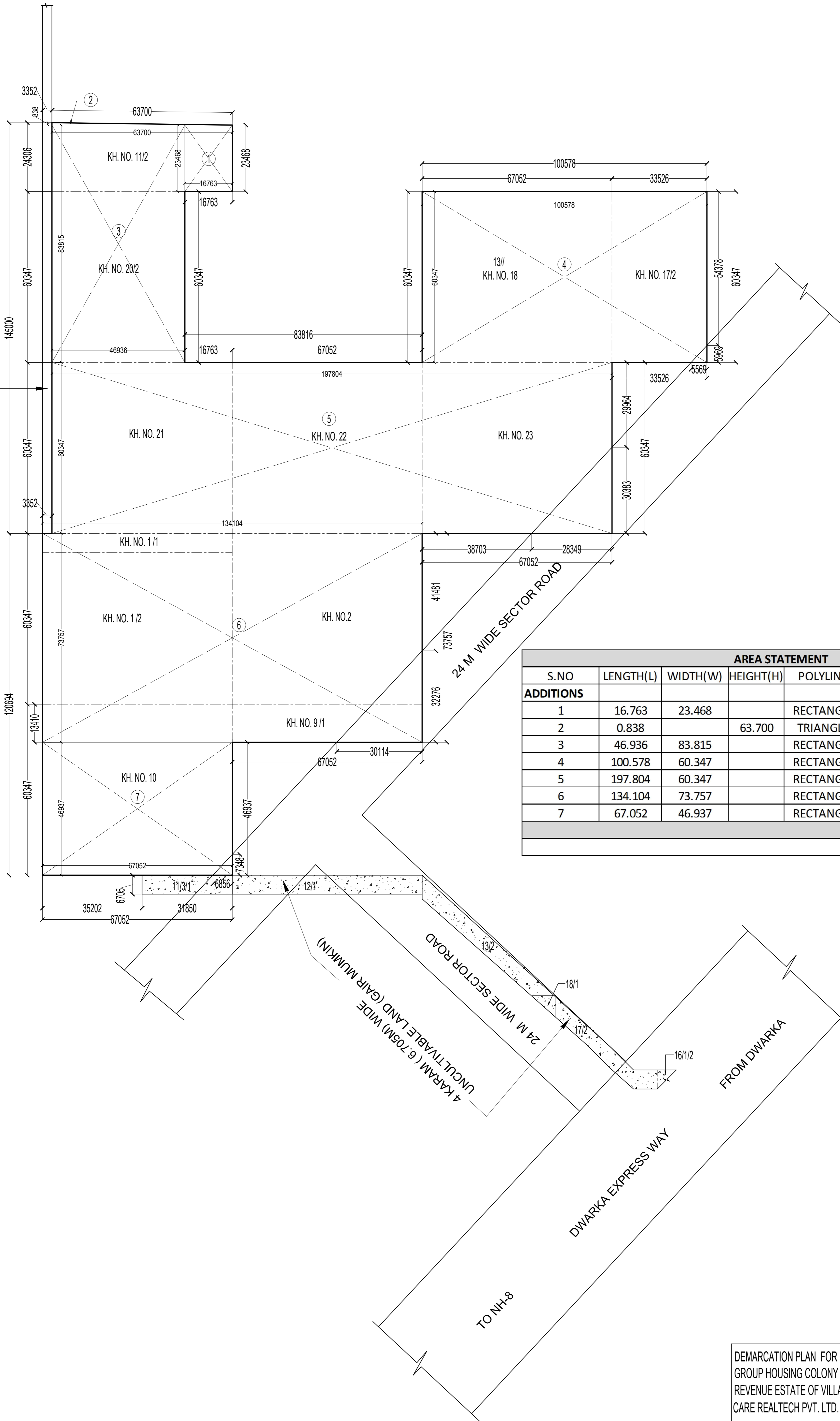

AREA STATEMENT						
S.NO	LENGTH(L)	WIDTH(W)	HEIGHT(H)	POLYLINE	FORMULA	AREA
<b>ADDITIONS</b>						
1	16.763	23.468		RECTANGLE	LXW	393.394
2	0.838		63.700	TRIANGLE	1/2XLXH	26.690
3	46.936	83.815		RECTANGLE	LXW	3933.941
4	100.578	60.347		RECTANGLE	LXW	6069.581
5	197.804	60.347		RECTANGLE	LXW	11936.878
6	134.104	73.757		RECTANGLE	LXW	9891.109
7	67.052	46.937		RECTANGLE	LXW	3147.220
<b>TOTAL AREA=</b>						<b>35398.81</b>
						<b>8.75 ACRES</b>



DEMARCATION PLAN FOR GRANT OF LICENCE FOR SETTING UP AN AFFORDABLE GROUP HOUSING COLONY OVER AN AREA MEASURING 8.75 ACRES IN THE REVENUE ESTATE OF VILLAGE TIKAMPUR, SECTOR-103, GURUGRAM-CARE REALTECH PVT. LTD. IN COLLABORATION WITH HCBS DEVELOPMENTS LTD.

SCALE	1: 800
OWNER SIGN.	ARCHITECT SIGN.