

01 TERRACE FLOOR PLAN  
SCALE 1:100

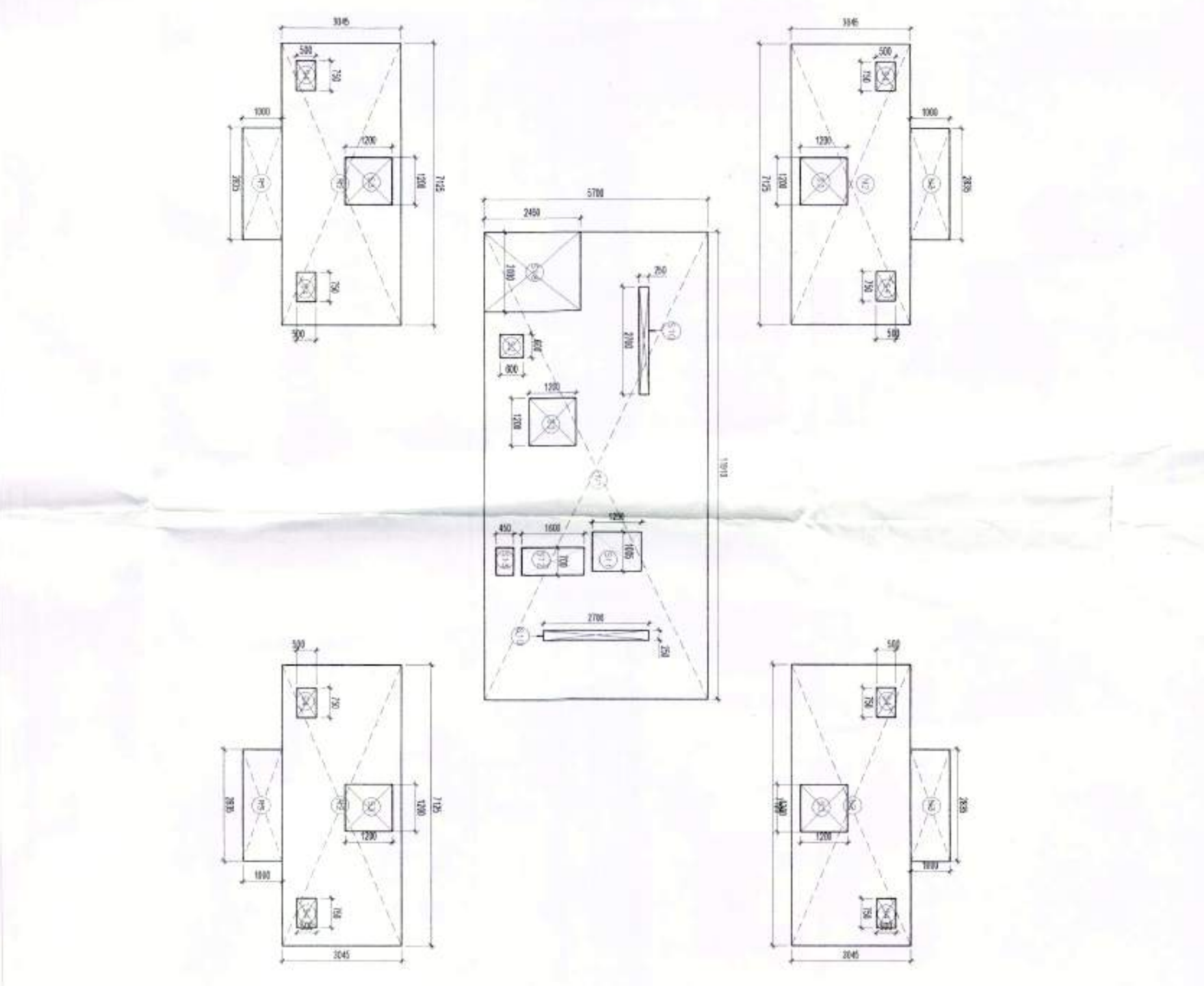

01 TERRACE FLOOR AREA DIAGRAM PLAN  
SCALE 1:800

TOWER 2						
Terrace Floor (Non Fair)						
Description	Length (m)	Breadth (m)	Base (m)	Height (m)	Area (sqm)	No. of Figures
Area of rectangle N1	11.910	5.700	-	-	67.887	1
Area of rectangle N2	7.125	3.045	-	-	21.696	4
Area of rectangle N3	2.835	1.000	-	-	2.835	4
Total of all additions 'A'					11.340	166.010
Deductions 'B'						
Description	Length (m)	Breadth (m)	Base (m)	Height (m)	Area (sqm)	No. of Figures
Area of rectangle S2	0.600	0.600	-	-	0.360	1
Area of rectangle S3	1.200	1.200	-	-	1.440	5
Area of rectangle S4	0.750	0.500	-	-	0.375	8
Area of rectangle S10	0.250	2.700	-	-	0.675	2
Area of rectangle S11	1.005	1.250	-	-	1.256	1
Area of rectangle S12	0.700	1.600	-	-	1.120	1
Area of rectangle S13	0.700	0.450	-	-	0.315	1
Area of rectangle S18	2.000	2.450	-	-	4.900	1
Total of all Deductions 'B'					19.501	
Total Non Fair Terrace Area for Tower 2= (A - B)					146.508	

SCHEDULE OF DOORS			
REF NO	DESCRIPTION	WIDTH	HEIGHT
01	1000 SWG FPF	800	2100
02	750 AUTOMATIC FPF	750	2100
03	1000 SWG WTR DR	800	2100
04	1000 SWG WTR DR	1000	2100
05	750 BALCONY DR	1000	2100
06	750 BALCONY DR	1000	2100
07	750 BALCONY DR	1000	2100
08	750 BALCONY DR	1000	2100
09	750 BALCONY DR	1000	2100
10	750 BALCONY DR	1000	2100
11	750 BALCONY DR	1000	2100
12	750 BALCONY DR	1000	2100
13	750 BALCONY DR	1000	2100
14	750 BALCONY DR	1000	2100
15	750 BALCONY DR	1000	2100
16	750 BALCONY DR	1000	2100
17	750 BALCONY DR	1000	2100
18	750 BALCONY DR	1000	2100
19	750 BALCONY DR	1000	2100
20	750 BALCONY DR	1000	2100
21	750 BALCONY DR	1000	2100
22	750 BALCONY DR	1000	2100
23	750 BALCONY DR	1000	2100
24	750 BALCONY DR	1000	2100
25	750 BALCONY DR	1000	2100
26	750 BALCONY DR	1000	2100
27	750 BALCONY DR	1000	2100
28	750 BALCONY DR	1000	2100
29	750 BALCONY DR	1000	2100
30	750 BALCONY DR	1000	2100
31	750 BALCONY DR	1000	2100
32	750 BALCONY DR	1000	2100
33	750 BALCONY DR	1000	2100
34	750 BALCONY DR	1000	2100
35	750 BALCONY DR	1000	2100
36	750 BALCONY DR	1000	2100
37	750 BALCONY DR	1000	2100
38	750 BALCONY DR	1000	2100
39	750 BALCONY DR	1000	2100
40	750 BALCONY DR	1000	2100
41	750 BALCONY DR	1000	2100
42	750 BALCONY DR	1000	2100
43	750 BALCONY DR	1000	2100
44	750 BALCONY DR	1000	2100
45	750 BALCONY DR	1000	2100
46	750 BALCONY DR	1000	2100
47	750 BALCONY DR	1000	2100
48	750 BALCONY DR	1000	2100
49	750 BALCONY DR	1000	2100
50	750 BALCONY DR	1000	2100
51	750 BALCONY DR	1000	2100
52	750 BALCONY DR	1000	2100
53	750 BALCONY DR	1000	2100
54	750 BALCONY DR	1000	2100
55	750 BALCONY DR	1000	2100
56	750 BALCONY DR	1000	2100
57	750 BALCONY DR	1000	2100
58	750 BALCONY DR	1000	2100
59	750 BALCONY DR	1000	2100
60	750 BALCONY DR	1000	2100
61	750 BALCONY DR	1000	2100
62	750 BALCONY DR	1000	2100
63	750 BALCONY DR	1000	2100
64	750 BALCONY DR	1000	2100
65	750 BALCONY DR	1000	2100
66	750 BALCONY DR	1000	2100
67	750 BALCONY DR	1000	2100
68	750 BALCONY DR	1000	2100
69	750 BALCONY DR	1000	2100
70	750 BALCONY DR	1000	2100
71	750 BALCONY DR	1000	2100
72	750 BALCONY DR	1000	2100
73	750 BALCONY DR	1000	2100
74	750 BALCONY DR	1000	2100
75	750 BALCONY DR	1000	2100
76	750 BALCONY DR	1000	2100
77	750 BALCONY DR	1000	2100
78	750 BALCONY DR	1000	2100
79	750 BALCONY DR	1000	2100
80	750 BALCONY DR	1000	2100
81	750 BALCONY DR	1000	2100
82	750 BALCONY DR	1000	2100
83	750 BALCONY DR	1000	2100
84	750 BALCONY DR	1000	2100
85	750 BALCONY DR	1000	2100
86	750 BALCONY DR	1000	2100
87	750 BALCONY DR	1000	2100
88	750 BALCONY DR	1000	2100
89	750 BALCONY DR	1000	2100
90	750 BALCONY DR	1000	2100
91	750 BALCONY DR	1000	2100
92	750 BALCONY DR	1000	2100
93	750 BALCONY DR	1000	2100
94	750 BALCONY DR	1000	2100
95	750 BALCONY DR	1000	2100
96	750 BALCONY DR	1000	2100
97	750 BALCONY DR	1000	2100
98	750 BALCONY DR	1000	2100
99	750 BALCONY DR	1000	2100
100	750 BALCONY DR	1000	2100



NOTE : ALL PARAPET AND RAILING HEIGHTS ARE IN COMPLIANCE PER NBC 2016  
ALL FIRE DOORS RATING ARE IN COMPLIANCE WITH NBC 2016

For Approval Stamping:  
**This is a 'PROVISIONAL BUILDING PLAN'**  
approved only for the purpose of inviting  
objections from the general public.

NOTES:  
1) ALL STRUCTURE PROVIDED IN TOILETS ARE AS PER NBC.  
2) DRAWINGS WILL BE AIRTELAY VENTILATED SERVICES BASEMENT ETC.) WILL BE AIRTELAY LIT.  
3) STANDBY GENERATING CAPACITY WILL BE 10% OF THE TOTAL SCHEME THIS THEREFORE INCLUDES STANDBY GENERATION FOR ALL COMMON SERVICES FIRE SERVICES, ELECTRICAL LOAD FOR THE VENTILATION, FIRE SAFETY MEASURES AS PER NBC INCLUDES SMOKE DETECTOR, MFC COMPLIANCE WITH CODE.



Project:  
REVISED GROUP HOUSING SCHEME MEASURING 17.55 ACRES LICENCE NO. 1607/2008 DATED 22/08/2008 (100%) + 4.72 ACRES LICENCE NO. 44 OF 2011 DATED 15/05/2011 = 22.27 ACRES IN SECTOR 59 GURGAON MANESAR COMMANDER RELATIONS PVT LTD. ORAMMANIYA REALTORS PVT. LTD. GOLDEN VIEW BUILDERS PVT. LTD. FIVE RIVER BUILDCON PVT. LTD. FIVE RIVER BUILDCON PVT. LTD. ASHRANI BUILDERS PVT. LTD. FIVE RIVER BUILDCON PVT. LTD. IN COLLABORATION WITH BY BAE EXPORTS PVT. LTD. & BUIZ HOTELS PVT. LTD.

Authorized Signature

STRUCTURAL CONSULTANT  
VINTECH

Consulting MEP  
ENVERSUS CONSULTANTS PVT LTD

Consulting LANDSCAPE  
ORACLE

Architect's Sign  
Morphogenesis

Drawing Title  
TOWER-2  
TERRACE LVL. PLAN

Drawing No.  
T-02-6

Scale  
1:100

