

Area Details Phase 2 AS SANCTIONED

Sl. No.	Room	Area (sqm)	Volume (cu m)	Remarks
1	Office	1000	1000	
2	Meeting Room	500	500	
3	Conference Room	300	300	
4	Reception	200	200	
5	Waiting Area	150	150	
6	Corridor	100	100	
7	Staircase	80	80	
8	Lift	50	50	
9	Plant Room	40	40	
10	Garage	30	30	
11	Storage	20	20	
12	W.C.	15	15	
13	Shower	10	10	
14	Bed Room	8	8	
15	Bathroom	5	5	
16	Kitchen	4	4	
17	Dining	3	3	
18	Living	2	2	
19	Veranda	1	1	
20	Other	1	1	
21	Roof	1	1	
22	Basement	1	1	
23	Substructure	1	1	
24	Structure	1	1	
25	Finishing	1	1	
26	Painting	1	1	
27	Electrical	1	1	
28	Plumbing	1	1	
29	Mechanical	1	1	
30	Other	1	1	
31	Roof	1	1	
32	Basement	1	1	
33	Substructure	1	1	
34	Structure	1	1	
35	Finishing	1	1	
36	Painting	1	1	
37	Electrical	1	1	
38	Plumbing	1	1	
39	Mechanical	1	1	
40	Other	1	1	

24.0 MT. WIDE INTERNAL CIRCULATION ROAD

SECTOR-58

120 MT. WIDE EXISTING SERVICE ROAD

60.0 MT. WIDE EXISTING SERVICE ROAD

24.0 MT. WIDE INTERNAL CIRCULATION ROAD

SECTOR-59 Village-Behrampur

APPLIED FOR SANCTION  
ADDITIONAL EWS  
UNITS ON 2nd, 3rd &  
4th FLOOR

Phase 1 & 2 Area Summary

Sl. No.	Description	Area (sqm)	Volume (cu m)	Remarks
1	Office	1000	1000	
2	Meeting Room	500	500	
3	Conference Room	300	300	
4	Reception	200	200	
5	Waiting Area	150	150	
6	Corridor	100	100	
7	Staircase	80	80	
8	Lift	50	50	
9	Plant Room	40	40	
10	Garage	30	30	
11	Storage	20	20	
12	W.C.	15	15	
13	Shower	10	10	
14	Bed Room	8	8	
15	Bathroom	5	5	
16	Kitchen	4	4	
17	Dining	3	3	
18	Living	2	2	
19	Veranda	1	1	
20	Other	1	1	
21	Roof	1	1	
22	Basement	1	1	
23	Substructure	1	1	
24	Structure	1	1	
25	Finishing	1	1	
26	Painting	1	1	
27	Electrical	1	1	
28	Plumbing	1	1	
29	Mechanical	1	1	
30	Other	1	1	

Description	Length (m)	Breadth (m)	Area (sqm)	No. of Figures
G15	41.91	35.92	1505.65	1
G16	41.91	35.92	1505.65	1
G17	41.91	35.92	1505.65	1
G18	41.91	35.92	1505.65	1
<b>Total Green Area</b>			<b>6022.60</b>	<b>4</b>

S.No	Type	No. of Units	No. of Persons	No. of Cars
1	3 BHK Units	310	5	1
2	4 BHK Units	5	5	1
3	5 BHK Units	5	5	1
4	6 BHK Units	5	5	1
5	EWS	68	2	0
<b>Total</b>		<b>448</b>	<b>212</b>	<b>4</b>

Description	Length (m)	Breadth (m)	Area (sqm)	No. of Figures
G19	41.91	35.92	1505.65	1
G20	41.91	35.92	1505.65	1
G21	41.91	35.92	1505.65	1
G22	41.91	35.92	1505.65	1
<b>Total Green Area</b>			<b>6022.60</b>	<b>4</b>

Description	Length (m)	Breadth (m)	Area (sqm)	No. of Figures
G23	41.91	35.92	1505.65	1
G24	41.91	35.92	1505.65	1
G25	41.91	35.92	1505.65	1
G26	41.91	35.92	1505.65	1
<b>Total Green Area</b>			<b>6022.60</b>	<b>4</b>

For Approval Stamping:  
This is a "PROVISIONAL BUILDING PLAN" approved only for the purpose of inviting applications from the general public.

- NOTES:
- 1) ALL FIXTURE PROVIDED IN TOILETS ARE AS PER N.B.C.
  - 2) BASEMENT WILL BE ARTIFICIALLY VENTILATED.
  - 3) ALL SPACES (PARKING BASEMENT, ARTIFICIAL LIGHTING, ETC.) WILL BE ARTIFICIALLY VENTILATED.
  - 4) STANDBY GENERATING CAPACITY WILL BE PROVIDED FOR THE ELECTRICAL REQUIREMENT OF THE TOTAL SCHEME. THIS THEREFORE INCLUDES STANDBY CAPACITY FOR ALL COMMON SERVICES (FIRE SERVICES, LIFTS ETC.) AND ALSO THE ENTIRE ELECTRICAL LOAD FOR THE VENTILATION.
  - 5) FIRE SAFETY MEASURES AS PER NBC DETECTOR, SPRINKLER SPACING IN COMPLIANCE WITH CODE

Key Plan:

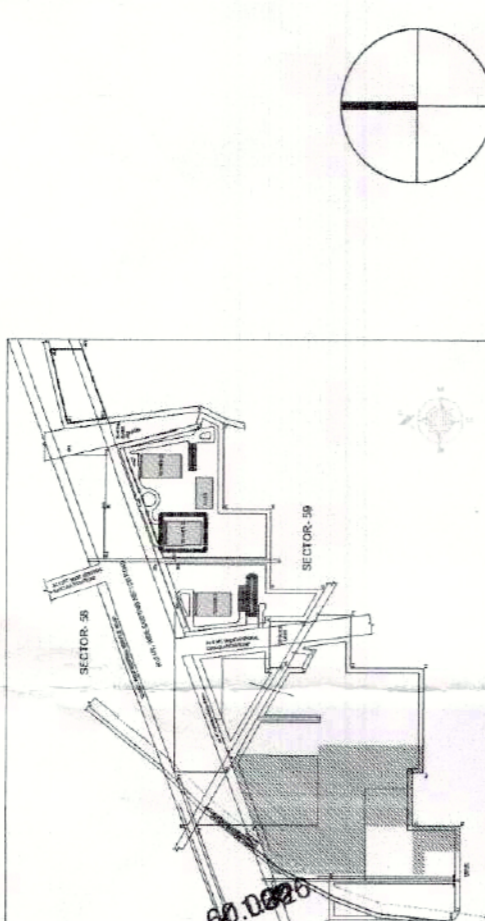

Project:  
REVISED GROUP HOUSING SCHEME MEASURING 17.65 ACRES (LICENCE NO. 16 OF 2008 DATED 31.08.2008) + 11.90 ACRES (LICENCE NO. 28 OF 2008 DATED 17.02.2008) + 4.75 ACRES (LICENCE NO. 44 OF 2011 DATED 13.05.2011) + 1.00 ACRES (LICENCE NO. 10 OF 2011 DATED 13.05.2011) + 1.00 ACRES (LICENCE NO. 11 OF 2011 DATED 13.05.2011) + 1.00 ACRES (LICENCE NO. 12 OF 2011 DATED 13.05.2011) + 1.00 ACRES (LICENCE NO. 13 OF 2011 DATED 13.05.2011) + 1.00 ACRES (LICENCE NO. 14 OF 2011 DATED 13.05.2011) + 1.00 ACRES (LICENCE NO. 15 OF 2011 DATED 13.05.2011) + 1.00 ACRES (LICENCE NO. 16 OF 2011 DATED 13.05.2011) + 1.00 ACRES (LICENCE NO. 17 OF 2011 DATED 13.05.2011) + 1.00 ACRES (LICENCE NO. 18 OF 2011 DATED 13.05.2011) + 1.00 ACRES (LICENCE NO. 19 OF 2011 DATED 13.05.2011) + 1.00 ACRES (LICENCE NO. 20 OF 2011 DATED 13.05.2011) + 1.00 ACRES (LICENCE NO. 21 OF 2011 DATED 13.05.2011) + 1.00 ACRES (LICENCE NO. 22 OF 2011 DATED 13.05.2011) + 1.00 ACRES (LICENCE NO. 23 OF 2011 DATED 13.05.2011) + 1.00 ACRES (LICENCE NO. 24 OF 2011 DATED 13.05.2011) + 1.00 ACRES (LICENCE NO. 25 OF 2011 DATED 13.05.2011) + 1.00 ACRES (LICENCE NO. 26 OF 2011 DATED 13.05.2011) + 1.00 ACRES (LICENCE NO. 27 OF 2011 DATED 13.05.2011) + 1.00 ACRES (LICENCE NO. 28 OF 2011 DATED 13.05.2011) + 1.00 ACRES (LICENCE NO. 29 OF 2011 DATED 13.05.2011) + 1.00 ACRES (LICENCE NO. 30 OF 2011 DATED 13.05.2011) + 1.00 ACRES (LICENCE NO. 31 OF 2011 DATED 13.05.2011) + 1.00 ACRES (LICENCE NO. 32 OF 2011 DATED 13.05.2011) + 1.00 ACRES (LICENCE NO. 33 OF 2011 DATED 13.05.2011) + 1.00 ACRES (LICENCE NO. 34 OF 2011 DATED 13.05.2011) + 1.00 ACRES (LICENCE NO. 35 OF 2011 DATED 13.05.2011) + 1.00 ACRES (LICENCE NO. 36 OF 2011 DATED 13.05.2011) + 1.00 ACRES (LICENCE NO. 37 OF 2011 DATED 13.05.2011) + 1.00 ACRES (LICENCE NO. 38 OF 2011 DATED 13.05.2011) + 1.00 ACRES (LICENCE NO. 39 OF 2011 DATED 13.05.2011) + 1.00 ACRES (LICENCE NO. 40 OF 2011 DATED 13.05.2011) + 1.00 ACRES (LICENCE NO. 41 OF 2011 DATED 13.05.2011) + 1.00 ACRES (LICENCE NO. 42 OF 2011 DATED 13.05.2011) + 1.00 ACRES (LICENCE NO. 43 OF 2011 DATED 13.05.2011) + 1.00 ACRES (LICENCE NO. 44 OF 2011 DATED 13.05.2011) + 1.00 ACRES (LICENCE NO. 45 OF 2011 DATED 13.05.2011) + 1.00 ACRES (LICENCE NO. 46 OF 2011 DATED 13.05.2011) + 1.00 ACRES (LICENCE NO. 47 OF 2011 DATED 13.05.2011) + 1.00 ACRES (LICENCE NO. 48 OF 2011 DATED 13.05.2011) + 1.00 ACRES (LICENCE NO. 49 OF 2011 DATED 13.05.2011) + 1.00 ACRES (LICENCE NO. 50 OF 2011 DATED 13.05.2011) + 1.00 ACRES (LICENCE NO. 51 OF 2011 DATED 13.05.2011) + 1.00 ACRES (LICENCE NO. 52 OF 2011 DATED 13.05.2011) + 1.00 ACRES (LICENCE NO. 53 OF 2011 DATED 13.05.2011) + 1.00 ACRES (LICENCE NO. 54 OF 2011 DATED 13.05.2011) + 1.00 ACRES (LICENCE NO. 55 OF 2011 DATED 13.05.2011) + 1.00 ACRES (LICENCE NO. 56 OF 2011 DATED 13.05.2011) + 1.00 ACRES (LICENCE NO. 57 OF 2011 DATED 13.05.2011) + 1.00 ACRES (LICENCE NO. 58 OF 2011 DATED 13.05.2011) + 1.00 ACRES (LICENCE NO. 59 OF 2011 DATED 13.05.2011) + 1.00 ACRES (LICENCE NO. 60 OF 2011 DATED 13.05.2011) + 1.00 ACRES (LICENCE NO. 61 OF 2011 DATED 13.05.2011) + 1.00 ACRES (LICENCE NO. 62 OF 2011 DATED 13.05.2011) + 1.00 ACRES (LICENCE NO. 63 OF 2011 DATED 13.05.2011) + 1.00 ACRES (LICENCE NO. 64 OF 2011 DATED 13.05.2011) + 1.00 ACRES (LICENCE NO. 65 OF 2011 DATED 13.05.2011) + 1.00 ACRES (LICENCE NO. 66 OF 2011 DATED 13.05.2011) + 1.00 ACRES (LICENCE NO. 67 OF 2011 DATED 13.05.2011) + 1.00 ACRES (LICENCE NO. 68 OF 2011 DATED 13.05.2011) + 1.00 ACRES (LICENCE NO. 69 OF 2011 DATED 13.05.2011) + 1.00 ACRES (LICENCE NO. 70 OF 2011 DATED 13.05.2011) + 1.00 ACRES (LICENCE NO. 71 OF 2011 DATED 13.05.2011) + 1.00 ACRES (LICENCE NO. 72 OF 2011 DATED 13.05.2011) + 1.00 ACRES (LICENCE NO. 73 OF 2011 DATED 13.05.2011) + 1.00 ACRES (LICENCE NO. 74 OF 2011 DATED 13.05.2011) + 1.00 ACRES (LICENCE NO. 75 OF 2011 DATED 13.05.2011) + 1.00 ACRES (LICENCE NO. 76 OF 2011 DATED 13.05.2011) + 1.00 ACRES (LICENCE NO. 77 OF 2011 DATED 13.05.2011) + 1.00 ACRES (LICENCE NO. 78 OF 2011 DATED 13.05.2011) + 1.00 ACRES (LICENCE NO. 79 OF 2011 DATED 13.05.2011) + 1.00 ACRES (LICENCE NO. 80 OF 2011 DATED 13.05.2011) + 1.00 ACRES (LICENCE NO. 81 OF 2011 DATED 13.05.2011) + 1.00 ACRES (LICENCE NO. 82 OF 2011 DATED 13.05.2011) + 1.00 ACRES (LICENCE NO. 83 OF 2011 DATED 13.05.2011) + 1.00 ACRES (LICENCE NO. 84 OF 2011 DATED 13.05.2011) + 1.00 ACRES (LICENCE NO. 85 OF 2011 DATED 13.05.2011) + 1.00 ACRES (LICENCE NO. 86 OF 2011 DATED 13.05.2011) + 1.00 ACRES (LICENCE NO. 87 OF 2011 DATED 13.05.2011) + 1.00 ACRES (LICENCE NO. 88 OF 2011 DATED 13.05.2011) + 1.00 ACRES (LICENCE NO. 89 OF 2011 DATED 13.05.2011) + 1.00 ACRES (LICENCE NO. 90 OF 2011 DATED 13.05.2011) + 1.00 ACRES (LICENCE NO. 91 OF 2011 DATED 13.05.2011) + 1.00 ACRES (LICENCE NO. 92 OF 2011 DATED 13.05.2011) + 1.00 ACRES (LICENCE NO. 93 OF 2011 DATED 13.05.2011) + 1.00 ACRES (LICENCE NO. 94 OF 2011 DATED 13.05.2011) + 1.00 ACRES (LICENCE NO. 95 OF 2011 DATED 13.05.2011) + 1.00 ACRES (LICENCE NO. 96 OF 2011 DATED 13.05.2011) + 1.00 ACRES (LICENCE NO. 97 OF 2011 DATED 13.05.2011) + 1.00 ACRES (LICENCE NO. 98 OF 2011 DATED 13.05.2011) + 1.00 ACRES (LICENCE NO. 99 OF 2011 DATED 13.05.2011) + 1.00 ACRES (LICENCE NO. 100 OF 2011 DATED 13.05.2011) + 1.00 ACRES (LICENCE NO. 101 OF 2011 DATED 13.05.2011) + 1.00 ACRES (LICENCE NO. 102 OF 2011 DATED 13.05.2011) + 1.00 ACRES (LICENCE NO. 103 OF 2011 DATED 13.05.2011) + 1.00 ACRES (LICENCE NO. 104 OF 2011 DATED 13.05.2011) + 1.00 ACRES (LICENCE NO. 105 OF 2011 DATED 13.05.2011) + 1.00 ACRES (LICENCE NO. 106 OF 2011 DATED 13.05.2011) + 1.00 ACRES (LICENCE NO. 107 OF 2011 DATED 13.05.2011) + 1.00 ACRES (LICENCE NO. 108 OF 2011 DATED 13.05.2011) + 1.00 ACRES (LICENCE NO. 109 OF 2011 DATED 13.05.2011) + 1.00 ACRES (LICENCE NO. 110 OF 2011 DATED 13.05.2011) + 1.00 ACRES (LICENCE NO. 111 OF 2011 DATED 13.05.2011) + 1.00 ACRES (LICENCE NO. 112 OF 2011 DATED 13.05.2011) + 1.00 ACRES (LICENCE NO. 113 OF 2011 DATED 13.05.2011) + 1.00 ACRES (LICENCE NO. 114 OF 2011 DATED 13.05.2011) + 1.00 ACRES (LICENCE NO. 115 OF 2011 DATED 13.05.2011) + 1.00 ACRES (LICENCE NO. 116 OF 2011 DATED 13.05.2011) + 1.00 ACRES (LICENCE NO. 117 OF 2011 DATED 13.05.2011) + 1.00 ACRES (LICENCE NO. 118 OF 2011 DATED 13.05.2011) + 1.00 ACRES (LICENCE NO. 119 OF 2011 DATED 13.05.2011) + 1.00 ACRES (LICENCE NO. 120 OF 2011 DATED 13.05.2011) + 1.00 ACRES (LICENCE NO. 121 OF 2011 DATED 13.05.2011) + 1.00 ACRES (LICENCE NO. 122 OF 2011 DATED 13.05.2011) + 1.00 ACRES (LICENCE NO. 123 OF 2011 DATED 13.05.2011) + 1.00 ACRES (LICENCE NO. 124 OF 2011 DATED 13.05.2011) + 1.00 ACRES (LICENCE NO. 125 OF 2011 DATED 13.05.2011) + 1.00 ACRES (LICENCE NO. 126 OF 2011 DATED 13.05.2011) + 1.00 ACRES (LICENCE NO. 127 OF 2011 DATED 13.05.2011) + 1.00 ACRES (LICENCE NO. 128 OF 2011 DATED 13.05.2011) + 1.00 ACRES (LICENCE NO. 129 OF 2011 DATED 13.05.2011) + 1.00 ACRES (LICENCE NO. 130 OF 2011 DATED 13.05.2011) + 1.00 ACRES (LICENCE NO. 131 OF 2011 DATED 13.05.2011) + 1.00 ACRES (LICENCE NO. 132 OF 2011 DATED 13.05.2011) + 1.00 ACRES (LICENCE NO. 133 OF 2011 DATED 13.05.2011) + 1.00 ACRES (LICENCE NO. 134 OF 2011 DATED 13.05.2011) + 1.00 ACRES (LICENCE NO. 135 OF 2011 DATED 13.05.2011) + 1.00 ACRES (LICENCE NO. 136 OF 2011 DATED 13.05.2011) + 1.00 ACRES (LICENCE NO. 137 OF 2011 DATED 13.05.2011) + 1.00 ACRES (LICENCE NO. 138 OF 2011 DATED 13.05.2011) + 1.00 ACRES (LICENCE NO. 139 OF 2011 DATED 13.05.2011) + 1.00 ACRES (LICENCE NO. 140 OF 2011 DATED 13.05.2011) + 1.00 ACRES (LICENCE NO. 141 OF 2011 DATED 13.05.2011) + 1.00 ACRES (LICENCE NO. 142 OF 2011 DATED 13.05.2011) + 1.00 ACRES (LICENCE NO. 143 OF 2011 DATED 13.05.2011) + 1.00 ACRES (LICENCE NO. 144 OF 2011 DATED 13.05.2011) + 1.00 ACRES (LICENCE NO. 145 OF 2011 DATED 13.05.2011) + 1.00 ACRES (LICENCE NO. 146 OF 2011 DATED 13.05.2011) + 1.00 ACRES (LICENCE NO. 147 OF 2011 DATED 13.05.2011) + 1.00 ACRES (LICENCE NO. 148 OF 2011 DATED 13.05.2011) + 1.00 ACRES (LICENCE NO. 149 OF 2011 DATED 13.05.2011) + 1.00 ACRES (LICENCE NO. 150 OF 2011 DATED 13.05.2011) + 1.00 ACRES (LICENCE NO. 151 OF 2011 DATED 13.05.2011) + 1.00 ACRES (LICENCE NO. 152 OF 2011 DATED 13.05.2011) + 1.00 ACRES (LICENCE NO. 153 OF 2011 DATED 13.05.2011) + 1.00 ACRES (LICENCE NO. 154 OF 2011 DATED 13.05.2011) + 1.00 ACRES (LICENCE NO. 155 OF 2011 DATED 13.05.2011) + 1.00 ACRES (LICENCE NO. 156 OF 2011 DATED 13.05.2011) + 1.00 ACRES (LICENCE NO. 157 OF 2011 DATED 13.05.2011) + 1.00 ACRES (LICENCE NO. 158 OF 2011 DATED 13.05.2011) + 1.00 ACRES (LICENCE NO. 159 OF 2011 DATED 13.05.2011) + 1.00 ACRES (LICENCE NO. 160 OF 2011 DATED 13.05.2011) + 1.00 ACRES (LICENCE NO. 161 OF 2011 DATED 13.05.2011) + 1.00 ACRES (LICENCE NO. 162 OF 2011 DATED 13.05.2011) + 1.00 ACRES (LICENCE NO. 163 OF 2011 DATED 13.05.2011) + 1.00 ACRES (LICENCE NO. 164 OF 2011 DATED 13.05.2011) + 1.00 ACRES (LICENCE NO. 165 OF 2011 DATED 13.05.2011) + 1.00 ACRES (LICENCE NO. 166 OF 2011 DATED 13.05.2011) + 1.00 ACRES (LICENCE NO. 167 OF 2011 DATED 13.05.2011) + 1.00 ACRES (LICENCE NO. 168 OF 2011 DATED 13.05.2011) + 1.00 ACRES (LICENCE NO. 169 OF 2011 DATED 13.05.2011) + 1.00 ACRES (LICENCE NO. 170 OF 2011 DATED 13.05.2011) + 1.00 ACRES (LICENCE NO. 171 OF 2011 DATED 13.05.2011) + 1.00 ACRES (LICENCE NO. 172 OF 2011 DATED 13.05.2011) + 1.00 ACRES (LICENCE NO. 173 OF 2011 DATED 13.05.2011) + 1.00 ACRES (LICENCE NO. 174 OF 2011 DATED 13.05.2011) + 1.00 ACRES (LICENCE NO. 175 OF 2011 DATED 13.05.2011) + 1.00 ACRES (LICENCE NO. 176 OF 2011 DATED 13.05.2011) + 1.00 ACRES (LICENCE NO. 177 OF 2011 DATED 13.05.2011) + 1.00 ACRES (LICENCE NO. 178 OF 2011 DATED 13.05.2011) + 1.00 ACRES (LICENCE NO. 179 OF 2011 DATED 13.05.2011) + 1.00 ACRES (LICENCE NO. 180 OF 2011 DATED 13.05.2011) + 1.00 ACRES (LICENCE NO. 181 OF 2011 DATED 13.05.2011) + 1.00 ACRES (LICENCE NO. 182 OF 2011 DATED 13.05.2011) + 1.00 ACRES (LICENCE NO. 183 OF 2011 DATED 13.05.2011) + 1.00 ACRES (LICENCE NO. 184 OF 2011 DATED 13.05.2011) + 1.00 ACRES (LICENCE NO. 185 OF 2011 DATED 13.05.2011) + 1.00 ACRES (LICENCE NO. 186 OF 2011 DATED 13.05.2011) + 1.00 ACRES (LICENCE NO. 187 OF 2011 DATED 13.05.2011) + 1.00 ACRES (LICENCE NO. 188 OF 2011 DATED 13.05.2011) + 1.00 ACRES (LICENCE NO. 189 OF 2011 DATED 13.05.2011) + 1.00 ACRES (LICENCE NO. 190 OF 2011 DATED 13.05.2011) + 1.00 ACRES (LICENCE NO. 191 OF 2011 DATED 13.05.2011) + 1