

REVISED ZONING PLAN OF RESIDENTIAL PLOTTED COLONY LICENSED AREA MEASURING 113.837 ACERS (LICENSE NO. 88 OF 2010 DATED 28.10.2010, LICENSE NO. 21 OF 2012 DATED 20.03.2012, LICENSE NO. 109 OF 2012 DATED 26.10.2012 & LICENSE NO.81 OF 2018 DATED 01.12.2018) IN SECTOR 73, GURUGRAM MANSAAR URBAN COMPLEX BEING DEVELOPED BY DLF HOME DEVELOPERS LTD. & OTHERS

For purpose of Chapter 1.2 (ecol) & 6.1 (I) of the Haryana Building Code, 2017, amended from time to time.

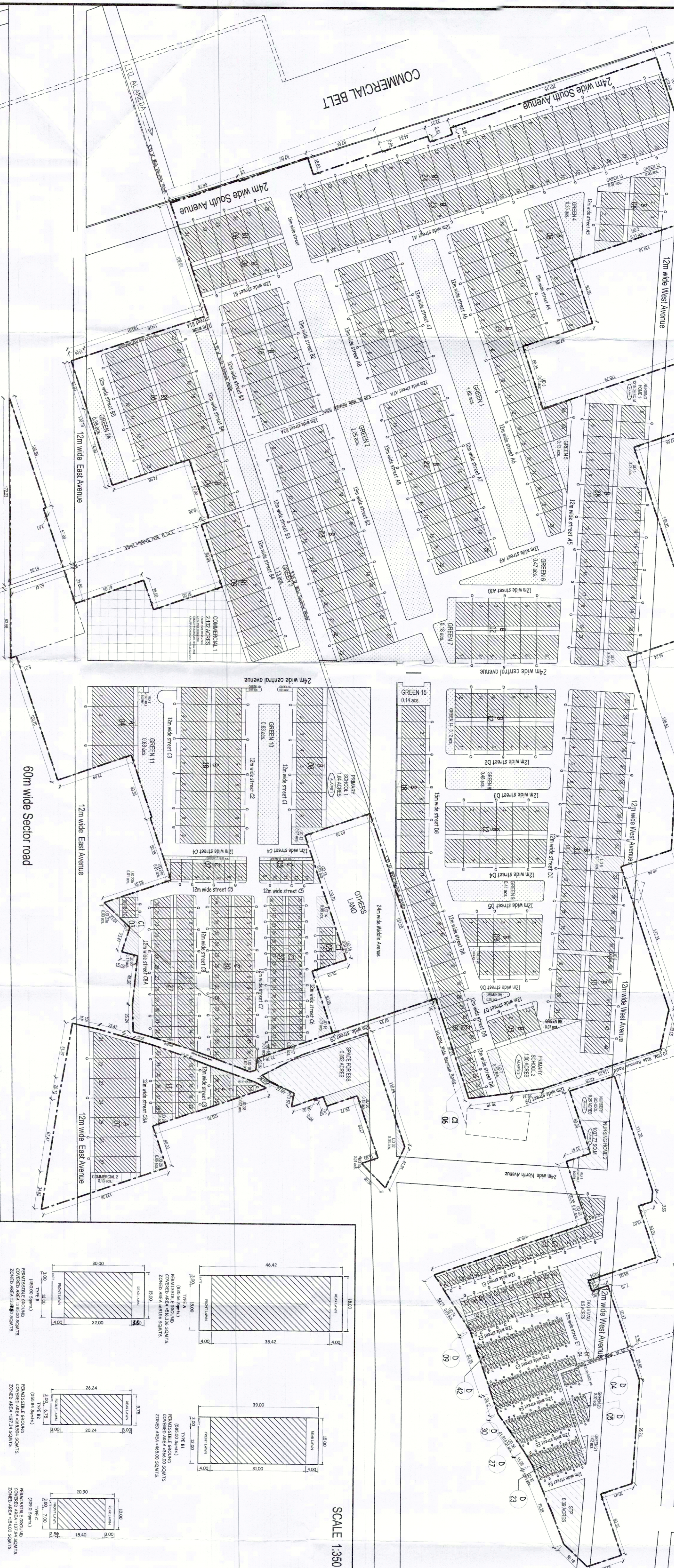

SECTOR 71

SECTOR 74

SCALE 1:350

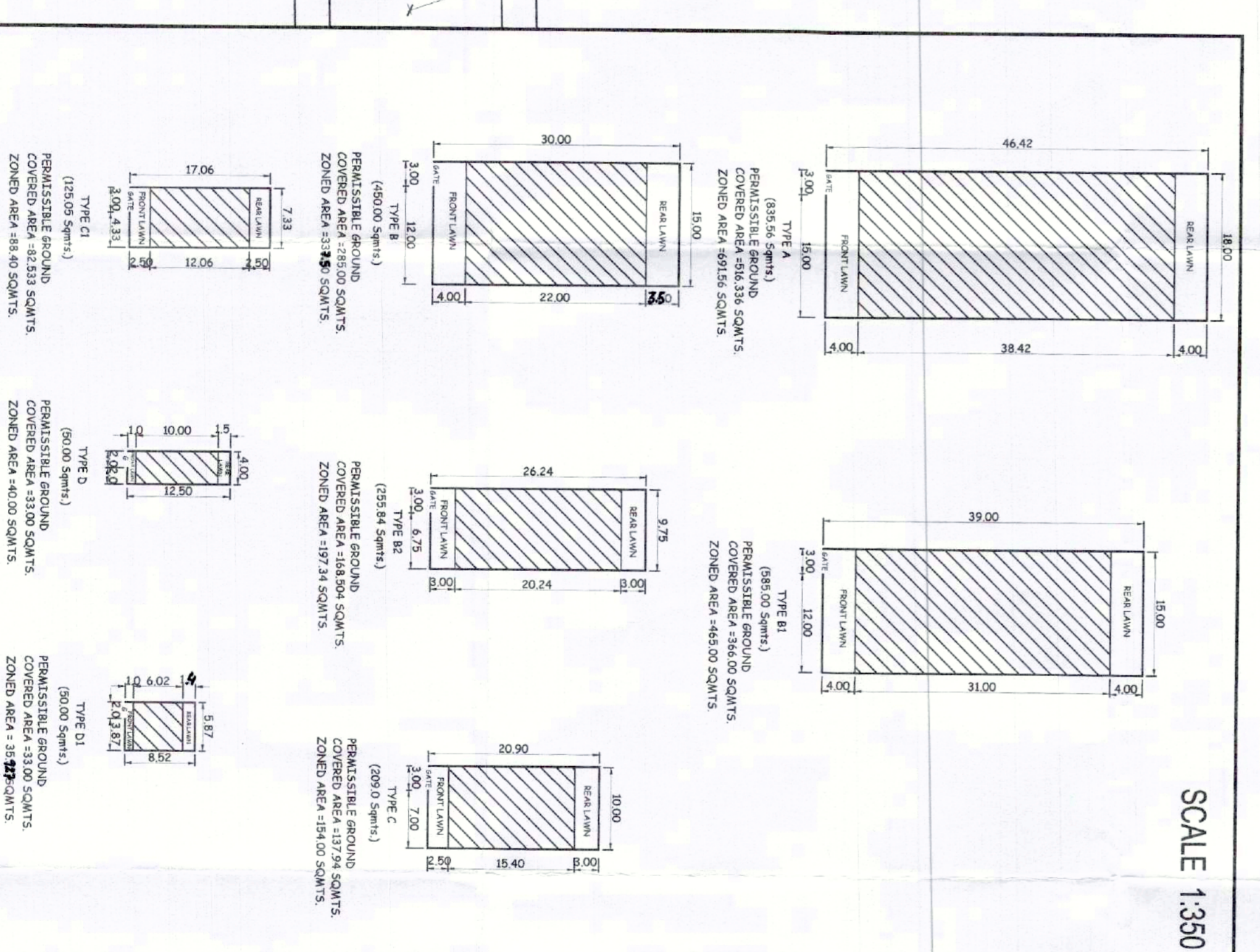

1. USE ZONE: - The zoning plan shall be applied in accordance with the mapping specified in the table below and other rules applicable to the use zone.
2. MAXIMUM PERMISSIBLE GROUND COVERAGE BASEMENT FLOOR AND MAXIMUM PERMISSIBLE HEIGHT/INCLUDING STILT PARKING:-

Plot Area	Minimum Permissible Ground Coverage		Maximum Permissible Height	
	Area (%)	Volume (m ³)	Height (m)	Number of Floors
Up to 1000 sq.m	20	1000	12	3
1000 to 2000 sq.m	25	2000	15	4
2000 to 3000 sq.m	30	3000	18	5
3000 to 4000 sq.m	35	4000	21	6
4000 to 5000 sq.m	40	5000	24	7
5000 to 6000 sq.m	45	6000	27	8
6000 to 7000 sq.m	50	7000	30	9
7000 to 8000 sq.m	55	8000	33	10
8000 to 9000 sq.m	60	9000	36	11
9000 to 10000 sq.m	65	10000	39	12
3. PERMISSIBLE NUMBER OF DWELLING UNIT ON EACH PLOT
 - (a) GENERAL, NPWL AND EMS PLOTS: Not more than three dwelling units shall be allowed on each plot. However, maximum dwelling units, in case of plot falling in EMS category not more than three dwelling units will be allowed and only one dwelling unit shall be allowed on each floor.
 - (b) SUB-DIVISION / COMBINATION OF PLOTS: No plot shall be sub-divided. However, two plots under one ownership may be combined to form a single plot and hence EMS/EMS plots, subject to the following conditions: coverage and no. of dwelling units shall be as per 2.3.3. Above, the maximum permissible coverage shall be calculated considering the combined plot as a single plot.
4. BUILDING SETBACK: Building other than boundary wall and gates shall be constructed only within the portion of the site marked as residential buildable zone in status number project beyond the portion marked as residential buildable zone.
5. HEIGHT OF THE BUILDING AND PERMISSIBLE NUMBER OF STOREY: The height and number of storey shall be allowed on the plot as given in table at 5.05.
6. STILT PARKING: Stilt parking is allowed in all plots. The clear height of the stilt shall be 2.40 metres for any purpose other than parking.
7. PARKING: Acquire parking spaces, covered open or in the basement, shall be as per Haryana Building Code, 2017 and comply with the table at per Code 7.2 of the Haryana Building Code, 2017 and other rules applicable to the plot as per the Haryana Building Code, 2017.
8. PLUMB LEVEL: The ground height of building shall not be less than 45 cm. above the road level as per Haryana Building Code, 2017.
9. BASEMENT: Basements shall be constructed within the building zone of plot and shall be provided as per Code 8.03 (B) (I) and (II) of the Haryana Building Code, 2017.
10. RESTRICTION OF ACCESS FROM 60 METRES WIDE OR MORE SECTOR ROADS AND PUBLIC OPEN SPACES: In the case of plots which share on the 60 metres or more wide sector roads and plots shall be provided with access to public open spaces.
11. BOUNDARY WALL: The boundary wall shall be constructed as per Code 7.2. The height of the boundary wall shall be 1.80 metres and the boundary wall shall be provided on all sides of the plot. The boundary wall shall be provided on all sides of the plot. The boundary wall shall be provided on all sides of the plot.
12. GATE AND GATE POST: The gate and gate post shall be constructed as per approved standard design, at the position indicated on the location plan. An additional set of gate post shall be provided if the plot is more than 1.80 metres in length. The gate and gate post shall be provided on all sides of the plot.
13. DISPLAY OF POSTAL NUMBER OF THE PLOT: The plot number and postal address shall be visible in the space shown for this purpose on the location plan.
14. GARBAGE COLLECTION POINT: The garbage collection point shall be provided as per approved standard design, at the position indicated on the location plan.
15. ACCESS: No plot or building shall have an access from less than 1.20 metres wide road.
16. NOTES: The drawing is submitted in accordance with the Haryana Building Code, 2017. The drawing is submitted in accordance with the Haryana Building Code, 2017. The drawing is submitted in accordance with the Haryana Building Code, 2017.

DRG. NO. 14-43 DATED 18-05-2020

(SANKU KUMAR) (DINESH KUMAR) (DIVYA DEDGA) (SANKU KUMAR) (DINESH KUMAR) (DIVYA DEDGA) (SANKU KUMAR) (DINESH KUMAR) (DIVYA DEDGA)
 (RANJIT) (J.P. HO) (SANKU KUMAR) (DINESH KUMAR) (DIVYA DEDGA) (SANKU KUMAR) (DINESH KUMAR) (DIVYA DEDGA) (SANKU KUMAR) (DINESH KUMAR) (DIVYA DEDGA)
 (D.M. AMBODKAR) (LITENDERSHAR) (K.M. PAUDRANG, IAS) (D.M. AMBODKAR) (LITENDERSHAR) (K.M. PAUDRANG, IAS)
 (SANKU KUMAR) (DINESH KUMAR) (DIVYA DEDGA) (SANKU KUMAR) (DINESH KUMAR) (DIVYA DEDGA) (SANKU KUMAR) (DINESH KUMAR) (DIVYA DEDGA)