

Checked and found ok for Public Health  
(Internal) for compliance to the  
Township and Suburban Areas  
Development Regulations, 2015  
3.9.12  
Superintendent  
NSMP, Punjab  
13/12

*W. Khan* (S.T.P.)  
Member Secretary  
B.P.C.  
3.9.12

*A. Singh* (G.C.P.H.)  
Chairman  
B.P.C.  
3.9.12

**DINESH KUMAR**  
S.D. (C.O.)

*PA*  
PA

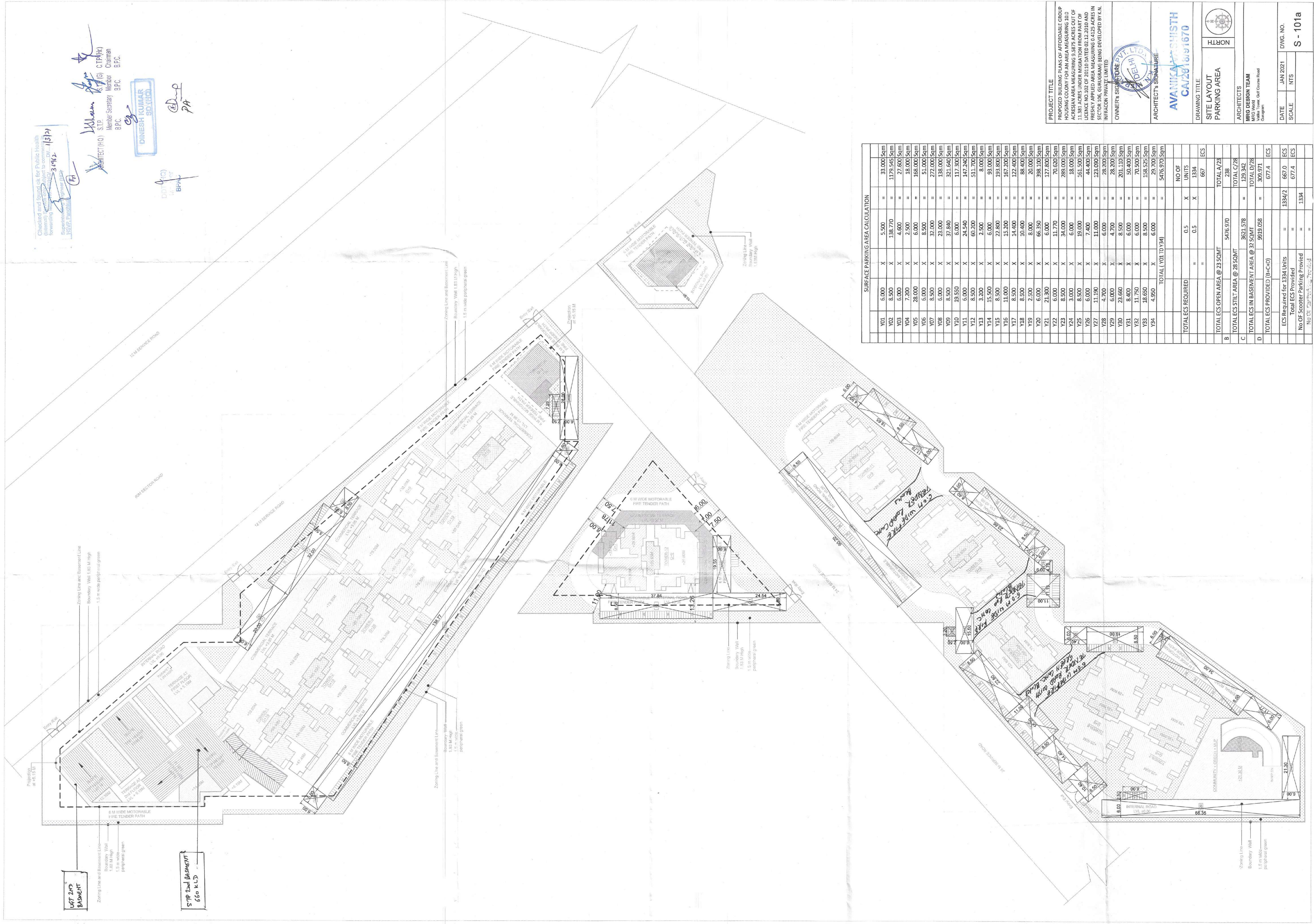

**SURFACE PARKING AREA CALCULATION**

Y01	6.000	X	5.500	=	33.000	Sqm			
Y02	8.500	X	138.770	=	1179.545	Sqm			
Y03	6.000	X	4.600	=	27.600	Sqm			
Y04	7.200	X	2.500	=	18.000	Sqm			
Y05	28.000	X	6.000	=	168.000	Sqm			
Y06	6.000	X	8.500	=	51.000	Sqm			
Y07	8.500	X	32.000	=	272.000	Sqm			
Y08	6.000	X	23.000	=	138.000	Sqm			
Y09	8.500	X	37.640	=	319.640	Sqm			
Y10	19.550	X	6.000	=	117.300	Sqm			
Y11	6.000	X	24.540	=	147.240	Sqm			
Y12	8.500	X	60.200	=	511.700	Sqm			
Y13	3.200	X	2.500	=	8.000	Sqm			
Y14	15.500	X	6.000	=	93.000	Sqm			
Y15	8.500	X	22.800	=	193.800	Sqm			
Y16	11.000	X	15.200	=	167.200	Sqm			
Y17	8.500	X	14.400	=	122.400	Sqm			
Y18	8.500	X	10.400	=	88.400	Sqm			
Y19	2.500	X	8.000	=	20.000	Sqm			
Y20	6.000	X	66.350	=	398.100	Sqm			
Y21	21.300	X	6.000	=	127.800	Sqm			
Y22	6.000	X	11.770	=	70.620	Sqm			
Y23	8.500	X	34.000	=	289.000	Sqm			
Y24	3.000	X	6.000	=	18.000	Sqm			
Y25	8.500	X	19.000	=	161.500	Sqm			
Y26	6.000	X	7.400	=	44.400	Sqm			
Y27	11.190	X	11.000	=	123.090	Sqm			
Y28	4.700	X	6.000	=	28.200	Sqm			
Y29	6.000	X	4.700	=	28.200	Sqm			
Y30	23.660	X	8.500	=	201.110	Sqm			
Y31	8.400	X	6.000	=	50.400	Sqm			
Y32	11.750	X	6.000	=	70.500	Sqm			
Y33	18.650	X	8.500	=	158.525	Sqm			
Y34	4.950	X	6.000	=	29.700	Sqm			
TOTAL (Y01 TO Y34)					=	5476.970	Sqm		
TOTAL ECS REQUIRED					=	0.5	X	1334	ECS
TOTAL ECS PROVIDED					=	0.5	X	667	ECS
TOTAL ECS OPEN AREA @ 23 SQMT					=	5476.970			
TOTAL ECS STILL AREA @ 28 SQMT					=	3621.578			
TOTAL ECS IN BASEMENT AREA @ 32 SQMT					=	9919.058			
TOTAL ECS PROVIDED (B+C+D)					=	1334/2			
ECS Required for 1334 Units					=	667.0			
Total ECS Provided					=	677.4			
No Of Scooter Parking Provided					=	1334			
No Of Scooter Parking Required					=	1334			

**PROJECT TITLE**  
PROPOSED BUILDING PLANS OF AFFORDABLE HOUSING COLONY FOR AN AREA MEASURING 10.0 ACRES IN AREA UNDER MIGRATION FROM PART OF LICENCE NO.102 OF 2010 DATED 02.12.2010 AND SECTORS 106, 107, 108, 109, 110, 111, 112, 113, 114, 115, 116, 117, 118, 119, 120, 121, 122, 123, 124, 125, 126, 127, 128, 129, 130, 131, 132, 133, 134, 135, 136, 137, 138, 139, 140, 141, 142, 143, 144, 145, 146, 147, 148, 149, 150, 151, 152, 153, 154, 155, 156, 157, 158, 159, 160, 161, 162, 163, 164, 165, 166, 167, 168, 169, 170, 171, 172, 173, 174, 175, 176, 177, 178, 179, 180, 181, 182, 183, 184, 185, 186, 187, 188, 189, 190, 191, 192, 193, 194, 195, 196, 197, 198, 199, 200, 201, 202, 203, 204, 205, 206, 207, 208, 209, 210, 211, 212, 213, 214, 215, 216, 217, 218, 219, 220, 221, 222, 223, 224, 225, 226, 227, 228, 229, 230, 231, 232, 233, 234, 235, 236, 237, 238, 239, 240, 241, 242, 243, 244, 245, 246, 247, 248, 249, 250, 251, 252, 253, 254, 255, 256, 257, 258, 259, 260, 261, 262, 263, 264, 265, 266, 267, 268, 269, 270, 271, 272, 273, 274, 275, 276, 277, 278, 279, 280, 281, 282, 283, 284, 285, 286, 287, 288, 289, 290, 291, 292, 293, 294, 295, 296, 297, 298, 299, 300, 301, 302, 303, 304, 305, 306, 307, 308, 309, 310, 311, 312, 313, 314, 315, 316, 317, 318, 319, 320, 321, 322, 323, 324, 325, 326, 327, 328, 329, 330, 331, 332, 333, 334, 335, 336, 337, 338, 339, 340, 341, 342, 343, 344, 345, 346, 347, 348, 349, 350, 351, 352, 353, 354, 355, 356, 357, 358, 359, 360, 361, 362, 363, 364, 365, 366, 367, 368, 369, 370, 371, 372, 373, 374, 375, 376, 377, 378, 379, 380, 381, 382, 383, 384, 385, 386, 387, 388, 389, 390, 391, 392, 393, 394, 395, 396, 397, 398, 399, 400, 401, 402, 403, 404, 405, 406, 407, 408, 409, 410, 411, 412, 413, 414, 415, 416, 417, 418, 419, 420, 421, 422, 423, 424, 425, 426, 427, 428, 429, 430, 431, 432, 433, 434, 435, 436, 437, 438, 439, 440, 441, 442, 443, 444, 445, 446, 447, 448, 449, 450, 451, 452, 453, 454, 455, 456, 457, 458, 459, 460, 461, 462, 463, 464, 465, 466, 467, 468, 469, 470, 471, 472, 473, 474, 475, 476, 477, 478, 479, 480, 481, 482, 483, 484, 485, 486, 487, 488, 489, 490, 491, 492, 493, 494, 495, 496, 497, 498, 499, 500, 501, 502, 503, 504, 505, 506, 507, 508, 509, 510, 511, 512, 513, 514, 515, 516, 517, 518, 519, 520, 521, 522, 523, 524, 525, 526, 527, 528, 529, 530, 531, 532, 533, 534, 535, 536, 537, 538, 539, 540, 541, 542, 543, 544, 545, 546, 547, 548, 549, 550, 551, 552, 553, 554, 555, 556, 557, 558, 559, 560, 561, 562, 563, 564, 565, 566, 567, 568, 569, 570, 571, 572, 573, 574, 575, 576, 577, 578, 579, 580, 581, 582, 583, 584, 585, 586, 587, 588, 589, 590, 591, 592, 593, 594, 595, 596, 597, 598, 599, 600, 601, 602, 603, 604, 605, 606, 607, 608, 609, 610, 611, 612, 613, 614, 615, 616, 617, 618, 619, 620, 621, 622, 623, 624, 625, 626, 627, 628, 629, 630, 631, 632, 633, 634, 635, 636, 637, 638, 639, 640, 641, 642, 643, 644, 645, 646, 647, 648, 649, 650, 651, 652, 653, 654, 655, 656, 657, 658, 659, 660, 661, 662, 663, 664, 665, 666, 667, 668, 669, 670, 671, 672, 673, 674, 675, 676, 677, 678, 679, 680, 681, 682, 683, 684, 685, 686, 687, 688, 689, 690, 691, 692, 693, 694, 695, 696, 697, 698, 699, 700, 701, 702, 703, 704, 705, 706, 707, 708, 709, 710, 711, 712, 713, 714, 715, 716, 717, 718, 719, 720, 721, 722, 723, 724, 725, 726, 727, 728, 729, 730, 731, 732, 733, 734, 735, 736, 737, 738, 739, 740, 741, 742, 743, 744, 745, 746, 747, 748, 749, 750, 751, 752, 753, 754, 755, 756, 757, 758, 759, 760, 761, 762, 763, 764, 765, 766, 767, 768, 769, 770, 771, 772, 773, 774, 775, 776, 777, 778, 779, 780, 781, 782, 783, 784, 785, 786, 787, 788, 789, 790, 791, 792, 793, 794, 795, 796, 797, 798, 799, 800, 801, 802, 803, 804, 805, 806, 807, 808, 809, 810, 811, 812, 813, 814, 815, 816, 817, 818, 819, 820, 821, 822, 823, 824, 825, 826, 827, 828, 829, 830, 831, 832, 833, 834, 835, 836, 837, 838, 839, 840, 841, 842, 843, 844, 845, 846, 847, 848, 849, 850, 851, 852, 853, 854, 855, 856, 857, 858, 859, 860, 861, 862, 863, 864, 865, 866, 867, 868, 869, 870, 871, 872, 873, 874, 875, 876, 877, 878, 879, 880, 881, 882, 883, 884, 885, 886, 887, 888, 889, 890, 891, 892, 893, 894, 895, 896, 897, 898, 899, 900, 901, 902, 903, 904, 905, 906, 907, 908, 909, 910, 911, 912, 913, 914, 915, 916, 917, 918, 919, 920, 921, 922, 923, 924, 925, 926, 927, 928, 929, 930, 931, 932, 933, 934, 935, 936, 937, 938, 939, 940, 941, 942, 943, 944, 945, 946, 947, 948, 949, 950, 951, 952, 953, 954, 955, 956, 957, 958, 959, 960, 961, 962, 963, 964, 965, 966, 967, 968, 969, 970, 971, 972, 973, 974, 975, 976, 977, 978, 979, 980, 981, 982, 983, 984, 985, 986, 987, 988, 989, 990, 991, 992, 993, 994, 995, 996, 997, 998, 999, 1000

**OWNER'S SIGNATURE (PVT. LTD.)**  
*(Signature)*

**ARCHITECT'S SIGNATURE**  
*(Signature)*

**AVANIKASHISHI PVT. LTD.**  
CA/28/16/1670

**DRAWING TITLE**  
SITE LAYOUT  
PARKING AREA

**ARCHITECTS**  
MRG World  
100, Ganga Road  
Gurgaon

**DATE**  
JAN 2021

**DWG. NO.**  
S - 101a