

OTPL
 ATPL
 F15
 20

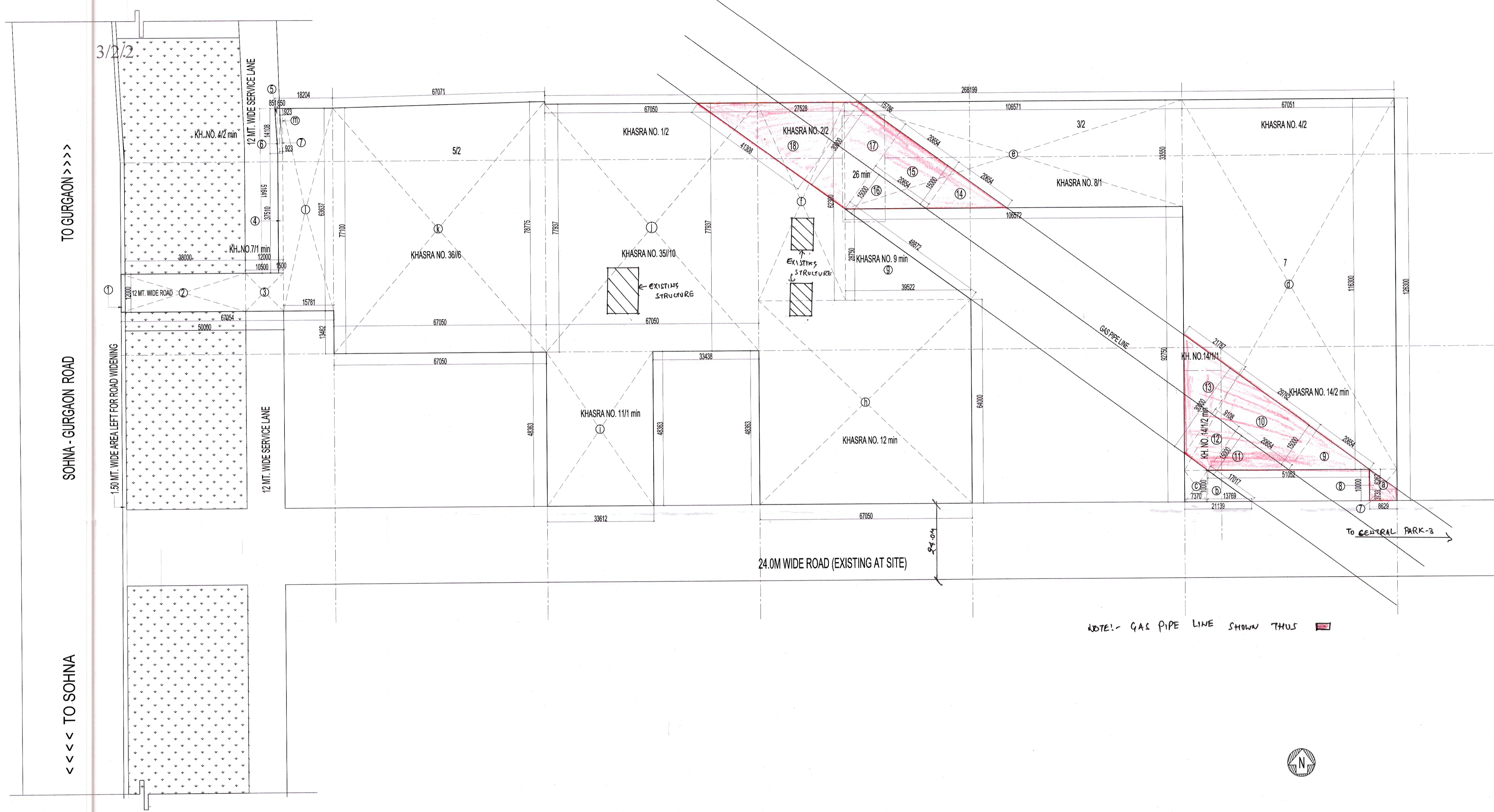

DEMARICATION PLAN OF AFFORDABLE GROUP PLOTTED COLONY (DDJAY 2016)
 ON AN LAND MEASURING 7.89375 ACRE AT VILLAGE DHUNELA, SECTOR-33, OF
 TEHSIL SOHNA DISTT. GURGAON. BELONGING TO MIS GLOBAL HORIZON HOLDINGS PVT. LTD.
 VIDE LOI MEMO NO. LC - 3972 - Asstt. (RK) /2019 / 4988 DATED 21-02-2019.
 SCALE 1:500

AREA DETAIL

- AREA BLOCK (a) = 8.629 x 10.0 = 86.29 SQMT
- AREA BLOCK (b) = 0.50 x 13.769 x 10.0 = 68.845 SQMT
- AREA BLOCK (c) = 7.37 x 10.0 = 73.70 SQMT
- AREA BLOCK (d) = 67.051 x 116.30 = 7798.031 SQMT
- AREA BLOCK (e) = 106.571 x 33.55 = 3575.457 SQMT
- AREA BLOCK (f) = 27.528 x 62.30 = 1714.994 SQMT
- AREA BLOCK (g) = 0.50 x 39.522 x 28.75 = 568.128 SQMT
- AREA BLOCK (h) = 67.05 x 64.0 = 4291.20 SQMT
- AREA BLOCK (i) = 33.612 x 48.363 = 1625.577 SQMT
- AREA BLOCK (j) = 67.05 x 77.937 = 5225.709 SQMT
- AREA BLOCK (k) = 1/2 x 78.775 + 77.10 x 67.05 = 5225.709 SQMT
- AREA BLOCK (l) = 15.781 x 63.637 = 1004.255 SQMT
- AREA BLOCK (m) = 0.50 x 0.923 x 14.108 = 6.51 SQMT

TOTAL AREA = 31264.405 SQMT OR 7.256 ACRE

- AREA UNDER 60.0M WIDE ROAD WIDENING ABUTING GURGAON-SOHNA ROAD =
- AREA BLOCK (1) = 1.50 x 12.0 = 18.0 SQMT or 0.0044 ACRE
- AREA UNDER 38.0M WIDE GREEN BELT PART OF 50.0M WIDE GREEN BELT ALONG WITH EXISTING GURGAON-SOHNA ROAD =
- AREA BLOCK (2) = 38.0 x 12.0 = 456.0 SQMT or 0.1126 ACRE
- AREA UNDER 12.0M WIDE SERVICE ROAD(PART OF 50.0M WIDE GREEN BELT) =
- AREA BLOCK (3) = 12.0 x 12.0 = 144.0 SQMT
- AREA BLOCK (4) = 1.50 x 37.51 = 56.265 SQMT
- AREA BLOCK (5) = 0.50x0.851 x 14.108 = 6.002 SQMT
- AREA BLOCK (6) = 0.65 x 14.108 = 9.17 SQMT
- AREA BLOCK (7) = 0.50x0.923 x 14.108 = 6.51 SQMT
- TOTAL COVD. AREA ON 12.0M WIDE SERVICE ROAD = 144.0 + 56.265 + 6.002 + 9.17 + 6.51 = 221.947 SQMT OR 0.0548 ACRE
- AREA UNDER 30.0M WIDE GAS PIPE LINE =
- AREA BLOCK (7) = 8.629 x 3.733 = 32.212 SQMT
- AREA BLOCK (8) = 0.50x8.629 x 6.267 = 27.038 SQMT
- AREA BLOCK (9) = 0.50x15.0 x 20.654 = 154.905 SQMT
- AREA BLOCK (10) = 15.0 x 29.762 = 446.43 SQMT
- AREA BLOCK (11) = 0.50x15.0 x 20.654 = 154.905 SQMT
- AREA BLOCK (12) = 15.0 x 9.108 = 136.62 SQMT
- AREA BLOCK (13) = 0.50x30.0 x 21.787 = 326.805 SQMT
- AREA BLOCK (14) = 0.50x15.0 x 20.654 = 154.905 SQMT
- AREA BLOCK (15) = 15.0 x 20.654 = 309.81 SQMT
- AREA BLOCK (16) = 0.50x15.0 x 20.654 = 154.905 SQMT
- AREA BLOCK (17) = 30.0 x 15.786 = 473.58 SQMT
- AREA BLOCK (18) = 0.50x30.0 x 41.308 = 619.62 SQMT
- TOTAL AREA = 2991.735 SQMT OR 0.7392 ACRE

NET PLANNED AREA = 31264.405 + 18.0 + 456.0 + 221.947 = 31960.352 - 2991.735 = 28968.617 SQMT OR 7.1583 ACRE (AFTER DEDUCTION OF GAS PIPE LINE)
 TOTAL AREA OF SITE = 31264.405 + 18.0 + 456.0 + 221.947 = 31960.352 SQMT OR 7.89375 ACRE
 NET PLANNED AREA (ATOM-7 TO 18) = 31264.405 - 2991.735 = 28272.67 SQMT OR 6.9863 ACRE

For Global Horizon Holdings Pvt. Ltd.
 Authorised Signatory

Sumanta Singh Roy
 Architect
 CA-2004/34084
 211, A.K.D. Tower, Sec.-14, GGN.

OWNER'S

ARCHITECT