

BAHADURGARH

REVISED LAYOUT CUM DEMARCATION PLAN OF AUTO MARKET SECTOR 12

DETAIL OF AREA

SNO	CATEGORY	SIZE	NOS.	AREA
1.	SCHEMATIC SHOPS	6.73 X 13.73 M	64	562.64 SQM
2.	(WITH/OUT BASEMENT)	5.73 X 13.73 M	32	232.80 SQM
3.	(WITH BASEMENT INCLUDING CORRIDOR)	5.00 X 13.73 M	32	212.80 SQM
4.	DOUBLE STOREY SHOPS (WITH/OUT BASEMENT)	5.73 X 13.73 M	2	152.20 SQM
5.	CHAWLS	5.73 X 13.73 M	2	152.20 SQM
6.	WITH/OUT CORRIDOR	5.00 X 13.73 M	1	76.10 SQM
7.	SHOPS STOREY (WITH/OUT BASEMENT)	5.00 X 13.73 M	2	152.20 SQM
8.	BOOTH	2.28 X 8.28 M	2	46.17 SQM
9.	WITH STOREY ON 1st FLOOR	2.28 X 8.28 M	15	340.33 SQM
10.	WITH STOREY ON 2nd FLOOR	2.28 X 8.28 M	15	340.33 SQM
11.	SHOPS PARTS SHOPS	5.73 X 25.00 M	79	286.80 SQM
12.	SHOPS PARTS SHOPS (WITH/OUT BASEMENT)	5.00 X 25.00 M	4	600.00 SQM
13.	SERVICE STATION	27.00 X 18.00 M	1	486.00 SQM
14.	PETROL PUMP	38.0 X 40.0 M	1	1520.00 SQM
15.	P. U.S.	5.00 X 42.00 M	3	158.40 SQM
TOTAL			283	15388.73 SQM

TOTAL AREA OF SITE = 55431.90 SQM (13.70 ACRES)
 SALEABLE AREA = 15388.73 SQM (136.128 SQM/US) = 15252.61 SQM OR (27.52%)

- NOTES:
- THIS DRAWING IS PREPARED ON THE BASIS OF DIMENSIONS SUPPLIED BY EXECUTIVE ENGINEER, HUDA DIVISION, BAHADURGARH. VIDE HIS MEMO NO. 23071 DATED 07.02.2017.
 - THE LOCATION, SIZE AND SHAPE OF THE SITES PROVIDED IN THIS PLAN SHALL BE AS PER THE LOCATION, SIZE AND SHAPE OF THE SITES PROVIDED IN THE PLAN.
 - CONSTRUCTION OF D.S.S. REPAIR / SPARE PARTS SHOPS, BOOTHS, CHAWLS & BUS PROVIDED IN THIS PLAN SHALL BE AS PER STANDARD ARCHITECTURAL CONTROL. FINALIZED BY CHIEF ARCHITECT, HUDA.
 - SIZE OF CORNER D.S.S. IS 0.23M EXTRA AND SIZE OF CORNER SINGLE STOREY SITES IS 0.23M EXTRA.
 - PROVISION OF BASEMENT SHALL BE GIVEN AS PER POLICY CIRCULATED BY CA, HUDA.
 - (ARCH. WING) VIDE MEMO NO. SA/UD/08/173-205 DATED 06-02-2008.
 - WIDTH OF CORRIDORS SHALL BE AS PER ARCHITECTURAL CONTROL'S APPLICABLE.
 - ALL DIMENSIONS ARE IN METERS.



DRG. NO. DTP/JH) 560/17 DT. 08.02.2017

DRAWN BY: (KOLDEEP A.S.)
 PLANNING ASSTT. (SOMWIR SINGH)
 ASSTT. TOWN PLANNER (SHAKUNTALA SHANI)
 DISTT. TOWN PLANNER (ASHOK GANG)
 CHECKED BY: (KOLDEEP A.S.)
 SENIOR TOWN PLANNER (ROHTAK, CIRCLE, ROHTAK)

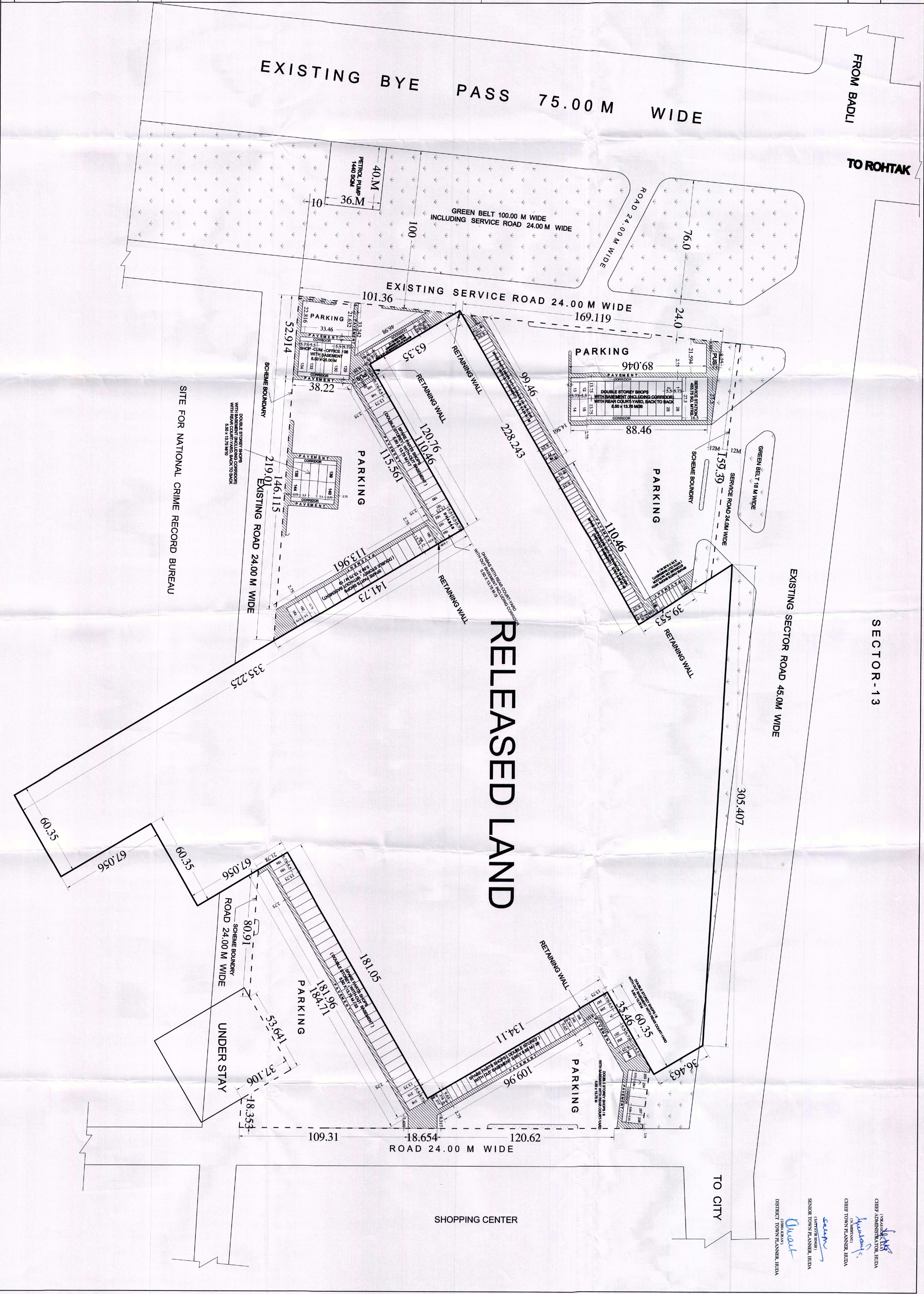

SECTOR-13

CHIEF ADMINISTRATOR, HUDA
 CHIEF TOWN PLANNER, HUDA
 SENIOR TOWN PLANNER, HUDA
 DISTRICT TOWN PLANNER, HUDA