

SYMBOL	DESCRIPTION
	EXTERNAL SEWER LINE 1 AS / EARLIER
	EXTERNAL SEWER LINE FOR ADDITIONAL AREA 1E23 ACRES

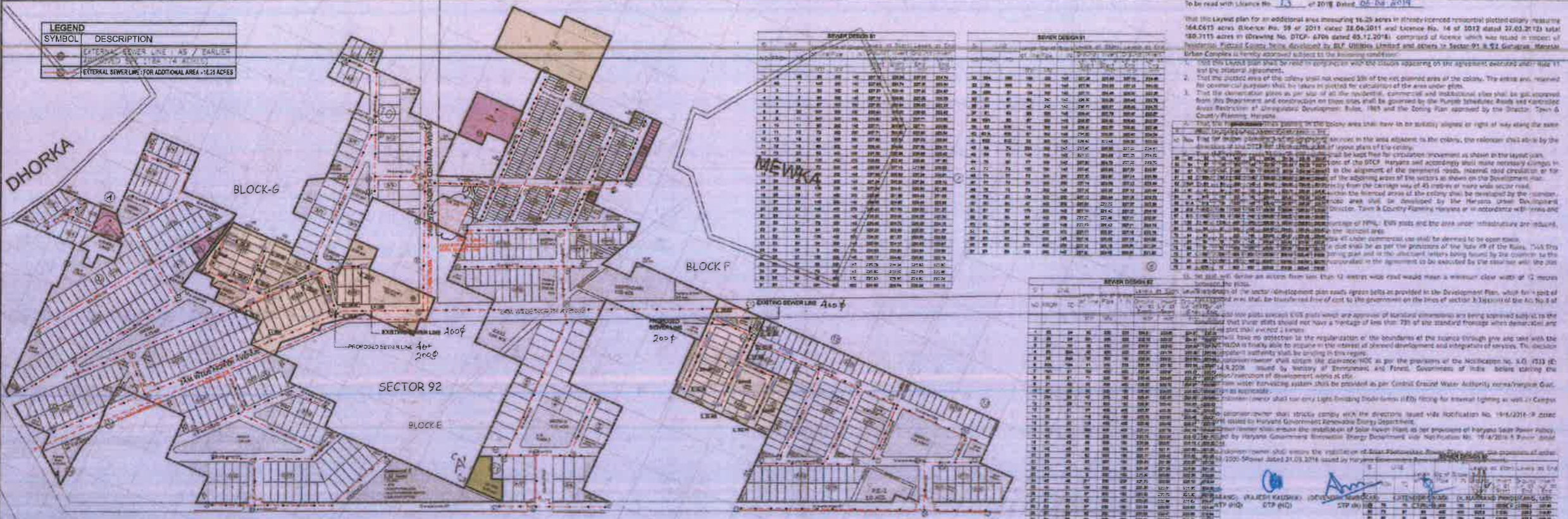

STATEMENT FOR SEWERAGE LINE FOR ADDITIONAL AREA (16.25 ACRES)

LINE NO.	LINE TYPE	LENGTH (M)	DEPTH (M)	START STATION	END STATION	AREA (SQ. M)	PERMITS
1	AS	100	1.00	200+00	200+100	10000	1
2	AS	150	1.00	200+100	200+250	15000	1
3	AS	200	1.00	200+250	200+450	20000	1
4	AS	250	1.00	200+450	200+700	25000	1
5	AS	300	1.00	200+700	200+1000	30000	1
6	AS	350	1.00	200+1000	200+1350	35000	1
7	AS	400	1.00	200+1350	200+1750	40000	1
8	AS	450	1.00	200+1750	200+2200	45000	1
9	AS	500	1.00	200+2200	200+2700	50000	1
10	AS	550	1.00	200+2700	200+3250	55000	1
11	AS	600	1.00	200+3250	200+3850	60000	1
12	AS	650	1.00	200+3850	200+4500	65000	1
13	AS	700	1.00	200+4500	200+5200	70000	1
14	AS	750	1.00	200+5200	200+5950	75000	1
15	AS	800	1.00	200+5950	200+6750	80000	1
16	AS	850	1.00	200+6750	200+7600	85000	1
17	AS	900	1.00	200+7600	200+8500	90000	1
18	AS	950	1.00	200+8500	200+9450	95000	1
19	AS	1000	1.00	200+9450	200+10450	100000	1
20	AS	1050	1.00	200+10450	200+11500	105000	1
21	AS	1100	1.00	200+11500	200+12600	110000	1
22	AS	1150	1.00	200+12600	200+13750	115000	1
23	AS	1200	1.00	200+13750	200+15000	120000	1
24	AS	1250	1.00	200+15000	200+16350	125000	1
25	AS	1300	1.00	200+16350	200+17800	130000	1
26	AS	1350	1.00	200+17800	200+19350	135000	1
27	AS	1400	1.00	200+19350	200+21000	140000	1
28	AS	1450	1.00	200+21000	200+22750	145000	1
29	AS	1500	1.00	200+22750	200+24600	150000	1
30	AS	1550	1.00	200+24600	200+26550	155000	1
31	AS	1600	1.00	200+26550	200+28600	160000	1
32	AS	1650	1.00	200+28600	200+30750	165000	1
33	AS	1700	1.00	200+30750	200+33000	170000	1
34	AS	1750	1.00	200+33000	200+35350	175000	1
35	AS	1800	1.00	200+35350	200+37800	180000	1
36	AS	1850	1.00	200+37800	200+40350	185000	1
37	AS	1900	1.00	200+40350	200+43000	190000	1
38	AS	1950	1.00	200+43000	200+45750	195000	1
39	AS	2000	1.00	200+45750	200+48600	200000	1
40	AS	2050	1.00	200+48600	200+51550	205000	1
41	AS	2100	1.00	200+51550	200+54600	210000	1
42	AS	2150	1.00	200+54600	200+57750	215000	1
43	AS	2200	1.00	200+57750	200+61000	220000	1
44	AS	2250	1.00	200+61000	200+64350	225000	1
45	AS	2300	1.00	200+64350	200+67800	230000	1
46	AS	2350	1.00	200+67800	200+71350	235000	1
47	AS	2400	1.00	200+71350	200+75000	240000	1
48	AS	2450	1.00	200+75000	200+78750	245000	1
49	AS	2500	1.00	200+78750	200+82600	250000	1
50	AS	2550	1.00	200+82600	200+86550	255000	1
51	AS	2600	1.00	200+86550	200+90600	260000	1
52	AS	2650	1.00	200+90600	200+94750	265000	1
53	AS	2700	1.00	200+94750	200+99000	270000	1
54	AS	2750	1.00	200+99000	200+103350	275000	1
55	AS	2800	1.00	200+103350	200+107800	280000	1
56	AS	2850	1.00	200+107800	200+112350	285000	1
57	AS	2900	1.00	200+112350	200+117000	290000	1
58	AS	2950	1.00	200+117000	200+121750	295000	1
59	AS	3000	1.00	200+121750	200+126600	300000	1
60	AS	3050	1.00	200+126600	200+131550	305000	1
61	AS	3100	1.00	200+131550	200+136600	310000	1
62	AS	3150	1.00	200+136600	200+141750	315000	1
63	AS	3200	1.00	200+141750	200+147000	320000	1
64	AS	3250	1.00	200+147000	200+152350	325000	1
65	AS	3300	1.00	200+152350	200+157800	330000	1
66	AS	3350	1.00	200+157800	200+163350	335000	1
67	AS	3400	1.00	200+163350	200+169000	340000	1
68	AS	3450	1.00	200+169000	200+174750	345000	1
69	AS	3500	1.00	200+174750	200+180600	350000	1
70	AS	3550	1.00	200+180600	200+186550	355000	1
71	AS	3600	1.00	200+186550	200+192600	360000	1
72	AS	3650	1.00	200+192600	200+198750	365000	1
73	AS	3700	1.00	200+198750	200+205000	370000	1
74	AS	3750	1.00	200+205000	200+211350	375000	1
75	AS	3800	1.00	200+211350	200+217800	380000	1
76	AS	3850	1.00	200+217800	200+224350	385000	1
77	AS	3900	1.00	200+224350	200+231000	390000	1
78	AS	3950	1.00	200+231000	200+237750	395000	1
79	AS	4000	1.00	200+237750	200+244600	400000	1
80	AS	4050	1.00	200+244600	200+251550	405000	1
81	AS	4100	1.00	200+251550	200+258600	410000	1
82	AS	4150	1.00	200+258600	200+265750	415000	1
83	AS	4200	1.00	200+265750	200+273000	420000	1
84	AS	4250	1.00	200+273000	200+280350	425000	1
85	AS	4300	1.00	200+280350	200+287800	430000	1
86	AS	4350	1.00	200+287800	200+295350	435000	1
87	AS	4400	1.00	200+295350	200+303000	440000	1
88	AS	4450	1.00	200+303000	200+310750	445000	1
89	AS	4500	1.00	200+310750	200+318600	450000	1
90	AS	4550	1.00	200+318600	200+326550	455000	1
91	AS	4600	1.00	200+326550	200+334600	460000	1
92	AS	4650	1.00	200+334600	200+342750	465000	1
93	AS	4700	1.00	200+342750	200+351000	470000	1
94	AS	4750	1.00	200+351000	200+359350	475000	1
95	AS	4800	1.00	200+359350	200+367800	480000	1
96	AS	4850	1.00	200+367800	200+376350	485000	1
97	AS	4900	1.00	200+376350	200+385000	490000	1
98	AS	4950	1.00	200+385000	200+393750	495000	1
99	AS	5000	1.00	200+393750	200+402600	500000	1
100	AS	5050	1.00	200+402600	200+411550	505000	1
101	AS	5100	1.00	200+411550	200+420600	510000	1
102	AS	5150	1.00	200+420600	200+429750	515000	1
103	AS	5200	1.00	200+429750	200+439000	520000	1
104	AS	5250	1.00	200+439000	200+448350	525000	1
105	AS	5300	1.00	200+448350	200+457800	530000	1
106	AS	5350	1.00	200+457800	200+467350	535000	1
107	AS	5400	1.00	200+467350	200+477000	540000	1
108	AS	5450	1.00	200+477000	200+486750	545000	1
109	AS	5500	1.00	200+486750	200+496600	550000	1
110	AS	5550	1.00	200+496600	200+506550	555000	1
111	AS	5600	1.00	200+506550	200+516600	560000	1
112	AS	5650	1.00	200+516600	200+526750	565000	1
113	AS	5700	1.00	200+526750	200+537000	570000	1
114	AS	5750	1.00	200+537000	200+547350	575000	1
115	AS	5800	1.00	200+547350	200+557800	580000	1
116	AS	5850	1.00	200+557800	200+568350	585000	1
117	AS	5900	1.00	200+568350	200+579000	590000	1
118	AS	5950	1.00	200+579000	200+589750	595000	1
119	AS	6000	1.00	200+589750	200+600600	600000	1
120	AS	6050	1.00	200+600600	200+611550	605000	1
121	AS	6100	1.00	200+611550	200+622600	610000	1
122	AS	6150	1.00	200+622600	200+633750	615000	1
123	AS	6200	1.00	200+633750	200+645000	620000	1
124	AS	6250	1.00	200+645000	200+656350	625000	1
125	AS	6300	1.00	200+656350	200+667800	630000	1
126	AS	6350	1.00	200+667800	200+679350	635000	1
127	AS	6400	1.00	200+679350	200+691000	640000	1
128	AS	6450	1.00	200+691000	200+702750	645000	1
129	AS	6500	1.00	200+702750	200+714600	650000	1
130	AS	6550	1.00	200+714600	200+726550	655000	1
131	AS	6600	1.00	200+726550	200+738600	660000	1
132	AS	6650	1.00	200+738600	200+750750	665000	1
133	AS	6700	1.00	200+750750	200+763000	670000	1
134	AS	6750	1.00	200+763000	200+775350	675000	1
135	AS	6800	1.00	200+775350	200+787800	680000	1
136	AS	6850	1.00	200+787800	200+800350	685000	1
137	AS	6900	1.00	200+800350	200+813000	690000	1
138	AS	6950	1.00	200+813000	200+825750	695000	1
139	AS	7000	1.00	200+825750	200+838600	700000	1
140	AS	7050	1.00	200+838600	200+851550	705000	1
141	AS	7100	1.00	200+851550	200+864600	710000	1
142	AS	7150	1.00	200+864600	200+877750	715000	1
143	AS	7200	1.00	200+877750	200+891000	720000	1
144	AS	7250	1.00	200+891000	200+904350	725000	1
145	AS	7300	1.00	200+904350	200+917800	730000	1
146	AS	7350	1.00	200+917800	200+931350	735000	

LEGEND

12 MTR ROAD	AS PER APPROVED SPE OF 184.774 ACRES
18 MTR ROAD	
24 MTR ROAD	
12 MTR ROAD	FOR 16.25 ACRES ADDITIONAL AREA

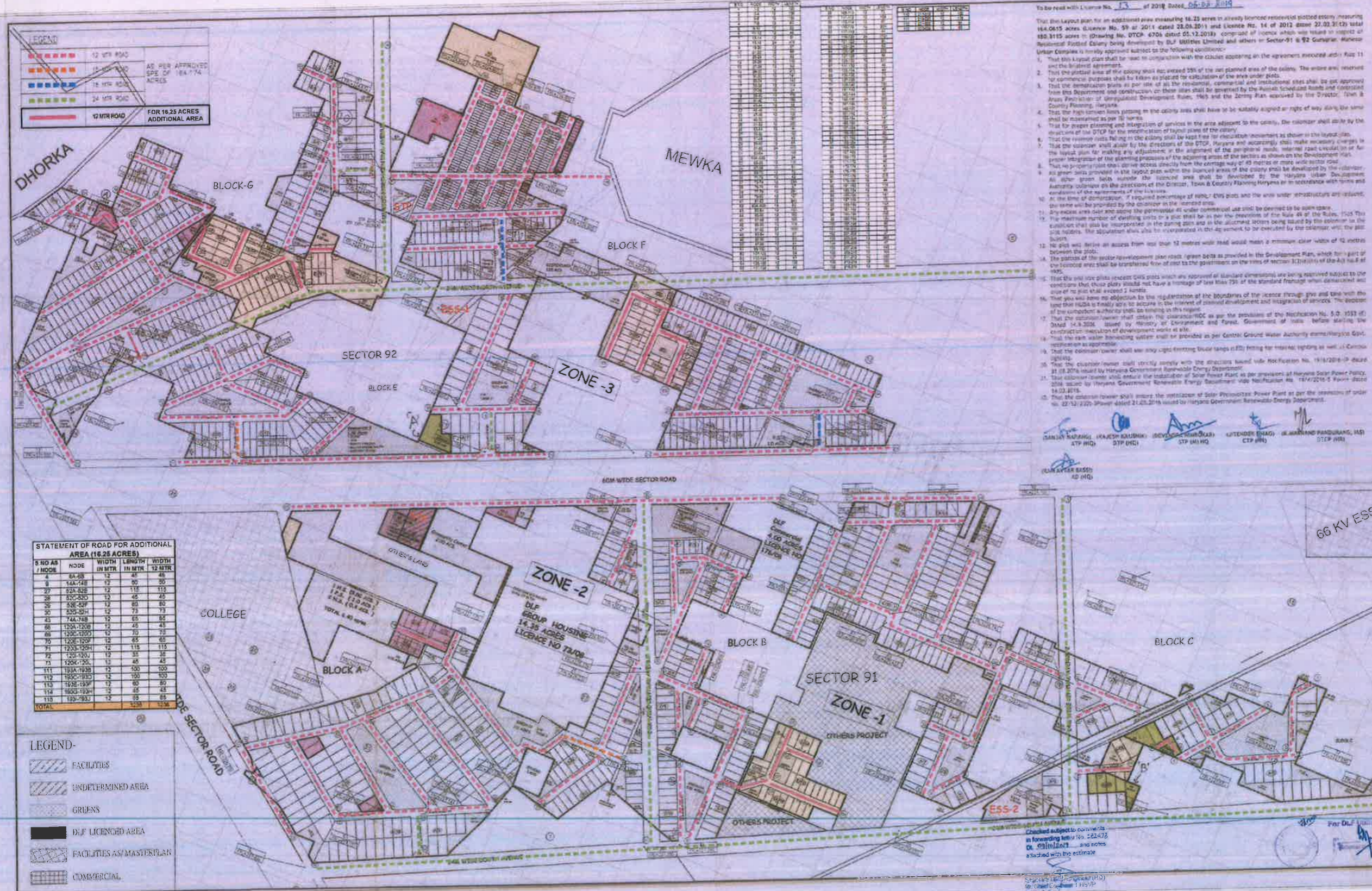

- To be read with Licence No. 173 of 2018 Dated 06.08.2018
- This layout plan for an additional area measuring 16.25 acres in already licensed residential plotted colony measuring 184.0615 acres (Drawing No. 59 of 2014 dated 23.04.2014 and Licence No. 14 of 2012 dated 22.03.2012) total 180.3115 acres in (Drawing No. DTPC 6706 dated 05.12.2018) comprised of licence which was issued in respect of Residential Plotted Colony being developed by DLF Estates Limited and others in Sector-91 & 92 Gurugram, Haryana Urban Complex is hereby approved subject to the following conditions:
1. That this layout plan shall be read in conjunction with the conditions appearing in the agreement enclosed and Rule 11 and the bye-laws.
 2. That the plotted area of the colony shall be divided into the areas planned in the plan. The areas reserved for commercial purposes shall be taken as planned for calculation of the area under plots.
 3. That the demarcation plans as per site of all the residential, commercial and institutional areas shall be got approved from this Department and construction on these sites shall be governed by the Master Development Plans and Control Areas Plan (Sector of Unplanned Development, Rules, 1969 and the Zoning Plan approved by the Director, Town & Country Planning, Haryana.
 4. That the high tension lines passing in the colony area shall have to be suitably aligned or right of way along the same shall be maintained as per the norms.
 5. That for proper planning and integration of services in the area adjacent to the colony, the collector shall take by the directions of the DTPC for the reconnection of public services of the colony.
 6. That the collector shall take by the directions of the DTPC, Haryana and accordingly shall make necessary changes in the layout plan for making any adjustment in the alignment of the public roads, sewerage road, electrical line or for proper integration of the planning proposals of the adjoining areas as shown in the Development Plan.
 7. That no property shall have direct access from the colony area to any main road or water supply road.
 8. All green belts provided in the layout plan within the licensed area of the colony shall be developed by the collector. Any other green belts, outside the licensed area shall be developed by the collector in accordance with the norms and conditions of the provisions of the District, Town & Country Planning Haryana or in accordance with norms and conditions of the provisions of the laws.
 9. At the time of demarcation, if required percentage of 100% EWS plots and the whole water infrastructure are provided, the same will be provided by the collector in the licensed area.
 10. Any vacant area (land and above the possession) under commercial use shall be deemed to be such open.
 11. The maximum number of dwelling units in a plot shall be as per the provisions of the Rule 46 of the Rules, 1969. The calculation of this shall be incorporated in the zoning plan and as the allocated sectors being issued by the collector in the condition of the application shall also be incorporated in the zoning plan to be developed by the collector with the plot layout.
 12. No plot will have an access from road less than 12 metres wide road with a minimum clear width of 12 metres between the plots.
 13. The pattern of the road development plan roads (green belts) as provided in the Development Plan, which form a part of the licensed area shall be transferred free of cost to the government on the terms of section 317(1)(b) of the Act read with the rules.
 14. The collector shall ensure that the plot area shall not have a coverage of less than 75% of the standard coverage when demarcated and size of no plot shall exceed 2 Hectare.
 15. The collector shall ensure that the plot area shall be in the possession of the licensee through the collector and the collector shall ensure that the plot area shall be in the possession of the licensee through the collector. The collector shall ensure that the plot area shall be in the possession of the licensee through the collector. The collector shall ensure that the plot area shall be in the possession of the licensee through the collector.
 16. The collector shall ensure that the plot area shall be in the possession of the licensee through the collector. The collector shall ensure that the plot area shall be in the possession of the licensee through the collector. The collector shall ensure that the plot area shall be in the possession of the licensee through the collector.
 17. The collector shall ensure that the plot area shall be in the possession of the licensee through the collector. The collector shall ensure that the plot area shall be in the possession of the licensee through the collector. The collector shall ensure that the plot area shall be in the possession of the licensee through the collector.
 18. The collector shall ensure that the plot area shall be in the possession of the licensee through the collector. The collector shall ensure that the plot area shall be in the possession of the licensee through the collector. The collector shall ensure that the plot area shall be in the possession of the licensee through the collector.
 19. The collector shall ensure that the plot area shall be in the possession of the licensee through the collector. The collector shall ensure that the plot area shall be in the possession of the licensee through the collector. The collector shall ensure that the plot area shall be in the possession of the licensee through the collector.
 20. The collector shall ensure that the plot area shall be in the possession of the licensee through the collector. The collector shall ensure that the plot area shall be in the possession of the licensee through the collector. The collector shall ensure that the plot area shall be in the possession of the licensee through the collector.
 21. The collector shall ensure that the plot area shall be in the possession of the licensee through the collector. The collector shall ensure that the plot area shall be in the possession of the licensee through the collector. The collector shall ensure that the plot area shall be in the possession of the licensee through the collector.
 22. The collector shall ensure that the plot area shall be in the possession of the licensee through the collector. The collector shall ensure that the plot area shall be in the possession of the licensee through the collector. The collector shall ensure that the plot area shall be in the possession of the licensee through the collector.

(SARVJIT KAPUR) I (KALASH KALSHIKI) (DEVANAND KUMAR) (LITENDR (HAG)) (KAMALAKANTH PANDURANG, IAS) (DTP DECI) (STP (HAG)) (CTP (HAG)) (DTP (HAG))



DLF GARDEN CITY

DETAILS OF PLOTS

TYPE	AREA	NO. OF PLOTS	TOTAL AREA	% AREA
A	1800	1000	180000	100.00
B	1800	1000	180000	100.00
C	1800	1000	180000	100.00
D	1800	1000	180000	100.00
E	1800	1000	180000	100.00
F	1800	1000	180000	100.00
G	1800	1000	180000	100.00
H	1800	1000	180000	100.00
I	1800	1000	180000	100.00
J	1800	1000	180000	100.00
K	1800	1000	180000	100.00
L	1800	1000	180000	100.00
M	1800	1000	180000	100.00
N	1800	1000	180000	100.00
O	1800	1000	180000	100.00
P	1800	1000	180000	100.00
Q	1800	1000	180000	100.00
R	1800	1000	180000	100.00
S	1800	1000	180000	100.00
T	1800	1000	180000	100.00
U	1800	1000	180000	100.00
V	1800	1000	180000	100.00
W	1800	1000	180000	100.00
X	1800	1000	180000	100.00
Y	1800	1000	180000	100.00
Z	1800	1000	180000	100.00
TOTAL PLOTS		1000	180000	100.00
MAINTENANCE PLOTS		1000	180000	100.00
GRAND TOTAL		2000	360000	100.00

DETAIL OF AREA

TYPE OF AREA	AREA (SQ. MTR)	% AREA
TOTAL LICENSED AREA	184061.5	100.00
RESERVED AREA FOR PUBLIC INFRASTRUCTURE	184061.5	100.00
TOTAL 80-80 AREA	184061.5	100.00
AREA UNDER NON SECTOR ROAD	184061.5	100.00
UNDEVELOPED AREA / TO BE PLANNED LATER	184061.5	100.00
PLANNED AREA	184061.5	100.00
800 SQ. MTR AREA UNDER SECTOR ROAD	80000	43.47
NET PLANNED AREA	104061.5	56.53
AREA UNDER CHANGING	104061.5	56.53
AREA UNDER REQUIREMENTS PLOTS	104061.5	56.53
TOTAL 80-80 AREA	184061.5	100.00
AREA UNDER CHANGING GREENS	104061.5	56.53
AREA UNDER REQUIREMENTS GREENS	104061.5	56.53
UNDEVELOPED GREENS / PENSION	104061.5	56.53
TOTAL GREENS	104061.5	56.53

PROVISION OF INFRASTRUCTURE

S. NO.	REQUISITION	REQUIRED	PROVIDED
1	MANAGER SCHOOL	1	1
2	TEACHER SCHOOL	1	1
3	CHILD SCHOOL	1	1
4	COMMUNITY CENTRE	1	1
5	CLUB HOUSE	1	1
6	RECREATIONAL	1	1
7	RECREATIONAL BUILDING	1	1
8	CLUB	1	1
9	RECREATIONAL BOOTH	1	1
10	CLUB	1	1
11	RECREATIONAL BOOTH	1	1
12	CLUB & RECREATIONAL BOOTH	1	1
13	CLUB & RECREATIONAL BOOTH	1	1
14	CLUB & RECREATIONAL BOOTH	1	1
15	CLUB & RECREATIONAL BOOTH	1	1
16	CLUB & RECREATIONAL BOOTH	1	1
17	CLUB & RECREATIONAL BOOTH	1	1
18	CLUB & RECREATIONAL BOOTH	1	1
19	CLUB & RECREATIONAL BOOTH	1	1
20	CLUB & RECREATIONAL BOOTH	1	1



KEY PLAN
 REVISED LAYOUT PLAN FOR RESIDENTIAL PLOTTED COLONY AREA MEASURING 180.3115 ACRES IN SECTOR-91 & 92 VILLAGE MEWKA, DHORKA, BHANGROLA & HAYATPUR, GURUGRAM

SCALE: 1:2400 @A1
 NORTH
 DATE: 05/10/2018
 FOR DLF

