

| COMMERCIAL AREA CALCULATION |            |        |        |    |       |          |
|-----------------------------|------------|--------|--------|----|-------|----------|
| (AREAS IN sq mtrs.)         |            |        |        |    |       |          |
| ITEM                        | L          | B      | FACTOR | NO | =     | SQ.MT    |
| C1                          | 20.536     | 6.128  | 0.5    | 1  | =     | 62.902   |
| C2                          | 14.581     | 11.189 | 0.5    | 1  | =     | 81.573   |
| C3                          | 14.581     | 15.348 | 1.0    | 1  | =     | 223.789  |
| C4                          | 20.536     | 26.536 | 1.0    | 1  | =     | 544.984  |
| C5                          | as/autocad |        |        |    | =     | 211.115  |
| C6                          | 21.364     | 7.368  | 1.0    | 1  | =     | 157.367  |
|                             |            |        |        |    | SQ MT | 1281.730 |
|                             |            |        |        |    | ACRES | 0.3167   |

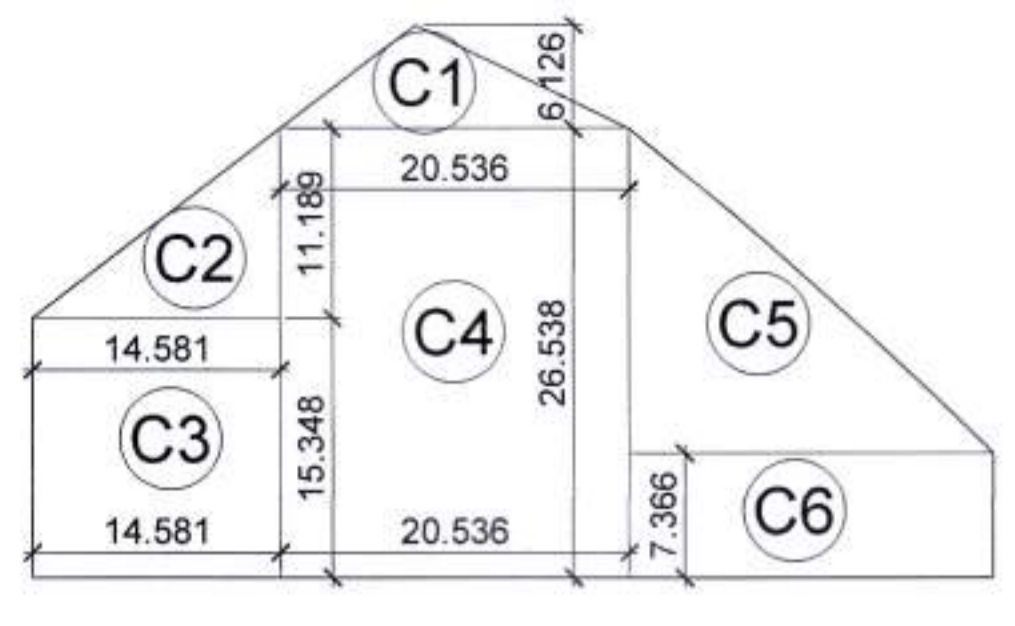

**COMMERCIAL- 0.3167 ACRES**

| SITE 01<br>63K-13M              | PERMISSIBLE   |                                 | PROPOSED      |                      |
|---------------------------------|---------------|---------------------------------|---------------|----------------------|
|                                 | AREA<br>acres | PERCENTAGE<br>sq. mt            | AREA<br>acres | PERCENTAGE<br>sq. mt |
| 7.95 ACRES                      | 7.95625       | 32197.53                        | 7.95625       | 32197.53             |
| TOTAL Plot area                 | 7.95625       | 32197.53                        | 7.95625       | 32197.53             |
| Net Planned Area                | 7.95625       | 32197.53                        | 7.95625       | 32197.53             |
| Open Area under GREEN/PARK      | 0.597         | 2414.8                          | 7.50          | 2472.95              |
| Community Facilities            | 0.796         | 3219.74                         | 10.00         | 0.8035               |
| Commercial Area                 | 0.318         | 1287.89                         | 4.00          | 0.3167               |
| Area Under Plots                | 4.853         | 19640.4                         | 61.00         | 4.4502               |
| Total permissible saleable area | 5.172         | 20928.3                         | 65.00         | 4.7670               |
| Density                         | 240-400 ppa   | (14.581 x 26.536) = 1.957-5 PPA | 246.033       | ppa                  |

This is a "PROVISIONAL APPROVED LAYOUT PLAN"  
Only for Purpose of Inviting  
Objection from the general public

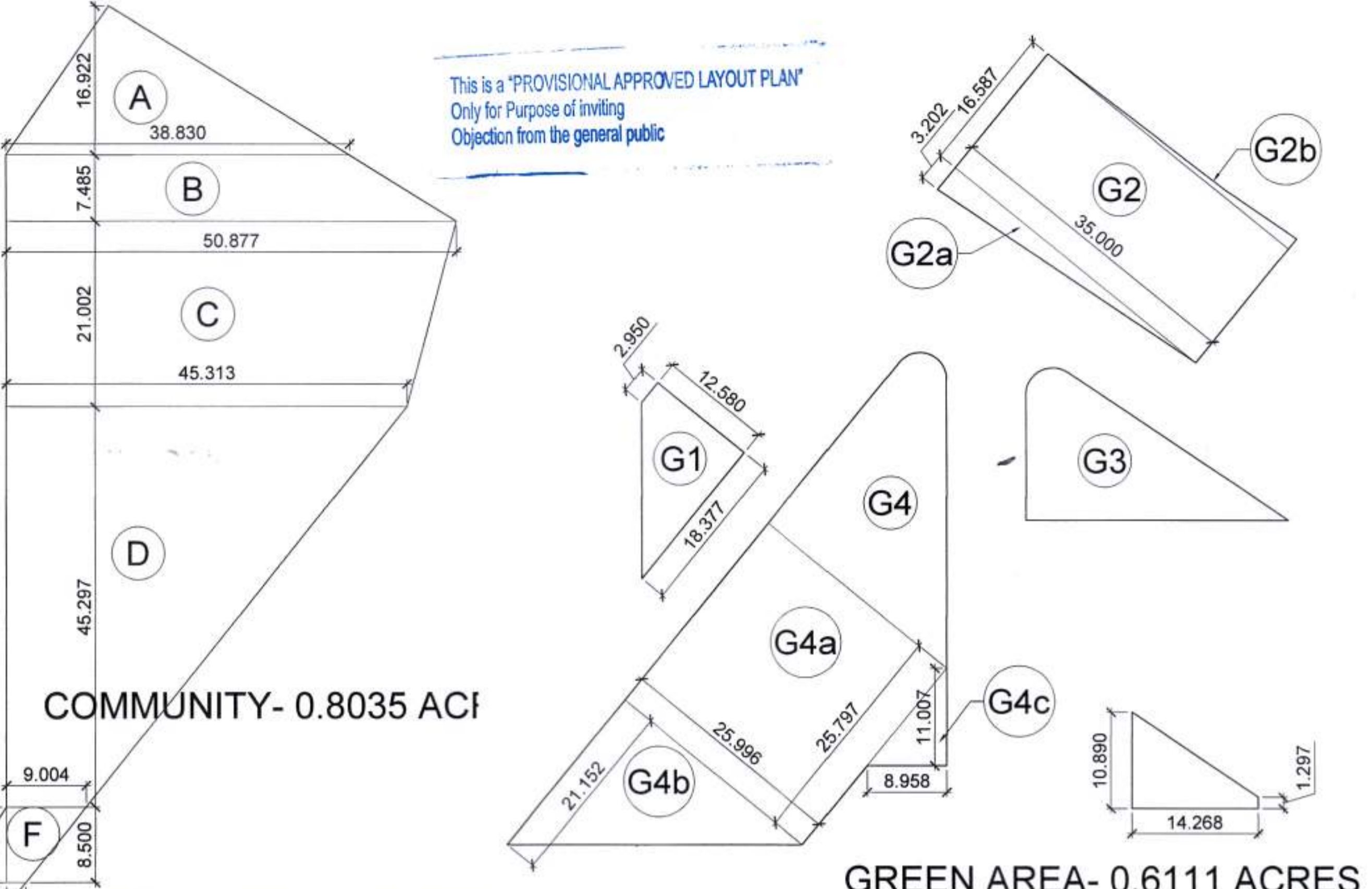

**COMMUNITY- 0.8035 ACRES**

**GREEN AREA- 0.6111 ACRES**

| GREEN AREA ADDITIONS |            |   |        |   |        |   |       |   |         |   |          |
|----------------------|------------|---|--------|---|--------|---|-------|---|---------|---|----------|
| (AREAS IN sq mtrs.)  |            |   |        |   |        |   |       |   |         |   |          |
| ITEM                 | L          | X | B      | X | FACTOR | X | NO    | = | SQ.MT   |   |          |
| G1                   | 2.950      | + | 18.377 | x | 0.5    | x | 12.58 | = | 134.147 |   |          |
| G2                   | 35.000     | x | 16.587 | x | 1.0    | x | 1     | = | 580.545 |   |          |
| G2a                  | 35.000     | x | 3.202  | x | 0.5    | x | 1     | = | 56.035  |   |          |
| G2b                  | as/autocad |   |        |   |        |   | 1     | = | 19.292  |   |          |
| G3                   | as/autocad |   |        |   |        |   | 1     | = | 287.026 |   |          |
| G4                   | as/autocad |   |        |   |        |   | 1     | = | 401.051 |   |          |
| G4a                  | 25.996     | x | 25.797 | x | 1.0    | x | 1     | = | 670.619 |   |          |
| G4b                  | 25.996     | x | 21.152 | x | 0.5    | x | 1     | = | 274.934 |   |          |
| G4c                  | 8.958      | x | 11.007 | x | 0.5    | x | 1     | = | 49.300  |   |          |
|                      |            |   |        |   |        |   |       |   | TOTAL   | = | 2472.948 |
|                      |            |   |        |   |        |   |       |   | ACRES   | = | 0.6111   |

| AREA STATEMENT FOR THE PROPOSED TOWNSHIP |      |             |        |          |          |           |            |          |  |  |
|--|------|-------------|--------|----------|----------|-----------|------------|----------|--|--|
| SITE 01                                  |      |             |        |          |          |           |            |          |  |  |
| SR.                                      | FROM | TO          | SIZE   | AREA     | AREA     | TOTAL NO. | TOTAL AREA |          |  |  |
| NO.                                      | L    | B           | SQ.M.  | SQ. YARD | OF PLOTS | SQ.M.     |            |          |  |  |
| 1  | 1    |             |        | 149.93   | 179.17   | 1         | 149.929    |          |  |  |
| 2  | 2    | As Per Site | 146.69 | 175.29   | 1        | 146.685   |            |          |  |  |
| 3  | 3    |             | 106.68 | 127.48   | 1        | 106.676   |            |          |  |  |
| 4  | 4    | 17.00       | 8.80   | 149.60   | 178.77   | 1         | 149.600    |          |  |  |
| 5  | 5    | 17.00       | 7.00   | 119.00   | 142.21   | 4         | 476.000    |          |  |  |
| 6  | 9    | As Per Site | 131.80 | 157.50   | 1        | 131.799   |            |          |  |  |
| 7  | 10   |             | 148.69 | 177.69   | 1        | 148.691   |            |          |  |  |
| 8  | 11   | 12          | 17.00  | 7.00     | 119.00   | 142.21    | 2          | 238.000  |  |  |
| 14                                       | 15   | 17.00       | 7.00   | 119.00   | 142.21   | 2         | 238.000    |          |  |  |
| 9  | 16   | 17.00       | 8.80   | 149.60   | 178.77   | 1         | 149.600    |          |  |  |
| 10                                       | 17   | 18          | 21.42  | 7.00     | 149.91   | 179.14    | 2          | 299.052  |  |  |
| 11                                       | 19   |             | 147.10 | 175.79   | 1        | 147.103   |            |          |  |  |
| 12                                       | 20   |             | 114.95 | 137.37   | 1        | 114.952   |            |          |  |  |
| 13                                       | 21   |             | 74.99  | 89.61    | 1        | 74.990    |            |          |  |  |
| 14                                       | 22   |             | 80.30  | 95.96    | 1        | 80.302    |            |          |  |  |
| 15                                       | 23   |             | 99.43  | 118.82   | 1        | 99.428    |            |          |  |  |
| 16                                       | 24   |             | 122.23 | 146.06   | 1        | 122.226   |            |          |  |  |
| 17                                       | 25   |             | 123.31 | 147.36   | 1        | 123.310   |            |          |  |  |
| 18                                       | 26   |             | 120.37 | 143.84   | 1        | 120.370   |            |          |  |  |
| 19                                       | 27   |             | 132.27 | 158.06   | 1        | 132.270   |            |          |  |  |
| 20                                       | 28   |             | 131.70 | 157.38   | 1        | 131.700   |            |          |  |  |
| 21                                       | 29   |             | 145.74 | 174.16   | 1        | 145.738   |            |          |  |  |
| 22                                       | 30   |             | 144.23 | 172.35   | 1        | 144.228   |            |          |  |  |
| 23                                       | 31   |             | 115.55 | 138.08   | 1        | 115.552   |            |          |  |  |
| 24                                       | 32   | As Per Site | 125.37 | 149.82   | 1        | 125.374   |            |          |  |  |
| 25                                       | 33   |             | 124.91 | 149.27   | 1        | 124.912   |            |          |  |  |
| 26                                       | 34   |             | 124.45 | 148.72   | 1        | 124.449   |            |          |  |  |
| 27                                       | 35   |             | 123.99 | 148.16   | 1        | 123.986   |            |          |  |  |
| 28                                       | 36   |             | 123.44 | 147.52   | 1        | 123.444   |            |          |  |  |
| 29                                       | 37   |             | 122.27 | 146.12   | 1        | 122.274   |            |          |  |  |
| 30                                       | 38   |             | 120.55 | 144.06   | 1        | 120.553   |            |          |  |  |
| 31                                       | 39   |             | 118.89 | 142.08   | 1        | 118.892   |            |          |  |  |
| 32                                       | 40   |             | 117.23 | 140.09   | 1        | 117.232   |            |          |  |  |
| 33                                       | 41   |             | 115.57 | 138.11   | 1        | 115.571   |            |          |  |  |
| 34                                       | 42   |             | 115.31 | 137.80   | 1        | 115.313   |            |          |  |  |
| 35                                       | 43   |             | 119.30 | 142.56   | 1        | 119.297   |            |          |  |  |
| 36                                       | 44   |             | 122.91 | 146.88   | 1        | 122.911   |            |          |  |  |
| 37                                       | 45   |             | 127.41 | 152.26   | 1        | 127.413   |            |          |  |  |
| 38                                       | 46   |             | 131.62 | 157.28   | 1        | 131.618   |            |          |  |  |
| 39                                       | 47   |             | 142.10 | 169.81   | 1        | 142.104   |            |          |  |  |
| 40                                       | 48   |             | 145.62 | 174.02   | 1        | 145.624   |            |          |  |  |
| 41                                       | 49   |             | 149.98 | 179.22   | 1        | 149.978   |            |          |  |  |
| 42                                       | 50   |             | 150.00 | 179.25   | 9        | 1350.000  |            |          |  |  |
| 43                                       | 51   |             | 146.04 | 174.52   | 1        | 146.038   |            |          |  |  |
| 44                                       | 52   |             | 146.50 | 175.07   | 1        | 146.504   |            |          |  |  |
| 45                                       | 53   | 17.00       | 7.50   | 127.50   | 152.36   | 1         | 127.500    |          |  |  |
| 46                                       | 54   | 17.00       | 7.00   | 119.00   | 142.21   | 1         | 119.000    |          |  |  |
| 47                                       | 55   | 13.41       | 7.54   | 101.18   | 120.91   | 2         | 202.360    |          |  |  |
| 48                                       | 56   | 17.00       | 8.70   | 147.87   | 176.70   | 1         | 147.866    |          |  |  |
| 49                                       | 57   | 17.00       | 7.00   | 119.00   | 142.21   | 16        | 1904.000   |          |  |  |
| 50                                       | 58   | 17.00       | 7.00   | 119.00   | 142.21   | 11        | 1309.000   |          |  |  |
| 51                                       | 59   | 17.00       | 7.00   | 119.00   | 142.21   | 1         | 119.000    |          |  |  |
| 52                                       | 60   | 17.00       | 7.50   | 127.50   | 152.36   | 2         | 255.000    |          |  |  |
| 53                                       | 61   | 15.50       | 8.02   | 124.26   | 148.49   | 3         | 372.791    |          |  |  |
| 54                                       | 62   | 15.50       | 8.02   | 124.26   | 148.49   | 2         | 248.527    |          |  |  |
| 55                                       | 63   | 15.68       | 6.50   | 101.89   | 121.76   | 12        | 1222.650   |          |  |  |
| 56                                       | 64   |             |        |          |          |           | SQ MT      | 9035.344 |  |  |
| 57                                       | 65   |             |        |          |          |           | ACRES      | 2.233    |  |  |
| 58                                       | 66   |             |        |          |          |           |            | 50.171%  |  |  |

| AREA STATEMENT FOR THE PROPOSED FROZEN LAND IN TOWNSHIP |      |     |       |          |          |           |            |          |  |  |
|---|------|-----|-------|----------|----------|-----------|------------|----------|--|--|
| SR.   | FROM | TO  | SIZE  | AREA     | AREA     | TOTAL NO. | TOTAL AREA |          |  |  |
| NO.   | L    | B   | SQ.M. | SQ. YARD | OF PLOTS | SQ.M.     |            |          |  |  |
| 1   | 43   | 0   | 0     | 119.30   | 142.56   | 1         | 119.297    |          |  |  |
| 2   | 44   | 0   | 0     | 122.91   | 146.88   | 1         | 122.911    |          |  |  |
| 3   | 45   | 0   | 0     | 127.41   | 152.26   | 1         | 127.413    |          |  |  |
| 4   | 46   | 0   | 0     | 131.62   | 157.28   | 1         | 131.618    |          |  |  |
| 5   | 47   | 0   | 0     | 142.52   | 170.31   | 1         | 142.517    |          |  |  |
| 6   | 48   | 0   | 0     | 139.78   | 167.04   | 1         | 139.782    |          |  |  |
| 7   | 49   | 0   | 0     | 142.10   | 169.81   | 1         | 142.104    |          |  |  |
| 8   | 50   | 0   | 0     | 143.86   | 171.92   | 1         | 143.864    |          |  |  |
| 9   | 51   | 0   | 0     | 145.62   | 174.02   | 1         | 145.624    |          |  |  |
| 10  | 52   | 0   | 0     | 149.98   | 179.22   | 1         | 149.978    |          |  |  |
| 11  | 53   | 61  | 20.00 | 150.00   | 179.25   | 9         | 1350.000   |          |  |  |
| 12  | 62   | 0   | 0     | 146.04   | 174.52   | 1         | 146.038    |          |  |  |
| 13  | 63   | 0   | 0     | 146.50   | 175.07   | 1         | 146.504    |          |  |  |
| 14  | 64   | 0   | 17.00 | 127.50   | 152.36   | 1         | 127.500    |          |  |  |
| 15  | 65   | 0   | 17.00 | 119.00   | 142.21   | 1         | 119.000    |          |  |  |
| 16  | 66   | 67  | 13.41 | 7.54     | 101.18   | 120.91    | 2          | 202.360  |  |  |
| 17  | 68   | 0   | 17.00 | 147.87   | 176.70   | 1         | 147.866    |          |  |  |
| 18  | 69   | 84  | 17.00 | 119.00   | 142.21   | 16        | 1904.000   |          |  |  |
| 19  | 95   | 105 | 17.00 | 119.00   | 142.21   | 11        | 1309.000   |          |  |  |
| 20  | 112  | 0   | 17.00 | 119.00   | 142.21   | 1         | 119.000    |          |  |  |
| 21  | 113  | 114 | 17.00 | 127.50   | 152.36   | 2         | 255.000    |          |  |  |
| 22  | 123  | 125 | 15.50 | 8.02     | 124.26   | 148.49    | 3          | 372.791  |  |  |
| 23  | 128  | 129 | 15.50 | 8.02     | 124.26   | 148.49    | 2          | 248.527  |  |  |
| 24  | 137  | 148 | 15.68 | 6.50     | 101.89   | 121.76    | 12         | 1222.650 |  |  |
|   |      |     |       |          |          | SQ MT     | 9035.344   |          |  |  |
|   |      |     |       |          |          | ACRES     | 2.233      |          |  |  |
|   |      |     |       |          |          |           |            | 50.171%  |  |  |

| COMMUNITY ADDITIONS (AREAS IN sq mtrs.) |        |   |        |   |        |   |        |   |                |                  |
|---|--------|---|--------|---|--------|---|--------|---|----------------|------------------|
| ITEM                                    | L      | X | B      | X | FACTOR | X | NO     | = | SQ.MT          |                  |
| a                                       | 38.830 | x | 16.922 | x | 0.5    | x | 1      | = | 328.541        |                  |
| b                                       | 38.830 | + | 50.877 | x | 0.5    | x | 7.485  | = | 335.728        |                  |
| c                                       | 45.313 | + | 50.877 | x | 0.5    | x | 21.002 | = | 1010.091       |                  |
| d                                       | 45.313 | + | 9.004  | x | 0.5    | x | 45.297 | = | 1230.199       |                  |
| e                                       | 5.638  | x | 8.500  | x | 0.5    | x | 1      | = | 23.962         |                  |
| f                                       | 9.004  | + | 2.191  | x | 0.5    | x | 8.5    | = | 47.579         |                  |
| g                                       | 22.191 | + | 7.035  | x | 0.5    | x | 18.855 | = | 275.528        |                  |
|   |        |   |        |   |        |   |        |   | TOTAL          | SQ MT = 3251.627 |
|   |        |   |        |   |        |   |        |   | ACRES = 0.8035 |                  |

Note:- Plots No. 53 to 57 (05 Nos.), 68 to 72 (05 Nos.), 81 to 83 (03 Nos.), 96 to 98 (03 Nos.), 105 to 109 (05 Nos.), 136 to 140 (05 Nos.) and 144 to 146 (03 Nos.) totalling 29 Nos. falling under ROW of 11 KV HT Lines passing through the site shall be freed till shifting of above said HT lines and also plots freed as per policy dated 08.02.2016 of DDJAY as shown on the plan in table.

NOTE:-  
-All dimensions are in meters unless stated otherwise.

ARCHITECT:  
MANISH JAIN AND ASSOCIATES  
E-131, East Of Kailash, New Delhi-110065  
T: 011-41084019  
E: info@manishjainassociates.com  
W: www.manishjainassociates.com

Architect's Signature: [Signature]  
Client's Signature: [Signature]

JOB TITLE:  
LAYOUT PLAN FOR DEVELOPING A RESIDENTIAL AFFORDABLE PLOTTED HOUSING COLONY UNDER DEEN DAYAL JAN AWAS YOJNA OVER AN AREA MEASURING 7.95625 ACRES AT KILLA NO. 3/24, 4/9, 10, 11/2/1, 11/2/2, 12/1, 12/2, 13, 18/2, 19, 22/1, 22/2, 23/1, 5/5, 6 IN THE REVENUE ESTATE OF VILLAGE SHADIPUR, TEHSIL AND DISTT. SONEPAT FOR SANJIV SARIN, NEERU SARIN AND PREM SARIN

Date: JULY 2020  
Scale