

OTHER VACANT LAND

OTHER VACANT LAND

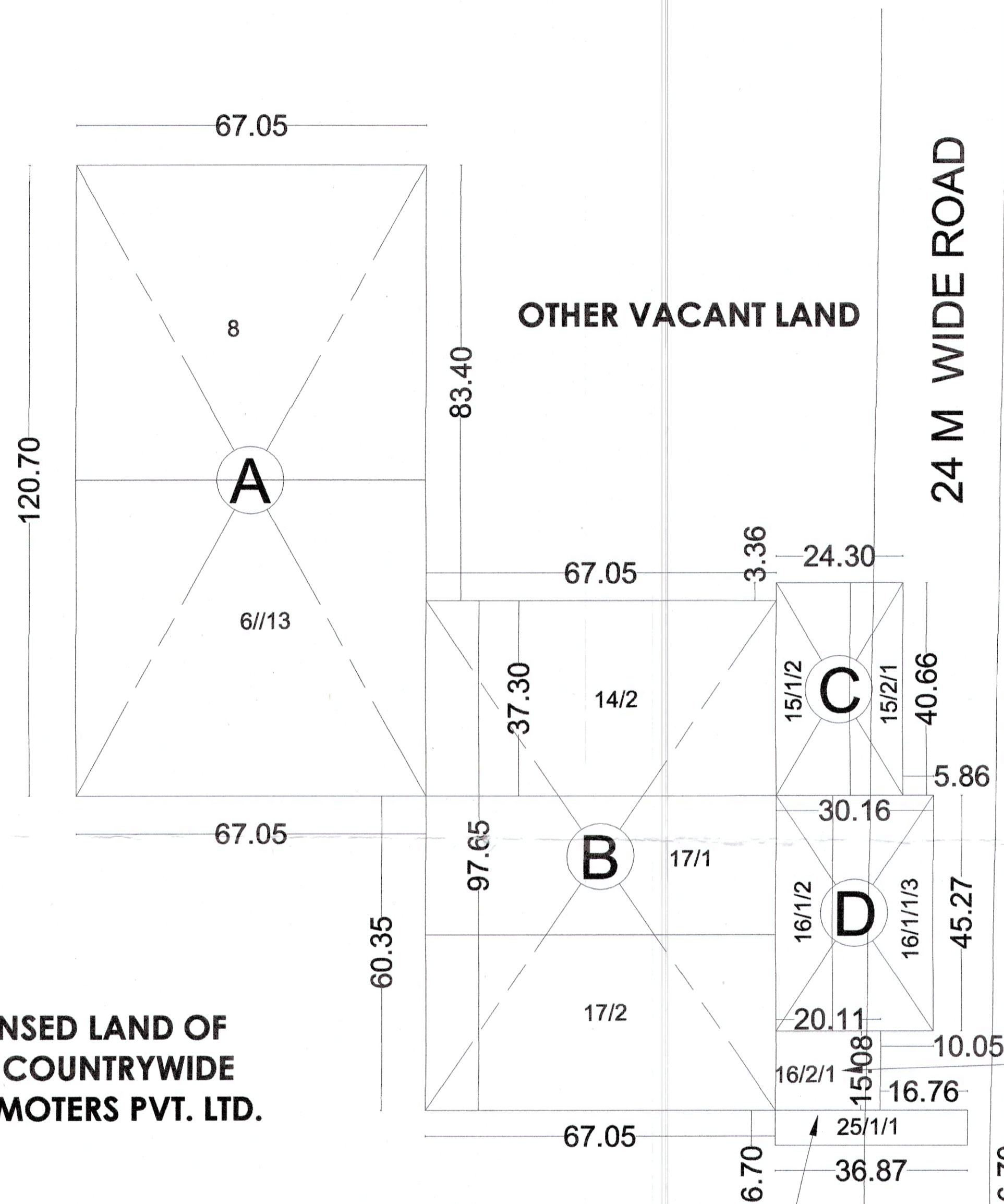

LICENSED LAND OF M/S COUNTRYWIDE PROMOTERS PVT. LTD.

LICENSED LAND OF M/S COUNTRYWIDE PROMOTERS PVT. LTD.

AREA UNDER 24M ROAD

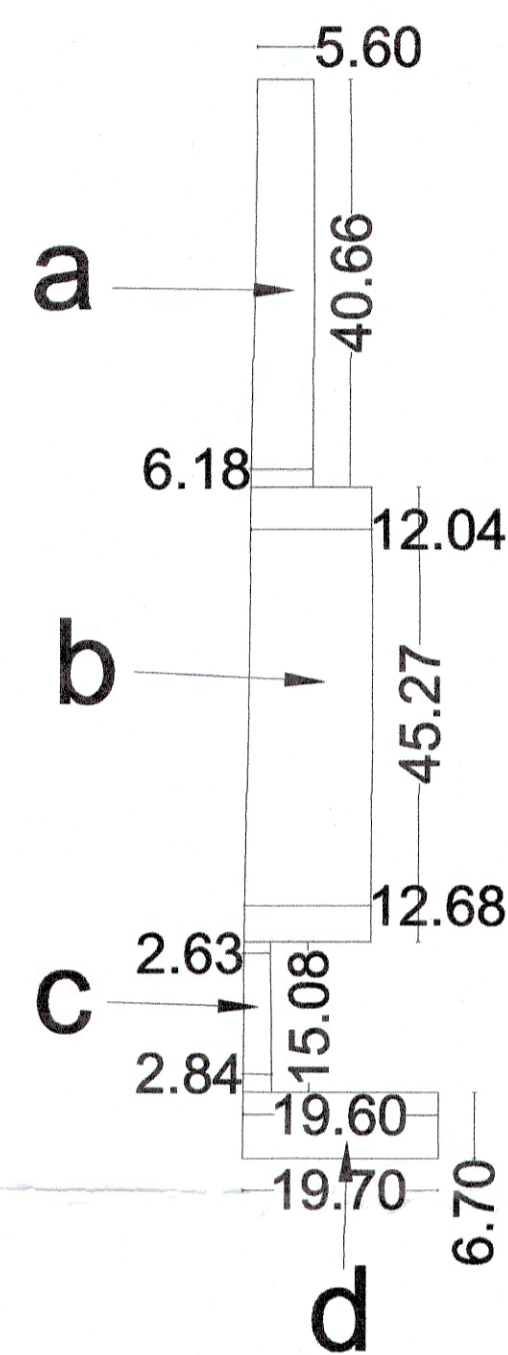

DTP  
PA  
JE  
JD

PLOT AREA	=	4.3375	ACRES			=	17553.863	SQM
<b>AREA UNDER ZONNING</b>								
A	67.05	X	120.70			=	8092.935	SQM
B	67.05	X	97.65			=	6547.433	SQM
C	24.30	X	40.66			=	988.038	SQM
D	30.16	X	45.27			=	1365.343	SQM
E	20.11	X	15.08			=	303.259	SQM
F	36.87	X	6.70			=	247.029	SQM
			TOTAL			=	17544.037	SQM
						=	4.335	ACRES
<b>AREA UNDER 24.0M WIDE ROAD</b>								
a	5.600	+	6.180	÷ 2	x	40.660	=	239.49
b	12.040	+	12.680	÷ 2	x	45.270	=	559.537
c	2.630	+	2.840	÷ 2	x	15.080	=	41.24
d	19.600	+	19.700	÷ 2	x	6.700	=	131.66
						=	971.927	SQM
						=	0.24	ACRES
<b>NET PLANNED AREA</b>								
			4.335	-	0.24	=	4.095	ACRES

PROJECT NAME & ADDRESS :  
**Demarcation plan of Affordable Group Housing colony over an area measuring 4.3375 acres.**  
 (LOI No.LC-3979-JE(VA)/2020/10016 Dated.16.06.2020)  
 Site measuring = 4.3375 acres  
 [Rect/Killa No.6/18 (8-0), 13(8-0), 14/2MIN(4-19), 15/1/2(1-3), 15/2/1(0-16), 16/1/2(1-0), 16/1/1/3(1-14), 16/2/1(0-12), 17/1(3-11), 17/2(4-9), 25/1/1(0-10) total 34K-14M OR 4.3375 acres falling in the revenue estate of village Palra Sector-70, District Gurugram - Pyramid Dream Homes LLP.]

OWNER NAME :  
**PYRAMID DREAM HOMES LLP.**

ARCHITECTS  
**RAO AND ASSOCIATE**  
 ARCHITECTS PLANNERS ENGINEERS INTERIORS VALUERS  
 374,UDYOG VIHAR,PHASE-4,SEC-18 GURGAON.HARYANA(INDIA)  
 PH. (0124) - 2347706, 2347707 FAX 0124 - 2347707

ARCHITECT'S SIGNATURE : *Vivek Singh RAO*  
**V.S. RAO**

DRAWING TITLE :  
**DEMARICATION PLAN**

SCALE :  
**A2 SIZE 1 : 1000**

REVISION :

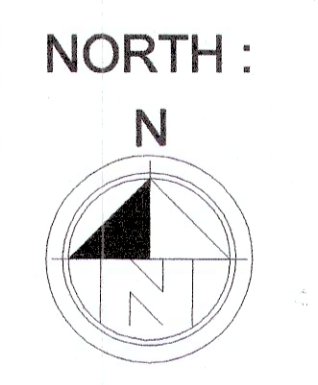

559.537  
971.927  
0.24

4.095