

60.0 MT. WIDE EXISTING
SECTOR ROAD

120 MT. WIDE EXISTING SERVICE ROAD

2-KARAM WIDE REVENUE PASTA

2 Karam wide
Revenue Rasta

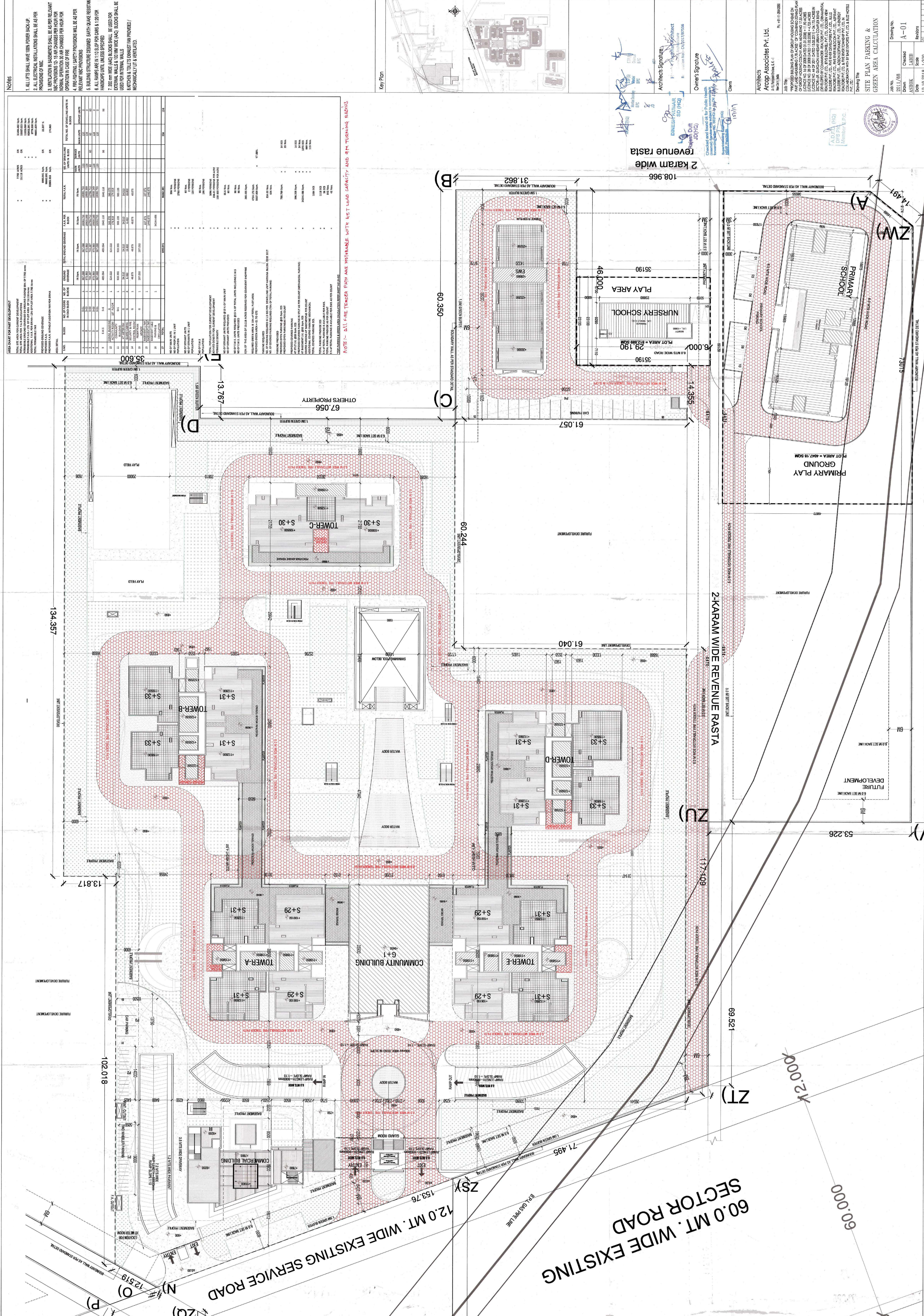

TABLE 1: AREA SCHEDULE FOR PART DEVELOPMENT

Sl. No.	Part	Area (sq. mt.)	Remarks
1	Plot Area	39,600	
2	Building Area	12,500	
3	Open Space	15,000	
4	Play Area	4,600	
5	Swimming Pool	1,000	
6	Water Body	1,500	
7	Other	1,000	
8	Total	75,600	

TABLE 2: AREA SCHEDULE FOR FULL DEVELOPMENT

Sl. No.	Part	Area (sq. mt.)	Remarks
1	Plot Area	39,600	
2	Building Area	15,000	
3	Open Space	15,000	
4	Play Area	4,600	
5	Swimming Pool	1,000	
6	Water Body	1,500	
7	Other	1,000	
8	Total	77,700	

NOTES

1. ALL SETBACKS SHALL BE AS PER THE PROVISIONS OF THE BUILDING REGULATIONS.
2. ALL ELECTRICAL METALLINGS SHALL BE AS PER THE PROVISIONS OF THE ELECTRICAL REGULATIONS.
3. ALL MECHANICAL METALLINGS SHALL BE AS PER THE PROVISIONS OF THE MECHANICAL REGULATIONS.
4. ALL MECHANICAL METALLINGS SHALL BE AS PER THE PROVISIONS OF THE MECHANICAL REGULATIONS.
5. ALL MECHANICAL METALLINGS SHALL BE AS PER THE PROVISIONS OF THE MECHANICAL REGULATIONS.
6. ALL MECHANICAL METALLINGS SHALL BE AS PER THE PROVISIONS OF THE MECHANICAL REGULATIONS.
7. ALL MECHANICAL METALLINGS SHALL BE AS PER THE PROVISIONS OF THE MECHANICAL REGULATIONS.
8. ALL MECHANICAL METALLINGS SHALL BE AS PER THE PROVISIONS OF THE MECHANICAL REGULATIONS.
9. ALL MECHANICAL METALLINGS SHALL BE AS PER THE PROVISIONS OF THE MECHANICAL REGULATIONS.
10. ALL MECHANICAL METALLINGS SHALL BE AS PER THE PROVISIONS OF THE MECHANICAL REGULATIONS.

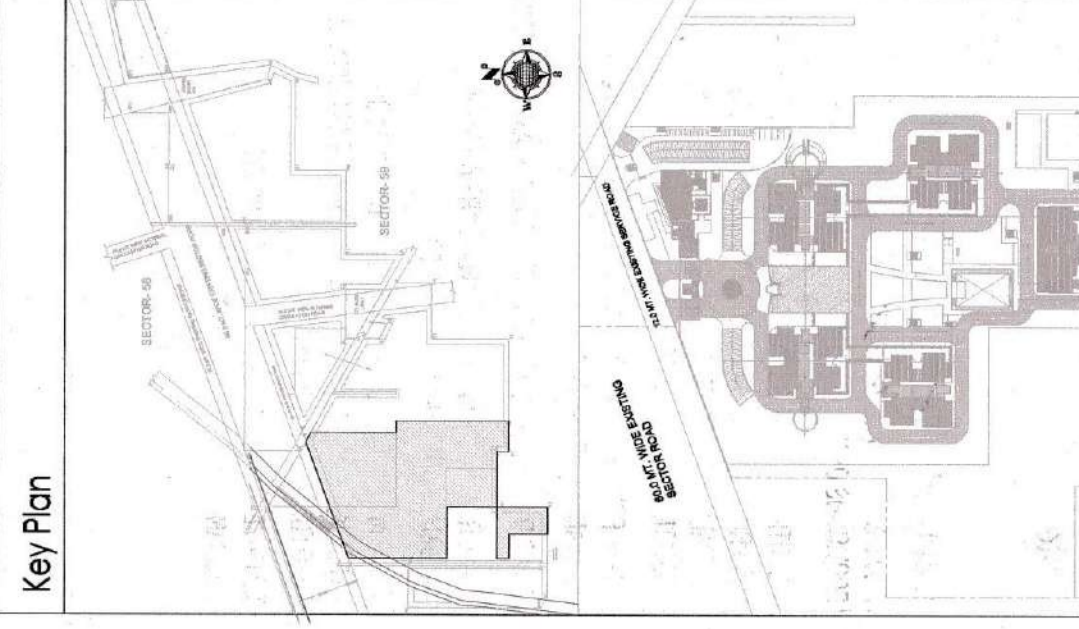

Architects: Arcop Associates Pvt. Ltd.
 Checked: [Signature]
 Date: [Date]
 Scale: [Scale]
 Drawing No: A-01
 Revision: [Revision]