

Memo No.: -ZP-1193/AD (RA)/2018/ 29594 Dated: 16-10-18

To

JBG Buildcon Pvt. Ltd.,
D-33, Punjab Basti,
North Rly Nangloi,
New Delhi.

Subject: -Approval of zoning plan of Affordable Residential Plotted Colony (Under Deen Dayal Jan Awas Yojna-2016) for an area measuring 10.0375 acres (Licence No. 68 of 2017 dated 22.08.2017) in Sector-3A, Bahadurgarh being developed by JBG Buildcon Pvt. Ltd.

Please refer on the subject noted above.

Please find enclosed a copy of approved zoning Plan of Affordable Residential Plotted Colony (Under Deen Dayal Jan Awas Yojna-2016) bearing Drg. No. DTCP 6643 Dated 11.10.2018.

DA/As above.

(Lalit Kumar)
District Town Planner (HQ),
For: Director, Town & Country Planning,
Haryana, Chandigarh.

Endst. No.: -ZP-1193/AD (RA)/2018/ _____ Dated: _____

A copy is forwarded to the following for information and necessary action.

1. The Senior Town Planner, Rohtak along with a copy of approved zoning plan of Affordable Residential Plotted Colony.
2. The District Town Planner, Jhajjar along with a copy of approved zoning plan of Affordable Residential Plotted Colony.
3. Nodal Officer, Website Updation along with a copy of approved zoning plan of Affordable Residential Plotted Colony.

DA/As above.

(Lalit Kumar)
District Town Planner (HQ),
For: Director, Town & Country Planning,
Haryana, Chandigarh.

24 MT. WIDE INTERNAL ROAD

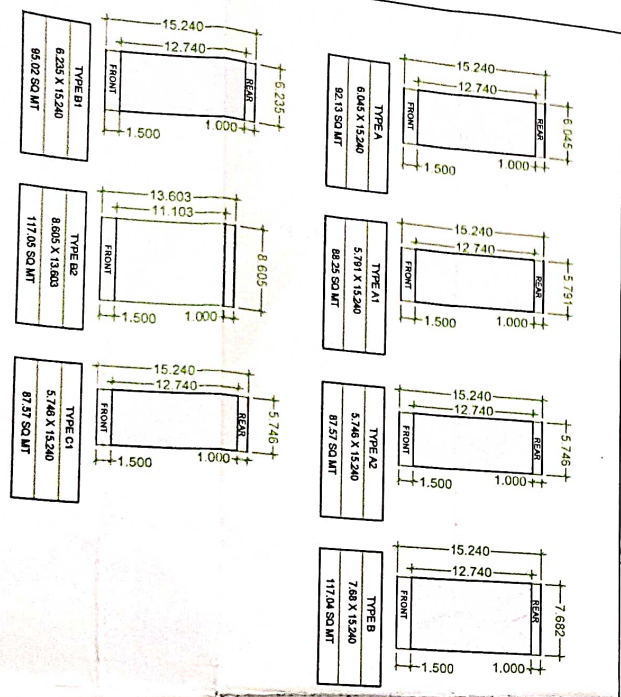
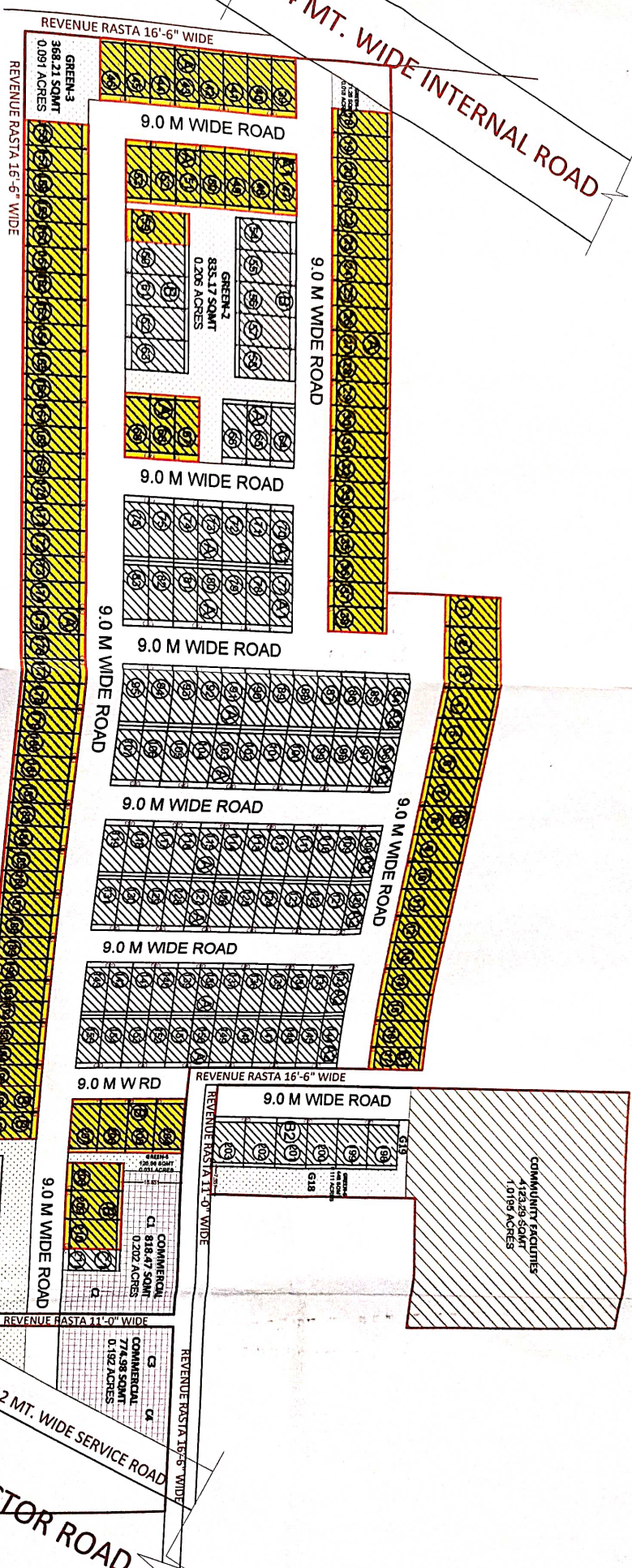

50 % FREETED AREA

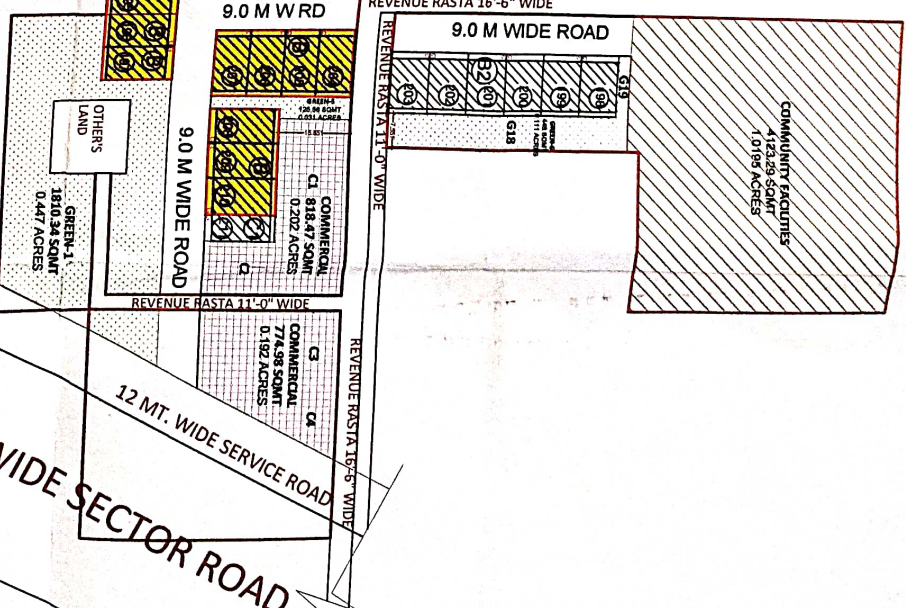

45 MT. WIDE SECTOR ROAD

12 MT. WIDE SERVICE ROAD

ZONING PLAN OF AFFORDABLE RESIDENTIAL PLOTTED COLONY (UNDER DEEN DAYAL JAN AWAS YOJNA) AREA MEASURING 10.0375 ACRES (LICENSE NO. 68 OF 2017 DATED 22.08.2017) IN SECTOR-3A, BAHADURGARH BEING DEVELOPED BY JBG BUILDCON PVT. LTD.

FOR PURPOSE OF CODE 1.2 (XCVI) & 6.1 (1) OF THE HARYANA BUILDING CODE, 2017, AS AMENDED FROM TIME TO TIME.

1. USE ZONE

The land shown in this zoning plan shall be utilized in accordance with the marking explained in the table below and no other manner whatsoever:

Notation	Permissible use of land on the portion of the plot marked in column 1	Type of building permissible on land marked in column 1.
1	2	3
	Road	Road furniture at approved places.
	Public open space	To be used only for landscape features.
	Residential Buildable Zone	Residential building.
	Commercial	As per supplementary zoning plan to be approved separately for each site.

2. MAXIMUM PERMISSIBLE GROUND COVERAGE BASEMENT, FAR AND MAXIMUM PERMISSIBLE HEIGHT / INCLUDING STILT PARKING

- (a) The building or buildings shall be constructed only with in the portion of the site marked as buildable zone as explained above, and nowhere else.
- (b) The Maximum permissible ground coverage, basement, F.A.R (DDJAY Policy dated 08.02.2016) and maximum permissible height / including stilt parking on the area of the site mentioned in column-1, according to the tale below :-

Plot Area	Maximum Permissible Ground Coverage	Permissible Basement	Maximum Permissible Floor Area Ratio (FAR)	Maximum permissible Height (G+3 Floor) (Including stilt (S+4 Floor)) (in.metres)
Upto 150 square metres	66%	Single Level	200%	15.00

- (c) The stilt parking are permitted parking purpose in residential plots of all sizes, subject to the condition that maximum permissible height of building shall not exceed 15 metres.

3. PERMISSIBLE NUMBER OF DWELLING UNIT ON EACH PLOT

Not more than three dwelling units shall be allowed on each plot.

4. BAR ON SUB-DIVISION OF PLOT

Sub-division & clubbing of the plots shall not be permitted any circumstances.

5. BUILDING SETBACK

Building other than boundary wall and gates shall be constructed only within the portion of the site marked as residential buildable zone in clause number 1 above. The cantilever projections as allowed in Haryana Building Code, 2017 shall project beyond the portion marked as residential buildable zone.

6. HEIGHT OF THE BUILDING AND PERMISSIBLE NUMBER OF STOREY

The maximum height and number of storey shall be allowed on the plot as per provisions of Haryana Building Code, 2017.

7. STILT PARKING

Stilt parking is allowed in all sizes plots. The clear height of the stilt shall be 2.40 metres from the plinth level and below the bottom of the beam. The Stilt will not be permissible for any purpose other than parking.

8. PARKING

- (a) Parking shall be provided as per the provisions of Haryana Building Code - 2017 as amended from time to time.
- (b) In no circumstance, the vehicle(s) belonging to the plot shall be parked outside the plot area.

9. PLINTH LEVEL

The plinth height of building shall be as per Haryana Building Code, 2017.

10. BASEMENT

Single level basements within the building zone of the site shall be provided as per Code 6.3(3)(i)(a) and shall be constructed, used and maintained as per Haryana Building Code, 2017.

11. RESTRICTION OF ACCESS FROM 45 MTS. WIDE OR MORE SECTOR ROADS AND PUBLIC OPEN SPACES

In the case of plots which abut on the 45 meters or more wide sector roads and plots which abut on public open spaces, no direct access whatsoever secondary or main shall be allowed into the plots from such roads and open spaces.

12. BOUNDARY WALL

- (a) The boundary wall shall be constructed as per Haryana Building Code, 2017.
- (b) The boundary walls in front courtyard which abut on a road or an open space shall be constructed according to standard design as approved by the DTCP. The boundary wall in the rear courtyard shall not be more than 1.80 meters in height.
- (c) In case of corner plots, boundary walls shall be rounded off at such corner by a radius as given below-
i. 0.5 metes Radius for plots opening on to open space.
ii. 1.0 metes Radius for plots.
- (d) The owner/applicant if desires, is permitted to not construct boundary wall in front of plot, so that the said area can be utilized for parking.

13. GATE AND GATE POST

- (a) Gate and gate post shall be constructed as per approved standard design, at the position indicated on the zoning plan.
- (b) An additional wicket gate of standard design not exceeding 1.15 meter width may be allowed in the front and side boundary wall provided further that no gate shall be allowed in the rear boundary wall or towards the sector road and public open space.

14. DISPLAY OF POSTAL NUMBER OF THE PLOT

The premises number and postal address shall be written at the space shown for this purpose on the standard design of the gate as per approved design.

15. GARBAGE COLLECTION POINT

Every plot holder shall make adequate provision for garbage collection in his own plot and make suitable arrangement for disposal at the towable collection point to be provided by the colonizer.

16. ACCESS

No plot or public building will derive an access from less than 9.00 meters wide road.

17. GENERAL

- (i) That the coloniser/owner shall use only Light-Emitting Diode lamps (LED) fitting for internal lighting as well as Campus lighting.
- (ii) That the coloniser/owner shall strictly comply with the directions issued vide Notification No. 19/6/2016-5P dated 31.03.2016 issued by Haryana Government Renewable Energy Department, if applicable.
- (iii) That coloniser/owner shall ensure the installation of Solar Power Plant as per provisions of Haryana Solar Power Policy, 2016 issued by Haryana Government Renewable Energy Department vide Notification No. 19/4/2016-5 Power dated 14.03.2016, if applicable.
- (iv) That the coloniser/owner shall ensure the installation of Solar Photovoltaic Power Plant as per the provisions of order No. 22/52/2005-5Power dated 21.03.2016 issued by Haryana Government Renewable Energy Department, if applicable.

NOTE

Read this drawing in conjunction with the demarcation plan verified by D.T.P., Rohtak vide Endst no. 2349 dated 08.07.2017.

DRG. NO. DTCP 6643 DATED 11-10-2018

(BALWANT SINGH) SD (HQ) (LALIT KUMAR) DTP (HQ) (DEVENDRA NIMBOKAR) STP (M) HQ (JITENDER SIHAG) CTP (HR) (K.MAKRAND PANDURANG, IAS) DTCP (HR)

(RAM AVTAR BASSI) AD (HQ)