

**LEGEND**

SYMBOL	DESCRIPTION
	SEWER MAINLINE
	SEWER MAINLINE
	SEWER MAINLINE
	SEWER MAINLINE

**NOTES**

1. DIMENSIONS ARE NOT TO BE SCALED.
2. ALL DIMENSIONS ARE IN MM UNLESS NOTED OTHERWISE.
3. ALL ELECTRICAL INSTALLATIONS SHALL BE AS PER PROVISIONS OF NEC.
4. FIRE FIGHTING SAFETY PROVISIONS SHALL BE AS PER RELEVANT NBC.
5. BOUNDARY WALL AND GATE AS PER STANDARDS.
6. ALL WALLS ARE OF 100 MM THK.
7. RAIN WATER HARVESTING SYSTEM SHALL BE PROVIDED AS PER CENTRAL PROVISIONS.
8. ALL WINDOWS & VENTILATORS ARE OPENABLE.

**LICENCE HOLDER**  
**CHITRA INDIA LIMITED**  
 A-11, KALASH COLONY  
 NEW DELHI  
 & OTHERS

**ARCHITECT'S SIGNATURE**  
 (Signature)

**SCALE**  
 1:750  
 PS-101

**REVISIONS**

NO.	DATE	REVISION
1	2023-11-15	REVISED BUILDING PLAN SANCTION

**EXTERNAL SEWER LAYOUT**

**PROJECT DETAILS**

**CLIENT**: SOBHA LIMITED

**LOCATION**: NEW DELHI

**DATE**: 2023-11-15

**PROJECT NO.**: PS-101

**DRAWN BY**: (Name)

**CHECKED BY**: (Name)

**DATE**: 2023-11-15

**SCALE**: 1:750

**PROJECT NO.**: PS-101

**PROJECT NO.**: PS-101

**SCALE**: 1:750

**PROJECT NO.**: PS-101

**PROJECT NO.**: PS-101

**SCALE**: 1:750

**PROJECT NO.**: PS-101

**PROJECT NO.**: PS-101

**SCALE**: 1:750

**PROJECT NO.**: PS-101

**PROJECT NO.**: PS-101

**SCALE**: 1:750

**PROJECT NO.**: PS-101

**PROJECT NO.**: PS-101

**SCALE**: 1:750

**PROJECT NO.**: PS-101

**PROJECT NO.**: PS-101

**SCALE**: 1:750

**PROJECT NO.**: PS-101



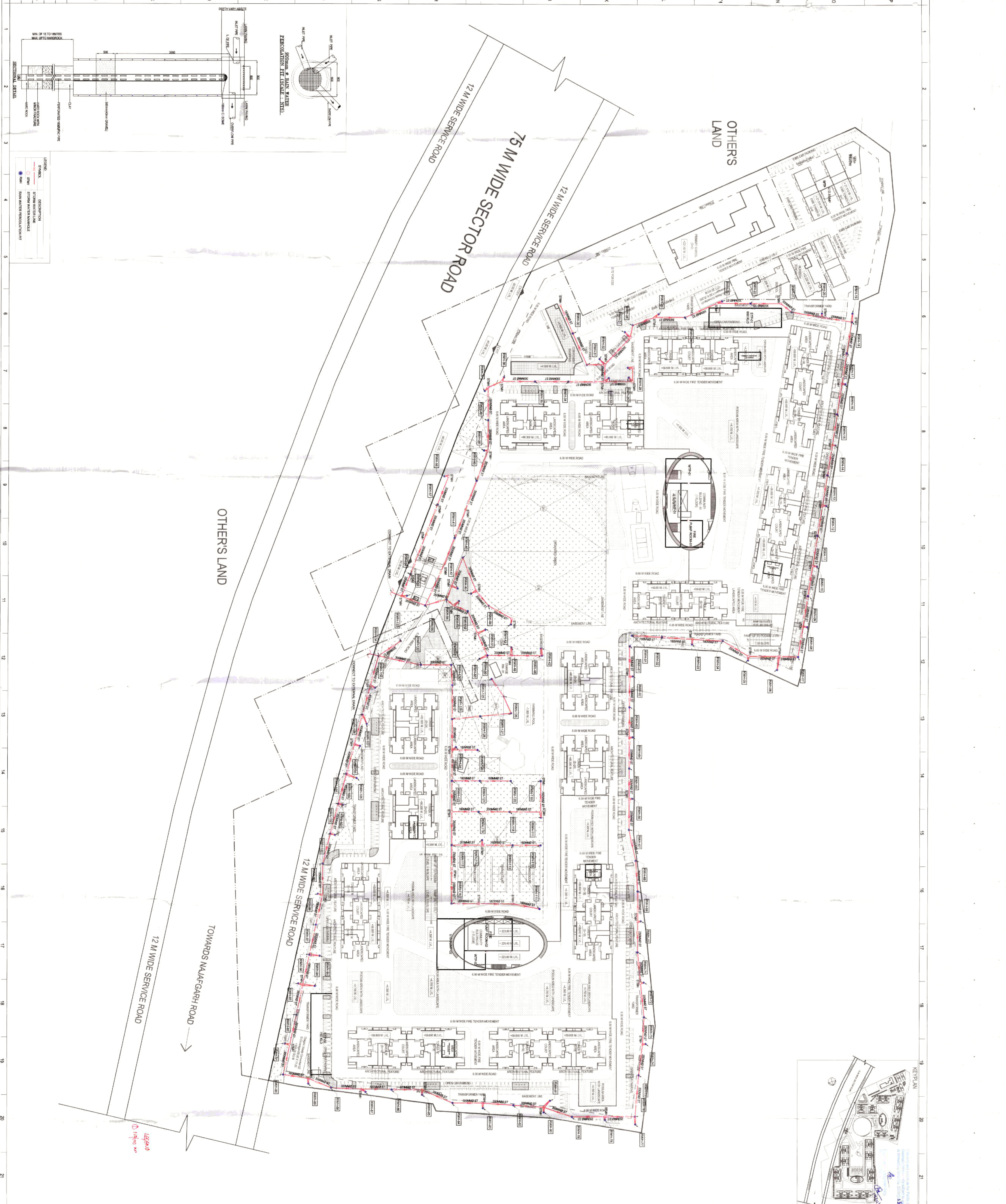

**NOTES**

1. DIMENSIONS ARE NOT TO BE SCALED.  
 2. MENTIONED OTHERWISE SHALL BE AS PER PROVISIONS OF NBC  
 3. ALL ELECTRICAL INSTALLATIONS SHALL BE AS PER PROVISIONS OF NBC WILL BE AS PER RELEVANT NBC PROVISIONS.  
 4. BOUNDARY WALL AND GATE AS PER 5. ALL WALLS ARE OF 180 MM THK CONCRETE WALL.  
 5. RAIN WATER HARVESTING SYSTEM SHALL BE AS PER CENTRAL GOVT. NOSHARAYANA GOVT. 6. ALL WINDOWS & VENTILATORS ARE OF 200x200.

**LEGEND**

SYMBOL	DESCRIPTION
---	STORM WATER LINE
---	SEWER WATER LINE
---	RAIN WATER COLLECTION
---	CONCRETE FOUNDATION

**SECTIONAL DETAILS**

**3000mm x 600mm RAIN WATER EXERCUTION DET (SCALE : 1:10)**

**3000mm x 600mm RAIN WATER EXERCUTION DET (SCALE : 1:10)**

**3000mm x 600mm RAIN WATER EXERCUTION DET (SCALE : 1:10)**

**KEY PLAN**

**LEGEND**

**EXTERNAL STORM WATER LAYOUT**

**REVISOR**

**DATE**

**PROJECT**

**CLIENT**

**DESIGNER**

**SCALE**

**SHEET NO.**

**TOTAL SHEETS**

**DATE**

**PROJECT**

**CLIENT**

**DESIGNER**

**SCALE**

**SHEET NO.**

**TOTAL SHEETS**

**DATE**



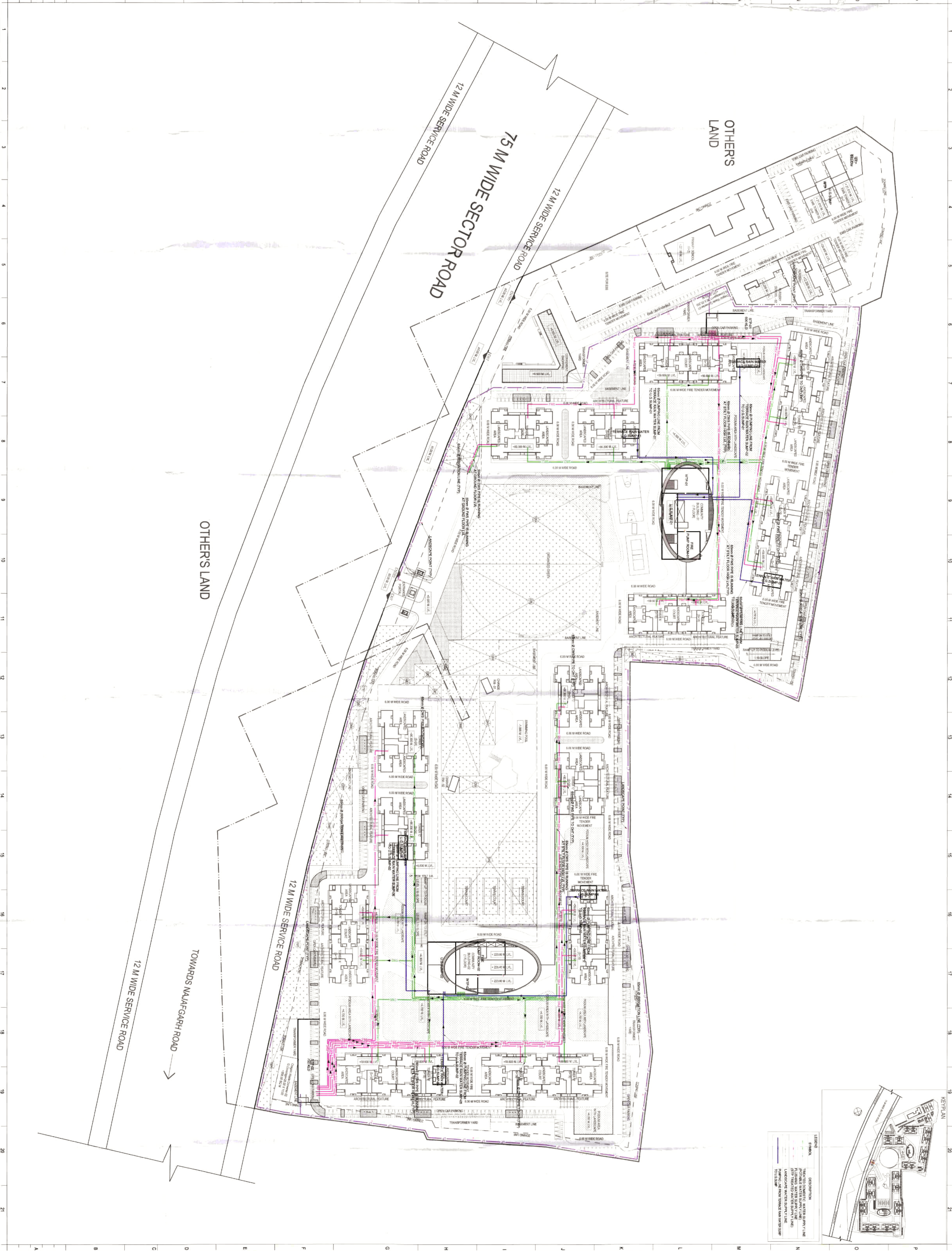

SYMBOL	DESCRIPTION
(Red line)	PROPOSED EXTERNAL WATER SUPPLY LINE
(Green line)	EXISTING EXTERNAL WATER SUPPLY LINE
(Blue line)	EXISTING WATER SUPPLY LINE
(Purple line)	LANDSCAPE WATER SUPPLY LINE
(Yellow line)	PLANNING LINE FROM TOWNSHIP BOUNDARY
(Black line)	PROPERTY LINE



KEY PLAN

**NOTES**

1. DIMENSIONS ARE NOT TO BE SCALED
2. ALL DIMENSIONS ARE IN MM UNLESS MENTIONED OTHERWISE
3. ALL DIMENSIONS ARE IN MM UNLESS MENTIONED OTHERWISE
4. FIRE FIGHTING SAFETY PROVISIONS WILL BE AS PER RELEVANT NBC
5. BOUNDARY WALL AND GATE AS PER STANDARDS
6. ALL WALLS ARE OF 150 MM THK CONCRETE
7. CONCRETE FINISHING SYSTEM SHALL BE PROVIDED AS PER CENTRAL GOVT. WATER AUTHORITY
8. ROOFING SHALL BE AS PER CENTRAL GOVT. WATER AUTHORITY
9. VENTILATORS ARE OFFSHORE

**LICENSE HOLDERS SIGNATURE**

*[Signature]*  
**CHINTELA INDIA LIMITED**  
 A-11, KALIAJI COLONY  
 NEW DELHI  
 & OTHERS

**ARCHITECTS SIGNATURE**

*[Signature]*  
**A.P. Praveen Prasad**  
 A.P. Praveen Prasad & Associates  
 507, Connaught Place, New Delhi - 110029  
 Tel: +91-11-26100000, Fax: +91-11-26100001  
 Email: praveen@apppraves.com

**DATE**

DATE: 20/11/2024

**SCALE**

SCALE: 1:150

**PROJECT NO.**

PROJECT NO: PS-110

**EXTERNAL WATER SUPPLY LAYOUT**

**REVISED BUILDING PLAN SANCTION**  
 OF GOVT. ACQUIRING RESIDENCY AT 27th CROSS IN SECTOR 10, GATEWAY INDIA, NEW DELHI  
 PREPARED BY: CHINTELA INDIA LIMITED & OTHERS  
 LICENSE NO.: 107/2024 (27/05/2024)