

ABSTRACT	
TOTAL SITE AREA	11.61250 Acres
SITE AREA for Calculation	4699.046 sqm
FAR Permitted @175	43785.501 sqm
	76624.626 sqm

DETAILS OF MAIN D.U.'s PROPOSED								
	Tower - 1	Tower - 2	Tower - 3	Tower - 4	Tower - 5	Tower - 6	Tower - 7	Tower - 8
No. of D.U.'s per Tower	104	96	84	72	104	96	88	72
Total D.U.'s	716							

NO. OF D.U.'s				POPULATION PROPOSED			
716	Population of Main Units	@ 5 person per unit	3580 persons				
72	Population of Service Personnel	@ 2 person per unit	144 persons			3724 persons	
126	Population of EWS Units in Pocket A	@ 2 person per unit	252 persons				
TOTAL POPULATION						3976 persons	

PARAMETERS			
PARAMETER	PERMISSIBLE	TOTAL ACHIEVED	Figures
Ground Coverage	35.0%	15324.93 sqm	10174.968 sqm 23.28 %
F.A.R.	175%	76624.63 sqm	76611.341 sqm 174.969
No. of Main Units			716 nos.
No. of EWS units	(15% of Main D.U.'s)		126 nos.
TOTAL UNITS			
No. of Service Personnel	(10% of Main D.U.'s)		72 nos.
Population	100 ppa - 400 ppa	1080 - 4328 nos.	3976 nos. 367.480 PPA
Organised Greens	15%	6567.825 sqm	6567.840 %
Convenient Shopping	(0.5% of Site Area)	218.93 sqm	218.72 sqm
Car Parking	1.5 per Main D.U.	1074 nos.	1154 ECS
Covered Car Parking 75% of Total Required		806 nos.	865 ECS

PARKING SUMMARY			
PARKING for Main Units	REQUIRED	PROPOSED	
	1.5 ECS per unit	1074 ECS	1154 ECS
Covered Parking in STILT & BASEMENT @ 75%		806 ECS	865 ECS
Parking in SURFACE @ 25%		269 ECS	289 ECS
ECS Reserved for EWS 5% OF M.D.U.'s			53.7 ECS

DETAILS OF PARKING & BASEMENT (not included in FAR)					
FLOORS	AREA FOR SERVICES	AREA FOR PARKING	ECS @ (in sqm)	NO. OF ECS	Proposed
Surface	7756.590 sqm	25	310	289.00	
Stilt	1757.211 sqm	30	59	58.00	
Basement-1	339.950 sqm	16142.320 sqm	35	461	401.00
Basement-2	2047.438 sqm	16934.440 sqm	35	484	406.00
ECS Reserved for EWS				54	1154.00

SURFACE PARKING CALCULATION					
P1	11.15	X	17.5	=	195.13
P2	5.355	X	5	=	26.78
P3	12.5	X	5	=	62.50
P4	157.145	X	11	=	1728.60
P5	17.5	X	5	=	87.50
P6	11.5	X	58.93	=	677.70
P7	17.5	X	5.765	=	100.89
P8	6.0	X	17.5	=	875.00
P9	27.055	X	60.755	=	1643.73
P10	11	X	126.93	=	1396.23
P11	11	X	67.5	=	742.50
P12	10	X	9.45	=	94.50
TOTAL				=	7631.03

SCHOOL AREA AND PARKING CALCULATION					
SCHOOL-1 AREA	22.5	X	36	=	810.00 SQ.M
PARKING 10% OF PLOT AREA				=	81.00 SQ.M
PARKING PROVISIONS 25 SQ.M/ECS				=	3.24 NOS.
PROPOSED PARKING				=	4 NOS.

SCHOOL AREA AND PARKING CALCULATION					
SCHOOL-2 AREA	22.5	X	36	=	810.00 SQ.M
PARKING 10% OF PLOT AREA				=	81.00 SQ.M
PARKING PROVISIONS 25 SQ.M/ECS				=	3.24 NOS.
PROPOSED PARKING				=	4 NOS.

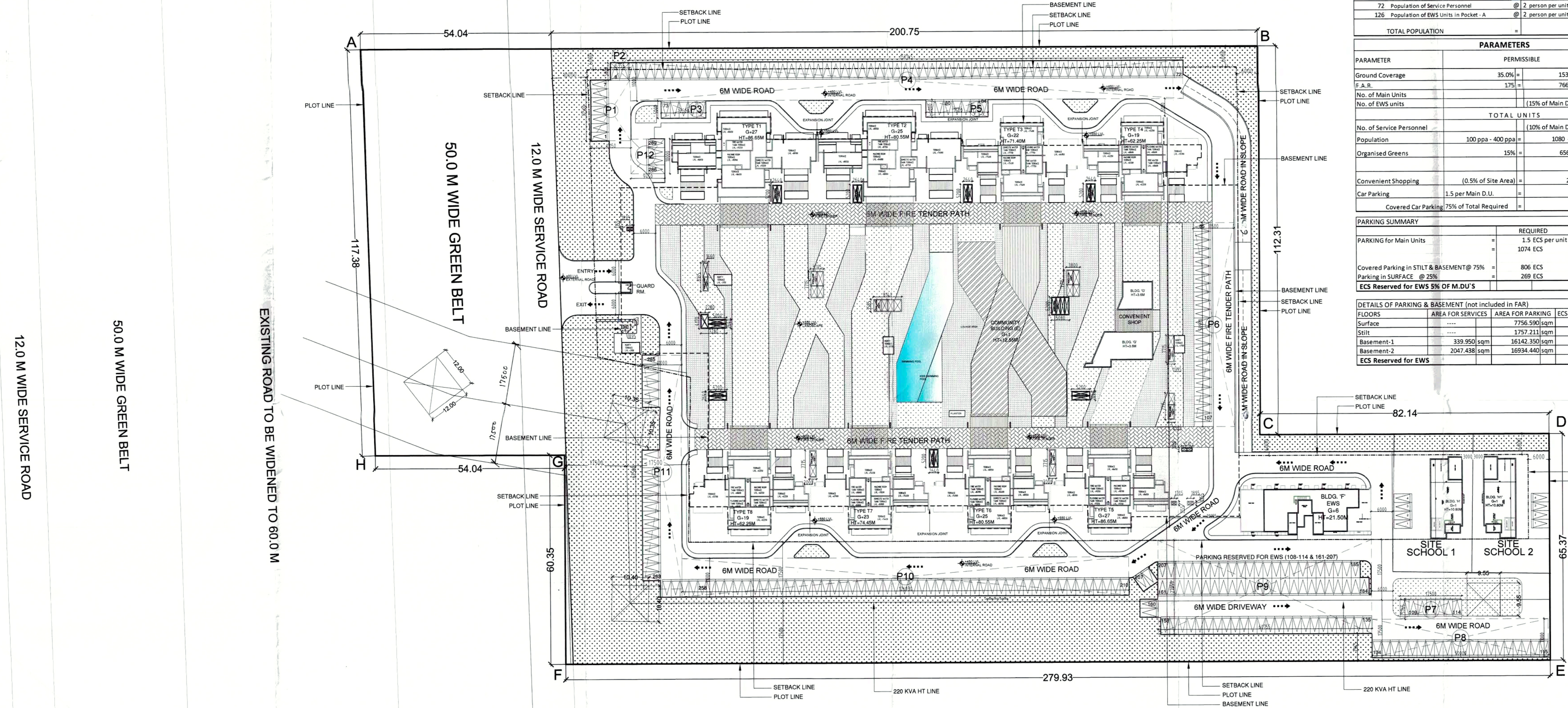

Building Block	No of Block	Description Layout	No of Floors	Height (No of Apartments)	Units of Dom.Serv.	Ground Coverage	Bldg FAR
TYPE T1	1	Type T1	G+27	84.43	104	874.477	13816.488
TYPE T2	1	Type T2	G+25	80.37	96	874.477	12783.972
TYPE T3	1	Type T3	G+22	71.40	84	637.605	7533.466
TYPE T4	1	Type T4	G+19	62.25	72	637.605	6486.241
TYPE T5	1	Type T5	G+27	84.43	104	637.605	9223.841
TYPE T6	1	Type T6	G+26	80.35	96	637.605	8542.661
TYPE T7	1	Type T7	G+23	74.43	88	637.605	7860.541
TYPE T8	1	Type T8	G+19	62.25	72	637.605	6486.241
Bldg E	1	Community Building	G+1	12.55	-	997.180	774.490
Bldg F	1	EWS Housing	G+8	21.30	126	494.300	2877.590
Bldg G	1	Convenient Shopping	G	3.80	-	218.707	218.720
Bldg H	1	Nursery School	G+1	8.05	-	214.108	-
Bldg I	1	Nursery School	G+1	8.05	-	214.108	-
Stilt						2488.972	-
LT room						25.000	-
TOTAL		MAIN DWELLING UNITS			716		
		TOTAL DWELLING UNITS = MAIN DUS + EWS UN			842		

PARKING CALCULATIONS			
Required @ 1.5 ECS for main DUs		1074.000	1074
Minimum Covered ECS required @ 75%			806
Stilt area			225.429
Stilt area in Tower Type T1 (A)			226.069
Stilt area in Tower Type T2 (B)			138.735
Stilt area in Tower Type T3 (C)			138.735
Stilt area in Tower Type T4 (D)			138.735
Stilt area in Tower Type T5 (E)			138.735
Stilt area in Tower Type T6 (F)			138.735
Stilt area in Tower Type T7 (G)			138.735
Stilt area in Tower Type T8 (H)			138.735
Community building stilt area			473.303
TOTAL STILT AREA			1187.211
Basement Area		16142.350	
Level 1 (BASEMENT)		16934.440	
Level 2 (BASEMENT)		33076.790	
PARKING PROVISIONS			845
Basement ECS @ 35 sqm/ECS			807
Provided covered parking in basement			58
Covered Surface ECS @ 30 sqm/ECS			59
Provided covered parking in stilt		7756.590	310
Open Surface ECS @ 25sqm/ECS			289
Provided parking in surface			1154
Total Parking provisions			841
RESERVED CAR PARK FOR EWS			54

Towers and Buildings FAR Chart												
Floor	TYPE T1 (A)	TYPE T2 (B)	TYPE T3 (C)	TYPE T4 (D)	TYPE T5 (E)	TYPE T6 (F)	TYPE T7 (G)	TYPE T8 (H)	Bldg E (Community Building)	Bldg F (EWS)	Bldg G (Convenient Shopping)	
27th Floor	310.782				240.640							
26th Floor	407.225				273.318							
25th Floor	515.938	310.782			341.075	240.640						
24th Floor	515.938	407.225			341.075	273.318						
23th Floor	515.938	515.938			341.075	341.075	240.640					
22th Floor	515.938	515.938	240.640		341.075	341.075	273.318					
21th Floor	515.938	515.938	273.318		341.075	341.075	341.075					
20th Floor	515.938	515.938	341.075		341.075	341.075	341.075					
19th Floor	515.938	515.938	341.075	240.640	341.075	341.075	341.075	240.640				
18th Floor	515.938	515.938	341.075	273.318	341.075	341.075	341.075	273.318				
17th Floor	515.938	515.938	341.075	341.075	341.075	341.075	341.075	341.075				
16th Floor	515.938	515.938	341.075	341.075	341.075	341.075	341.075	341.075				
15th Floor	515.938	515.938	341.075	341.075	341.075	341.075	341.075	341.075				
14th Floor	515.938	515.938	341.075	341.075	341.075	341.075	341.075	341.075				
13th Floor	515.938	515.938	341.075	341.075	341.075	341.075	341.075	341.075				
12th Floor	515.938	515.938	341.075	341.075	341.075	341.075	341.075	341.075				
11th Floor	515.938	515.938	341.075	341.075	341.075	341.075	341.075	341.075				
10th Floor	515.938	515.938	341.075	341.075	341.075	341.075	341.075	341.075				
9th Floor	515.938	515.938	341.075	341.075	341.075	341.075	341.075	341.075				
8th Floor	515.938	515.938	341.075	341.075	341.075	341.075	341.075	341.075				
7th Floor	515.938	515.938	341.075	341.075	341.075	341.075	341.075	341.075				
6th Floor	515.938	515.938	341.075	341.075	341.075	341.075	341.075	341.075				
5th Floor	515.938	515.938	341.075	341.075	341.075	341.075	341.075	341.075				
4th Floor	515.938	515.938	341.075	341.075	341.075	341.075	341.075	341.075				
3rd Floor	515.938	515.938	341.075	341.075	341.075	341.075	341.075	341.075				
2nd Floor	515.938	515.938	341.075	341.075	341.075	341.075	341.075	341.075				
1st Floor	403.711	403.711	285.328	285.328	285.328	285.328	285.328	285.328	503.330			
Stilt/Ground Floor	312.282	311.872	239.755	239.755	239.755	239.755	239.755	239.755	271.160	448.740	218.720	
Total	13616.488	12763.972	7518.466	6486.241	9224.841	8542.681	7860.541	6486.241	774.480	2877.590	218.720	
No. of Blocks	1	1	1	1	1	1	1	1	1	1	1	
Total FAR	13616.488	12763.972	7518.466	6486.241	9224.841	8542.681	7860.541	6486.241	774.480	2877.590	218.720	
Total FAR of all Residential Towers											SOMY.	76611.341

Signature and Seal of Architect
 S. Prakash
 Registration No. 10110/2005
 Designation: Architect
 Address: 101, Indraprastha, New Delhi - 110 025

DRG. NO. ILD-101

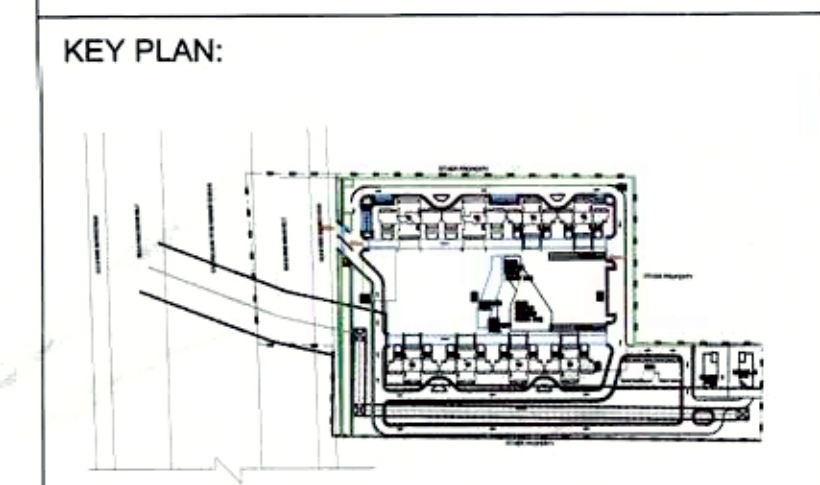

OWNER:
 SH. BRUJESH AND OTHERS IN COLLABORATION WITH INTERNATIONAL LAND DEVELOPERS PVT. LTD.

ARCHITECT:
 DPA DESIGNPLUS ARCHITECTURE

145-E, OKHLA INDUSTRIAL ESTATE, PHASE-III, NEW DELHI - 110 020, INDIA.
 PH. 41613854, 41613855, 32828023 & 32828024.
 FAX. 26842171 www.dpaonline.com

PROJECT TITLE:
 PROPOSED BUILDING PLAN OF GROUP HOUSING SCHEME MEASURING 11.6125 ACRES (LICENCE NO.44 OF 2013 DATED 04.06.2013)
 IN SECTOR 33, SONHA, BEING DEVELOPED BY SH. BRUJESH AND OTHERS IN COLLABORATION WITH INTERNATIONAL LAND DEVELOPERS PVT. LTD.

DRAWING TITLE:
 SITE PLAN

Scale: 1:500@A0 DRG. NO. ILD-101

Date: 14.05.2014

SIGNATURE & SEAL OF ARCHITECT
 S. Prakash
 Registration No. 10110/2005
 Designation: Architect
 Address: 101, Indraprastha, New Delhi - 110 025

SIGNATURE OF OWNER