

ROAD

SECTOR 34

Munir
Executive Engineer
H.S.V.P. Division No. 1
ROHTAK

Semiraj Paw Estimach

Superintending Engineer
H.S.V.P. Circle, Rohtak

Checked subject to conditions
In forwarding letter No. 2233/872
D. 23/11/87 and notes
attached with the estimate

Superintending Engineer (HQ)
for Chief Engineer H.S.V.P.

Legend
Road center
Direction of flow/slope
Proposed Road center level 100.25

Schematic Diagram
222.5
Proposed Road center level

CLIENT: Informage Realty Pvt. Ltd.
Project No. 81/187/84
Design No. 158/11

Approved by:
Director/Authority

For Informage Realty Pvt. Ltd.
Semiraj Paw
Director/Authority

Item No.	Description	Quantity	Rate	Total
1
2
3
4
5
6
7
8
9
10
11
12
13
14
15
16
17
18
19
20
21
22
23
24
25
26
27
28
29
30
31
32
33
34
35
36
37
38
39
40
41
42
43
44
45
46
47
48
49
50
51
52
53
54
55
56
57
58
59
60
61
62
63
64
65
66
67
68
69
70
71
72
73
74
75
76
77
78
79
80
81
82
83
84
85
86
87
88
89
90
91
92
93
94
95
96
97
98
99
100

Area	Description	Area (sq. m)
1
2
3
4
5
6
7
8
9
10
11
12
13
14
15
16
17
18
19
20
21
22
23
24
25
26
27
28
29
30
31
32
33
34
35
36
37
38
39
40
41
42
43
44
45
46
47
48
49
50
51
52
53
54
55
56
57
58
59
60
61
62
63
64
65
66
67
68
69
70
71
72
73
74
75
76
77
78
79
80
81
82
83
84
85
86
87
88
89
90
91
92
93
94
95
96
97
98
99
100

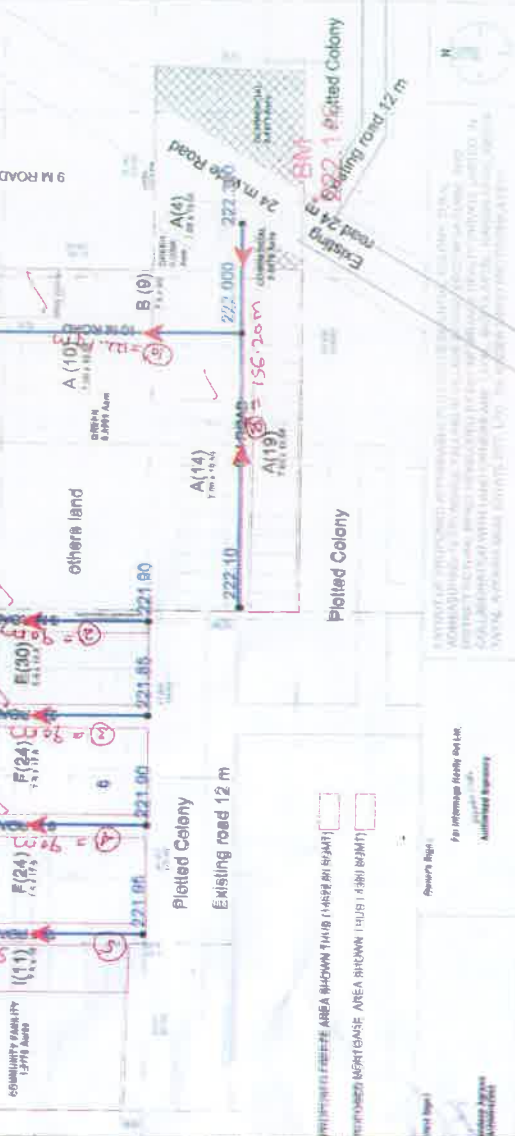

For Informage Realty Pvt. Ltd.
Semiraj Paw
Director/Auth. Signatory

Plot shown in FREE-FR AREA SHOWN THIS (1:480) IN PLAN
MORTGAGED MORTGAGE AREA SHOWN (1:150) (1:30) IN PLAN

Author's Sign
For Informage Realty Pvt. Ltd.
Authorized Signatory

INFORMAGE REALTY PRIVATE LIMITED
ROHTAK

Sl. No.	Particulars	Amount
1
2
3
4
5
6
7
8
9
10
11
12
13
14
15
16
17
18
19
20
21
22
23
24
25
26
27
28
29
30
31
32
33
34
35
36
37
38
39
40
41
42
43
44
45
46
47
48
49
50

Approved by: _____
Director/Authority

Project No. 81/187/84
Design No. 158/11

At Informage Realty Private Limited, Rohtak, Haryana, India.
Date: 23/11/87.
As per the conditions of the contract.
For Informage Realty Pvt. Ltd.



SECTOR 34

Item	Quantity	Unit	Rate	Amount
1	1.00	km	1000.00	1000.00
2	2.00	km	1500.00	3000.00
3	3.00	km	2000.00	6000.00
4	4.00	km	2500.00	10000.00
5	5.00	km	3000.00	15000.00
6	6.00	km	3500.00	21000.00
7	7.00	km	4000.00	28000.00
8	8.00	km	4500.00	36000.00
9	9.00	km	5000.00	45000.00
10	10.00	km	5500.00	55000.00
11	11.00	km	6000.00	66000.00
12	12.00	km	6500.00	78000.00
13	13.00	km	7000.00	91000.00
14	14.00	km	7500.00	105000.00
15	15.00	km	8000.00	120000.00
16	16.00	km	8500.00	136000.00
17	17.00	km	9000.00	153000.00
18	18.00	km	9500.00	171000.00
19	19.00	km	10000.00	190000.00
20	20.00	km	10500.00	210000.00
21	21.00	km	11000.00	231000.00
22	22.00	km	11500.00	253000.00
23	23.00	km	12000.00	276000.00
24	24.00	km	12500.00	300000.00
25	25.00	km	13000.00	325000.00
26	26.00	km	13500.00	351000.00
27	27.00	km	14000.00	378000.00
28	28.00	km	14500.00	405000.00
29	29.00	km	15000.00	433000.00
30	30.00	km	15500.00	462000.00
31	31.00	km	16000.00	492000.00
32	32.00	km	16500.00	523000.00
33	33.00	km	17000.00	555000.00
34	34.00	km	17500.00	588000.00
35	35.00	km	18000.00	622000.00
36	36.00	km	18500.00	657000.00
37	37.00	km	19000.00	693000.00
38	38.00	km	19500.00	730000.00
39	39.00	km	20000.00	768000.00
40	40.00	km	20500.00	807000.00
41	41.00	km	21000.00	847000.00
42	42.00	km	21500.00	888000.00
43	43.00	km	22000.00	930000.00
44	44.00	km	22500.00	973000.00
45	45.00	km	23000.00	1017000.00
46	46.00	km	23500.00	1062000.00
47	47.00	km	24000.00	1108000.00
48	48.00	km	24500.00	1155000.00
49	49.00	km	25000.00	1203000.00
50	50.00	km	25500.00	1252000.00
51	51.00	km	26000.00	1302000.00
52	52.00	km	26500.00	1353000.00
53	53.00	km	27000.00	1405000.00
54	54.00	km	27500.00	1458000.00
55	55.00	km	28000.00	1512000.00
56	56.00	km	28500.00	1567000.00
57	57.00	km	29000.00	1623000.00
58	58.00	km	29500.00	1680000.00
59	59.00	km	30000.00	1738000.00
60	60.00	km	30500.00	1797000.00
61	61.00	km	31000.00	1857000.00
62	62.00	km	31500.00	1918000.00
63	63.00	km	32000.00	1980000.00
64	64.00	km	32500.00	2043000.00
65	65.00	km	33000.00	2107000.00
66	66.00	km	33500.00	2172000.00
67	67.00	km	34000.00	2238000.00
68	68.00	km	34500.00	2305000.00
69	69.00	km	35000.00	2373000.00
70	70.00	km	35500.00	2442000.00
71	71.00	km	36000.00	2512000.00
72	72.00	km	36500.00	2583000.00
73	73.00	km	37000.00	2655000.00
74	74.00	km	37500.00	2728000.00
75	75.00	km	38000.00	2802000.00
76	76.00	km	38500.00	2877000.00
77	77.00	km	39000.00	2953000.00
78	78.00	km	39500.00	3030000.00
79	79.00	km	40000.00	3108000.00
80	80.00	km	40500.00	3187000.00
81	81.00	km	41000.00	3267000.00
82	82.00	km	41500.00	3348000.00
83	83.00	km	42000.00	3430000.00
84	84.00	km	42500.00	3513000.00
85	85.00	km	43000.00	3597000.00
86	86.00	km	43500.00	3682000.00
87	87.00	km	44000.00	3768000.00
88	88.00	km	44500.00	3855000.00
89	89.00	km	45000.00	3943000.00
90	90.00	km	45500.00	4032000.00
91	91.00	km	46000.00	4122000.00
92	92.00	km	46500.00	4213000.00
93	93.00	km	47000.00	4305000.00
94	94.00	km	47500.00	4398000.00
95	95.00	km	48000.00	4492000.00
96	96.00	km	48500.00	4587000.00
97	97.00	km	49000.00	4683000.00
98	98.00	km	49500.00	4780000.00
99	99.00	km	50000.00	4878000.00
100	100.00	km	50500.00	4977000.00



LEGEND

UNDERGROUND TANK	□
OVERHEAD TANK	○
JUNCTION	●
NODE NUMBER	417
LENGTH/DIAMETER	300 mm / 100 mm
100MM D.I DISTRIBUTION PIPE	—
150 MM D PIPE	—
BLUIDE VALVE	⊕
AIR RELEASE VALVE	⊖
FIRE HYDRANT	⊗
DRAIN VALVE	⊙
TWO WAY CHECK ROAD CROSSING	—
TUBEWELL	⊕
50 LBS PRESS. W/LS FROM TUBEWELL TO LOT	—
25 LBS PRESS. W/LS FROM TUBEWELL TO LOT	—

FOR INFORMATION ONLY
 PREPARED FREEZE AREA BROWN TUBES (4500 SQ.MT)
 PREPARED WASTE AREA BROWN TUBES (4500 SQ.MT)

FOR INFORMATION ONLY
 For Informage Realty Pvt Ltd
 Director/Author Signatory

DATE: 15/06/2018
 TIME: 10:00 AM
 PROJECT NO: 15/06/2018
 DRAWING NO: 15/06/2018
 SHEET NO: 15/06/2018

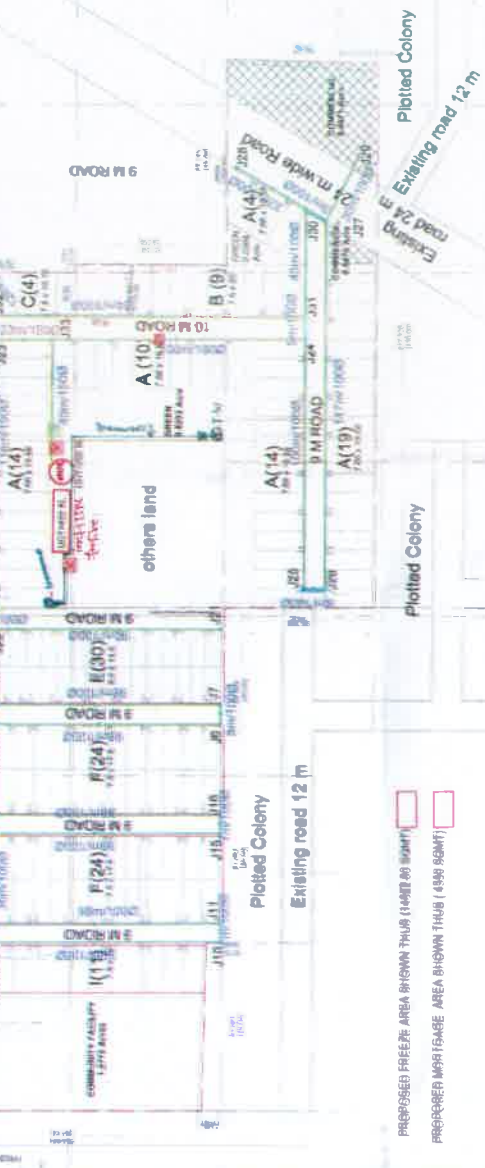

LAYOUT OF UNDEPOSED APPROPRIABLE PLOTS ARE NOT RELEVANT FOR THIS PROJECT. ADDRESSING TO BE ADDED. FALLING IN VILLAGE DE-AD ADDRESSING TO BE ADDED. DISTRICT REGISTRAR BEING DECIDED BY HIS RESOLVE POWER PROVIDED BY THE GOVERNMENT WITH LIMITED RESERVE AND TAYAL. SINGAPORE, SINGAPORE. TOTAL AREA OF THE PLOT: 0.142 HECTARE (1400 SQ.M).

DATE: 15/06/2018
 TIME: 10:00 AM
 PROJECT NO: 15/06/2018
 DRAWING NO: 15/06/2018
 SHEET NO: 15/06/2018

For Informage Realty Pvt Ltd
 Director/Author Signatory

Recycle water



Checked subject to comments
In forwarding letter No. 2/3872
Dt. 28/11/2018 and notes
attached with the estimate

Superintending Engineer (HQ),
or Chief Engineer HSVP,
Panchkula



LEGEND

- STP
- JUNCTION
- NODE NUMBER
- LENGTH/DIAMETER
- 50MM MDPE PIPE
- SLUICE VALVE
- AIR RELEASE VALVE
- DRAIN VALVE
- RCC PIPE

CLIENT
Informage Realty Pvt. Ltd.
A-403, Bhawan Apartment,
Plot No. 31, Sector 34,
Gurgaon (HR)-122001

Allocatable Plotted Colony Under Design Order
Dated 10th 2016 measuring area 12.776 Acres
under License No. 43 of 2016 dated 19.04.2018
Issued in exercise of power of Village-Block, Sector-34,
Gurgaon, Haryana, Government of India.
This plan is sanctioned by Informage Realty Pvt. Ltd.

PROJECT INFORMATION	
PROJECT NAME	SECTOR 34
PROJECT NO.	DCR/IMP/ROH/2018/00-09
DATE OF SANCTION	19/04/2018
SCALE	AS SHOWN
DATE OF ISSUE	28/11/2018
BY	[Signature]
FOR	INFORMAGE REALTY PRIVATE LIMITED

ITEM	DESCRIPTION	UNIT	QUANTITY	RATE	AMOUNT
1	Supply of 100mm dia. 100m length of 50mm MDPE pipe	m	100	150	15000
2	Supply of 100mm dia. 100m length of 50mm MDPE pipe	m	100	150	15000
3	Supply of 100mm dia. 100m length of 50mm MDPE pipe	m	100	150	15000
4	Supply of 100mm dia. 100m length of 50mm MDPE pipe	m	100	150	15000
5	Supply of 100mm dia. 100m length of 50mm MDPE pipe	m	100	150	15000
6	Supply of 100mm dia. 100m length of 50mm MDPE pipe	m	100	150	15000
7	Supply of 100mm dia. 100m length of 50mm MDPE pipe	m	100	150	15000
8	Supply of 100mm dia. 100m length of 50mm MDPE pipe	m	100	150	15000
9	Supply of 100mm dia. 100m length of 50mm MDPE pipe	m	100	150	15000
10	Supply of 100mm dia. 100m length of 50mm MDPE pipe	m	100	150	15000

ITEM	DESCRIPTION	UNIT	QUANTITY	RATE	AMOUNT
1	Supply of 100mm dia. 100m length of 50mm MDPE pipe	m	100	150	15000
2	Supply of 100mm dia. 100m length of 50mm MDPE pipe	m	100	150	15000
3	Supply of 100mm dia. 100m length of 50mm MDPE pipe	m	100	150	15000
4	Supply of 100mm dia. 100m length of 50mm MDPE pipe	m	100	150	15000
5	Supply of 100mm dia. 100m length of 50mm MDPE pipe	m	100	150	15000
6	Supply of 100mm dia. 100m length of 50mm MDPE pipe	m	100	150	15000
7	Supply of 100mm dia. 100m length of 50mm MDPE pipe	m	100	150	15000
8	Supply of 100mm dia. 100m length of 50mm MDPE pipe	m	100	150	15000
9	Supply of 100mm dia. 100m length of 50mm MDPE pipe	m	100	150	15000
10	Supply of 100mm dia. 100m length of 50mm MDPE pipe	m	100	150	15000

1. The proposed scheme is for the supply of recycled water to the plots in Sector 34, Gurgaon, Haryana. The scheme is proposed to be executed in two phases. The first phase is for the supply of recycled water to the plots in the first phase of the colony. The second phase is for the supply of recycled water to the plots in the second phase of the colony. The scheme is proposed to be executed in two phases. The first phase is for the supply of recycled water to the plots in the first phase of the colony. The second phase is for the supply of recycled water to the plots in the second phase of the colony.

SECTOR 34

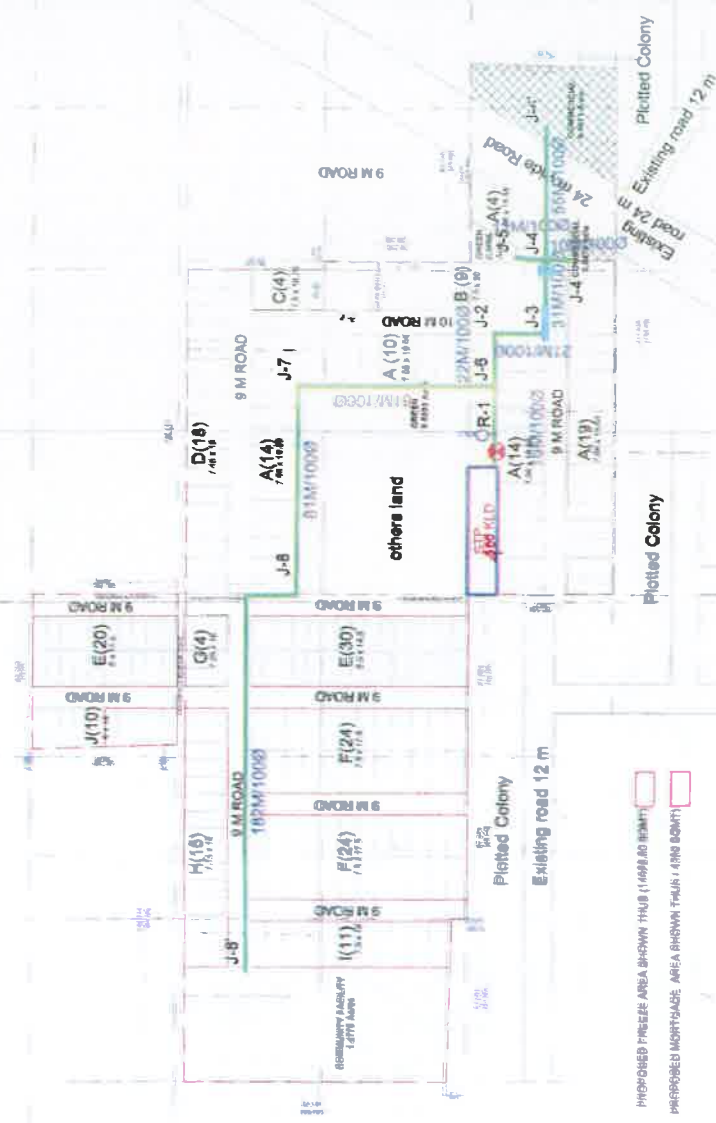

PROPOSED PIPES AREA SHOWN THIS (14998.80 SQM)
PROPOSED MORTGAGE AREA SHOWN THIS (4280 SQM)

For Informage Realty Pvt. Ltd.
[Signature]

Director/ Auth. Signatory

For INFORMAGE REALTY PRIVATE LIMITED
[Signature]

Director/Authorized Signatory

SEWERAGE

Executive Engineer
H.S.V.P. Division No. 1
ROHTAK

Legend

- Sewer Pipeline
- Sewer Manhole
- Sewer Chamber
- Sewer Arrow
- STP (50 KL/D)
- Sewer Ground Level
- Sewer Invert Level
- Length Chamber/Slope
- Sewer Connecting Level
- Sewer Node Number
- Card

Service Plan Extract
Superintending Engineer
H.P.V.P. Circle, Rohtak



For Informage Realty Pvt. Ltd.
Director/Author. Signatory

For Informage Realty Pvt. Ltd.
Director/Author. Signatory

Approved by
MHTAN
DRAWING NO. DCOR/REH/100/100/100
PROJECT PROPOSED SEWERAGE NETWORK

Node No.	Stationing	Chainage	Ground Level	Invert Level	Slope	Length	Area	Volume
1	0+00	0+00	10.00	9.50	0.00	0.00	0.00	0.00
2	0+10	0+10	10.00	9.50	0.00	0.00	0.00	0.00
3	0+20	0+20	10.00	9.50	0.00	0.00	0.00	0.00
4	0+30	0+30	10.00	9.50	0.00	0.00	0.00	0.00
5	0+40	0+40	10.00	9.50	0.00	0.00	0.00	0.00
6	0+50	0+50	10.00	9.50	0.00	0.00	0.00	0.00
7	0+60	0+60	10.00	9.50	0.00	0.00	0.00	0.00
8	0+70	0+70	10.00	9.50	0.00	0.00	0.00	0.00
9	0+80	0+80	10.00	9.50	0.00	0.00	0.00	0.00
10	0+90	0+90	10.00	9.50	0.00	0.00	0.00	0.00
11	1+00	1+00	10.00	9.50	0.00	0.00	0.00	0.00
12	1+10	1+10	10.00	9.50	0.00	0.00	0.00	0.00
13	1+20	1+20	10.00	9.50	0.00	0.00	0.00	0.00
14	1+30	1+30	10.00	9.50	0.00	0.00	0.00	0.00
15	1+40	1+40	10.00	9.50	0.00	0.00	0.00	0.00
16	1+50	1+50	10.00	9.50	0.00	0.00	0.00	0.00
17	1+60	1+60	10.00	9.50	0.00	0.00	0.00	0.00
18	1+70	1+70	10.00	9.50	0.00	0.00	0.00	0.00
19	1+80	1+80	10.00	9.50	0.00	0.00	0.00	0.00
20	1+90	1+90	10.00	9.50	0.00	0.00	0.00	0.00

Checked by
in forwarding
Date: 28/11/2018
attached with the plan

Supervisor
Chief Engineer
ROHTAK

SECTOR 34

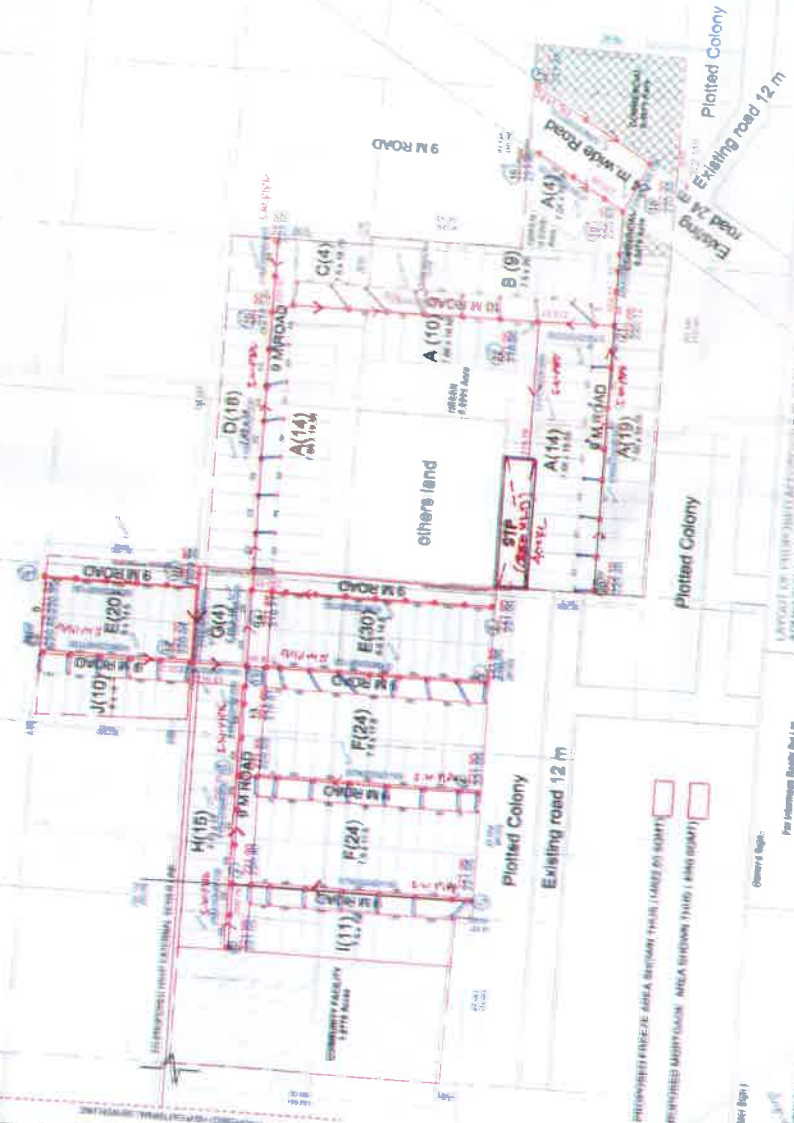

LAYOUT OF PROPOSED SEWERAGE NETWORK
PREPARED BY THE ENGINEER IN CHARGE
FOR THE SECTOR 34, ROHTAK
ON BEHALF OF THE DEVELOPER
FOR INFORMATION OF THE AUTHORITY
TAXAL, ROHTAK (STATE) PVT. LTD.

For Informage Realty Pvt. Ltd.
Director/Author. Signatory

For Informage Realty Pvt. Ltd.
Director/Author. Signatory

For Informage Realty Pvt. Ltd.
Director/Author. Signatory



Executive Engineer
H.S. VP, Division No. 3
ROHTAK

Legend

- Drain Pipeline
- Manhole
- Chamber
- Arrow
- Direction / Direction of flow

Ground Level
Import Level
Length/Chamber/Height
Connecting Level
Manhole Number

200.75
108.78
62M x 300/200
200.75
15

Sanitation Division
Superintending Engineer
ASVP Circle, Rohtak

Length/Chamber/Height
Import Level
Connecting Level

201.45
201.86
6m x 300/200
201.45

4x6 RCC NP3 Pipe

For Informatage Realty Pvt. Ltd.
Director of Public Health

CLIENT
Informatage Realty Pvt. Ltd.
A-65, Phase II, Sector 27
Gurgaon - 122001

Address: Plotting Colony under Dham Diyalpur
Block AVNO-001, near 5000 area, 12/25 Acres
Upper Plot No. 45 of 5011 dated 19/12/2018
Lower Plot No. 46 of 5011 dated 19/12/2018
To be used for the purpose of the project
As per request for informatage Realty Pvt. Ltd.

Sl. No.	Description	Area (sq. m)	Volume (cu. m)
1	Plotting Colony	12000	12000
2	Plotting Colony	12000	12000
3	Plotting Colony	12000	12000
4	Plotting Colony	12000	12000
5	Plotting Colony	12000	12000
6	Plotting Colony	12000	12000
7	Plotting Colony	12000	12000
8	Plotting Colony	12000	12000
9	Plotting Colony	12000	12000
10	Plotting Colony	12000	12000

Sl. No.	Area (sq. m)	Volume (cu. m)
1	12000	12000
2	12000	12000
3	12000	12000
4	12000	12000
5	12000	12000
6	12000	12000
7	12000	12000
8	12000	12000
9	12000	12000
10	12000	12000

Sl. No.	Area (sq. m)	Volume (cu. m)
1	12000	12000
2	12000	12000
3	12000	12000
4	12000	12000
5	12000	12000
6	12000	12000
7	12000	12000
8	12000	12000
9	12000	12000
10	12000	12000

As per plan shown in 'A' of the plan 'D' is correct.

SECTOR 34

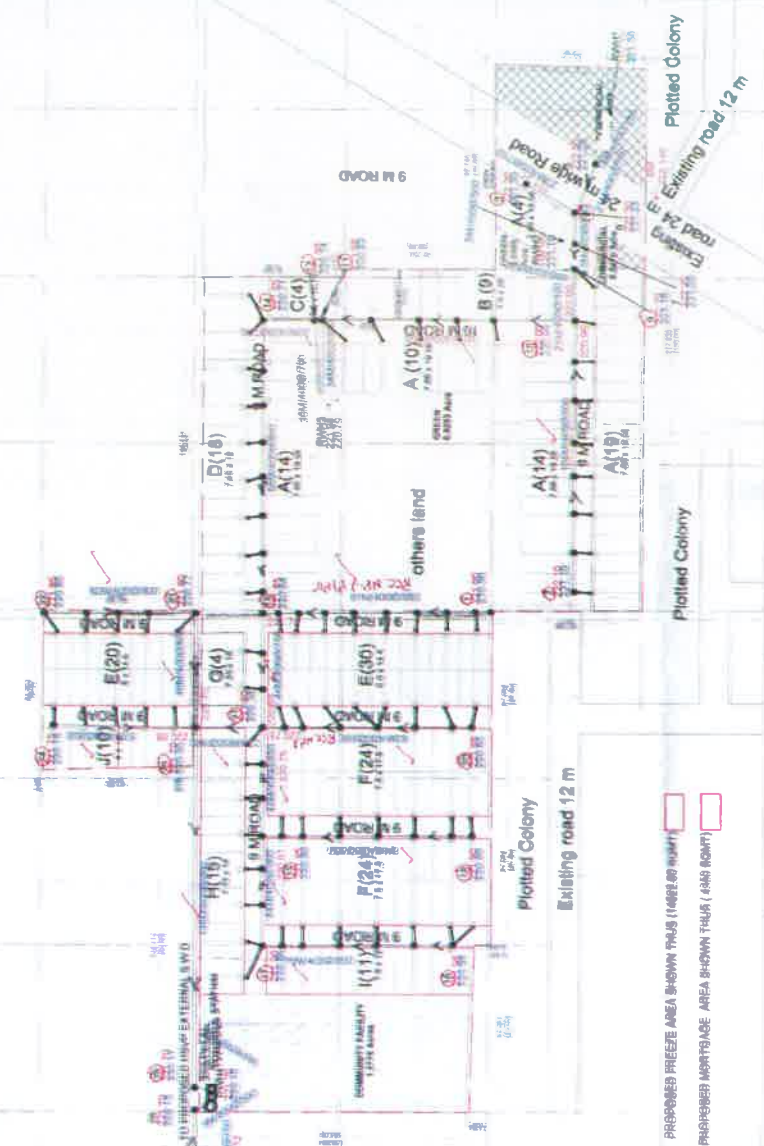

Plotted Colony
Existing road 12 m
Existing road 24 m
Existing road 12 m
9 M ROAD
24 M ROAD
others land
Plotted Colony
Plotted Colony

PROPOSED FREEZE AREA SHOWN THIS (1482.00 SQM)
PROPOSED MORTGAGE AREA SHOWN THIS (486 SQM)

For Informatage Realty Pvt. Ltd.
Director of Public Health

For Informatage Realty Pvt. Ltd.
Additional Engineer

Director of Public Health

Land to be transferred of community centre in favor Town Planning Department as per Rules and Regulations

SECTOR 34

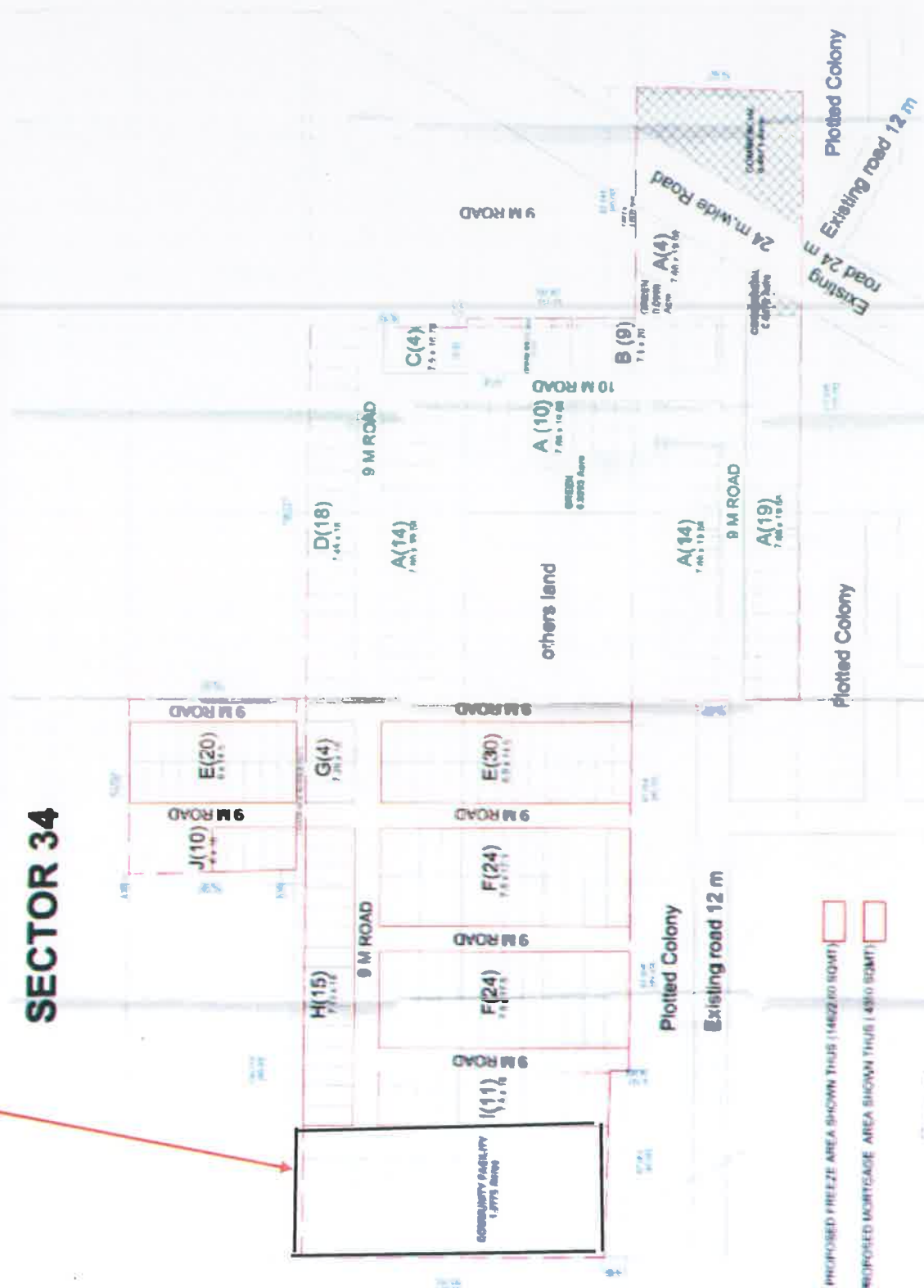

PROPOSED FREEZE AREA SHOWN THUS (1462/20 SQMT)
PROPOSED MORTGAGE AREA SHOWN THUS (430/02 SQMT)

For Information: Realty Pvt. Ltd.
Ray
Director/Auth. Signatory

SECTOR 34

Type	Length	Width	Area	No. of Posts	Total Area (sq. meters)	
A	18.58	7.05	131.00	10	1310.00	
B	20.00	7.50	150.00	9	1350.00	
C	16.75	7.50	125.63	8	1005.00	
D	18.00	7.65	137.70	11	1311.00	
E	14.00	6.00	84.00	10	840.00	
F	17.50	7.50	131.25	10	1312.50	
G	18.00	7.25	130.50	11	1234.50	
H	16.00	7.13	114.08	10	1140.80	
I	19.00	6.00	114.00	11	1026.00	
J	19.00	3.30	62.70	11	627.00	
Total (including roads)					233	24850.17

LEGEND	
	Street Light Pole (Pole height above ground 6 meters with LED Lights 43 Watts)
	Street Light Cable
	Feeder Pillar

CLIENT
Infintimage Realty Pvt. Ltd
 2nd Floor, Infintimage Building,
 Plot No. 81, Sector 34,
 Gurugram-122011

ROHTAK
 ELECTRICAL (STREET LIGHT POLE)

PROJAWIS NO.
 DCC/PRP/ROH/2016D-109

SCALE
 1:1000

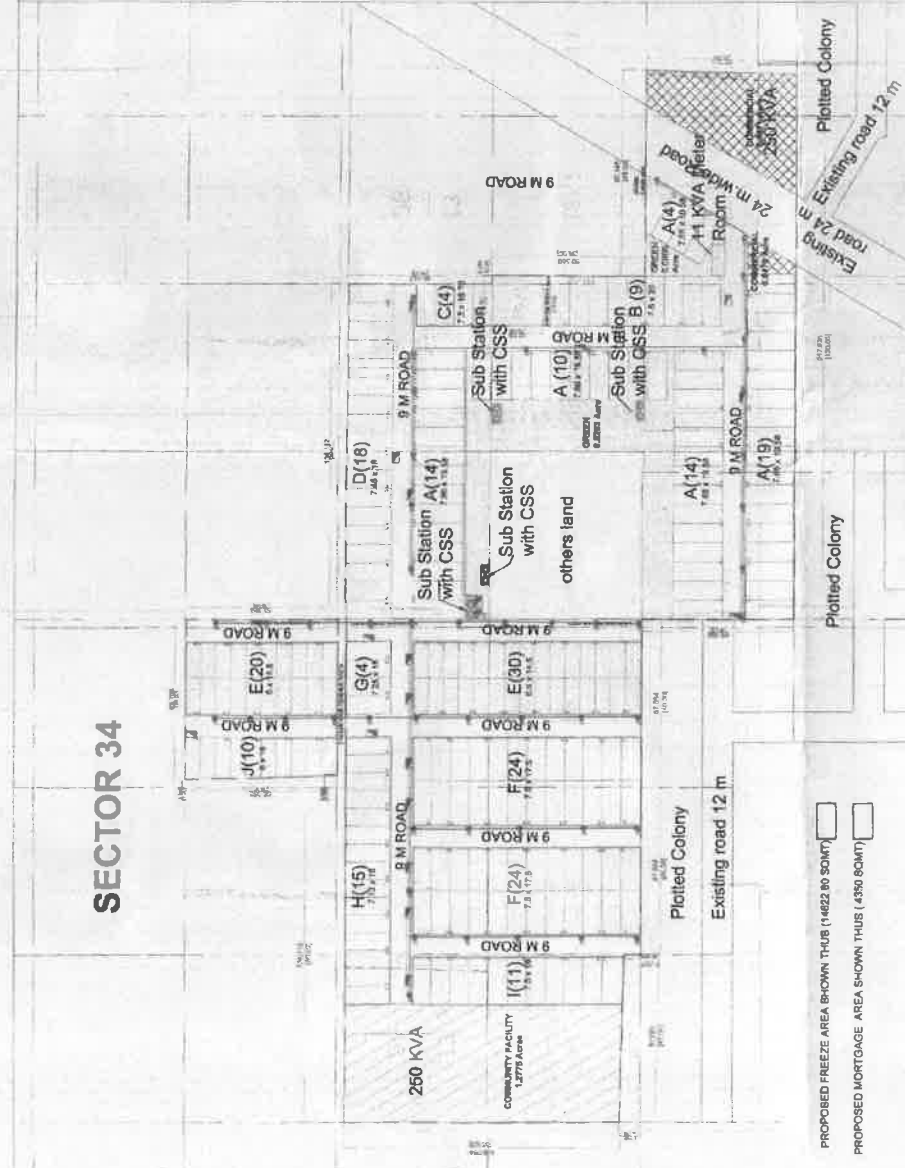

Proposed Freeze Area (14622.80 Sqm)

Proposed Mortgage Area (4350 Sqm)

Owner's Sign:
 For Infintimage Realty Pvt. Ltd.
 2nd Floor, Infintimage Building,
 Gurugram-122011

Architect's Sign:
 For Infintimage Realty Pvt. Ltd., TOTAL AREA BEING 12.75 ACRES, FALLING IN VILLAGE BEHAR, SECTOR 34, TENDU, AND DISTRICT ROHTAK, BEING DEVELOPED BY M3 INFORCHARGE REALTY PRIVATE LIMITED, IN COLLABORATION WITH LAND OWNERS ANIL TAYAL, SWATI TAYAL, HARSH TAYAL, GRIETA TAYAL, ANOOPINA REAL ESTATE PVT. LTD., RAJENDER JINCH AND PROVILA DEVI.

(Vertical text block containing detailed technical notes and specifications for the electrical layout.)