

KEY PLAN

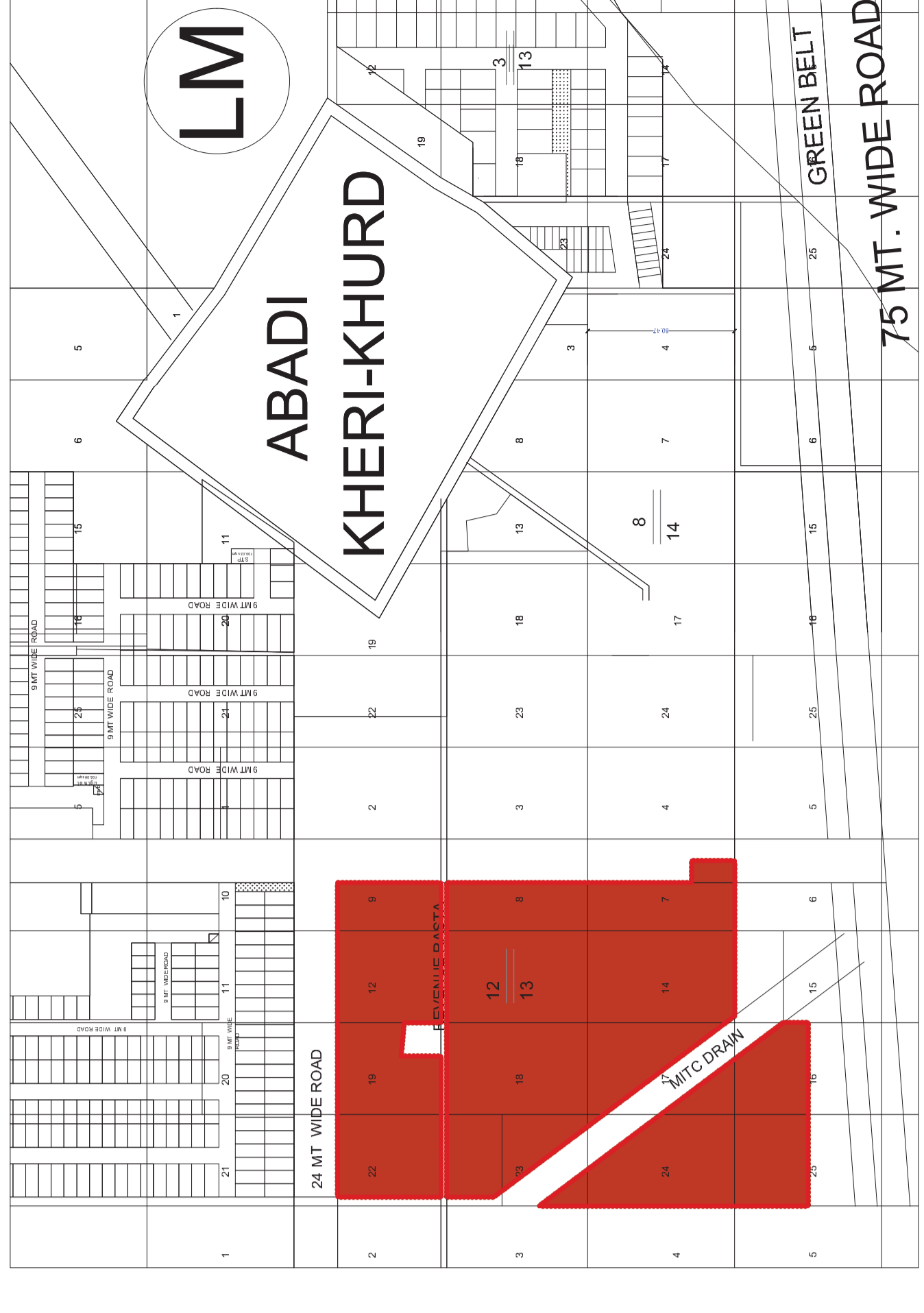

PROPOSED 9.31875 ACRE PROJECT UNDER DDJAY, SECTOR -83, FARIDABAD

AREA STATEMENT

| DESCRIPTION | Acres | SOM |
|--|---------|----------|
| TOTAL SITE AREA | 9.31875 | 37711.58 |
| PERMISSIBLE MAX AREA FOR RESIDENTIAL <COMMERCIAL (65%) | 6.057 | 24522.53 |
| PERMISSIBLE MAX AREA COMMERCIAL (4%) | 0.373 | 1508.46 |
| PERMISSIBLE AREA FOR COMMERCIAL (63%) | 5.684 | 23004.07 |
| AREA PROPOSED FOR COMMERCIAL (4%) | 0.373 | 1508.46 |
| AREA PROPOSED FOR RESIDENTIAL PLOTS(50.27%) | 4.685 | 18960.07 |
| TOTAL AREA PROPOSED UNDER COMMERCIAL + RESIDENTIAL PLOTS (54.27%) | 5.058 | 20469.13 |
| PERMISSIBLE RESIDENTIAL PLOT (MINIMUM/MAXIMUM) | 1.66 | 276 |
| ACHIEVED DENSITY (PPA) | | 240 PPA |
| 50% RESIDENTIAL AREA FROZEN BY THE DEPARTMENT UNDER DDJAY | 2.343 | 9480.33 |
| RESIDENTIAL AREA FROZEN BY THE DEPARTMENT UNDER DDJAY -2016(PROPOSED-50.43%) | 2.363 | 9562.69 |
| AREA REQD FOR THE TRANSFER OF 10% AREA OF THE LICENSED COLONY FREE OF COST TO THE GOVERNMENT FOR THE PROVISION OF COMMUNITY FACILITIES | 0.932 | 3771.16 |
| AREA PROPOSED FOR COMMUNITY FACILITIES(10%) | 0.932 | 3771.16 |
| AREA REQUIRED UNDER GREEN = 7.5% OF PLOT AREA | 0.6989 | 2828.37 |
| AREA PROPOSED UNDER GREEN (7.5%) | 0.6989 | 2828.37 |
| MINIMUM AREA REQ. IN SINGLE POKET UNDER CONSOLIDATED GREEN | 0.300 | 1214.06 |
| PROPOSED GREEN IN SINGLE POKET A | 0.468 | 1893.00 |
| PROPOSED NUMBER OF RESIDENTIAL PLOT | 166 | |

RESIDENTIAL PLOT AREA CALCULATIONS

| PLT TYPE | PLT NUMBERS | SHAPE | L | X | D | NO. OF PLOTS | AREA/PLT SOM | TOTAL PLOT AREA SOM |
|--------------|-------------|-----------|--------------------------------|---|-------|--------------|--------------|---------------------|
| A | A1-A12 | RECTANGLE | 13.06 | X | 7 | 12 | 91.42 | 1097.04 |
| | B1 | RECTANGLE | (19.90 X 7.40) - (1.53 X 1.15) | X | 1 | 1 | 145.50 | 145.50 |
| B | B2-B26 | RECTANGLE | 19.90 | X | 7.4 | 25 | 147.26 | 3681.50 |
| | B3 | RECTANGLE | 19.95 | X | 7.4 | 16 | 147.63 | 2362.08 |
| | B4-B51 | AS/SITE | (15.74 X 7.40) - (1.41 X 1.06) | X | 1 | 1 | 114.99 | 114.99 |
| | C1-C15 | RECTANGLE | 15.74 | X | 7.40 | 8 | 116.48 | 931.81 |
| | C16-C18 | RECTANGLE | 13.00 | X | 7.00 | 15 | 91.00 | 1365.00 |
| | C19-C22 | RECTANGLE | 8.00 | X | 7.54 | 3 | 60.42 | 181.26 |
| | C23-C26 | RECTANGLE | 7.00 | X | 13.00 | 4 | 91.00 | 364.00 |
| C | C37 | TRAPEZOID | AREA PLINE | X | 13.00 | 14 | 127.00 | 1778.00 |
| | C38 | RECTANGLE | 9.58 | X | 15.41 | 1 | 142.08 | 142.08 |
| | C39-C51 | RECTANGLE | 7.00 | X | 15.41 | 13 | 107.47 | 1397.11 |
| | D1 | RECTANGLE | 7.18 | X | 16.59 | 1 | 119.12 | 119.12 |
| | D2-D32 | RECTANGLE | 7.12 | X | 13.06 | 31 | 92.99 | 2882.60 |
| D | D33 | TRAPEZOID | AREA PLINE | X | 13.06 | 1 | 127.35 | 127.35 |
| | E1-E3 | RECTANGLE | 7.09 | X | 15.70 | 3 | 111.31 | 333.94 |
| | F1-F16 | RECTANGLE | 7.06 | X | 20.65 | 16 | 145.79 | 2332.62 |
| TOTAL | | | | | | 166 | | 18960.67 |

50% RESIDENTIAL AREA FROZEN BY THE DEPARTMENT UNDER DDJAY

| PLT TYPE | PLT NUMBERS | SHAPE | L | X | D | NO. OF PLOTS | PLT AREA | PLOT AREA |
|--------------|-------------|-----------|------------|---|-------|--------------|----------|----------------|
| A | A2-A6 | RECTANGLE | 13.06 | X | 7 | 5 | 91.42 | 457.10 |
| | C1-C15 | RECTANGLE | 13.00 | X | 7.00 | 15 | 91.00 | 1365.00 |
| | C16-C18 | RECTANGLE | 8.00 | X | 7.34 | 3 | 59.42 | 178.26 |
| | C19-C22 | RECTANGLE | 8.00 | X | 13.00 | 4 | 104.00 | 416.00 |
| C | C23-C26 | RECTANGLE | 7.00 | X | 13.00 | 14 | 91.00 | 1274.00 |
| | C37 | TRAPEZOID | AREA PLINE | X | 13.00 | 1 | 142.08 | 142.08 |
| | C38 | RECTANGLE | 9.58 | X | 13.41 | 1 | 128.47 | 128.47 |
| | C39-C51 | RECTANGLE | 7.00 | X | 15.41 | 13 | 107.47 | 1397.11 |
| | D1 | RECTANGLE | 7.18 | X | 16.59 | 1 | 119.12 | 119.12 |
| | D2-D32 | RECTANGLE | 7.12 | X | 13.06 | 31 | 92.99 | 2882.60 |
| | E1-E3 | RECTANGLE | 7.12 | X | 13.06 | 3 | 92.99 | 282.87 |
| | F1-F16 | RECTANGLE | 7.06 | X | 20.65 | 16 | 145.79 | 2332.62 |
| TOTAL | | | | | | 92 | | 9562.69 |

COMMERCIAL PLOT AREA DETAIL

| PLT NO | SHAPE | L | X | B | PLT AREA sqm |
|--------|-----------|-------|---|-------|--------------|
| S1 | RECTANGLE | 17.00 | X | 88.73 | 1508.46 |

TOTAL AREA UNDER COMMERCIAL

TRANSFER OF 10% OF AREA OF LICENSED COLONY FREE OF COST TO THE GOVERNMENT FOR THE PROVISION OF COMMUNITY FACILITIES

| Community | As/Drawing | SHAPE | PLT DIMENSIONS | PLT AREA(SOM) |
|-----------|------------|--------------------|----------------|---------------|
| Community | As/Drawing | Area as per P-Line | | 3771.16 |

GREEN AREA CALCULATION

| PLT/POCKET | AREA PLINE | SOM |
|-------------------------------|----------------|----------------|
| AREA IN POKET - A | 1893.00 | 1893.00 |
| AREA IN POKET - B | 935.37 | 935.37 |
| TOTAL GREEN AREA = A+B | 2828.37 | 2828.37 |

AREA FOR MILK & VEGETABLE BOOTH

| SHAPE | PLT DIMENSIONS | PLT AREA(SOM) |
|-------|----------------|---------------|
| 5 | 5 X 5.5 | 27.5 |

POPULATION DENSITY CALCULATION

| NET PLANNED AREA | 9.31875 ACRES |
|----------------------------------|---------------|
| NUMBER OF PERSONS/ PLOT | 13.5 PERSONS |
| MINIMUM NUMBER OF PLOTS REQUIRED | 166 PLOTS |
| MAXIMUM NUMBER OF PLOTS REQUIRED | 276 PLOTS |
| PROPOSED NUMBER OF PLOTS | 166 PLOTS |
| ACHIEVED DENSITY | 240 PPA |

TOTAL PLOT CALCULATION

| BLOCK | NUMBER OF PLOTS |
|--------------|-----------------|
| A | 12 |
| B | 51 |
| C | 31 |
| D | 3 |
| E | 16 |
| TOTAL | 166 |

INTERNAL PLOT SEWER CHAMBERS TO BE CONSTRUCTED BY THE RESPECTIVE PLOT OWNER.



LEGEND :

| S. No. | SYMBOL | DESCRIPTION |
|--------|--------|---|
| 1. | --- | DOMESTIC WATER SUPPLY LINE |
| 2. | --- | RISEING MAIN LINE (FROM TWT TO U.G.T.) |
| 3. | --- | MUNICIPAL WATER SUPPLY LINE. |
| 4. | --- | RECYCLED WATER SUPPLY LINE FOR HORTICULTURE |
| 5. | ○ | PROPOSED TUBE WELL |
| 6. | ⊠ | MASONRY CHAMBER FOR ISOLATING VALVE |
| 7. | ⊗ | GARDEN HYDRANT |
| 8. | | |

LEGEND :

| S. No. | SYMBOL | DESCRIPTION |
|--------|--------|-------------------------|
| 1. | □ | CATCH PIT |
| 2. | --- | UNDER GROUND PIPE DRAIN |
| 3. | □ | BRANCH DRAIN CONNECTION |
| 4. | | |

LEGEND :

| S. No. | SYMBOL | DESCRIPTION |
|--------|--------|------------------------------------|
| 1. | □ | MANHOLE |
| 2. | --- | SEWER LINE |
| 3. | --- | BRANCH SEWER CONNECTION FROM PLOTS |
| 4. | --- | BYPASS SEWER LINE |
| 5. | --- | BRANCH SEWER CONNECTION |

SUBMISSION DRAWING

| | |
|--|----------------------------|
| DRAWING TITLE | DRG. NUMBER |
| SITE PLAN | S-04 |
| PROJECT TITLE : | |
| PROPOSED LAYOUT PLAN FOR AFFORDABLE PLOTTED COLONY UNDER DDJAY SCHEME FOR AN AREA MEASURING 9.31875 ACRE IN SECTOR -83 , FARIDABAD | |
| SCALE | 1 : 800 |
| DATE | 25 OCT 18 |
| SubTitle : | EXTERNAL COMBINED SERVICES |

Authorized Signatory

Architect / Town Planner

GODREJ PROPERTIES LIMITED

Client : Godrej One, 5th Floor, Pirojshahagar, Eastern Express Highway, Vikhroli (East), Mumbai - 400079