

Detail of Plots:									
Plot Nos.	Type of Plot	Nos. of Plot	Part of Plot	Width/Base (in m)	Depth/Height (in m)	Area of Rectangle (Width X Depth)	Area of triangle (base X height)/2	Area (in sqm)	Total Area (in sqm)
1 to 9	II	9		8.000	16.500	132.000		132.000	1188.000
10	II	1	A	8.000	12.800	102.400		128.245	128.245
			B	3.700	5.970	22.089			
			C	2.030	3.700		3.756		
11	II	1	A	9.350	12.230	114.351		149.236	149.236
			B	4.270	7.000	29.890			
			C	2.240	4.270		4.996		
12 to 21	II	10		8.000	16.500	132.000		132.000	1320.000
22 to 30	V	9		6.000	14.000	84.000		84.000	756.000
31	V	1		7.000	14.000	98.000		98.000	98.000
32	II	1	A	5.000	13.200	66.000		135.714	135.714
			B	7.230	13.200		47.718		
			C	12.220	1.800	21.996			
33 to 36	IV	4		6.000	15.000	90.000		90.000	360.000
37	I	1	A	5.370	15.000	80.550		142.125	142.125
			B	8.210	15.000		61.575		
			A	11.310	8.300	93.873			
			B	5.060	5.700		14.421		
			C	6.250	5.700	35.625			
38 to 46	V	8		6.000	14.000	84.000		84.000	672.000
47 to 50	V	4		6.830	14.000	95.620		95.620	382.480
51 to 59	II	9		8.000	16.500	132.000		132.000	1188.000
60 to 68	II	9		9.000	16.500	148.500		148.500	1336.500
69 to 77	II	9		8.000	16.500	132.000		132.000	1188.000
78 to 80	IV	3		6.000	15.000	90.000		90.000	270.000
81	IV	1	A	7.000	12.000	84.000		96.780	96.780
			B	5.480	3.000		8.220		
			C	1.820	3.000	4.560			
82 to 94	II	13		8.000	16.500	132.000		132.000	1716.000
95 to 101	I	7		9.000	16.500	148.500		148.500	1039.500
102 to 114	II	13		8.000	16.500	132.000		132.000	1716.000
115 to 119	V	5		6.000	14.000	84.000		84.000	420.000
120 to 144	V	25		6.000	14.000	84.000		84.000	2100.000
145	V	1	A	6.000	11.940	71.640		82.836	82.836
			B	4.870	2.060	10.032			
			C	1.130	2.060		1.164		
146	V	1	A	6.530	14.060	91.747		92.595	92.595
			B	0.280	6.530		0.849		
			C	6.000	8.810	52.860			
147	V	1	A	6.240	6.000	37.440		83.580	83.580
			B	0.240	6.000		0.720		
			C	6.000	13.570	81.420			
148	V	1	A	6.240	6.000	37.440		82.140	82.140
			B	0.240	6.000		0.720		
			C	6.000	13.430	80.580			
149	V	1	A	2.490	0.570	1.419		82.254	82.254
			B	0.030	0.570		0.009		
			D	0.140	3.510		0.246		
150 to 172	V	23		6.000	14.000	84.000		84.000	1932.000
173	III	1	A	7.500	14.650	109.875		120.772	120.772
			B	1.850	3.220	5.957			
			C	4.280	1.850	7.918			
174 to 187	III	14		6.500	16.500	107.250		107.250	1501.500
188	III	1	A	6.500	16.500	107.250		113.520	113.520
			B	0.760	16.500		6.270		
Total		188						20637.695	

Green Area Detail									
Green Area	Nos. of Plot	Part of Plot	Width/Base (in m)	Depth/Height (in m)	Area of Rectangle (Width X Depth)	Area of triangle (base X height)/2	Area (in sqm)	Total Area (in sqm)	
OG 1	1	A	59.910	8.730		261.507			
		B	59.910	14.010		419.970			
		C	43.970	16.850		370.447			
		D	25.590	5.710		73.059		1363.650	
		E	20.710	0.160		1.657			
		F	31.750	10.410		165.259			
		G	17.320	8.320		72.051			
OG 2	1	A	2.810	1.250		1.756			
		B	64.790	22.740		736.862			
		C	64.790	13.510		437.856			
		D	60.700	12.070		366.325			
		E	12.130	3.090		18.741		2346.419	
		F	55.320	10.180		281.579			
		G	71.010	5.440		193.147			
		H	102.520	4.280		219.393			
		I	31.930	5.710		91.160			
IG 1	1		41.110	15.880		326.413		326.413	
			14.000	7.690		53.620		53.620	
			12.000	21.930		131.580		131.580	
			25.670	10.810		138.746		138.746	
			14.000	1.650		11.550			
			10.730	10.990		58.961		89.341	
			2.690	14.000		18.830			
			49.400	8.980		221.808			
			49.400	0.670		16.549			
			48.810	1.260		30.750		269.105	
IG 7	1		7.000	12.800		44.800		44.800	
			5.860	10.720		31.410			
IG 9	1	A	3.730	5.000		9.325			
		B	16.500	0.670		7.716			
		C	10.360	4.570		23.673		133.125	
IG 10	1	D	27.840	0.810		11.275			
		E	9.000	-16.500		74.250			
		F	16.500	-0.900		7.425			
		A	6.250	16.500		51.563			
		B	3.240	17.470		28.301			
IG 11	1	C	35.840	0.800		14.336		175.710	
		D	9.000	16.500		74.250			
		E	16.500	0.880		7.260			
IG 12	1		6.530	11.940		38.984		38.984	
			16.690	6.860		57.247		57.247	
IG 13	1	A	5.080	8.300		20.960		27.560	
		B	9.720	1.350		6.561			
Total							5151.502		

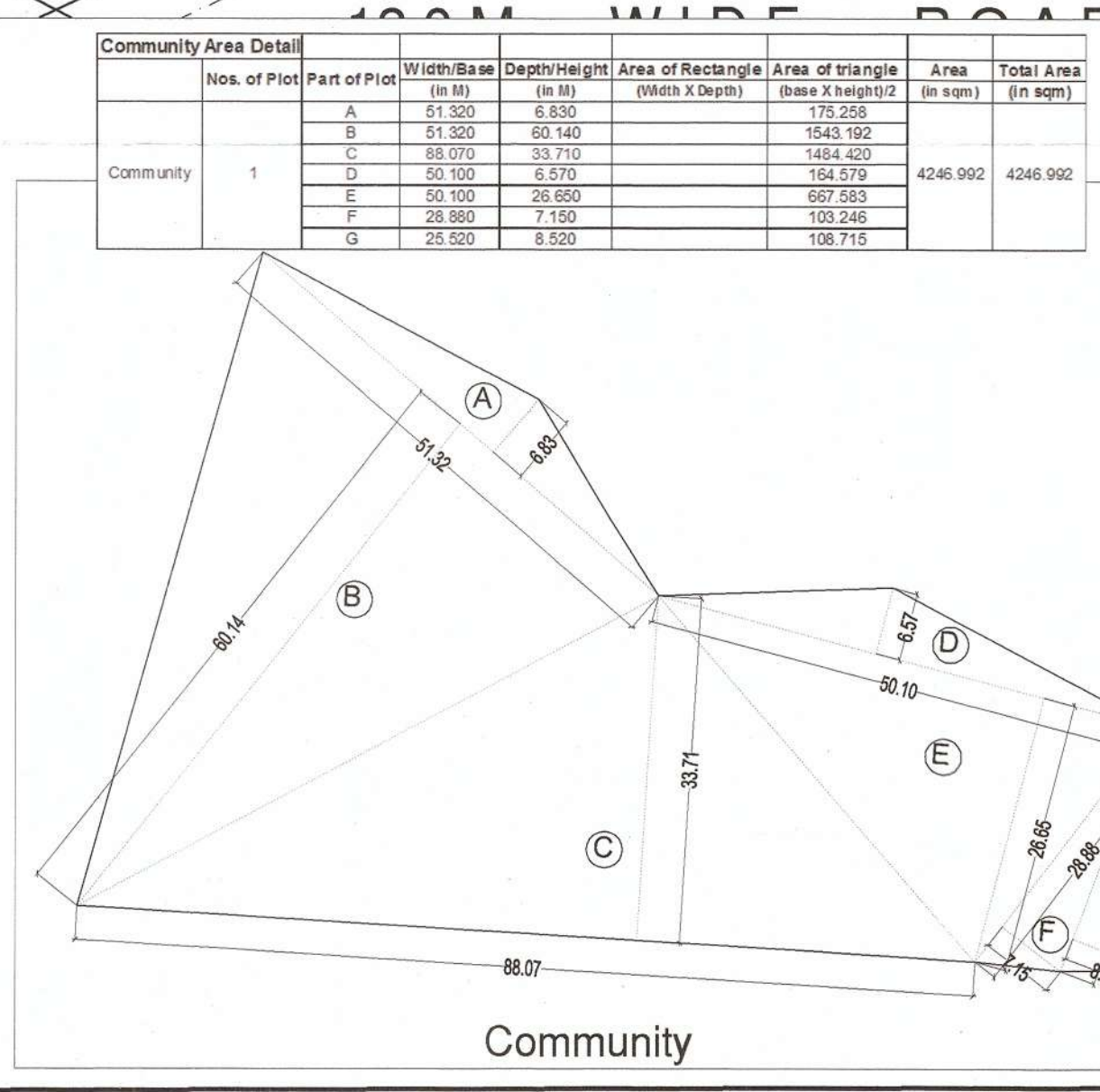
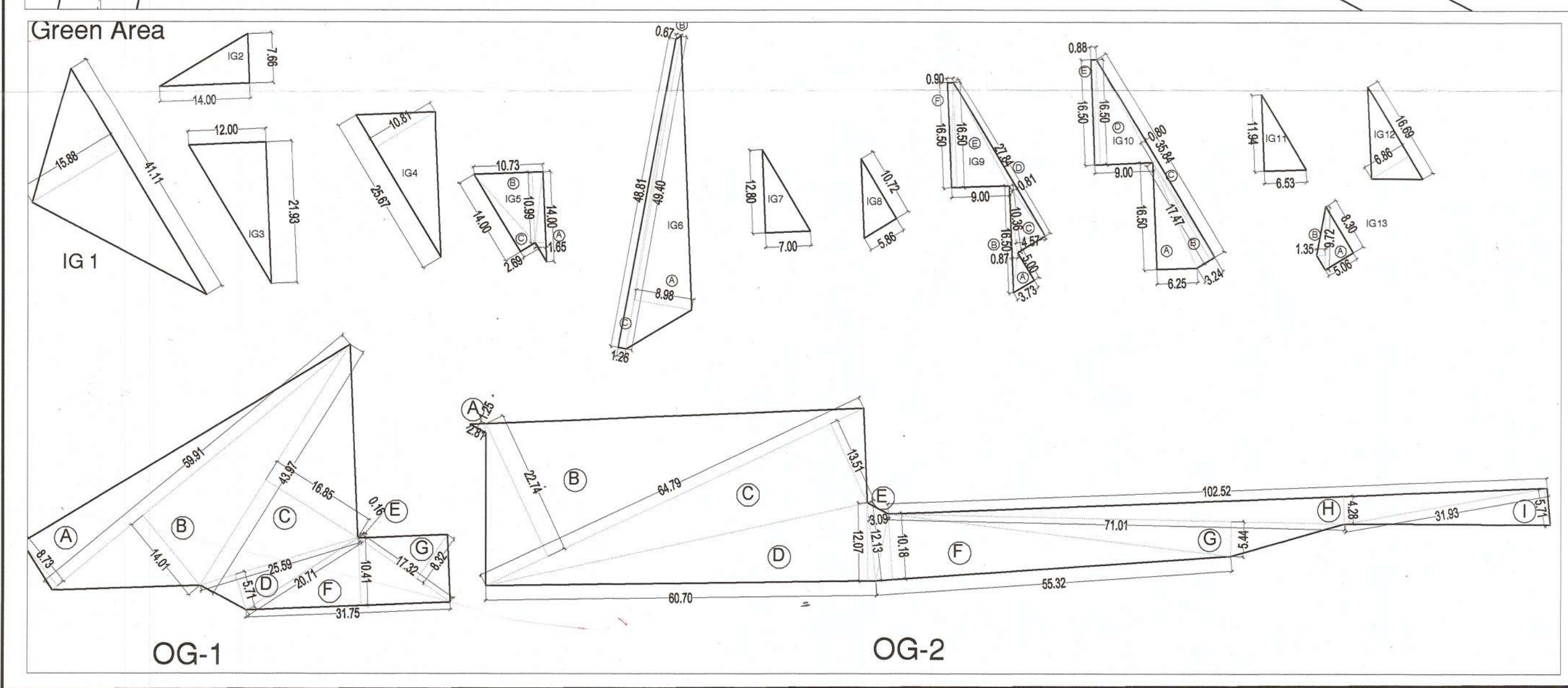

Demarcation Plan of Affordable Residential Plotted colony under Deen Dayal Jan Awas Yojna Policy 2016, over an Area Measuring 10.5 acres (through Migration Policy from their existing licence no. 149 of 2014 dated 04-09-2014 granted for land measuring 64.406 acres) in the revenue estate of village Bhatuli, Sector-20, Tehsil - Jagadhri, Dist. - Yamuna Nagar - M/s Ajitesh Buildcon Pvt. Ltd. & Others

Total area = 10.50 acres
 Area Under 12 m Wide Service Road = 0.00899acre
 50% Benefit of the 12 m Wide Service Road = 0.00449 acre
 Net Planned Area = 10.5-0.00899+0.00449 = 10.4955 acre
 Residential = 5.099 acres (48.58%)
 Commercial = 0.241 acres (2.29%)
 Community Facilities = 1.053 acres (10.03%)
 Green = 1.273 acres (12.12%)
 Saleable Area = 5.34 acres (50.87%)

DETAILS OF PLOTS			
Plot Type	Size (m)	Area (sqm)	Nos
I	9.0 x 16.5	148.50	18
II	8.0 x 16.5	132.00	68
III	6.5 x 16.5	107.25	16
IV	6.0 x 15.0	90.00	60
V	6.0 x 14.0	84.00	80
Total			188

LEGEND:
 [Hatched] Community Facilities
 [Green] Green
 [Diagonal Lines] Freeze Area
 [Solid Line] Site Boundary
 [Cross-hatched] Commercial

For Ajitesh Buildcon Pvt. Ltd.
 Director / Author Signatory

PROJECT: SUNCITY PLOTTED SCHEME, JAGADHARI, YAMUNA NAGAR

SHEET TITLE: DEMARCATION PLAN

OWNER'S SIGN: [Signature]
ARCHITECT'S NAME & SIGN: Meenakshi Kapur Architect

SCALE: 1:600
DATE: 26-09-2016
DRAWN BY: [Signature]

Ansal Housing & Constructions Ltd. in collaboration with Ajitesh Buildcon Pvt. Ltd. & Others
 PLOT-10, VASANT SQUARE MALL, PLOT-A, SECTOR-20, ROCKETRY, COMMUNITY CENTRE, VASANT KUNJ, NEW DELHI-110070